



惠州市德立电子有限公司

HUI ZHOU DE LI ELECTRONICS CO., LTD

CUSTOMER:		REV NO:	A1.0
DESCRIPTION:	COMMON MODE CHOKE	PAGE NO:	PAGE 1 OF 6
PART NO:	WBA1812D系列	SN.	
CUSTOMER NO:		DATE:	2021年8月10日

CATALOG

Resume	P2
Shape & Dimension	P3
Characteristic	P3
Part numbering ststem	P3
General specification	P3
Electrical Characteristics List	P4
Soldering Conditions	P5
Package Information	P6



惠州市德立电子有限公司

HUI ZHOU DE LI ELECTRONICS CO., LTD

CUSTOMER:		REV NO:	A1.0
DESCRIPTION:	COMMON MODE CHOKE	PAGE NO:	PAGE 3 OF 6
PART NO:	WBA1812D系列	SN.	
CUSTOMER NO:		DATE:	2021年8月10日

1. SHAPE & DIMENSION

UNIT:mm

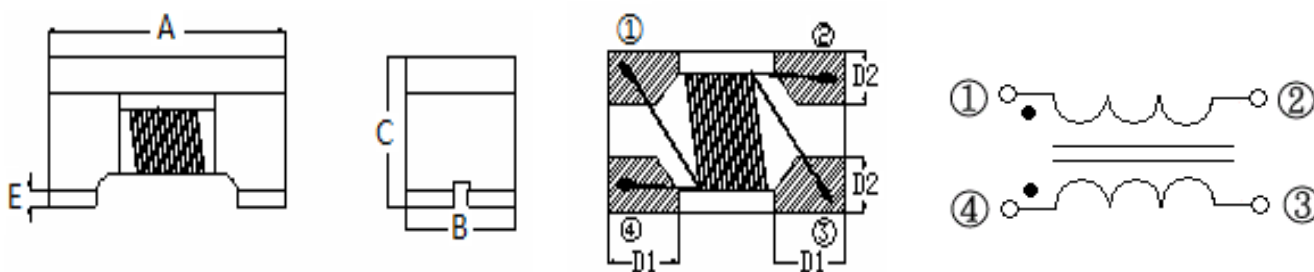

CODE	A	B	C	D1	D2	E
DIMENSION	4.50±0.20	3.20±0.20	2.80±0.2	1.00 Typ.	1.20Typ.	0.50Typ.

2. PART NUMBERING SYSTEM

WBA □□□□ □ □□□ □ □ — □□
 1 2 3 4 5 6 7

- 1 PRODUCT SYMBOL (产品代号)
- 2 DIMENSIONS (规格尺寸)
- 3 MATERIAL CODE (材料代号)
- 4 IMPEDANCE (阻抗)
- 5 TOLERANCE (公差) : P±25%; N±30%
- 6 PACKAGING (包装方式) : T-编带盘装; B -散装
- 7 E.P. (环保) : LF—Lead Free HF—Halogen Free FP—Red Phosphor Free

3. GENERAL SPECIFICATION

a. Storage temp.: -10°C~+40°C, R.H.: 30% ~ 70%, Operating temp.: -40°C ~ +125°C.

APPROVED BY	CHECKED BY	DRAFT
陈启善	黄志伟	胡俊平



惠州市德立电子有限公司

HUI ZHOU DE LI ELECTRONICS CO., LTD

CUSTOMER:		REV NO:	A1.0
DESCRIPTION:	COMMON MODE CHOKE	PAGE NO:	PAGE 4 OF 6
PART NO:	WBA1812D系列	SN.	
CUSTOMER NO:		DATE:	2021年8月10日

4. Electrical Characteristics List

NO.	Part Number	Z	Freq	Rdc	Idc	Rated Voltge	Insulation Resistance
		(Ω)	(MHz)	(Ω)Max	(mA)Max	Volts	(MΩ) Min
1	WBA1812D800PT-G-HF	80	100	0.05	3000	50	10
2	WBA1812D900PT-J-HF	90	100	0.085	3000	50	10
3	WBA1812D121PT-J-HF	120	100	0.1	3000	50	10
4	WBA1812D161PT-G-HF	160	100	0.085	1500	50	10
5	WBA1812D201PT-G-HF	200	100	0.1	1500	50	10
6	WBA1812D221PT-J-HF	220	100	0.1	1300	50	10
7	WBA1812D331PT-G-HF	330	100	0.11	1100	50	10
8	WBA1812D501PT-G-HF	500	100	0.12	1000	50	10
9	WBA1812D601PT-J-HF	600	100	0.12	1000	50	10
10	WBA1812D701PT-G-HF	700	100	0.12	1000	50	10
11	WBA1812D801PT-G-HF	800	100	0.16	900	50	10
12	WBA1812D102PT-G-HF	1000	100	0.18	800	50	10
13	WBA1812D142PT-G-HF	1400	100	0.2	700	50	10
14							
15							
16							
17							
18							
19							
20							
21							
22							

APPROVED BY	CHECKED BY	DRAFT
陈启善	黄志伟	胡俊平



CUSTOMER:		REV NO:	A1.0
DESCRIPTION:	COMMON MODE CHOKE	PAGE NO:	PAGE 5 OF 6
PART NO:	WBA1812D系列	SN.	
CUSTOMER NO:		DATE:	2021年8月10日

5. SOLDERING CONDITIONS

Figure 1. Re-flow Soldering (Lead Free)

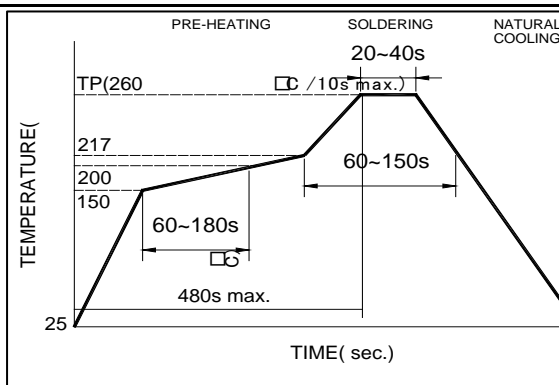

Note:

- Preheat circuit and products to 150°C
- 260°C tip temperature (max)
- Reflow times: no more than 2 times
- Solder paste thickness: the best 0.08mm is ,but max is 0.1mm

Figure 2. Wave Soldering

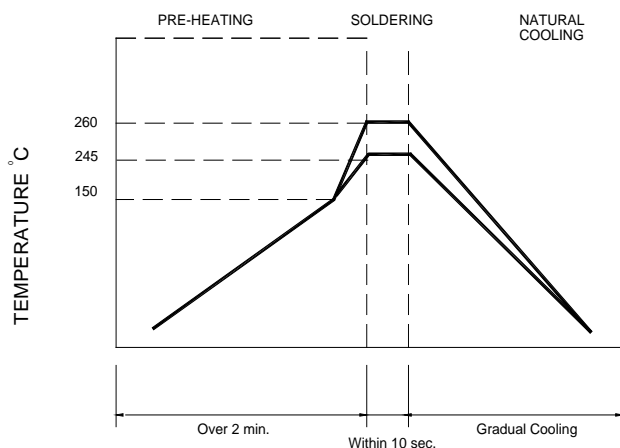

Note :

- Never contact the ceramic with the iron tip
- 1.0mm tip diameter (max)

Figure 3. Hand Soldering

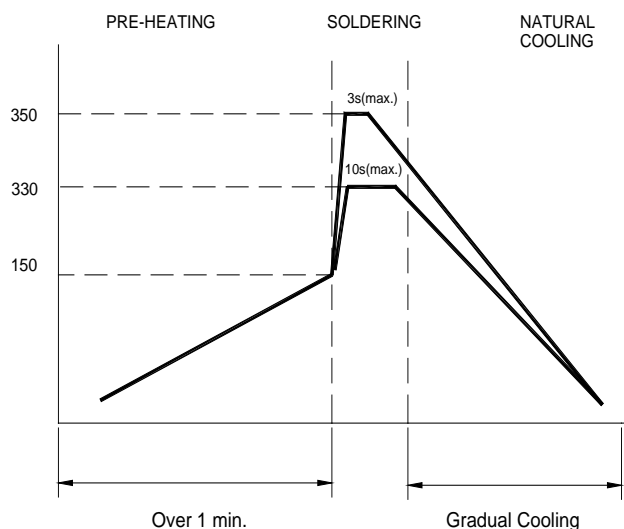

Note:

- Use a 20 watt soldering iron with tip diameter of 1.0mm
- Limit soldering time to 3 sec.

APPROVED BY	CHECKED BY	DRAWN BY
陈启善	黄志伟	胡俊平



惠州市德立电子有限公司

HUI ZHOU DE LI ELECTRONICS CO., LTD

CUSTOMER:		REV NO:	A1.0
DESCRIPTION:	COMMON MODE CHOKE	PAGE NO:	PAGE 6 OF 6
PART NO:	WBA1812D系列	SN.	
CUSTOMER NO:		DATE:	2021年8月10日

6. PACKAGING(unit: mm)

Type	1812
Quantity	500

TAPING DRAWINGS

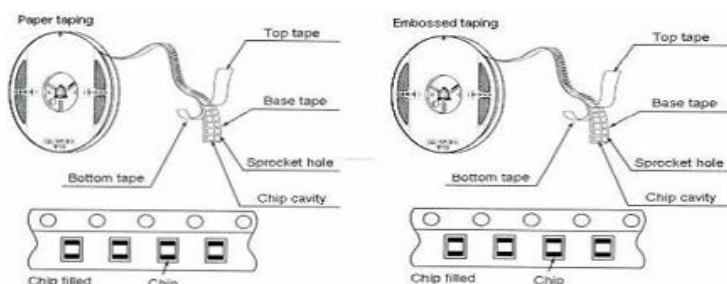

REEL DIMENSIONS(UNIT:mm)

	A	B	C	N	G
CF-12	178±2.0	22±2.0	12.5±1.5	98±2.0	12

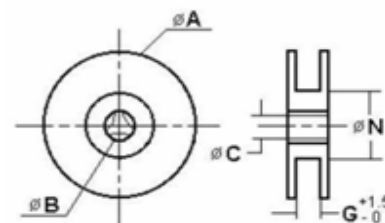

LEADER AND BLANK PORTION

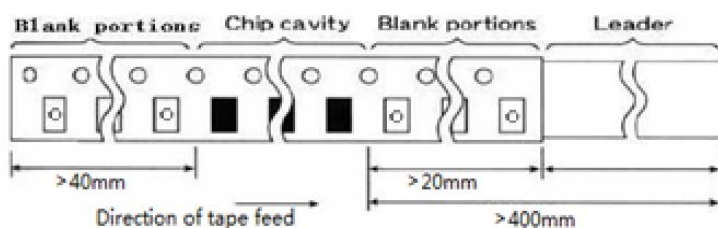

PEELLING OFF FORCE:0.05 to 0.7N in the direction show below.

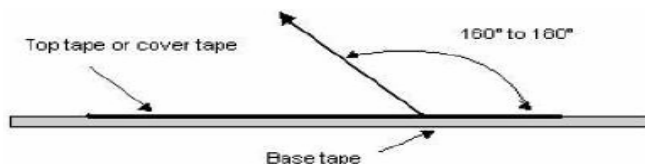

注意:

此物料不涉及汽车或相关产品方面的应用，否则，由此引起的一切品质和责任问题，我司将概不承担。

APPROVED BY	CHECKED BY	DRAFT
陈启善	黄志伟	胡俊平

X-ON Electronics

Largest Supplier of Electrical and Electronic Components

Click to view similar products for [Common Mode Chokes / Filters](#) category:

Click to view products by [DDY](#) manufacturer:

Other Similar products are found below :

[PE-64683](#) [RD5122-6-9M6](#) [RD6137-6-7M5](#) [RD8147-16-3M0](#) [ST6118T-R](#) [FE3X025-10-7NL](#) [RD7147-25-0M7](#) [TCM0806G-350-2P-T](#)
[TCM0806G-650-2P-T](#) [IND-0110](#) [UAL21VR0802000](#) [UALSC023000000](#) [UALSC1020JH000](#) [UALSU10VD20010](#) [UALSU9VD070100](#) [36-00037](#) [UALW21HS072450](#) [UALSU9H0208000](#) [UAL24VK06450CH](#) [PLT10HH501100PNB](#) [PLT10HH401100PNB](#) [PLT10HH1026R0PNB](#)
[36-00029-01](#) [PE-67531](#) [TLH10UB](#) [113 0R5](#) [2752045447](#) [7351V](#) [CMF16-153131](#) [RD7147-6-6M0](#) [T8116NLT](#) [FE2X10-4-2NL](#) [36-00029-07](#)
[T8003NLT](#) [CTX01-13663](#) [CTX66-19521-R](#) [RC212-0.5-10M](#) [RC112-0.4-15M](#) [RC212-0.6-6M8](#) [RC212-0.4-15M](#) [RC112-0.3-30M](#)
[WTCF2012Z0M751PB](#) [PH9408.814NLT](#) [PAC6006.364NLT](#) [PAC6006.444NLT](#) [PAC6006.204NLT](#) [PH9407.204NLT](#) [PAC6006.264NLT](#)
[PH9408.105NLT](#) [PH9408.494NLT](#) [PAC6006.104NLT](#)