

Technical Data

Material:

Pin(outer sleeve): Brass,machined CuZn38Pb2

Clip(contact 6 finger): Beryllium Copper,heat treated

Plating(outer sleeve):

Tin plated:2µm/80µ"Ni, 5µm/200µ"Sn

Gold Plated:2µm/80µ"Ni, Full gold

Plating(contact): 2µm/80µ"Ni, gold or Tin plated

Insulator(black): Glass filled thermoplastic polyester

UL94V-0



Electrical:

Current rating: 3Amps/contact max.

Contact resistance: $54m\Omega/$contact

Insulation resistance: $\geq 1000M\Omega$ at $V=100V$

Operating voltage: 60VAC/DC

Mechanical:

Average insertion force : <math><250g</math>

with steel pin of $\varnothing 0.7mm$ - $\varnothing 0.8mm$ or $\varnothing Q0.64mm$

Average withdrawal force : $>50g$

with steel pin of $\varnothing 0.7mm$ - $\varnothing 0.8mm$ or $\varnothing Q0.64mm$

Mechanical life cycle:min.200

Operating temperatures: Gold Plated:-55°C to+105°C

Tin plated:-40°C to+105°C

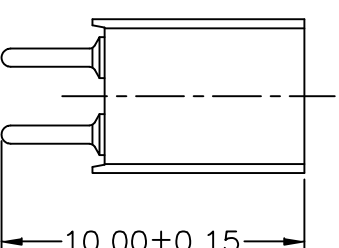
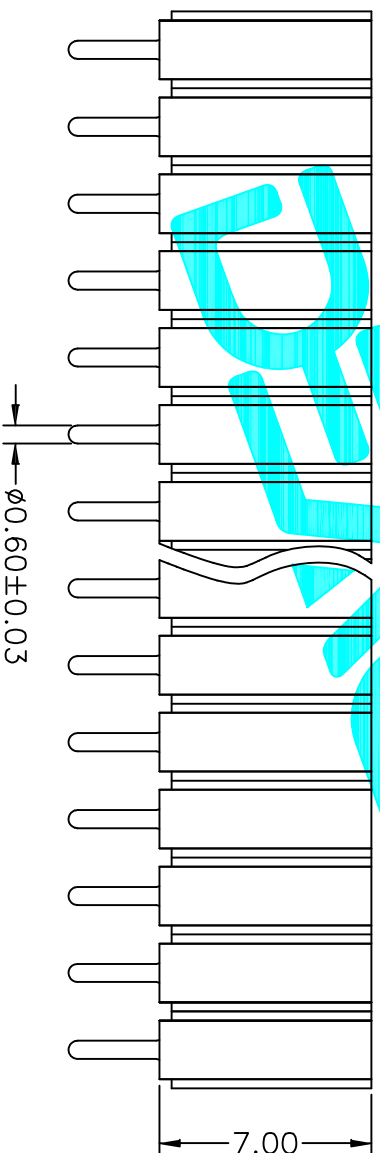
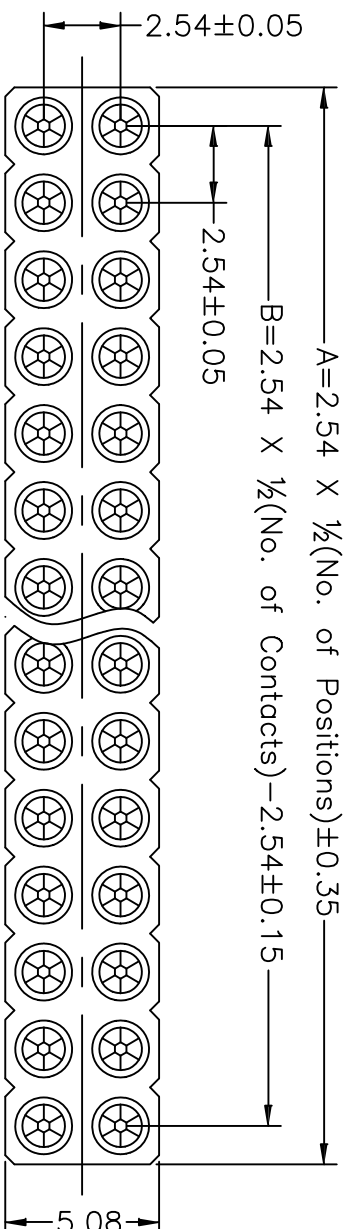

APPROVALS		DATE	TITLE:	
DRAWN	G.M.Chen	2015/7/17	Connector	
CHECKED			ELECTRONICS CO.,LTD	
APPROVALS			Connector	
CHANGE.			PART NO.	MW254R-22-XX-10
CHECK.			UNIT:	mm
APPRO.			SCALE:	1:1
			DRAWING NO.	
				SHEET 1 OF 1
				PROJ.
ECN NO.	REV.	DATE.	DESCRIPTION.	
	A		NEW	



30 ^{max} ±0.15	±0.30	ANGLE
10 ^{max} ±0.10	±0.20	
5 ^{max} ±0.05	±0.15	±2°

TOLERANCES ARE

X-ON Electronics

Largest Supplier of Electrical and Electronic Components

Click to view similar products for [Headers & Wire Housings](#) category:

Click to view products by [DEALON](#) manufacturer:

Other Similar products are found below :

[57102-F02-18ULF](#) [58102-G61-06LF](#) [582553-1](#) [009176003701906](#) [01.001.5753.1](#) [0050291907](#) [02.125.8002.8](#) [609-3404](#) [61062-3](#)
[CSU011177004](#) [622-0430](#) [622-3653LF](#) [63453-116](#) [636-1030](#) [636-1427](#) [636-3427](#) [636-4007](#) [641938-9](#) [644827-2](#) [65495-038](#) [65692-001LF](#)
[65781-018](#) [65781-047](#) [65817-010LF](#) [65817-015LF](#) [66207-023LF](#) [67095-007LF](#) [67601157](#) [68631-112](#) [68645-018](#) [699319-000](#)
[M90C108951C](#) [70.362.1628.0](#) [70-4210](#) [70-4226B](#) [70-4853B](#) [707-5028](#) [71.350.2428.0](#) [71961-016LF](#) [733-134](#) [733-162](#) [754199-000](#) [760-](#)
[3052](#) [80.063.4001.1](#) [800-90-001-10-001000](#) [800-90-010-10-002000](#) [801-43-002-10-013000](#) [801-43-006-10-002000](#) [803-41-018-10-001000](#)
[803-43-024-10-001000](#)