

Circuit Diagram

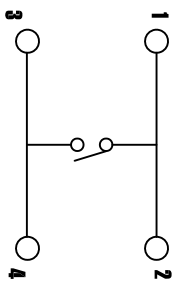

NO.1			
PART NO	H	PART NO	H
A	4.3	O	11
B	4.5	P	11.5
C	5	Q	12
D	5.5	R	12.5
E	6	S	13
F	6.5	T	13.5
G	7	U	14
H	7.5	V	14.5
I	8	W	15
J	8.5	X	15.5
K	9	Y	16
L	9.5	Z	16.5
M	10		17
N	10.5		17.5

PCB Layout(Pattern side)

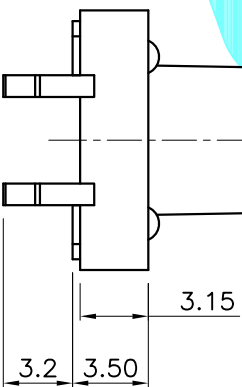
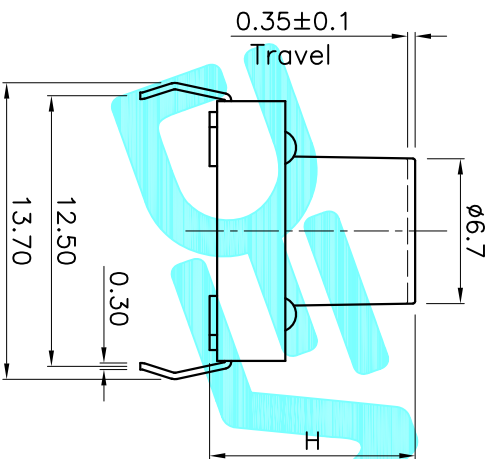

NO.2			
PART NO	QTY	DESCRIPTION	UNIT
070	70±30	vigor	
100	100±50		
160	160±50		
250	250±50		
320	320±80		
350	350±80		
520	520±130		

ITEM	PART NAME	QTY.	MATERIAL	FINISHING
⑤	Terminal	4	Brass(0.3t)	Plating silver
④	Contact Spring	1	F,Ag/C5210	
③	Base	1	Nylon	Black
②	Cover	1	SPCC/Brass	Plating Sn
①	KNOB	1	Nylon	Black

Note:  
1. Rating: 12V 50mA

APPROVALS		DATE	TITLE:	
DRAWN	G.M.Chen	2014/8/18	TACT SWITCHES	
CHECKED				
APPROVALS				
PART NO.		TC-1212DR-XXH-XXX	SHEET 1 OF 1	
UNIT:		mm	SCALE: 1:1	
DRAWING NO.			PROJ.	

ECN NO.	REV.	DATE.	DESCRIPTION.
	A		NEW

CHANGE.	CHECK.	APPRO.

APPROVALS		DATE	TITLE:	
DRAWN	G.M.Chen	2014/8/18	TACT SWITCHES	
CHECKED				
APPROVALS				
PART NO.		TC-1212DR-XXH-XXX	SHEET 1 OF 1	
UNIT:		mm	SCALE: 1:1	
DRAWING NO.			PROJ.	



APPROVALS		DATE	TITLE:	
DRAWN	G.M.Chen	2014/8/18	TACT SWITCHES	
CHECKED				
APPROVALS				
PART NO.		TC-1212DR-XXH-XXX	SHEET 1 OF 1	
UNIT:		mm	SCALE: 1:1	
DRAWING NO.			PROJ.	

ECN NO.	REV.	DATE.	DESCRIPTION.
	A		NEW

CHANGE.	CHECK.	APPRO.

APPROVALS		DATE	TITLE:	
DRAWN	G.M.Chen	2014/8/18	TACT SWITCHES	
CHECKED				
APPROVALS				
PART NO.		TC-1212DR-XXH-XXX	SHEET 1 OF 1	
UNIT:		mm	SCALE: 1:1	
DRAWING NO.			PROJ.	

## X-ON Electronics

Largest Supplier of Electrical and Electronic Components

*Click to view similar products for [Tactile Switches](#) category:*

*Click to view products by [DEALON](#) manufacturer:*

Other Similar products are found below :

[5GTH92001](#) [5GTH9202242](#) [6407-250V-25273P](#) [ADTSA62NV](#) [ADTSA62RV](#) [B3F-3123](#) [1977177-8](#) [1977266-1](#) [ADTSA63NV](#)  
[ADTSM21NSVTR](#) [ADTSM25RVTR](#) [ADTSM32NVTR](#) [ADTSMW64RV](#) [FSMRA4JHA04](#) [GS4.70F300QP](#) [KSC241J SP DELTA LFS](#)  
[3FTL600RAS](#) [3FTL640RAS](#) [Y96K132V0FPLFS](#) [5GTH9658222](#) [6407-250V-25343P](#) [ADTSM31NVTR](#) [2-1977120-7](#) [TSJW-5.2-260-TR](#)  
[KMT011MNGJLHS](#) [B3WN6002S](#) [70-201.0](#) [ADTSG648NV](#) [ADTSM62KSVTR](#) [ADTSM648NV](#) [95C06E3RAT](#) [5GTH96561](#) [3ATH9Q](#)  
[FSMRA8JHA04](#) [HARS0073](#) [Y33R411N9FPLFT](#) [Y31C01402FPLFS](#) [PTS645SK50SMTR92](#) [ADTSM32NVB](#) [KMS233GPWTLFG](#)  
[Y78B64124FP](#) [Y96D113G0FP LFS](#) [Y33A812C5FP LFT](#) [Y56B2D120FP LFS](#) [PTS645 DVM83-BN125-2 LFS](#) [B3W 1000G](#) [KSC621G OL](#)  
[LFS](#) [B3F 1002C](#) [B3F 0047H](#) [B3F 1000G](#)