

NO.1	
PART NO	H
A	2.0
B	2.5

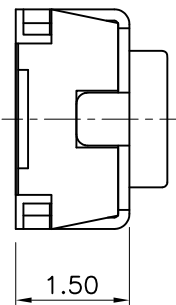
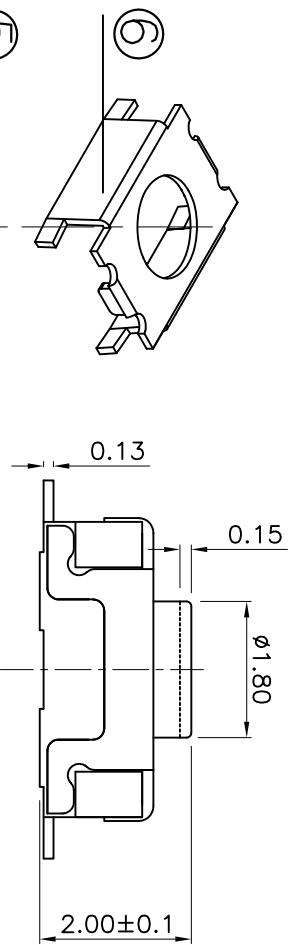

NO.2	
PART NO	vigor
1	70±30
2	100±50
3	160±50
4	260±50
5	320±80
6	350±80
7	520±130

NO.3	
PART NO	MATERIAL/QTY
S	SUS/1PC
D	SUS/2PCS

NO.4	
PART NO	NOTE
1~9	SERIAL NUMBER

NO.5	
PART NO	NOTE
B	Bulk
R	Tape&Reel

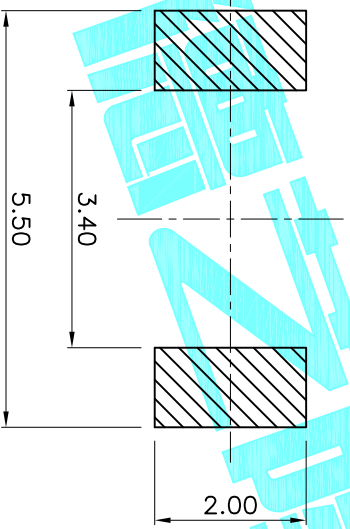
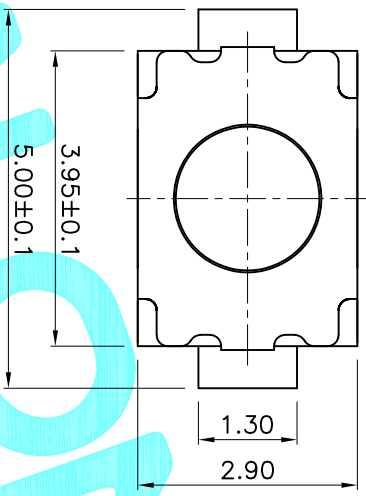

PCB Layout (Pattern Side)

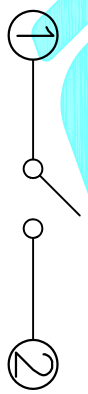
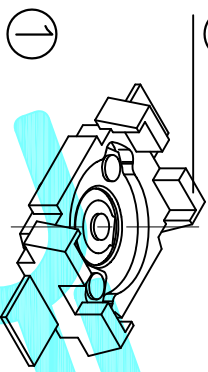

Circuit diagram

- 1. Rating:DC12V 50mA.
- 2. Travel:0.15±0.1mm.
- 3. Operating Force:250±50gf.
- 4. Contact Resistance:100mΩ Max.
- 5. Life:30,000 Cycles Min.

PART NO.	
TD-1185SA	
TD-1185SN	

ITEM	PART NAME	QTY.	MATERIAL	FINISHING
⑥	Cover	1	SUS T=0.15	Natural
⑤	Knob	1	LCP	Black
④	Dust Cover	1	Kapton Film	Yellow
③	Contact	2	SUS	Plating silver
②	Base	1	LCP	Black
①	Terminal	2	Phosphor Bronze/plating silver	

**DEALON**  
ELECTRONICS CO.,LTD

APPROVALS		DATE	TITLE:	
DRAWN	G.M.Chen	2015/9/11	TACT SWITCHES	
CHECKED			PART NO. TD-1185SN-XXN-XXX	
APPROVALS			UNIT: mm	SCALE: 1:1
TOLERANCES ARE		30~40±0.30	ANGLE	SHEET 1 OF 1
		10~30 ±0.20		PROJ.
		5~10 ±0.15		
ECN NO.	REV.	DATE.	DESCRIPTION.	CHANGE.
	A		NEW	

## X-ON Electronics

Largest Supplier of Electrical and Electronic Components

*Click to view similar products for [Tactile Switches](#) category:*

*Click to view products by [DEALON](#) manufacturer:*

Other Similar products are found below :

[5GTH92001](#) [5GTH9202242](#) [ADTSA62NV](#) [ADTSA62RV](#) [B3F-3123](#) [1977177-8](#) [1977266-1](#) [ADTSA63NV](#) [ADTSM21NSVTR](#)  
[ADTSM25RVTR](#) [ADTSM32NVTR](#) [ADTSMW64RV](#) [FSMRA4JHA04](#) [GS4.70F300QP](#) [3ESH9R](#) [KSC241J](#) [SP DELTA LFS](#) [3FTL600RAS](#)  
[3FTL640RAS](#) [Y96K132V0FPLFS](#) [5GSH92001](#) [5GTH9658222](#) [ADTSM31NVTR](#) [2-1977120-7](#) [TSJW-5.2-260-TR](#) [KMT011MNGJLHS](#)  
[ADTSG648NV](#) [ADTSM62KSVTR](#) [ADTSM648NV](#) [95C06E3RAT](#) [3ATH9Q](#) [FSM4JSMLXTR](#) [FSM4JSMXL](#) [FSMRA8JHA04](#) [HARS0073](#)  
[Y97HS12A5RAFP](#) [Y97BT23B2HAFP](#) [Y33R411N9FPLFT](#) [Y31C01402FPLFS](#) [PTS645SK50SMTR92](#) [ADTSM32NVB](#) [KMS233GPWTLFG](#)  
[Y78B42324FP](#) [Y33R21116FPLFT](#) [Y31B43131FPLFG](#) [Y78B64124FP](#) [Y71243251FP](#) [Y33R31119FPLFT](#) [Y97HS12A5TAFP](#)  
[PTS638SK25SMTR2LFS](#) [Y97LT25BADBFP](#)