

公差 (mm)		General tolerances (mm)	
0	>3	>10	>18
~	~	~	~
3	6	10	18
~	~	~	~
±0.12	±0.18	±0.22	±0.26
±0.31	±0.37	±0.57	±0.57
±0.80	±0.93	±1.05	±1.15
±1.60	±2.20	±2.50	±2.50
±2	±2	±2	±2
0.1/10	0.1/10	0.1/10	0.1/10
±2	±2	±2	±2

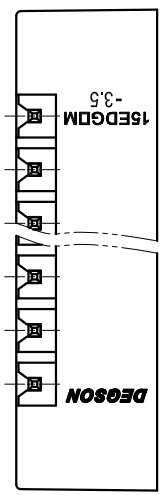

研发中心
管发专用
2020.06.01
(仅限内部使用, 对外无效)

3	Screw cap	Copper alloy	/
2	Pin	Copper alloy	Sn plated
1	Housing	PA66	UL94V-0
ITEM	NAME OF PART	MATERIAL	NOTES
UL 标准/UL Standard: B C D			
额定电压/电流/Rated Voltage(V)/Current(A) 300/8 / 300/8			
IEC 标准/IEC Standard: III/3 III/2 II/2			
过压类别/Overvoltage Category/污染等级/Pollution Degree III/3 III/2 II/2			
额定电压/电流/Rated Voltage(V)/Current(A) / / 250/7			
额定脉冲电压/Rate Impulse Voltage(KV) / / 2.5			
间距/Pitch(mm)/线数范围/Poles 3.50/N=02~22P			
使用温度范围/Operating Temperature(°C) -40~+105			
符合RoHS环保要求/Conform to RoHS Yes			

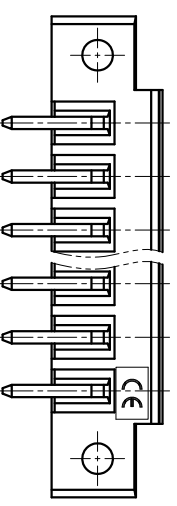
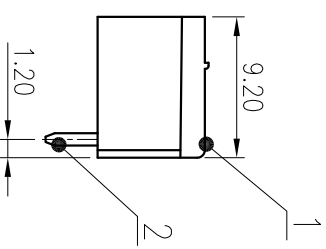
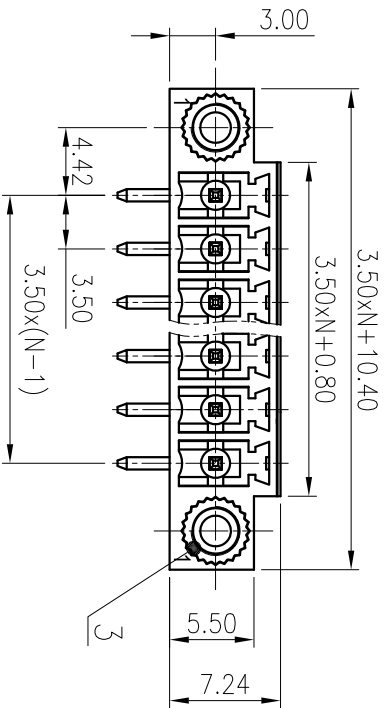
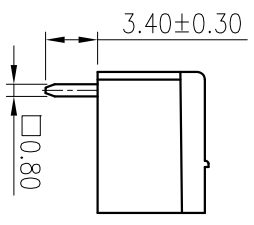
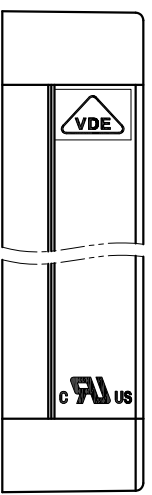
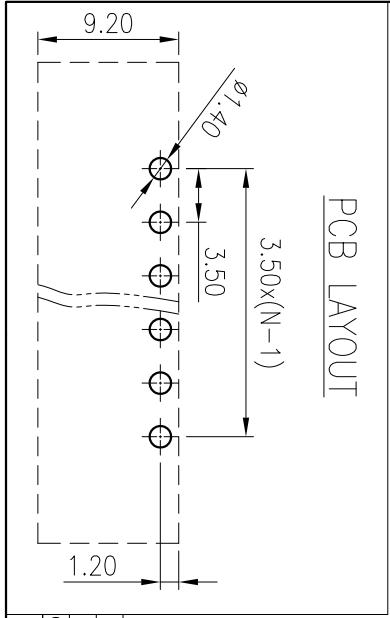

REV	ECN	DESCRIPTION	DRFT	DATE
T1		Change the frame	Wu LF	2020.06.01

MATERIAL:	
MAT NO.:	/
STATUS:	/
APPR:lan	CHKD:YU
CHH 2020.06.01	JZh 2020.06.01
DRFT: YZ	2015.10.13
SIZE: A4	(mm)
(inch)	
NAME:	15EDGRM-3.5-XXP-1Y-00A(H)
DRAWING NO.:	15EDGRM-3.5-C01
TYPE:	CUSTOMER DRAWING
SCALE:	2:1
SHEET	1/1

宁波高松电子有限公司
NINGBO DEGSON ELECTRICAL CO., LTD

X-ON Electronics

Largest Supplier of Electrical and Electronic Components

Click to view similar products for [Other Tools](#) category:

Click to view products by [Degson](#) manufacturer:

Other Similar products are found below :

[899-2-KT46](#) [CR-0AFL4--332K](#) [568681-1](#) [5800-0090](#) [58061-1](#) [59085](#) [00-8273-RDPP](#) [593033](#) [593072](#) [593564100](#) [593575](#) [593593](#) [010-0003-0000](#) [011349-000](#) [CRCW08052740FRT1](#) [LUC-012S070DSM](#) [LUC-018S070DSP](#) [LUC-024S105DSP](#) [599-2021-3-NME](#) [599-JJ-2021-03](#) [CRCW2010331JR02](#) [601-JJ-06](#) [601-SPB](#) [601YSY](#) [602-JJ-03](#) [602SPB](#) [603-JJ-07-FP](#) [603-JJY-04](#) [CRTN1013](#) [CS16](#) [6-1579014-0](#) [62036240-1](#) [M43435 TY 1 SZ 3 FIN B BLK](#) [M43435 TY 2 SZ 3 FIN C BLK](#) [M43435 TY 5 SZ 3 FIN C NAT](#) [M-5Z](#) [M6816](#) [660-29ABT1](#) [662508-1](#) [CVHD-950X-93.333](#) [CW104-01X](#) [671-GP-04-KT39-73207](#) [CW307-01A](#) [CW30901A](#) [CW6211201A](#) [690191-1](#) [690191-3](#) [690317-2](#) [691409-4](#)