

公差 (mm)		General tolerances (mm)	
0	>3	>10	>18
~	~	~	~
3	6	10	18
~	~	~	~
±0.12	±0.18	±0.22	±0.26
±0.31	±0.37	±0.57	±0.57
±0.80	±0.93	±1.05	±1.15
±1.60	±2.20	±2.50	±2.50
±2	±2	±2	±2
0.1/10	0.1/10	0.1/10	0.1/10
±2	±2	±2	±2

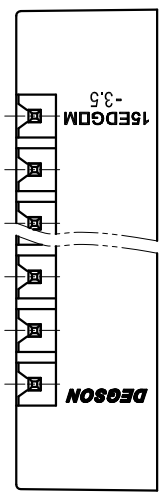
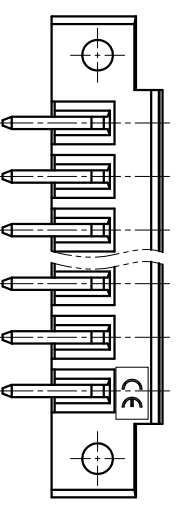
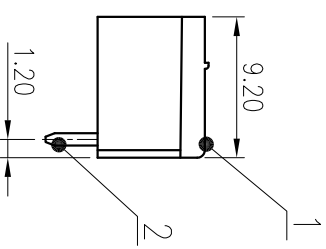
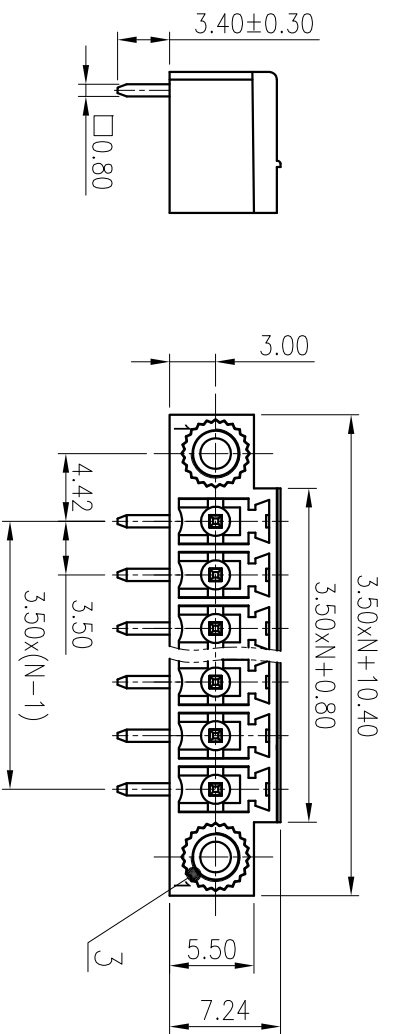
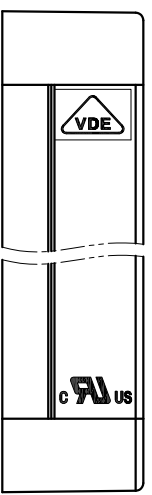

PCB LAYOUT

研发中心
管发专用
2020.06.01
(仅限内部使用, 对外无效)

3	Screw cap	Copper alloy	/
2	Pin	Copper alloy	Sn plated
1	Housing	PA66	UL94V-0
ITEM	NAME OF PART	MATERIAL	NOTES
UL 标准/UL Standard: B C D			
额定电压/电流/Rated Voltage(V)/Current(A) 300/8 / 300/8			
IEC 标准/IEC Standard: III/3 III/2 II/2			
过压类别/Overvoltage Category/污染等级/Pollution Degree III/3 III/2 II/2			
额定电压/电流/Rated Voltage(V)/Current(A) / / 250/7			
额定脉冲电压/Rate Impulse Voltage(KV) / / 2.5			
间距/Pitch(mm)/线数范围/Poles 3.50/N=02~22P			
使用温度范围/Operating Temperature(C) -40~+105			
符合RoHS环保要求/Conform to RoHS Yes			

MATERIAL:	
MAT NO.:	/
STATUS:	/
APPR:lan	ChH 2020.06.01
CHKD:YU	JZh 2020.06.01
DRFT:	YZ 2015.10.13
ECN	Change the frame
REV	(11)
DRFT	Wu LF
DATE	2020.06.01

SIZE: A4	SCALE: 2:1	SHEET	1/1
TYPE: CUSTOMER DRAWING	SCALE: 2:1	SHEET	1/1
NAME:	15EDGRM-3.5-XXP-1Y-00A(H)		
DRAWING NO.:	15EDGRM-3.5-C01		
TYPE:	CUSTOMER DRAWING		
DRFT:	YZ	2015.10.13	REV T1
CHKD:	YU	JZh	2020.06.01
APPR:	lan	ChH	2020.06.01
STATUS:	/		
MAT NO.:	/		

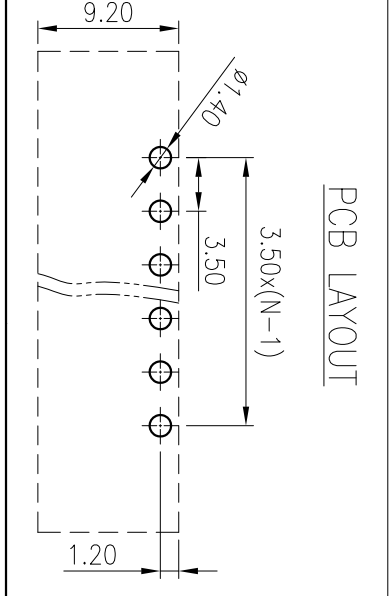

MATERIAL:	
MAT NO.:	/
STATUS:	/
APPR:lan	ChH 2020.06.01
CHKD:YU	JZh 2020.06.01
DRFT:	YZ 2015.10.13
ECN	Change the frame
REV	(11)
DRFT	Wu LF
DATE	2020.06.01

SIZE: A4	SCALE: 2:1	SHEET	1/1
TYPE: CUSTOMER DRAWING	SCALE: 2:1	SHEET	1/1
NAME:	15EDGRM-3.5-XXP-1Y-00A(H)		
DRAWING NO.:	15EDGRM-3.5-C01		
TYPE:	CUSTOMER DRAWING		
DRFT:	YZ	2015.10.13	REV T1
CHKD:	YU	JZh	2020.06.01
APPR:	lan	ChH	2020.06.01
STATUS:	/		
MAT NO.:	/		

宁波高松电子有限公司 NINGBO DEGSON ELECTRICAL CO., LTD

X-ON Electronics

Largest Supplier of Electrical and Electronic Components

Click to view similar products for [Pluggable Terminal Blocks](#) category:

Click to view products by [Degson](#) manufacturer:

Other Similar products are found below :

[57.510.0053](#) [721-104/026-047](#) [721-204/026-045](#) [MC 1.5/ 6-ST-3.5 GY AU](#) [ET02015000J0G](#) [860505](#) [860516](#) [860810](#) [GBPACX-12](#)
[93.731.4953.0](#) [PVP03-3,50](#) [PVS02-5,00](#) [1-1986160-3](#) [1377680000](#) [1531000000](#) [1546228-5](#) [ELFP03110](#) [ELFP10210](#) [ELFT07250](#)
[ELVD12100](#) [ELVF09400](#) [ELXH071G0E](#) [1725220000](#) [1760336](#) [1855000000](#) [19346](#) [1946309](#) [1973592](#) [19892](#) [25.320.4053.1](#) [25.320.4553.9](#)
[25.320.4753.1](#) [25.320.5453.1](#) [25.340.0353.1](#) [25.340.1053.1](#) [25.345.3553.0M001](#) [25.640.3553.1](#) [SH02-5,08](#) [SH06-3,81](#) [SH08-5,08](#) [SH08-](#)
[5,08-K](#) [SH12-5,08](#) [SHS04-5,00](#) [30.303](#) [30.305](#) [30.306](#) [PHP09-5,08](#) [25.193.0453.0](#) [25.320.4653.1](#) [25.332.2453.1](#)