

REV	ECN	DESCRIPTION	DRFT	DATE

REVISION RECORD

NOTES1:

- 1. Rated voltage/current : 300V / 8A
- 2. Withstanding voltage : AC1600V/1min.

IEC Standard

1. Pollution Degree	2
Overvoltage Category	II
Rate Impulse Voltage(kV)	2.5kV
Rate Voltage(V)	250V
Rate Current(A)	7A

NOTES2:

- 1. Dimension shall be interpreted per ASME Y14.5-2009
- 2. Pitch : 3.5/3.81mm, Poles : N=02~22P
- 3. Operating temperature: -40°C~+105°C
- 4. Undimensioned tolerances:

Pitch range in mm	mm	mm
Over	Over	Over
6 TO 10	6 TO 10	6 TO 10
10 TO 24	30 TO 60	30 TO 60
±0.15	±0.30	±0.50
±0.20	±0.30	±0.50
±0.30	±0.70	±1.00
±1.30	±1.30	±2.00

5. RoHS Compliance

15EDGVM - 3.5/3.81 - XX - 1X - 00A (H)
 (RoHS)
 00A - (Standard)
 1. (Grey)
 (Series No.) (Pitch) (Poles) (Single Pitch) (Color):
 2. (Blue)
 3. (Black)
 4. (Green)
 5. (Orange)
 6. (Red)
 7. (Transparent)
 8. (Yellow)
 9. (White)

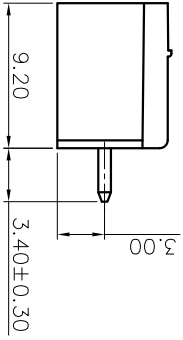

PART NO.:				NAME:			
DRFT:				CHKD:			
TTL:				15EDGVM-3.5/3.81-XXP-1Y-00A(H)			
DRAWING NO.:		SHEET		REV		DO	
THIRD ANGLE PROJECTION		DO NOT SCALE DRAWING		SCALE		1:1	

DETACHED LISTS

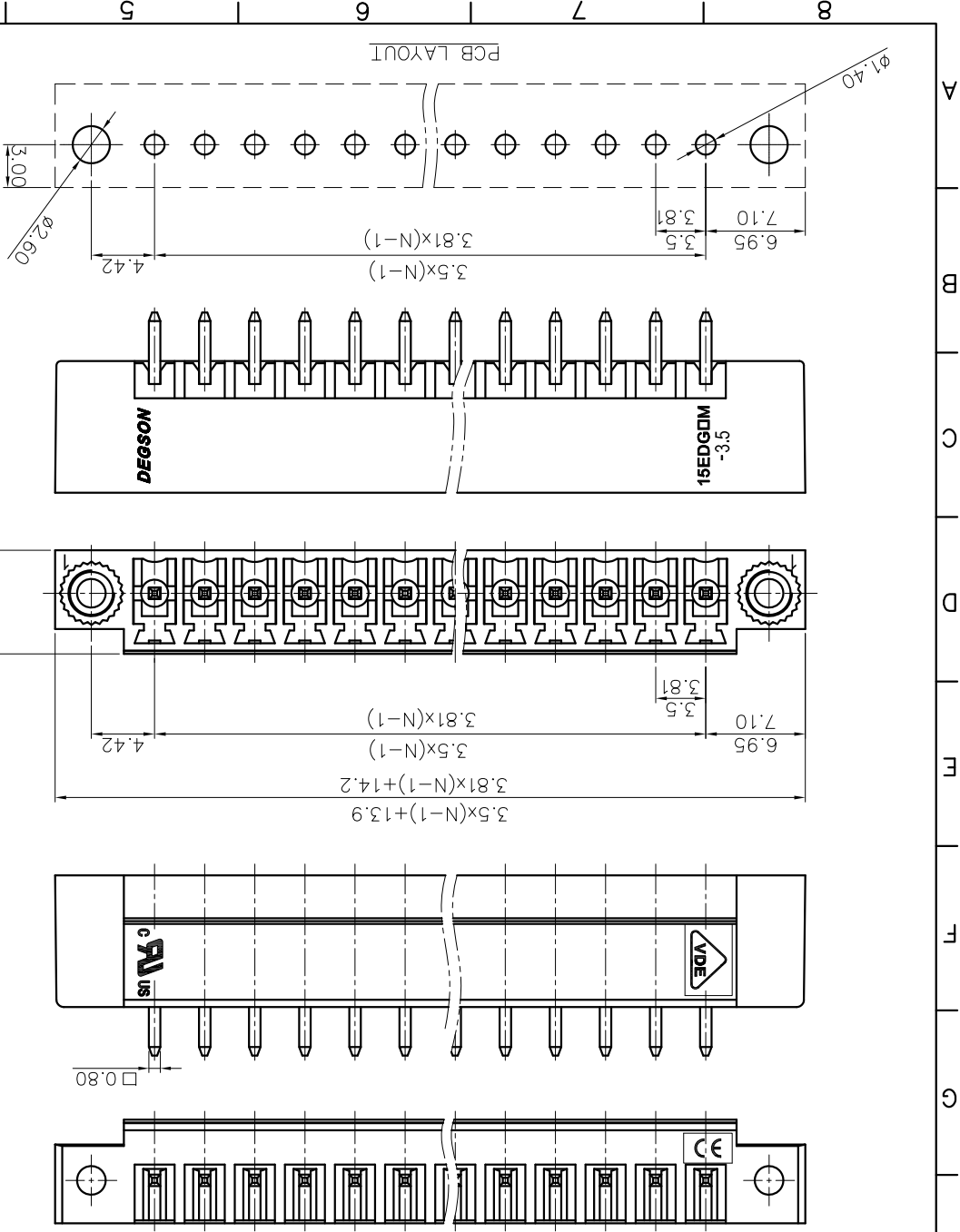

X-ON Electronics

Largest Supplier of Electrical and Electronic Components

Click to view similar products for [Pluggable Terminal Blocks](#) category:

Click to view products by [Degson](#) manufacturer:

Other Similar products are found below :

[57.404.7553](#) [57.504.0053.7](#) [57.510.0053](#) [57.910.6153](#) [01.112.1453](#) [CTB932VE/6](#) [MC 1.5/ 6-ST-3.5 GY AU](#) [ET02015000J0G](#) [734-104](#) [734-302](#) [734-304](#) [8-141-P](#) [FKCT 2.5/ 3-ST KMGY](#) [860505](#) [860508](#) [860516](#) [860810](#) [861908](#) [GBPACX-12](#) [93.731.4953.0](#) [PV05-5,08-K](#) [PVP02-5,00](#) [PVP04-3,50](#) [PVS02-5,00](#) [1-1986160-3](#) [H-10](#) [1546228-5](#) [ELFH09150](#) [ELFH16150](#) [ELFP03110](#) [ELFT06250](#) [ELFT07250](#) [ELVF09400](#) [ELVP03100](#) [ELXH03100](#) [ELXH071G0E](#) [ELXP041G0](#) [ELXT046G0](#) [1700101](#) [1700410](#) [1700425](#) [1703176](#) [1705229](#) [1710175](#) [1714537](#) [1717806](#) [1719600](#) [1729386](#) [1734692](#) [1734795](#)