

REVISION RECORD			
REV	ECN	DESCRIPTION	DATE

PART NO.:	/	NAME:	NINGBO DEGSON ELECTRICAL CO., LTD	
			宁波高松电子有限公司	
APPD:	/			
CHKD:	/			
DRFT:	/	TITLE: CUSTOMER DRAWING	REV: DO	SHEET: 1/1
THIRD ANGLE PROJECTION		DO NOT SCALE DRAWING		SCALE: 1:1

- DETACHED LISTS
- 9. (White)
 - 8. (Yellow)
 - 7. (Transparent)
 - 6. (Red)
 - 5. (Orange)
 - 4. (Green)
 - 3. (Black)
 - 2. (Blue)
 - 1. (Grey)
- (Series No.) (Pitch) (Poles) (Single Pitch)(Color) : 1.(Grey) 00A - (Standard) (H)
- ZEDGVM - 5.0/5.08 - XXP - 1X - 00A (H)

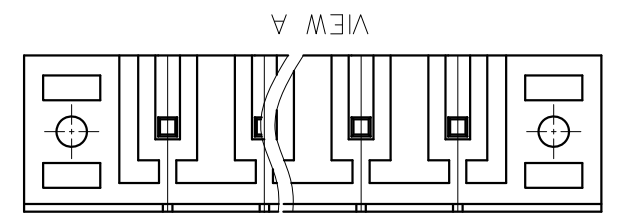
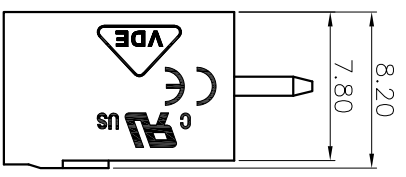
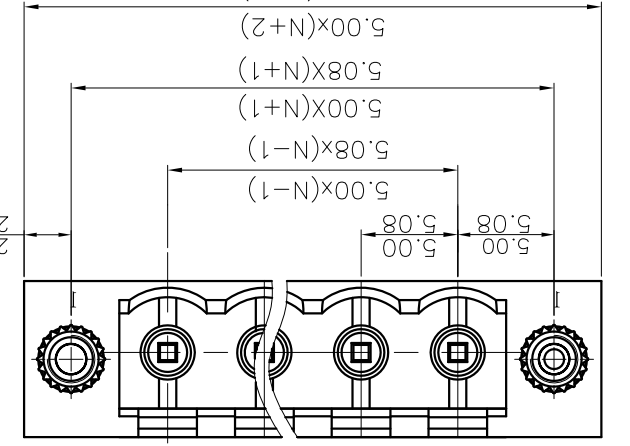
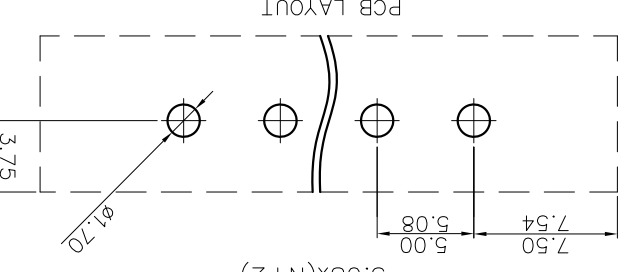

5. RoHS Compliance

mm	mm	mm	mm	mm	mm	mm	mm	mm	mm
±0.15	±0.20	±0.30	±0.50	±0.70	±1.00	±1.30	±2.0		
6	10	24	30	60	100	150	≤		
Over 10	Over 24	Over 30	Over 60	Over 100	Over 150	Over 150	0.1/10		

Pitch range in mm

Nominal dimension range

NOTE2: 1. Dimension shall be interpreted per ASME Y14.5-2009

2. Pitch : 5.00/5.08mm, Poles : N=02~22P

3. Operating temperature: -40°C~+105°C

4. Undimensioned tolerances:

IEC Standard

Rate current(A)	20A
Rate voltage(V)	320V
Rate impulse voltage(kV)	4.0KV
Overvoltage category	III
Pollution degree	2

NOTE1: 1. Rated voltage/current : 300V / 15A

2. Withstanding voltage : AC1600V/1Min.

UL Standard

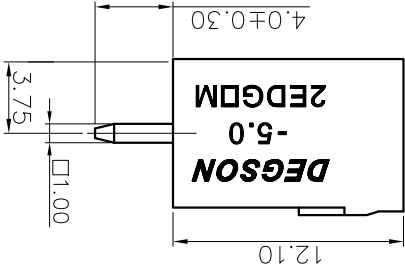

1 2 3 4 5 6 7 8

A B C D E F G H

X-ON Electronics

Largest Supplier of Electrical and Electronic Components

Click to view similar products for [Pluggable Terminal Blocks](#) category:

Click to view products by [Degson](#) manufacturer:

Other Similar products are found below :

[57.404.7553](#) [57.504.0053.7](#) [57.510.0053](#) [57.910.6153](#) [01.112.1453](#) [CTB932VE/6](#) [MC 1.5/ 6-ST-3.5 GY AU](#) [ET02015000J0G](#) [734-104](#) [734-302](#) [734-304](#) [8-141-P](#) [FKCT 2.5/ 3-ST KMGY](#) [860505](#) [860508](#) [860516](#) [860810](#) [861908](#) [GBPACX-12](#) [93.731.4953.0](#) [PV05-5,08-K](#) [PVP02-5,00](#) [PVP04-3,50](#) [PVS02-5,00](#) [1-1986160-3](#) [H-10](#) [1546228-5](#) [ELFH09150](#) [ELFH16150](#) [ELFP03110](#) [ELFT06250](#) [ELFT07250](#) [ELVF09400](#) [ELVP03100](#) [ELXH03100](#) [ELXH071G0E](#) [ELXP041G0](#) [ELXT046G0](#) [1700101](#) [1700410](#) [1700425](#) [1703176](#) [1705229](#) [1710175](#) [1714537](#) [1717806](#) [1719600](#) [1729386](#) [1734692](#) [1734795](#)