

REVISION RECORD			
REV	ECN	DESCRIPTION	DRFT DATE

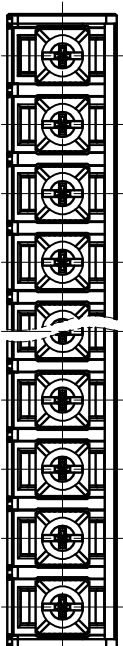

(Without Cover)

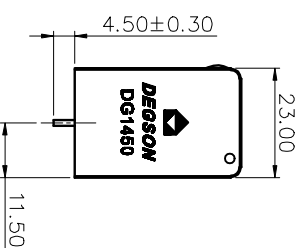
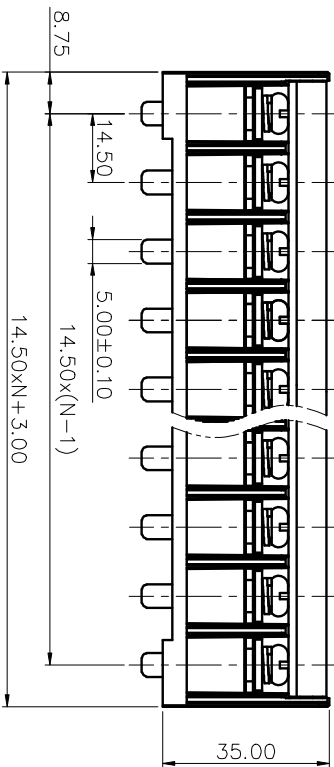
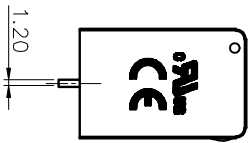

NOTES2:

- NOTE1:
 UL Standard
 1. Rated voltage/current : 300V / 50A
 2. Torque value : M5 , 17.54Lb.in
 3. Wire range : 22~8AWG

- NOTE2:
 1. Dimension shall be interpreted per ASME Y14.5-2009
 2. Pitch : 14.50mm, Poles : N=02~14P
 3. Stripping length : 12~15mm
 4. Withstanding voltage : AC1600V/1Min
 5. Operating temperature: -40C~+120C
 6. Undimensioned tolerances:

Pitch range	mm		in		Nominal dimension range		- /	D
	Over	Tolerance	Over	Tolerance	Over	Tolerance		
6	±0.15	±0.20	±0.30	±0.50	±0.70	±1.00	±1.30	±2
10	±0.10	±0.10	±0.30	±0.60	±1.00	±1.50	±2.00	±2
24	±0.10	±0.10	±0.30	±0.60	±1.00	±1.50	±2.00	±2

7. RoHS Compliance

DG1450-B - XYP - 1Y - 10A (H)
 (RoHS)
 10A - (Customer Request)
 (Series No.) (Poles) (Single Pitch) (Color) : 1. (Grey)
 2. (Blue)
 3. (Black)
 4. (Green)
 5. (Orange)
 6. (Red)
 7. (Transparent)
 8. (Yellow)
 9. (White)

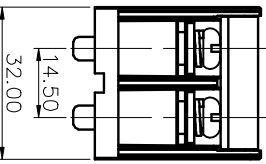
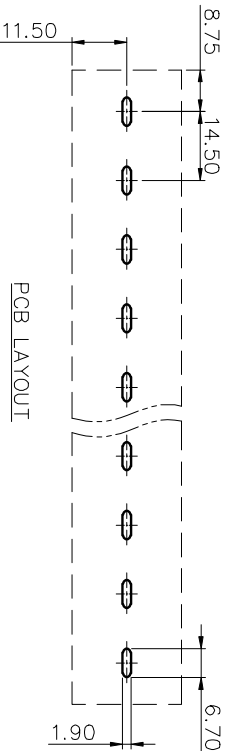

DETACHED LISTS	
PART NO.:	/
APPD:	
CHKD:	
DRFT:	/
THIRD ANGLE PROJECTION	
NAME:	DESSON 宁波德森电子有限公司 NINGBO DESSON ELECTRICAL CO., LTD
TITLE:	CUSTOMER DRAWING
DRAWING NO.:	/
REV	DO
SHEET	1/1
SCALE	1:1



X-ON Electronics

Largest Supplier of Electrical and Electronic Components

Click to view similar products for [Pluggable Terminal Blocks](#) category:

Click to view products by [Degson](#) manufacturer:

Other Similar products are found below :

[57.404.7553](#) [57.504.0053.7](#) [57.510.0053](#) [57.910.6153](#) [01.112.1453](#) [CTB932VE/6](#) [MC 1.5/ 6-ST-3.5 GY AU](#) [ET02015000J0G](#) [734-104](#) [734-302](#) [734-304](#) [8-141-P](#) [FKCT 2.5/ 3-ST KMGY](#) [860505](#) [860508](#) [860516](#) [860810](#) [861908](#) [GBPACX-12](#) [93.731.4953.0](#) [PV05-5,08-K](#) [PVP02-5,00](#) [PVP04-3,50](#) [PVS02-5,00](#) [1-1986160-3](#) [H-10](#) [1546228-5](#) [ELFH09150](#) [ELFH16150](#) [ELFP03110](#) [ELFT06250](#) [ELFT07250](#) [ELVF09400](#) [ELVP03100](#) [ELXH03100](#) [ELXH071G0E](#) [ELXP041G0](#) [ELXT046G0](#) [1700101](#) [1700410](#) [1700425](#) [1703176](#) [1705229](#) [1710175](#) [1714537](#) [1717806](#) [1719600](#) [1729386](#) [1734692](#) [1734795](#)