

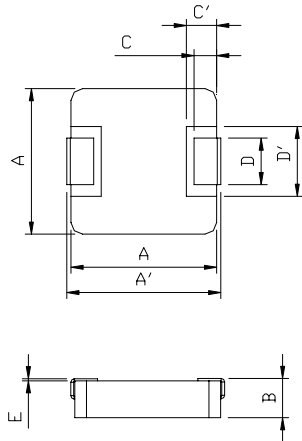

DELTA P/N : MPT750-H1 Series

Mechanical dimensions



Unit : mm	
A'	7.05 ± 0.35
A	6.6 ± 0.2
B	4.8 ± 0.2
C	1.6 ± 0.3
C'	2.0 ± 0.1
D	3.0 ± 0.3
D'	3.6 ± 0.2
E	0~0.15
F	3.5
G	3.7
H	8.4

Electrical Characteristics

Part No.	Lo @0A (uH) ± 20%	Ir(Adc)	Isat(Adc)	DCR (mΩ)	
				TYP.	MAX
MPT750-R13H1	0.13	42.0	48.0	1.0	1.2
MPT750-R22H1	0.22	30.0	35.0	1.1	1.3
MPT750-R36H1	0.36	21.0	25.0	3.2	3.5
MPT750-R40H1	0.4	20.0	23.0	3.2	3.5
MPT750-R47H1	0.47	20.0	21.0	3.25	3.75
MPT750-R56H1	0.56	20.0	18.0	3.4	3.6
MPT750-R68H1	0.68	18.0	16.0	3.9	4.2
MPT750-R82H1	0.82	16.5	17.0	4.6	4.9
MPT750-1R0H1	1.0	13.0	15.0	5.6	6.5
MPT750-1R2H1	1.2	12.0	13.0	6.0	7.5
MPT750-1R5H1	1.5	11.0	12.0	6.0	7.5
MPT750-2R2H1	2.2	10.5	12.0	11.2	12.5
MPT750-3R3H1	3.3	8.5	9.0	19.9	20.9
MPT750-4R7H1	4.7	6.5	7.0	23.0	25.0
MPT750-5R6H1	5.6	6.0	7.0	31.5	34.4
MPT750-6R8H1	6.8	5.5	6.0	36.5	41.0
MPT750-8R2H1	8.2	5.5	5.5	40.0	43.0
MPT750-100H1	10.0	4.5	5.3	48.0	55.0
MPT750-150H1	15.0	3.1	3.4	110.0	127.0
MPT750-220H1	22.0	2.6	2.8	165.0	190.0

NOTES:

- (1) All test data is referenced to 25°C ambient.
- (2) Ir is the DC current which cause the surface temperature of the part increase approximate 40°C
- (3) Isat is the DC current which cause the inductance drop approximate 30% of Lo.
- (4) Operating temperature range -55°C to 125°C. (The part temperature should be kepted under 125°C when the worse operating condition apply on it. Circuit design, component placement, PWB tracesize and thickness, airflow and other cooling provision may affect the part temperature. Part temperature should be verified in the end application.)
- (5) The rated current is depended on Ir and Isat which one is lower.

X-ON Electronics

Largest Supplier of Electrical and Electronic Components

Click to view similar products for [Fixed Inductors](#) category:

Click to view products by [Delta](#) manufacturer:

Other Similar products are found below :

[MLZ1608M6R8WTD25](#) [MLZ1608N6R8LT000](#) [MLZ1608N3R3LTD25](#) [MLZ1608N3R3LT000](#) [MLZ1608N150LT000](#)

[MLZ1608M150WTD25](#) [MLZ1608M3R3WTD25](#) [MLZ1608M3R3WT000](#) [MLZ1608M150WT000](#) [MLZ1608A1R5WT000](#)

[MLZ1608N1R5LT000](#) [B82432C1333K000](#) [PCMB053T-1R0MS](#) [PCMB053T-1R5MS](#) [PCMB104T-1R5MS](#) [CR32NP-100KC](#) [CR32NP-](#)

[151KC](#) [CR32NP-180KC](#) [CR32NP-181KC](#) [CR32NP-1R5MC](#) [CR32NP-390KC](#) [CR32NP-3R9MC](#) [CR32NP-680KC](#) [CR32NP-820KC](#)

[CR32NP-8R2MC](#) [CR43NP-390KC](#) [CR43NP-560KC](#) [CR43NP-680KC](#) [CR54NP-181KC](#) [CR54NP-470LC](#) [CR54NP-820KC](#) [CR54NP-8R5MC](#)

[MGDQ4-00004-P](#) [MGDU1-00016-P](#) [MHL1ECTTP18NJ](#) [MHL1JCTTD12NJ](#) [PE-51506NL](#) [PE-53601NL](#) [PE-53630NL](#) [PE-53824SNLT](#) [PE-](#)

[62892NL](#) [PE-92100NL](#) [PG0434.801NLT](#) [PG0936.113NLT](#) [PM06-2N7](#) [PM06-39NJ](#) [HC2LP-R47-R](#) [HC2-R47-R](#) [HC3-2R2-R](#) [HC8-1R2-R](#)