

# Dialight

## 521 SERIES 5mm Discrete LED 3 Leded, Non-Tinted, Diffused BI-COLOR

PART NUMBER	LED COLOR
521-9450	RED/GREEN
521-9461	YELLOW/GREEN

### SPECIFICATIONS

#### 521-9450

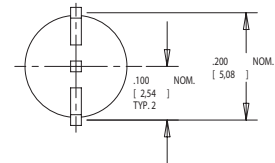
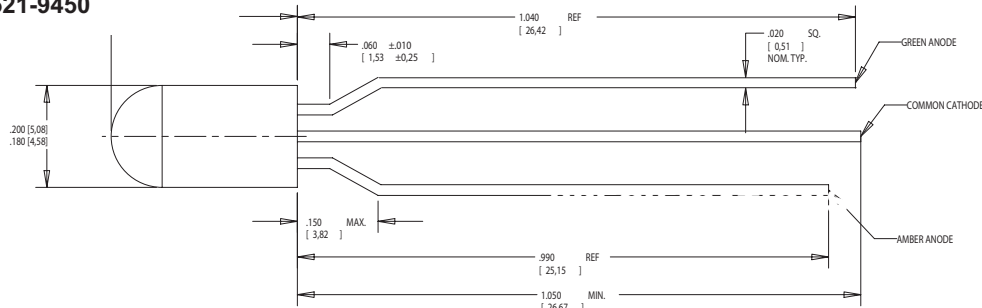

#### 521-9461

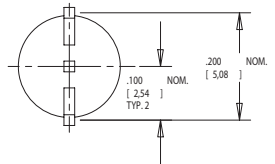
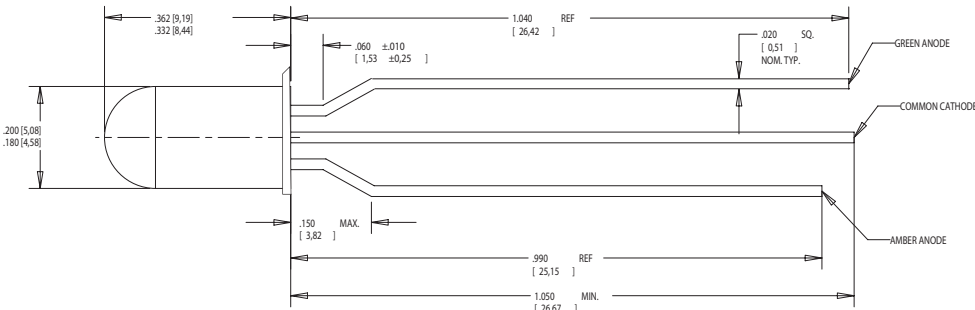

### ABSOLUTE MAXIMUM RATINGS (T<sub>A</sub> = 25°C)

Power Dissipation (mW):	135/135	Operating Temperature (°C):	-20/+85
Average Forward Current (mA):	25/25	Storage Temperature (°C):	-55/+85
Derating (mA/°C) From 50°C	.5/.5	Soldering Temperature:	260°C, 5 seconds, 1.6 mm from case
Peak Current (mA):	90/90		

### OPERATING CHARACTERISTICS (T<sub>A</sub> = 25°C)

Part Number	Color	Peak Wavelength (nm)	Luminous Intensity (mcd)	Forward Voltage (V)*	Viewing Angle 2θ 1/2
521-9450	Red/Green	635/565	Min. 2.1/4.2 Typ. 5/8	Typ. 2.1/2.3 Max. 2.5/2.7	65°
521-9461	Yellow/Green	583/565	Min. 2.1/4.2 Typ. 5/8	Typ. 2.1/2.1 Max. 2.5/2.5	65°

\*I<sub>F</sub> = 10mA



Dialight Corporation

1501 Route 34 South • Farmingdale, NJ 07727 USA

Tel: (1) 732-919-3119 • Fax: (1) 732-751-5778 • www.dialight.com



a Roxboro Group Company

MDEA521X001\_A

## X-ON Electronics

Largest Supplier of Electrical and Electronic Components

*Click to view similar products for [Standard LEDs - Through Hole category](#):*

*Click to view products by [Dialight manufacturer](#):*

Other Similar products are found below :

[LTL-10254W](#) [LTL-1214A](#) [LTL-2231AT](#) [LTL-3251A](#) [LTL-4262N](#) [LTL-433P](#) [LTL-5234](#) [LTL87HTBK](#) [LTL-87HD4B](#) [HLMP-EL30-PS0DD](#) [1L0532V23G0TD001](#) [NSPW500CS](#) [LD CQDP-1U3U-W5-1-K](#) [LP379PPG1C0G0300001](#) [SLR-342MC3F](#) [SLX-LX3044GD](#) [SLX-LX3044ID](#) [SLX-LX3044YD](#) [1.90690.3330000](#) [SSS-LX4673ID-410B](#) [1L0532Y24I0TD001](#) [264-7SYGD/S530-E2](#) [HLMP-1301-G00FG](#) [HLMP1385](#) [LTL-10224W](#) [LTL-1224A](#) [LTL-1234A](#) [LTL-2251AT](#) [LTL-403HR](#) [LTL-4222](#) [LU7-E-B](#) [4380H1](#) [HLMP-3962-F0002](#) [HLMP-GG15-R0000](#) [L53SRC/E-Z](#) [L-7679C1ZGC](#) [4302T1-5V](#) [4306D23](#) [4363D1/5](#) [WP1503SRC/J4](#) [WP153YDT](#) [WP1543SGC](#) [WP1543SRC/D](#) [WP1543SURC](#) [WP53MGD](#) [WP7113HD](#) [WP7113MBD](#) [WP7113MGC](#) [WP7143SEC/H](#) [Z-221A](#)