



513 SERIES SWITCHES

Caps Ordered Separately See Page 24.

MOMENTARY, SNAP ACTION
5 AMP-RESISTIVE; 2 AMP-INDUCTIVE; 125VAC/30VDC

Uses:
T-1 3/4 MIDGET
FLANGE BASE
INCANDESCENT LAMP

PART NO.	ACCEPTS CAP SIZE	CONTACT CIRCUIT	FIG
513-1601-604	ALL	SPDT	1
513-1606-001	5/8" SQ.	SPDT	2
513-1611-001	3/4" SQ.	SPDT	3
513-1701-604	ALL	TWO CIRCUIT	1
513-1706-001	5/8" SQ.	TWO CIRCUIT	2
513-1711-001	3/4" SQ.	TWO CIRCUIT	3

SIDE VIEW

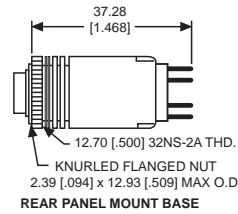

FRONT VIEW



FIG 1

MOUNTING HOLE

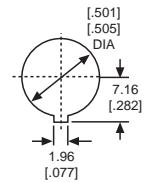

MOMENTARY ACTION
3 AMP; 125VAC/30VDC; GOLD PLATED CONTACT

PART NO.	ACCEPTS CAP SIZE	CONTACT CIRCUIT	FIG
513-0101-604	ALL	SPST N.O.	1
513-0106-001	5/8" SQ.	SPST N.O.	2
513-0109-001	3/4" X 1"	SPST N.O.	4
513-0110-001	3/4" X 1"	SPST N.O.	5
513-0111-001	3/4" SQ.	SPST N.O.	3
513-0301-604	ALL	TWO CIRCUIT	1
513-0306-001	5/8" SQ.	TWO CIRCUIT	2
513-0309-001	3/4" X 1"	TWO CIRCUIT	4
513-0310-001	3/4" X 1"	TWO CIRCUIT	5
513-0311-001	3/4" SQ.	TWO CIRCUIT	3

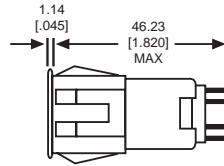

FIG 2

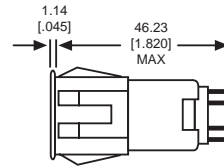

FIG 3

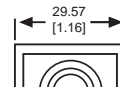
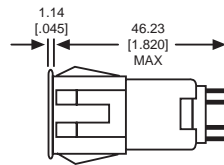
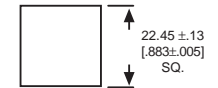

FIG 4

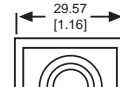
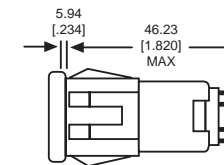
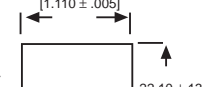

FIG 5

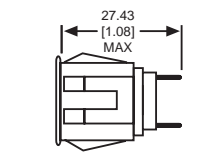
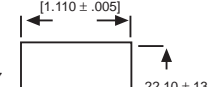

Fig. 6

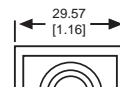
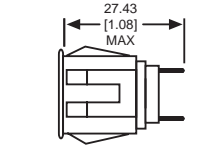
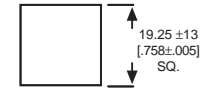

Fig. 7

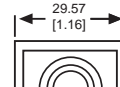
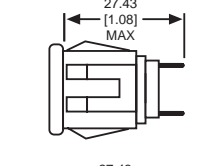
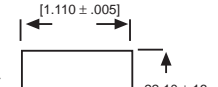

Fig. 8

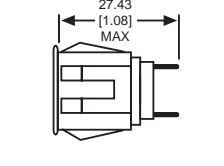
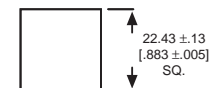

Fig. 9



MOMENTARY ACTION
5 TO 100 mA; 3 TO 12VDC; HEAVY GOLD PLATING

PART NO.	ACCEPTS CAP SIZE	CONTACT CIRCUIT	FIG
513-0601-604	ALL	TWO CIRCUIT	1
513-0606-001	5/8" SQ.	TWO CIRCUIT	2

ALTERNATE ACTION
5 AMP-RESISTIVE; 2 AMP-INDUCTIVE; 125VAC/30VDC

PART NO.	ACCEPTS CAP SIZE	CONTACT CIRCUIT	FIG
513-1401-604*	ALL	SPDT	1
513-1406-001**	5/8" SQ.	SPDT	2
513-1409-001**	3/4" X 1"	SPDT	4
513-1411-001**	3/4" SQ.	SPDT	3
513-1501-604*	ALL	TWO CIRCUIT	1
513-1506-001**	5/8" SQ.	TWO CIRCUIT	2
513-1511-001**	3/4" SQ.	TWO CIRCUIT	3

* Add 12.7 (.500) to length dimension
** Add 13.08 (.515) to length dimension

533 SERIES INDICATORS

PART NO.	ACCEPTS CAP SIZE	FIG
533-0601	5/8" SQ.	6
533-0901	3/4" X 1"	7
533-1001 (w/built-in barrier)	3/4" X 1"	8
533-1101	3/4" SQ.	9

Material & Finish: Base, Clear anodized aluminum;
Bezel, Heat resistant black plastic.

Neon and incandescent lamp information on Pages 35 and 36.

Dimensions in mm [inches]



X-ON Electronics

Largest Supplier of Electrical and Electronic Components

Click to view similar products for [Lamp Lenses](#) category:

Click to view products by [Dialight](#) manufacturer:

Other Similar products are found below :

[812-0974](#) [140-1475-003](#) [151-2900-200](#) [199-5261](#) [221-1131-203](#) [222-0113-303](#) [222-0135-203](#) [270-0121](#) [221-1132-203](#) [222-0135-303](#)
[22872.9](#) [39-02-4A](#) [39-02-6A](#) [39-08-3A](#) [39-08-4A](#) [39-12-1A](#) [D38999/20ZA98SA](#) [359-8430-0932-502-327](#) [39-02-3A](#) [39-12-2A](#) [39-12-7B](#)
[402-0172-100](#) [402-0175-100](#) [053-0992](#) [053-0993](#) [053-0994](#) [091-0931](#) [091-0971](#) [091-0932](#) [101-0974](#) [103-1233-403](#) [533-0001](#) [533-0601](#)
[534-0701-537](#) [270-0212](#) [359-8430-0932-502](#) [0190535300](#) [0510113303](#) [39-06-2A](#) [199-5263](#) [241-0001-804](#) [830-1432-003](#) [39-08-7A](#) [271-](#)
[0171](#) [047-2900-400](#) [39-04-4B](#) [1813/8](#) [R14-13](#) [BF2.4/RC](#) [128-0931-003](#) [FCP-M1-XPE1-HRF](#)