

Dialight

586 Series SINGLE CHIP BASED LED T1 3/4 WEDGE (T5)



FEATURES / BENEFITS

- ▲ RoHS Compliant
- ▲ High brightness with low current draw - uses up to 90% less energy than incandescent
- ▲ Long Life - up to 100K hours
- ▲ No heat generated
- ▲ Mounts directly into industry standard socket
- ▲ Resistant to shock and vibration
- ▲ Incorporating AlInGaP and InGaN technology
- ▲ Wide 100 degree viewing angle
- ▲ Colors include red, green, yellow, blue, and white

Dialight's line of based LED lamps is designed to directly replace many popular subminiature and miniature incandescent lamps. The benefits of LED technology over incandescent are significant: They offer long life, are shock resistant, withstand vibration and provide energy conservation.

SPECIFICATIONS

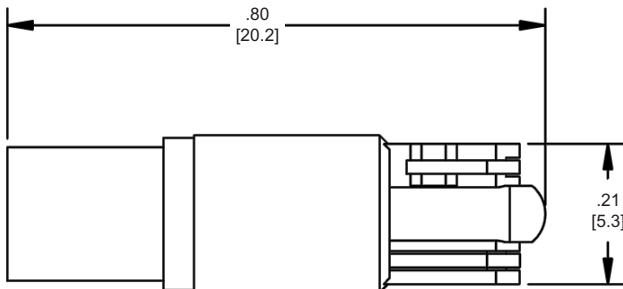

Measurements are typical
Dimensions are inches [mm]

- ▲ Operating Voltages: 6, 14 and 28 VDC
- ▲ Operating temperature: -40°C to +80°C
- ▲ Storage temperature: -40°C to +100°C
- ▲ Replaces incandescent lamp numbers*: 79, 16, 84, 86, 18, 37, 70, 73, 74, 17, 85

* See Dialight's Incandescent lamp/based LED cross reference guide for a complete listing

CONSIDERATIONS

- ▲ Since lens caps act as filters for the light emitted from the based LED, it is important to match the emitting color of the LED. If not matched properly, the overall light output may be substantially reduced. Dialight recommends using transparent lenses which will optimize the light output.
- ▲ Although these lamps can be operated at a lower voltage, which will increase the life, the intensity will be reduced.
- ▲ Operation of the based LED at a higher voltage should not exceed 10% above the recommended voltage.
- ▲ Dialight does not recommend that based LED lamps be used in neon sockets.

Dialight reserves the right to make changes at any time in order to supply the best product possible.

Dialight Corporation

1501 Route 34 South • Farmingdale, NJ 07727 USA

Tel: (1) 732-919-3119 • Fax: (1) 732-751-5778 • www.dialight.com



MDEL586T5001_C



T1 3/4 WEDGE (T5) POLARIZED

Part Number	Color	Dominant Wavelength (TYP- nm)	Nominal Voltage (VDC)	Forward Current TYP-(mA)	Intensity TYP-(mcd)	RoHS Compliant
586-1A01-101F	Red	630	6	16	775	✓
586-1A02-101F	Green	526	6	16	600	✓
586-1A03-101F	Yellow	592	6	16	775	✓
586-1A04-101F	Orange	615	6	16	775	✓
586-1A05-101F	Blue	472	6	16	165	✓
586-1A06-101F	White	*	6	16	460	✓
586-1A01-103F	Red	630	14	16	775	✓
586-1A02-103F	Green	526	14	16	600	✓
586-1A03-103F	Yellow	592	14	16	775	✓
586-1A04-103F	Orange	615	14	16	775	✓
586-1A05-103F	Blue	472	14	16	165	✓
586-1A06-103F	White	*	14	16	460	✓
586-1A01-105F	Red	630	28	16	775	✓
586-1A02-105F	Green	526	28	16	600	✓
586-1A03-105F	Yellow	592	28	16	775	✓
586-1A04-105F	Orange	615	28	16	775	✓
586-1A05-105F	Blue	472	28	16	165	✓
586-1A06-105F	White	*	28	16	460	✓

* Color Coordinates: x = 0.32, y = 0.32

Based LEDs SELECTION

With the technological advancements in Light Emitting Diodes (LEDs) brightness can now rival the incandescent lamp when used in similar packages. These advancements have created a new type of product called the based LED - an LED with the functionality of an incandescent bulb.

The following styles are currently available in red, green, yellow, blue and white:

- ▲ T1 3/4 Midget Flange ▲ T1 3/4 Bi-Pin ▲ T1 3/4 Wedge (T5) ▲ T2 Telephone Slide
- ▲ T3 1/4 Miniature Bayonet (BA9s) ▲ T3 1/4 Miniature Screw (E10) ▲ T3 1/4 Wedge (T10) ▲ 15mm SC Bayonet (BA15s)

Dialight's line of based LEDs continues to grow. Please visit our website for more information.

www.dialight.com

Dialight reserves the right to make changes at any time in order to supply the best product possible.

Dialight Corporation

1501 Route 34 South • Farmingdale, NJ 07727 USA

Tel: (1) 732-919-3119 • Fax: (1) 732-751-5778 • www.dialight.com



MDEL586T5001_C

X-ON Electronics

Largest Supplier of Electrical and Electronic Components

Click to view similar products for [LED Replacement Lamps - Based LEDs](#) category:

Click to view products by [Dialight](#) manufacturer:

Other Similar products are found below :

[LAPD-1A](#) [LAPD-1R](#) [LAPD-2R](#) [LAPD-6W](#) [LSTD-M4S](#) [SSP-1156B153S12](#) [SSP-1157B156U12](#) [SSP-LXS110818BA](#) [560-0101F](#) [560-0103F](#)
[LAPD-1W](#) [LAPD-6R](#) [560-0104F](#) [585-1113](#) [SSP-LXC1283S24](#) [SSP-3MB96U12G](#) [SLL-05EY](#) [1.90.690.684/0000](#) [560-0203F](#) [586-2206-](#)
[205F](#) [SSP-LXS1826U16A](#) [LATD-2JW](#) [24LS4-G1](#) [24LS4-R1](#) [MF200-NFW5H](#) [MB403-W60-CW-BP](#) [387LP-A](#) [1819LS2-G-CG](#) [387LP-R](#)
[387LP-B](#) [387LP-W](#) [387LP-G](#) [6S6LS155-CWR](#) [130MBLS-G-CG](#) [5000404LAMP](#) [E10SB12A](#) [E10SB130A](#) [E10SB24A](#) [E10SG12A](#)
[E10SG130A](#) [E10SG24A](#) [E10SR12A](#) [E10SR130A](#) [E10SR24A](#) [E10SW12A](#) [E10SY12A](#) [E10SY130A](#) [585-1425F](#) [521-9208F](#) [586-0012-806F](#)