



## Certifications & Ratings

- RoHS compliant

## Application

The 608 Series LED Panel Mount Indicators are designed for a variety of applications such as.

- Main power indication
  - Remote power indication
  - Status indication
  - Maintenance and warning indication
  - Instrumentation
- ... and many more!

## Dimensions

inches [mm]

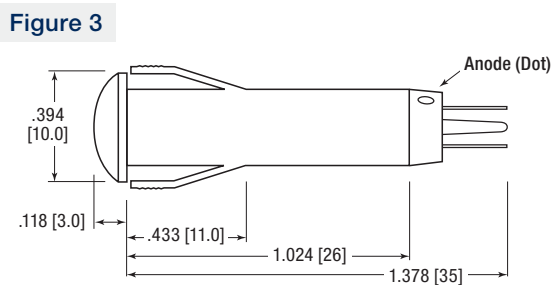
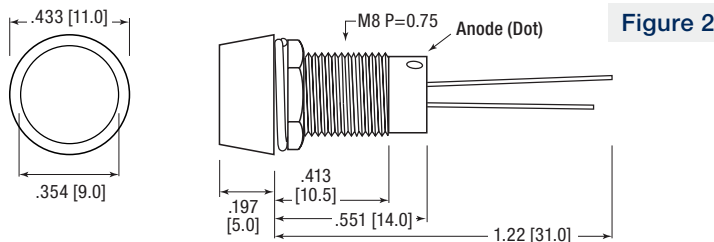
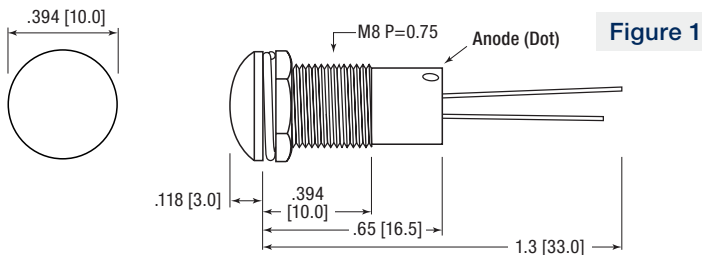
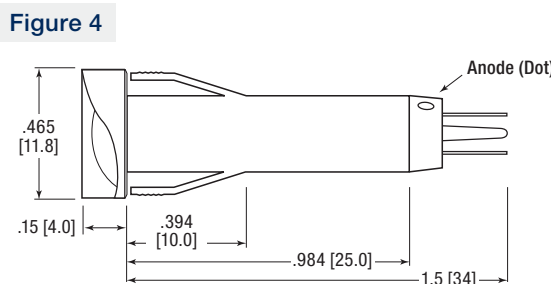
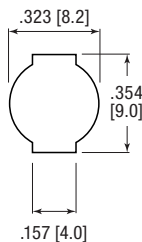

Fig 3 & 4  
Mounting Hole



## Mechanical Information

**Mounting Hole Size:** 0.323" (8.2 mm) (Fig. 1 & 2),  
Snap-Fit see Fig. 3 & 4

**Max Panel Thickness:** See part numbers

**Mounting Torque:** 0.217 lbs/ft or 3 kg/cm (Fig. 1 & 2 only)

## Specifications

**Voltage Options:** 2 VDC (resistor required)  
6, 12 & 24 VDC (no resistor required)

**Operating Temp:** -25 °C to +85 °C (-13 °F to +185 °F)

**Storage Temp:** -25 °C to +85 °C (-13 °F to +185 °F)

**Electrical Connection:** Leads (Fig. 1 & 2),  
Solder terminals (Fig. 3 & 4)

**Housing:** Polycarbonate

**Terminals:** Copper — Nickel Plated

**Lock Washer:** Iron — Nickel Plated

**Nut:** Brass — Nickel Plated

## Ordering Information 608 Series

Part Number	Color	Voltage (V DC)	Current (mA)	Typical Intensity (mcd)	Lens Shape	Figure	Panel Thickness
-------------	-------	----------------	--------------	-------------------------	------------	--------	-----------------

### Lock Washer & Nut

608-1131-110F	● Red	2	15	25	Domed	1	0.236" (6 mm)
608-1231-110F	● Green			30			
608-1331-110F	● Yellow			15			
608-3131-110F	● Red			25	Flat	2	
608-3231-110F	● Green			30			
608-3331-110F	● Yellow			15			

### Snap-Fit

608-1132-220F	● Red	6	15	75	Domed	3	0.197" (5 mm)
608-1232-220F	● Green			140			
608-1332-220F	● Yellow			120			
608-1132-230F	● Red	12		75			
608-1232-230F	● Green			140			
608-1332-230F	● Yellow			120			
608-1132-240F	● Red	24		75	Flat	4	
608-1232-240F	● Green			140			
608-1332-240F	● Yellow			120			
608-2132-220F	● Red	6		75			
608-2232-220F	● Green			130			
608-2332-220F	● Yellow			115			
608-2132-230F	● Red	12		75			
608-2232-230F	● Green			130			
608-2332-230F	● Yellow			115			
608-2132-240F	● Red	24	75				
608-2232-240F	● Green		130				
608-2332-240F	● Yellow		115				

Dialight reserves the right to make changes at any time in order to supply the best product possible. The most current version of this document will always be available at: [www.dialightsignalsandcomponents.com](http://www.dialightsignalsandcomponents.com)

**Warranty Statement:** Except for the warranty expressly provided for [herein/above/below], Dialight disclaims any and all other warranties, express or implied, including, without limitation, any warranties of merchantability, fitness for a particular purpose, title, and noninfringement.

## X-ON Electronics

Largest Supplier of Electrical and Electronic Components

*Click to view similar products for [LED Panel Mount Indicators](#) category:*

*Click to view products by [Dialight](#) manufacturer:*

Other Similar products are found below :

[607-3232-140F](#) [821-0331-503](#) [FL2870C8R](#) [FL2950WL7B](#) [FL2950WL8G](#) [FL589WL8R](#) [FL67C8R](#) [H8630FBBA3](#) [NL177WL2A](#)  
[NL177WL3G](#) [NL276C2A](#) [NL2950BWL3G](#) [NL589WL2R](#) [NL67C2C](#) [NL67C3R](#) [C480AABG3](#) [L32R-R2-2311](#) [L3353-MWRG](#) [L39UR-R24-2111](#) [L58D-G2-W](#) [L58D-Y2-W](#) [L59D-R12-W](#) [L59UD-R12-W](#) [L625DG](#) [L625DR](#) [LE177WL39007](#) [LE2950BWL39018](#) [LH1048BSWL3702](#)  
[LH1048BWL3702](#) [LH382A](#) [LH677G](#) [LHM628A](#) [FL276WL7R](#) [FL2950BWL7R](#) [FL2950WL7R](#) [FL2950WL8R](#) [FL2950WL8R-12](#)  
[FL2951WL8G](#) [FL2951WL8R](#) [FL589C7R](#) [FL67WL8G](#) [MPC5BCW18.0](#) [556-1605-808F](#) [556-1705-809F](#) [556-3008-839F](#) [558-0201-818F](#)  
[559-0001-813F](#) [559-1301-801F](#) [559-3501-804F](#) [VL1CK0P600](#)