



# Cixi Dibo Electronics Co.,LTD

产品规格书  
product specification

## 电气性能/Electrical

参考标准/Standard: UL IEC  
 额定电压/Rated voltage: 300V 250V  
 额定电流/Rated current: 8A 10A  
 接触电阻/Contact resistance: 20m $\Omega$

使用线径/Wire range: 28-16AWG 1.5mm<sup>2</sup>  
 耐电压/Withstanding voltage: AC2000V/1Min

绝缘电阻/Insulation resistance: 500M $\Omega$ /DC500V

## 机械性能/Mechanical

温度范围/Temp.Range: -40 $^{\circ}$ C<sup>+</sup>+105 $^{\circ}$ C  
 扭矩/Torque: 0.2Nm (1.71lb`in)

剥线长度/Strip length: 6-7mm

## 尺寸/Dimensions

间距/Pitch: 3.81mm/3.5mm

极数/Poles: 2P-24P

## 材料及电镀/Material

塑件/Housing: PA66 U94V-0  
 螺丝/Screws: M2, steel Zinc plated  
 方块/Wire guard: Brass, Ni plated  
 夹子/Clamp: Phosphor bronze, Ni plated

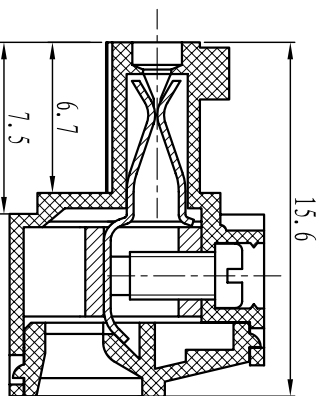
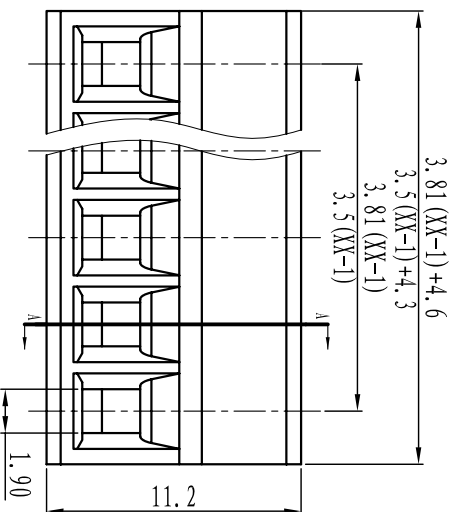

SECTION A-A

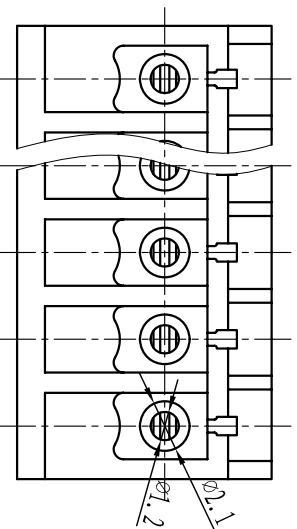

TOLERANCES EXCEPT AS NOTED

|                | linear dimension                     | fillet       | chamfer                          | short angle sid               | ≡                            | □      | //     | ⊥      |
|----------------|--------------------------------------|--------------|----------------------------------|-------------------------------|------------------------------|--------|--------|--------|
| variable range | 6 to 30<br>120 to 480                | all to 6     | 6 to 10<br>10 to 50<br>50 to 120 | 10 to 50<br>50 to 120         | all to 5<br>5 to 30          | to 120 | to 120 | to 120 |
| tolerance      | ±0.1 to ±0.2<br>±0.3 to ±0.5<br>±0.9 | ±0.2 to ±0.5 | ±1                               | 1 $^{\circ}$ to 30 $^{\circ}$ | 0.5 to 0.125<br>0.06 to 0.12 | 0.4    |        |        |

## 订购方式: HOW TO ORDER

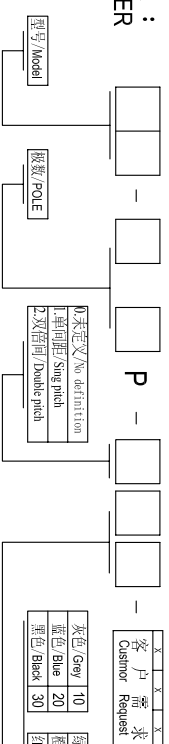

单位/UNITS mm 尺寸/SIZE A4 比例/SCALE

Cixi Dibo Electronics Co.,LTD

第一视角/FIRST ANGLE PROJECTION

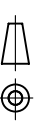

名称/NAME DB2EK-3.81/3.5

| 颜色/Color | 极数/Poles | 颜色/Color  | 极数/Poles | 颜色/Color       | 极数/Poles |
|----------|----------|-----------|----------|----------------|----------|
| 灰色/Gray  | 10       | 绿色/Green  | 40       | 透明/Transparent | 70       |
| 蓝色/Blue  | 20       | 橙色/Orange | 50       | 黄色/Yellow      | 80       |
| 黑色/Black | 30       | 红色/Red    | 60       | 白色/White       | 90       |

## X-ON Electronics

Largest Supplier of Electrical and Electronic Components

*Click to view similar products for [Pluggable Terminal Blocks](#) category:*

*Click to view products by [DIBO](#) manufacturer:*

Other Similar products are found below :

[57.404.7553](#) [57.504.0053.7](#) [57.510.0053](#) [57.910.6153](#) [01.112.1453](#) [CTB932VE/6](#) [MC 1.5/ 6-ST-3.5 GY AU](#) [ET02015000J0G](#) [734-104](#) [734-302](#) [734-304](#) [8-141-P](#) [FKCT 2.5/ 3-ST KMGY](#) [860505](#) [860508](#) [860516](#) [860810](#) [861908](#) [GBPACX-12](#) [93.731.4953.0](#) [PV05-5,08-K](#) [PVP02-5,00](#) [PVP04-3,50](#) [PVS02-5,00](#) [1-1986160-3](#) [H-10](#) [1546228-5](#) [ELFH09150](#) [ELFH16150](#) [ELFP03110](#) [ELFT06250](#) [ELFT07250](#) [ELVF09400](#) [ELVP03100](#) [ELXH03100](#) [ELXH071G0E](#) [ELXP041G0](#) [ELXT046G0](#) [1700101](#) [1700410](#) [1700425](#) [1703176](#) [1705229](#) [1710175](#) [1714537](#) [1717806](#) [1719600](#) [1729386](#) [1734692](#) [1734795](#)