



Cixi Dibo Electronics Co.,LTD

产品规格书
product specification

电气性能/Electrical
参考标准/Standard: UL IEC

额定电压/Rated voltage: 300V 320V
额定电流/Rated current: 15A 20A
接触电阻/Contact resistance: 20mΩ
耐电压/Withstanding voltage: AC2000V/1min
绝缘电阻/Insulation resistance: 500MΩ/DC500V

机械性能/Mechanical

温度范围/Temp.Range: -40°C~+105°C

瞬间温度/MAX Soldering: +250°C, for 5 Sec

尺寸/Dimensions

间距/Pitch: 5.00mm, 5.08mm

极数/Poles: 2P-24P

材质及电镀/Material

塑件/Housing: PA66,UL94V-0

焊针/Pin header: Brass, Tin plated

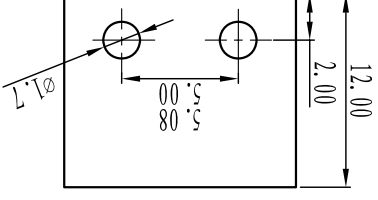
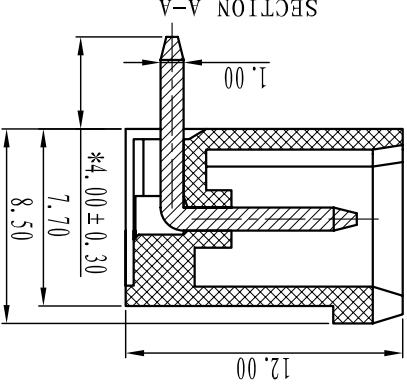

订购方式:
HOW TO ORDER:

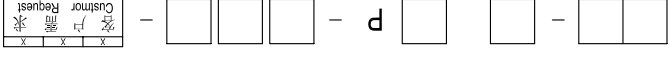

型号/Model	极数/POLE	0.未定义/No definition 1.单间距/Sing pitch 2.双间距/Double pitch
灰色/Gray 10	蓝色/Blue 20	黑色/Black 30
绿色/Green 40	橙色/Orange 50	红色/Red 60
黄色/Yellow 80	白色/White 90	透明/Transparent 70

客户请求 Customer Request
X X X X X

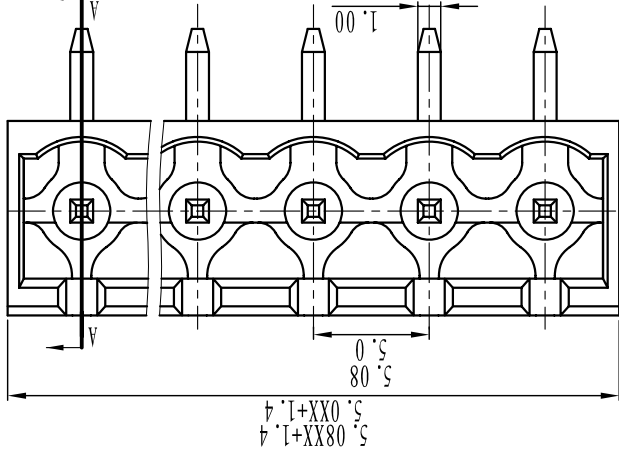

TOOLERANCES EXCEPT AS NOTED

linear dimension	filllet	chamfer	short angle sid	≡	—	□	//	L
tolerance	tolerance	tolerance	tolerance	tolerance	tolerance	tolerance	tolerance	tolerance
±0.1	±0.1	±0.2	±0.5	±1	1°	30'	20'	10'
to	to	to	to	to	to	to	to	to
6	6	6	6	6	6	6	6	6
over	over	over	over	over	over	over	over	over
to	to	to	to	to	to	to	to	to
30	30	30	30	30	30	30	30	30
to	to	to	to	to	to	to	to	to
120	120	120	120	120	120	120	120	120
over	over	over	over	over	over	over	over	over
to	to	to	to	to	to	to	to	to
5	5	5	5	5	5	5	5	5
to	to	to	to	to	to	to	to	to
0.06	0.06	0.06	0.06	0.06	0.06	0.06	0.06	0.06
0.12	0.12	0.12	0.12	0.12	0.12	0.12	0.12	0.12
0.4	0.4	0.4	0.4	0.4	0.4	0.4	0.4	0.4

单位/UNITS mm 尺寸/SIZE A4 比例/SCALE
Cixi Dibo Electronics Co.,LTD
名称/NAME DB2ERC-5.08
第一视角/FIRST ANGLE PROJECTION

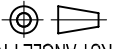

DB2ERC-5.08

X-ON Electronics

Largest Supplier of Electrical and Electronic Components

Click to view similar products for [Pluggable Terminal Blocks](#) category:

Click to view products by [DIBO](#) manufacturer:

Other Similar products are found below :

[57.404.7553](#) [57.504.0053.7](#) [57.510.0053](#) [57.910.6153](#) [01.112.1453](#) [CTB932VE/6](#) [MC 1.5/ 6-ST-3.5 GY AU](#) [ET02015000J0G](#) [734-104](#) [734-302](#) [734-304](#) [8-141-P](#) [FKCT 2.5/ 3-ST KMGY](#) [860505](#) [860508](#) [860516](#) [860810](#) [861908](#) [GBPACX-12](#) [93.731.4953.0](#) [PV05-5,08-K](#) [PVP02-5,00](#) [PVP04-3,50](#) [PVS02-5,00](#) [1-1986160-3](#) [H-10](#) [ELFH09150](#) [ELFH16150](#) [ELFP03110](#) [ELFT06250](#) [ELFT07250](#) [ELVF09400](#) [ELVP03100](#) [ELXH03100](#) [ELXH071G0E](#) [ELXP041G0](#) [ELXT046G0](#) [1700101](#) [1700410](#) [1700425](#) [1703176](#) [1703243](#) [1705229](#) [1710175](#) [1714537](#) [1717806](#) [1719600](#) [1729386](#) [1734692](#) [1734795](#)