

REVISION RECORD			
REV	ECN	DESCRIPTION	DATE
1			

NOTES1:

UL Standard  
 1. Rated voltage/current : 300V / 8A  
 2. Withstanding voltage : AC1600V/1min.

IEC Standard

1. Pollution Degree	2
Overvoltage Category	II
Rate Impulse Voltage(kV)	2.5kV
Rate Voltage(V)	250V
Rate Current(A)	7A

NOTES2:

1. Dimension shall be interpreted per ASME Y14.5-2009

2. Pitch : 3.5/3.81mm, Poles : N=02~22P

3. Operating temperature: -40°C~+105°C

4. Undimensioned tolerances:

Pitch range in mm	mm	mm	mm	mm	mm	mm	mm
Over	TO	Over	TO	Over	TO	Over	TO
0.1/10	6	0.1/10	6	0.1/10	6	0.1/10	6
150	100	150	100	150	100	150	100
Over	TO	Over	TO	Over	TO	Over	TO
±2.0	±0.30	±2.0	±0.30	±2.0	±0.30	±2.0	±0.30
±2.0	±0.30	±2.0	±0.30	±2.0	±0.30	±2.0	±0.30

5. RoHS Compliance

DB2ERM - 3.5/3.81 - XXP - 1Y - 00A (H)  
 (Series No.) (Pitch) (Poles) (Single Pitch) (Color): 1.(Grey)  
 2.(Blue) 3.(Black) 4.(Green) 5.(Orange) 6.(Red) 7.(Transparent) 8.(Yellow) 9.(White)

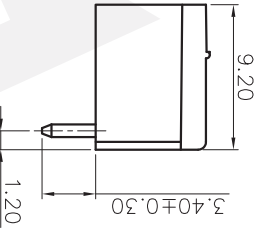

PART NO.:	CIXI DORABO ELECTRONICS CO.,LTD		
	DORABO 慈溪市地博电子有限公司		
NAME:	DB2ERM-3.5/3.81-XXP-1Y-00A(H)	APPD:	/
CHKD:	/	DRFT:	/
TITLE:	CUSTOMER DRAWING	REV	DO
DRAWING NO.:	/	SHEET	1/1
THIRD ANGLE PROJECTION	DO NOT SCALE DRAWING		
SCALE	1:1		

DETACHED LISTS

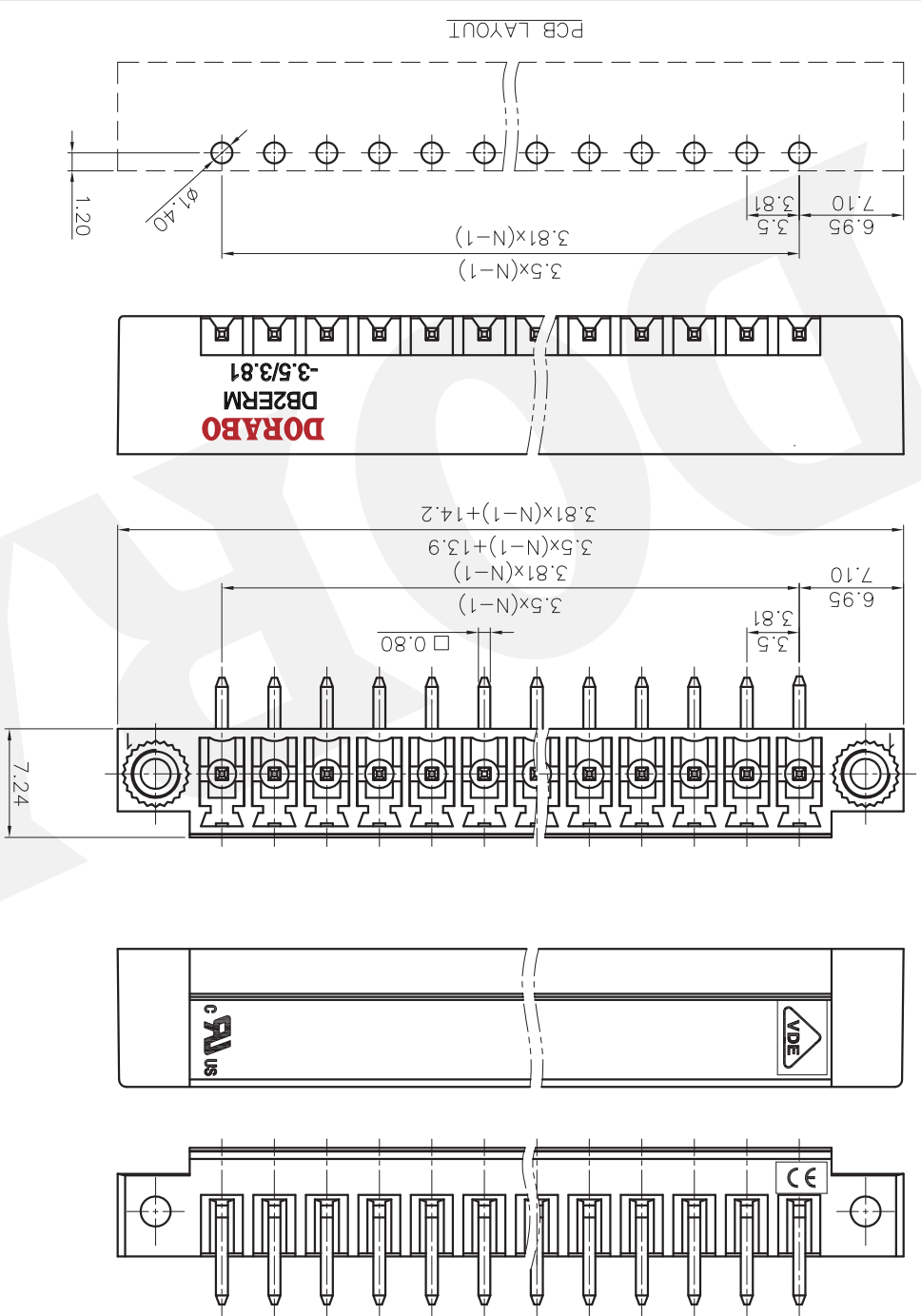

1 2 3 4 5 6 7 8

A B C D E F G H

## X-ON Electronics

Largest Supplier of Electrical and Electronic Components

*Click to view similar products for [Headers & Wire Housings](#) category:*

*Click to view products by [DIBO](#) manufacturer:*

Other Similar products are found below :

[95000-104TRLF](#) [10135584-644402LF](#) [DF62W-EP2022PCA](#) [95000-106TRLF](#) [DF62W-2022SCA](#) [DF62W-EP2022PC](#) [2203348](#) [DF62W-2022SC](#) [1084018](#) [1029039](#) [1084017](#) [802-10-012-10-002000](#) [1112640](#) [1112639](#) [891-007-9SS-BST1T](#) [000-34000](#) [0008550134](#) [0009482033](#) [0009507031](#) [57102-F02-18ULF](#) [57102-S06-03LF](#) [57202-S52-04LF](#) [PCN6-15S-2.5E](#) [0039019024](#) [58102-G61-06LF](#) [582553-1](#) [0009485154](#) [0009508121](#) [0022285053](#) [0050291907](#) [018731A](#) [LY20-4P-DT1-P1E-BR](#) [02.125.8002.8](#) [60101931](#) [60598-1 \(Cut Strip\)](#) [M1625-3R/100](#) [61062-3](#) [61082-181009](#) [CSU011177004](#) [636-1427](#) [638009-1](#) [641938-9](#) [641991-4](#) [644168-1](#) [644827-2](#) [647662-1](#) [65039-019ELF](#) [65692-001LF](#) [65781-018](#) [65781-047](#)