



Cixi Dibo Electronics Co., LTD

产品规格书
product specification

电气性能/Electrical

参考标准/Standard: UL IEC
 额定电压/Rated voltage: 300V 320V
 额定电流/Rated current: 15A 20A
 接触电阻/Contact resistance: 20mΩ

耐电压/Withstanding voltage: AC2000V/1Min

绝缘电阻/Insulation resistance: 500MΩ/DC500V

机械性能/Mechanical

温度范围/Temp.Range: -40° C~+105° C

瞬间温度/MAX Soldering: +250° C, for 5 Sec

尺寸/Dimensions

间距/Pitch: 5.00mm, 5.08mm

极数/Poles: 2P-24P

材料及电镀/Material

塑件/Housing: P166, UL94V-0

焊针/Pin header: Brass, Tin plated

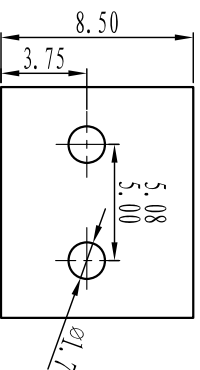
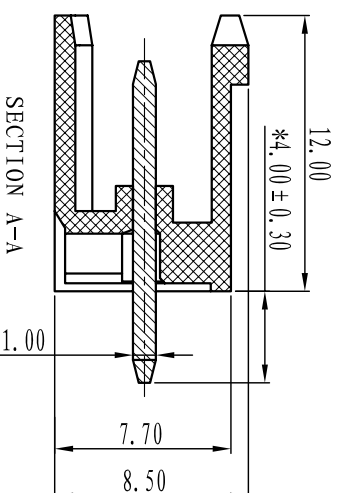
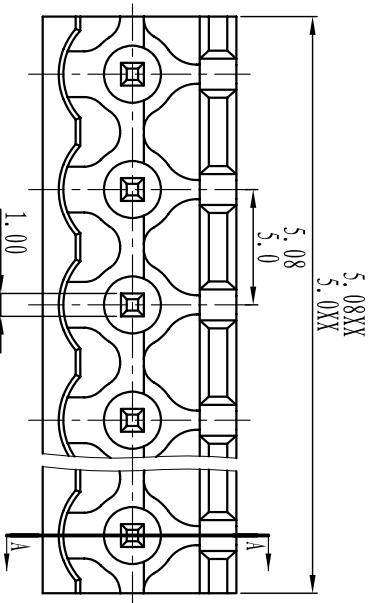

TOLERANCES EXCEPT AS NOTED

linear dimension	fillet	chamfer	short angle sid	≡	□	//	⊥
over 6 to 30	over 30 to 120	over 120 to 480	over 480 to all	over 6 to 10	over 50 to 120	over 120 to all	over 5 to 30
over 30 to 120	over 120 to 480	over 480 to all	over 6 to 10	over 50 to 120	over 120 to all	over 5 to 30	over 30 to 120
±0.1	±0.2	±0.3	±0.5	±0.9	±0.2	±0.5	±1
6	6	6	6	10	50	120	10
to 30	to 120	to 480	to all	to 10	to 50	to 120	to 10
tolerance	tolerance	tolerance	tolerance	tolerance	tolerance	tolerance	tolerance

订购方式：
HOW TO ORDER

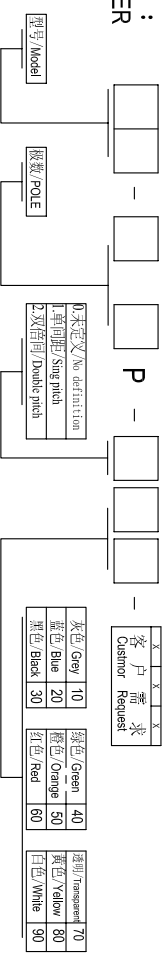

单座/UNITS mm 尺寸/SIZE A4 比例/SCALE 第一视角/FIRST ANGLE PROJECTION

Cixi Dibo Electronics Co., LTD

名称/NAME DB2EV-5.08/5.0



X-ON Electronics

Largest Supplier of Electrical and Electronic Components

Click to view similar products for [Pluggable Terminal Blocks](#) category:

Click to view products by [DIBO](#) manufacturer:

Other Similar products are found below :

[57.404.7553](#) [57.504.0053.7](#) [57.510.0053](#) [57.910.6153](#) [01.112.1453](#) [CTB932VE/6](#) [MC 1.5/ 6-ST-3.5 GY AU](#) [ET02015000J0G](#) [734-104](#) [734-302](#) [734-304](#) [8-141-P](#) [FKCT 2.5/ 3-ST KMGY](#) [860505](#) [860508](#) [860516](#) [860810](#) [861908](#) [GBPACX-12](#) [93.731.4953.0](#) [PV05-5,08-K](#) [PVP02-5,00](#) [PVP04-3,50](#) [PVS02-5,00](#) [1-1986160-3](#) [H-10](#) [ELFH09150](#) [ELFH16150](#) [ELFP03110](#) [ELFT06250](#) [ELFT07250](#) [ELVF09400](#) [ELVP03100](#) [ELXH03100](#) [ELXH071G0E](#) [ELXP041G0](#) [ELXT046G0](#) [1700101](#) [1700410](#) [1700425](#) [1703176](#) [1703243](#) [1705229](#) [1710175](#) [1714537](#) [1717806](#) [1719600](#) [1729386](#) [1734692](#) [1734795](#)