

# NDP series

Piano style • dual in line switches



## DISTINCTIVE FEATURES

2 to 12 Way

Self-cleaning wiping contacts

Gold plated terminals

Washable with tape seal



## ENVIRONMENTAL SPECIFICATIONS

- Operating Temperature: -20 °C to +70 °C (-4 °F to +158 °F)
- Storage Temperature: -40 °C to +85 °C (-40 °F to +185 °F)
- Washable (with tape seal)



## ELECTRICAL SPECIFICATIONS

- Max. Current/Voltage Rating:
  - Switching: 25 mA 24 VDC
  - Contact rating: 100 mA 50 VDC
- Initial Contact Resistance: 50 mΩ max
- Insulation Resistance: 100 MΩ min. at 500 VDC
- Dielectric Strength: 500 VAC min.
- Electrical Life: 2,000 cycles



## MECHANICAL SPECIFICATIONS

- Operating force: 400 gf (3.92 N) max



## MATERIALS

- Case & Actuator: PBT
- Base: PA66
- Contact: Gold plated
- Terminal: Gold plated brass
- Protection tape: Polyimide

The company reserves the right to change specifications without notice.

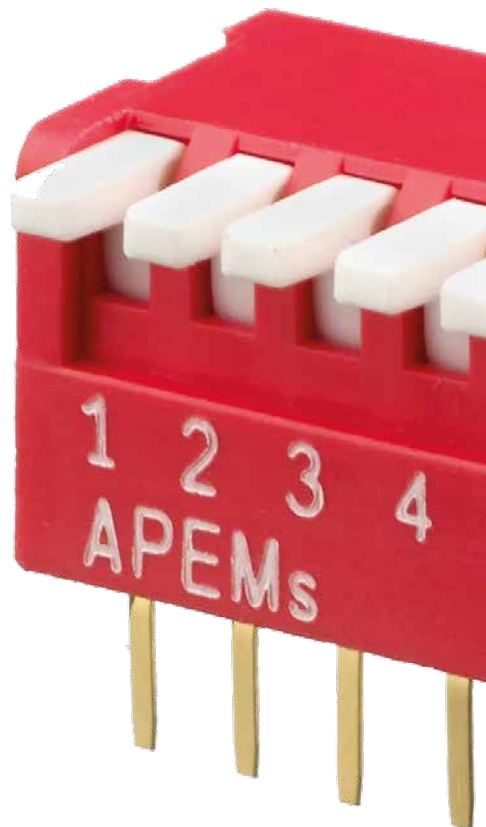
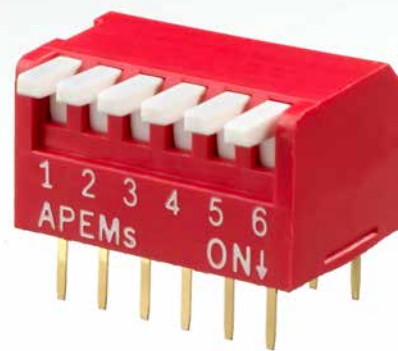

# NDP series

Piano style • dual in line switches



## PACKAGING

IC TUBE THROUGH-HOLE

Number of ways	No tape seal	With tape seal
2	70 pcs	65 pcs
3	50 pcs	49 pcs
4		39 pcs
5		32 pcs
6		27 pcs
7		24 pcs
8		21 pcs
9		19 pcs
10		17 pcs
12		14 pcs



## CIRCUIT

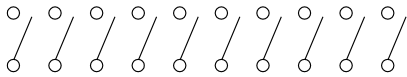

2,3,4,5,6,7,8,9,10,12 way only



## PCB LAYOUT

THROUGH-HOLE

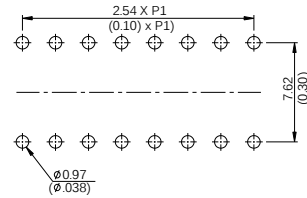

# NDP series

Piano style • dual in line switches



## BUILD YOUR PART NUMBER

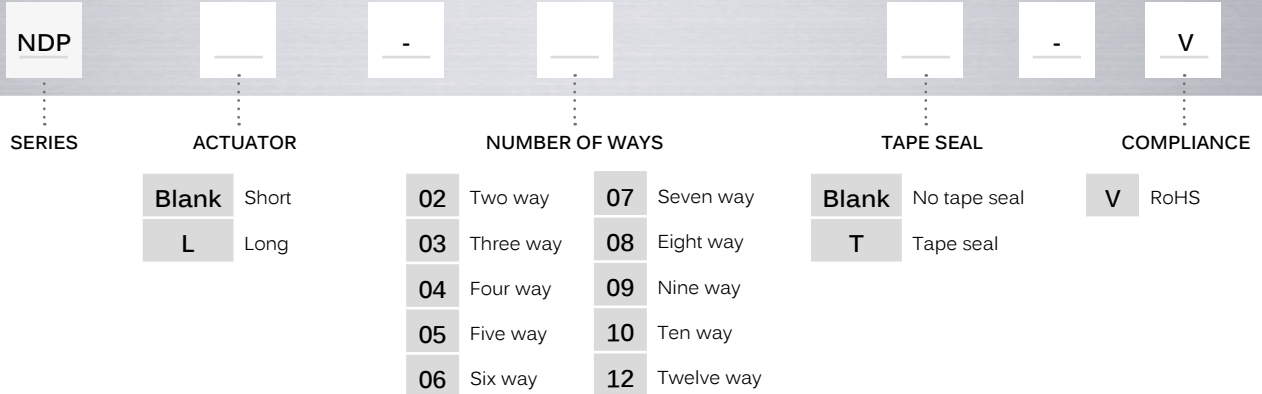

## 8 WAY STANDARD PROFILE THROUGH-HOLE PIANO STYLE

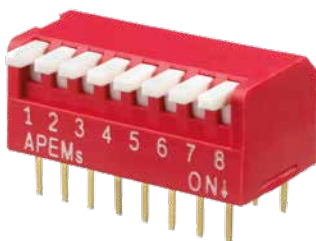

Number of ways	Dimension A	Dimension B
2	6.44 (0.25)	2.54 (0.1)
3	8.98 (0.35)	5.08 (0.2)
4	11.52 (0.45)	7.62 (0.3)
5	14.06 (0.55)	10.16 (0.4)
6	16.60 (0.65)	12.70 (0.5)
7	19.14 (0.75)	15.24 (0.6)
8	21.68 (0.85)	17.78 (0.7)
9	24.22 (0.95)	20.32 (0.8)
10	26.76 (1.05)	22.86 (0.9)
12	31.84 (1.25)	27.94 (1.1)

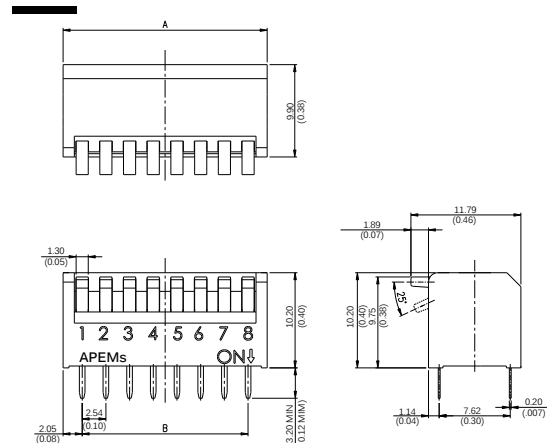

## X-ON Electronics

Largest Supplier of Electrical and Electronic Components

*Click to view similar products for [DIP Switches/SIP Switches](#) category:*

*Click to view products by [Diptronics](#) manufacturer:*

Other Similar products are found below :

[78M03S](#) [79B10T](#) [8136-475G4T](#) [G7G-1A2-CB-DC12](#) [A7SS-M](#) [DBP 2110](#) [DBP 2112](#) [DBS1008](#) [DHN02FTVTR](#) [DHN10T](#) [DHS108](#)  
[DPL08TN](#) [DRD16CSE04](#) [DRR4010](#) [DRR60016](#) [DRS4016](#) [BD06E](#) [1825008-1](#) [1825444-1](#) [25.350.0653.0](#) [LA2-DC12](#) [SBS 5004 TG](#)  
[SDA10H1BDA](#) [97R06ST](#) [A2C-2A5](#) [1825444-7](#) [ADE08SA04](#) [ADE12S04](#) [2161391-1](#) [2-1825058-8](#) [CCVA 2.5/ 4-G-5.08](#) [P26THRR32](#)  
[25.330.0653.1](#) [25.352.0353.0](#) [MDG305ST](#) [IKN0600000](#) [IKN0800000](#) [LA2-002-DC24](#) [DBP2008](#) [DBS1003](#) [DBS2008](#) [438872000](#)  
[DRD10CRAE04](#) [DRS1604](#) [DSR02T](#) [DSS 208 N](#) [5-1825033-1](#) [106-SDN06-EV](#) [1-1437507-6](#) [E2FMX2D1M1TGJ03M](#)  
[E3ZMCT81M1TJ03M](#)