

### 技术特性/Specifications:

额定电压 Rated voltage: 125V AC, DC  
额定电流 Rated current: 1A AC, DC  
接触电阻 Contact resistance: 20m $\Omega$  max  
绝缘电阻 Insulation resistance: 100M $\Omega$  min  
耐压 Withstand voltage: 500V AC/minute  
环境温度 Ambient temperature: -40 $^{\circ}$ C~+105 $^{\circ}$ C  
适用线规 Wire range: AWG#32~#28

| REV. | REVISION DESCRIPTION | DATE      | APPD   |
|------|----------------------|-----------|--------|
| B.   | 焊片材质磷青铜改为黄铜          | 2024.1.17 | Wu Hui |

# NOTES

Available in 02 through 20 Circuits.  
 Mates with DL12508-Y Series Housing.  
 Material : LCP UL94V-0.  
 Pin Material : Phosphor bronze.  
 Matte-plated .

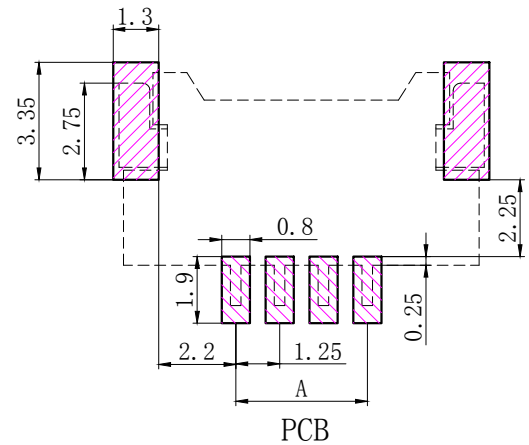
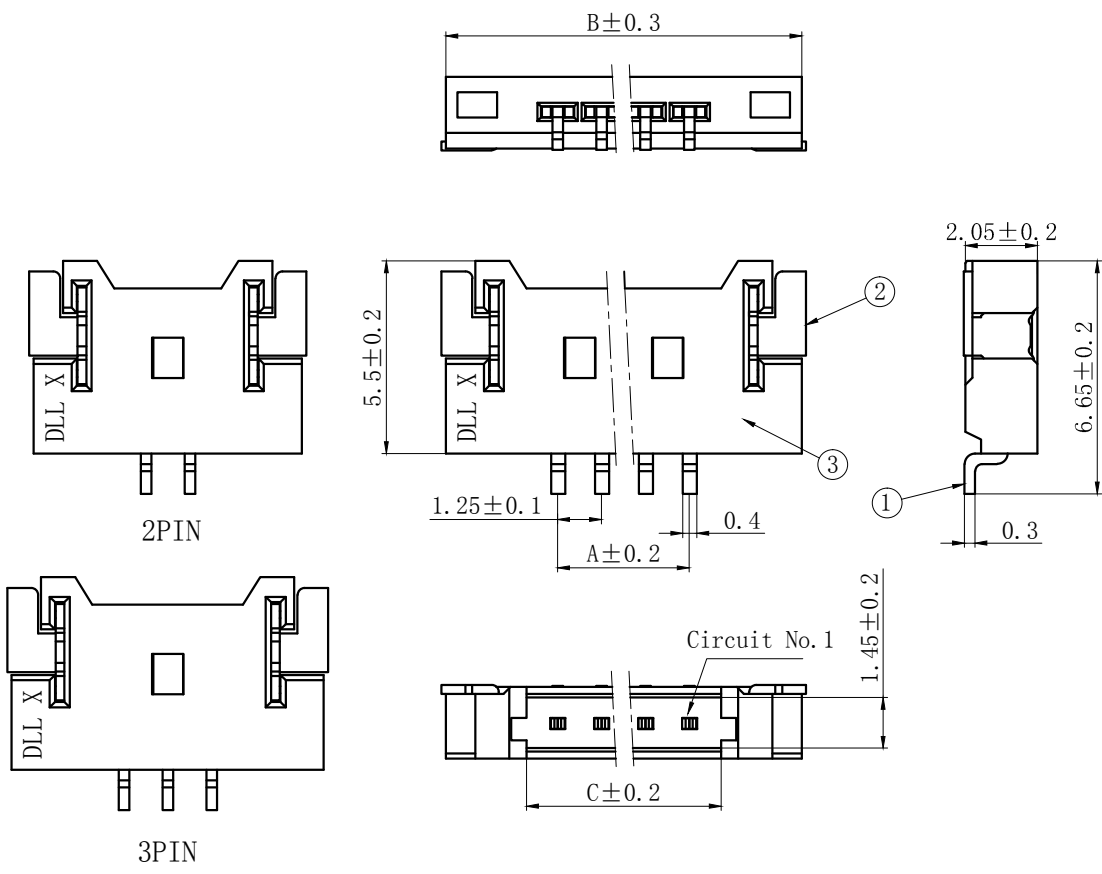

| Circuits | Product name  | Dimensino (mm) |       |       |
|----------|---------------|----------------|-------|-------|
|          |               | A              | B     | C     |
| 2        | DL12508-2AWB  | 1.25           | 7.65  | 3.05  |
| 3        | DL12508-3AWB  | 2.50           | 8.90  | 4.30  |
| 4        | DL12508-4AWB  | 3.75           | 10.15 | 5.55  |
| 5        | DL12508-5AWB  | 5.00           | 11.40 | 6.80  |
| 6        | DL12508-6AWB  | 6.25           | 12.65 | 8.05  |
| 7        | DL12508-7AWB  | 7.50           | 13.90 | 9.30  |
| 8        | DL12508-8AWB  | 8.75           | 15.15 | 10.55 |
| 9        | DL12508-9AWB  | 10.00          | 16.40 | 11.80 |
| 10       | DL12508-10AWB | 11.25          | 17.65 | 13.05 |
| 11       | DL12508-11AWB | 12.50          | 18.90 | 14.30 |
| 12       | DL12508-12AWB | 13.75          | 20.15 | 15.55 |
| 13       | DL12508-13AWB | 15.00          | 21.40 | 16.80 |
| ~        | ~             | ~              | ~     | ~     |
| 20       | DL12508-20AWB | 23.75          | 30.15 | 25.55 |

|    |    |     |     |    |         |
|----|----|-----|-----|----|---------|
| 3  | ③  | 基座  | LCP | 1  | UL94V-0 |
| 2  | ②  | 焊片  | 黄铜  | 2  | 镀亚光     |
| 1  | ①  | 接触件 | 磷青铜 | N* | 镀亚光     |
| 序号 | 图号 | 名称  | 材料  | 数量 | 附件      |

|                                       |               |                                     |               |  |           |
|---------------------------------------|---------------|-------------------------------------|---------------|--|-----------|
| GENERAL TOLERANCES (UNLESS SPECIFIED) |               | ZHE JIANG DELI CONNECTORS CO., LTD  |               |  |           |
| .X: ± 0.25                            | X° : ± 3.0°   | PRODUCT NAME:<br><b>DL12508-AWB</b> |               | TITLE:<br>1.25 mm Pitch<br>Wire To Board Wafer |           |
| .XX: ± 0.15                           | .X° : ± 2.0°  | DR:Chen Quan Long                   | DATE:21/04/03 | PART NO:                                       |           |
| .XXX: ± 0.01                          | .XX° : ± 1.0° | CHKD: Wu Hui                        | DATE:21/04/03 | SCALE: N/A                                     | PAGE: 1/1 |
| FINISH:                               |               | APPD:Ren An De                      | DATE:21/04/03 | UNITS: mm                                      | REV.: B   |
| DRAWING NO:                           |               |                                     |               |  |           |

|      |                      |        |      |
|------|----------------------|--------|------|
| REV. | REVISION DESCRIPTION | DATE   | APPD |
| B    | 优化加宽隔栅               | 23.8.4 | WH   |

## NOTES

Available in 02 through 20 Circuits.

Material : Nylon UL94V-0(2).

Accepts DL12508-T Crimp Terminal.

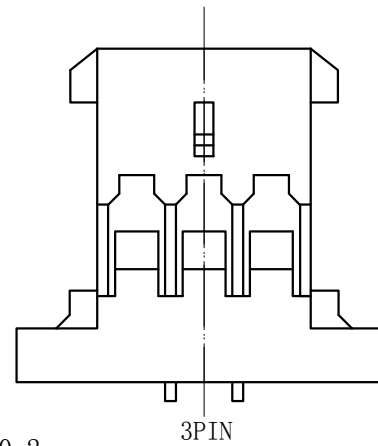
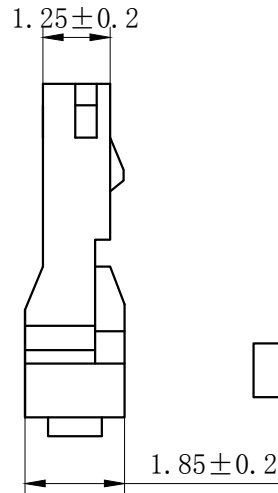
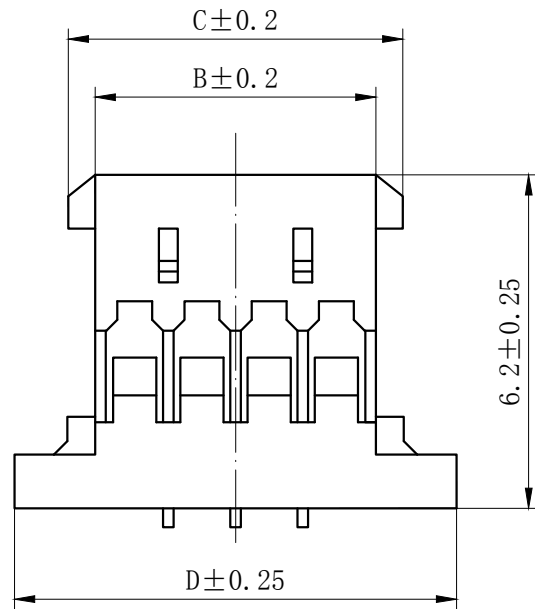
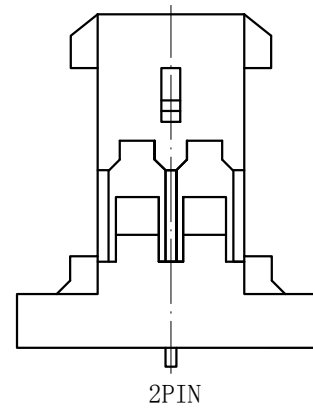
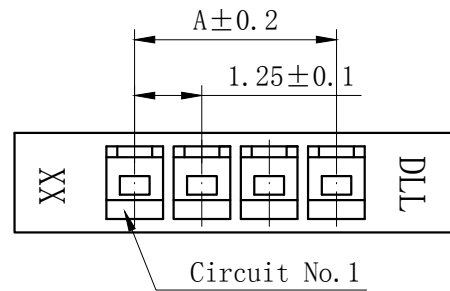

| Circuits | Product name | Dimension mm |       |       |       | Circuits | Product name | Dimension mm |       |       |       |
|----------|--------------|--------------|-------|-------|-------|----------|--------------|--------------|-------|-------|-------|
|          |              | A            | B     | C     | D     |          |              | A            | B     | C     | D     |
| 2        | DL12508-2Y   | 1.25         | 2.72  | 3.72  | 5.72  | 10       | DL12508-10Y  | 11.25        | 12.72 | 13.72 | 15.72 |
| 3        | DL12508-3Y   | 2.50         | 3.97  | 4.97  | 6.97  | 11       | DL12508-11Y  | 12.50        | 13.97 | 14.97 | 16.97 |
| 4        | DL12508-4Y   | 3.75         | 5.22  | 6.22  | 8.22  | 12       | DL12508-12Y  | 13.75        | 15.22 | 16.22 | 18.22 |
| 5        | DL12508-5Y   | 5.00         | 6.47  | 7.47  | 9.47  | 13       | DL12508-13Y  | 15.00        | 16.47 | 17.47 | 19.47 |
| 6        | DL12508-6Y   | 6.25         | 7.72  | 8.72  | 10.72 | 14       | DL12508-14Y  | 16.25        | 17.72 | 18.72 | 20.72 |
| 7        | DL12508-7Y   | 7.50         | 8.97  | 9.97  | 11.97 | 15       | DL12508-15Y  | 17.50        | 18.97 | 19.97 | 21.97 |
| 8        | DL12508-8Y   | 8.75         | 10.22 | 11.22 | 13.22 | -        | -            | -            | -     | -     | -     |
| 9        | DL12508-9Y   | 10.00        | 11.47 | 12.47 | 14.47 | 20       | DL12508-20Y  | 23.75        | 25.22 | 26.22 | 28.22 |

|  |              |                                    |   |
|--|--------------|------------------------------------|---|
| GENERAL TOLERANCES<br>(UNLESS SPECIFIED) |              | ZHE JIANG DELI CONNECTORS CO., LTD |   |
| .X: ± 0.25                               | X°: ± 3.0°   | PRODUCT NAME:<br><b>DL12508-Y</b>  | TITLE:<br>1.25 mm Pitch<br>W To B Housing |
| .XX: ± 0.15                              | .X°: ± 2.0°  | DR: Chen Quan Long                 | DATE: 21/01/25                            |
| .XXX: ± 0.01                             | .XX°: ± 1.0° | DATE: 21/01/25                     | PART NO:                                  |
| FINISH:                                  |              | CHKD: Wu Hui                       | SCALE: N/A                                |
| DRAWING NO:                              |              | APPD: Ren An De                    | PAGE: 1/1                                 |
|  |              | DATE: 21/01/25                     | UNITS: mm                                 |
|  |              |                                    | REV.: B                                   |

| REV. | REVISION DESCRIPTION | DATE | APPD |
|------|----------------------|------|------|
|      |                      |      |      |

## NOTES

Used in DL12508-Y Series Housing.  
 Accepts AWG #32~#28 Wire Range.  
 Insulation O.D.=0.5~1.0 mm.  
 Material : Phosphor Bronze .  
 Finish: Tin plated.  
 Thickness: 0.15mm.

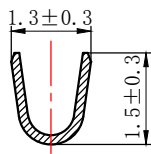
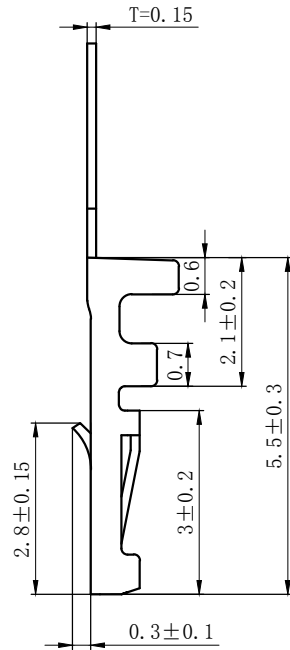
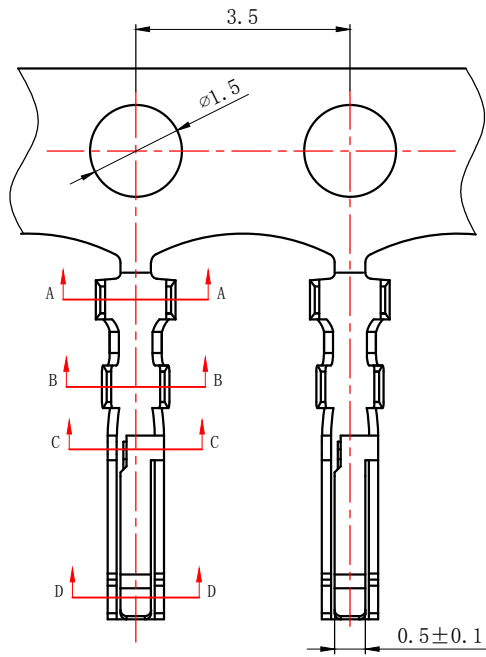
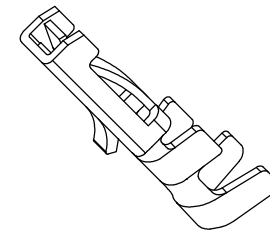

SECTION A-A

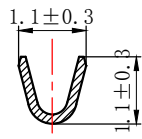

SECTION B-B

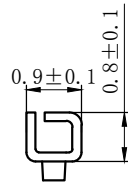

SECTION C-C

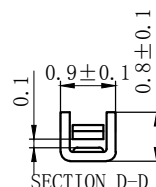

SECTION D-D

|  |              |                                    |  |
|--|--------------|------------------------------------|--|
| GENERAL TOLERANCES<br>(UNLESS SPECIFIED) |              | ZHE JIANG DELI CONNECTORS CO., LTD |  |
| .X: ± 0.25                               | X°: ± 3.0°   | PRODUCT NAME:<br><b>DL12508-T</b>  | TITLE:<br>1.25mm Pitch<br>Wire To Board Crimp Terminal |
| .XX: ± 0.15                              | .X°: ± 2.0°  | DR: Yuan Jun Rong                  | DATE:21.10.7   |
| .XXX: ± 0.01                             | .XX°: ± 1.0° | CHKD: Wu Hui                       | DATE:21.10.7   |
| FINISH:                                  |              | APPD: Ren An De                    | DATE:21.10.7   |
| DRAWING NO:                              |              | UNITS: mm                          | PART NO:<br>SCALE: N/A<br>PAGE: 1/1<br>REV.: A         |

## X-ON Electronics

Largest Supplier of Electrical and Electronic Components

*Click to view similar products for [Headers & Wire Housings](#) category:*

*Click to view products by [DLL](#) manufacturer:*

Other Similar products are found below :

[0015917161](#) [0022155065](#) [57102-F02-18ULF](#) [58102-G61-06LF](#) [582553-1](#) [01.001.5753.1](#) [0050291907](#) [02.125.8002.8](#) [609-3404](#) [61062-3](#)  
[CSU011177004](#) [622-0430](#) [622-3653LF](#) [63453-116](#) [636-1030](#) [636-1427](#) [636-3427](#) [636-4007](#) [641938-9](#) [65495-038](#) [65692-001LF](#) [65781-018](#)  
[65781-047](#) [65817-010LF](#) [65817-015LF](#) [67095-007LF](#) [67601157](#) [68631-112](#) [68645-018](#) [699319-000](#) [70.362.1628.0](#) [70-4210](#) [70-4226B](#) [70-](#)  
[4853B](#) [71.350.2428.0](#) [733-134](#) [733-162](#) [760-3052](#) [MHR-64-VUAL](#) [80.063.4001.1](#) [800-90-001-10-001000](#) [801-43-002-10-013000](#)  
[801-43-006-10-002000](#) [803-43-024-10-001000](#) [803-93-012-10-001000](#) [8-1437020-4](#) [819-22-004-30-001101](#) [820-22-006-30-001101](#)  
[820-22-008-30-001101](#) [821-22-002-10-001101](#)