

技术特性/Specifications:

额定电压 Rated voltage: 100V AC, DC
额定电流 Rated current: 2A AC, DC
接触电阻 Contact resistance: 20m Ω max
绝缘电阻 Insulation resistance: 1000M Ω min
耐压 Withstand voltage: 800V AC/minute
环境温度 Ambient temperature: -40 $^{\circ}$ C~+105 $^{\circ}$ C
适用线规 Wire range: AWG#30~#22

REV.	REVISION DESCRIPTION	DATE	APPD

NOTES

- Available in 02 through 20 Circuits.
- Mates with DL20033-Y Series Housing.
- Material : Nylon UL94V-0 (2) .
- 0.50mm Square Pin.
- Pin Material : Brass / Tin-Plated.

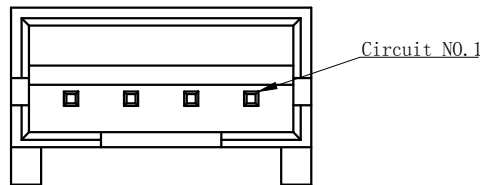
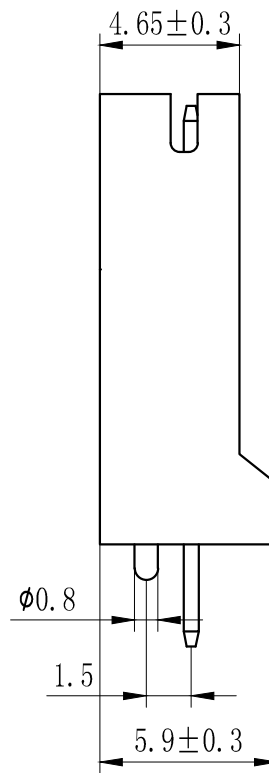
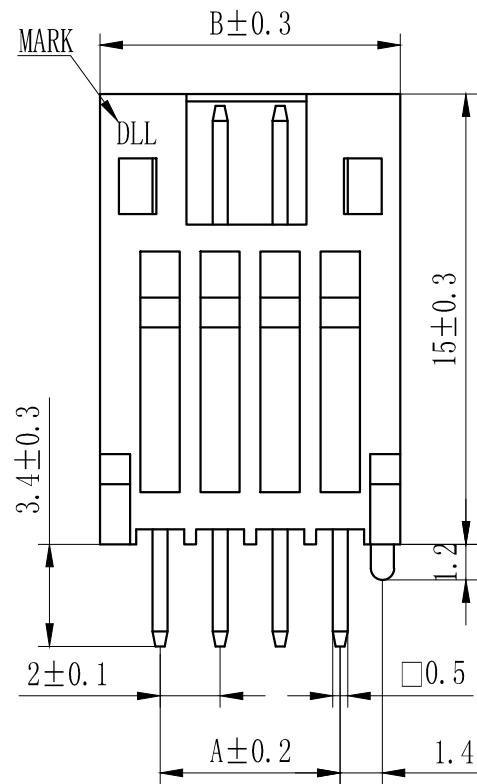

Circuits	Product name	Dimension mm		Circuits	Product name	Dimension mm	
		A	B			A	B
2	PH-H-2AS	2.00	6.00	11	PH-H-11AS	20.00	24.00
3	PH-H-3AS	4.00	8.00	12	PH-H-12AS	22.00	26.00
4	PH-H-4AS	6.00	10.00	13	PH-H-13AS	24.00	28.00
5	PH-H-5AS	8.00	12.00	14	PH-H-14AS	26.00	30.00
6	PH-H-6AS	10.00	14.00	15	PH-H-15AS	28.00	32.00
7	PH-H-7AS	12.00	16.00	16	PH-H-16AS	30.00	34.00
8	PH-H-8AS	14.00	18.00	17	PH-H-17AS	32.00	36.00
9	PH-H-9AS	16.00	20.00	~	~	~	~
10	PH-H-10AS	18.00	22.00	20	PH-H-20AS	38.00	42.00

GENERAL TOLERANCES (UNLESS SPECIFIED)		ZHE JIANG DELI CONNECTORS CO., LTD	
.X: ± 0.25	X°: ± 3.0°	PRODUCT NAME:	TITLE: 2.00 mm Pitch Wire To Board Wafer
.XX: ± 0.15	.X°: ± 2.0°	DL20033(PH-H)-AS	PART NO:
.XXX: ± 0.01	.XX°: ± 1.0°	DR: Chen Quan Long	
FINISH:		CHKD: Wu Hui	DATE: 22/05/23
DRAWING NO:		APPD: Ren An De	DATE: 22/05/23
			SCALE: N/A
			PAGE: 1/1
			UNITS: mm
			REV.: A

1

2

3

4

5

6

7

8

REV.	REVISION DESCRIPTION	DATE	APPD

NOTES

Available in 02 through 20 Circuits.
Match with DL20001 series housing.
Material : Nylon UL94V-0(2).
Accepts DL20001-T Crimp Terminal.

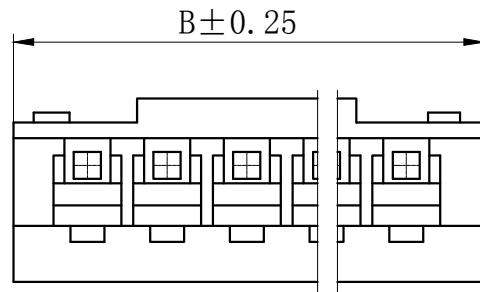
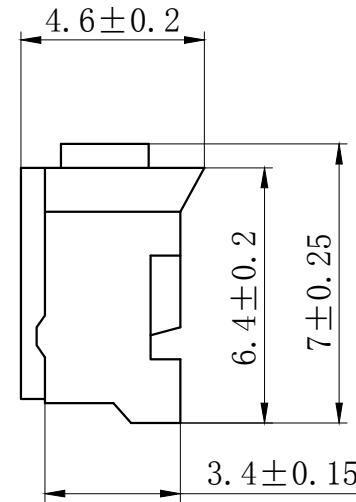
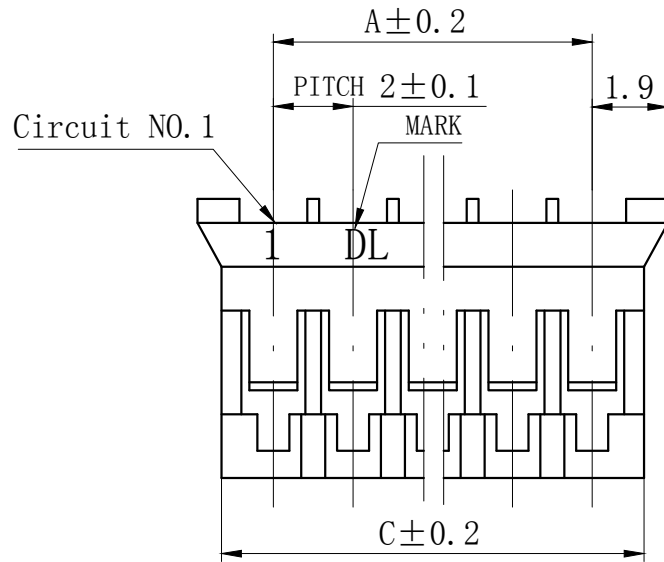

Circuits	Product name	Dimension mm			Circuits	Product name	Dimension mm		
		A	B	C			A	B	C
2	PH-2Y	2.00	5.80	4.55	12	PH-12Y	22.00	25.80	24.55
3	PH-3Y	4.00	7.80	6.55	13	PH-13Y	24.00	27.80	26.55
4	PH-4Y	6.00	9.80	8.55	14	PH-14Y	26.00	29.80	28.55
5	PH-5Y	8.00	11.80	10.55	15	PH-15Y	28.00	31.80	30.55
6	PH-6Y	10.00	13.80	12.55	16	PH-16Y	30.00	33.80	32.55
7	PH-7Y	12.00	15.80	14.55	17	PH-17Y	32.00	35.80	34.55
8	PH-8Y	14.00	17.80	16.55	18	PH-18Y	34.00	37.80	36.55
9	PH-9Y	16.00	19.80	18.55	19	PH-19Y	36.00	39.80	38.55
10	PH-10Y	18.00	21.80	20.55	20	PH-20Y	38.00	41.80	40.55
11	PH-11Y	20.00	23.80	22.55	—	—	—	—	—

GENERAL TOLERANCES
(UNLESS SPECIFIED)

.X: ± 0.25 X°: $\pm 3.0^\circ$
.XX: ± 0.15 .X°: $\pm 2.0^\circ$
.XXX: ± 0.01 .XX°: $\pm 1.0^\circ$

FINISH:

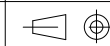

DRAWING NO:

ZHE JIANG DELI CONNECTORS CO., LTD

PRODUCT NAME:
DL20001 (PH)-Y

TITLE:
2.00 mm Pitch Housing

DR: Chen Quan Long

DATE: 20/08/01

PART NO:

CHKD: Wu Hui

DATE: 20/08/01

SCALE: N/A

PAGE: 1/1

APPD: Ren An De

DATE: 20/08/01

UNITS: mm

REV.: A

1

2

3

4

5

6

7

8

REV.	REVISION DESCRIPTION	DATE	APPD

NOTES

Used in DL20001-Y Series Housing.

Accepts AWG #30~22 Wire Range.

0.05~ 0.33 mm² .

Insulation O.D. =0.8~1.5 mm.

Material : Phosphor Bronze .

Finish: Tin plated.

Thickness: 0.2 mm.

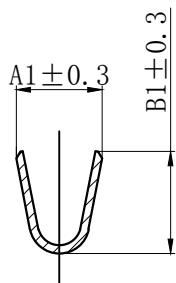
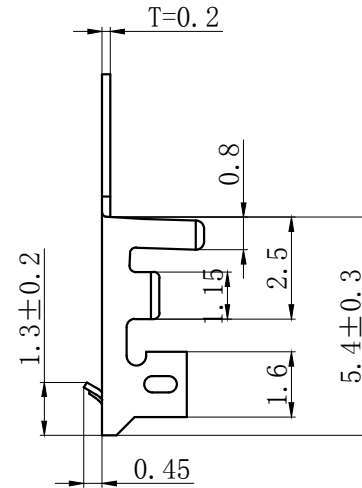
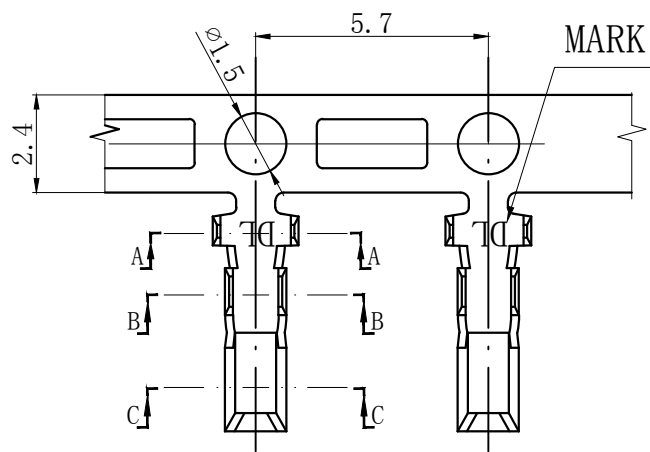

SECTION A-A

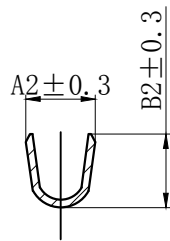

SECTION B-B

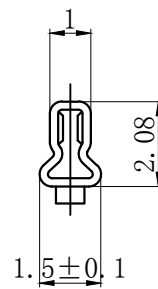

SECTION C-C

TYPE	Dimension mm				Applicable wires
	A1	B1	A2	B2	AWG#
PH-T-G	2.1	2.5	1.7	1.8	26-22
PH-T	2.1	2.5	1.5	1.4	30-24

GENERAL TOLERANCES (UNLESS SPECIFIED)		ZHE JIANG DELI CONNECTORS CO., LTD			
.X: ± 0.25	X°: ± 3.0°	PRODUCT NAME: DL20001 (PH)-T		TITLE: 2.00 mm Pitch Crimp Terminal	
.XX: ± 0.15	.X°: ± 2.0°	DR: Chen Quan Long		DATE: 20/01/26	
.XXX: ± 0.01	.XX°: ± 1.0°	CHKD: Wu Hui		DATE: 20/01/26	
DRAWING NO:		APPD: Ren An De		DATE: 20/01/26	
		SCALE: N/A		PAGE: 1/1	
		UNITS: mm		REV.: A	

X-ON Electronics

Largest Supplier of Electrical and Electronic Components

Click to view similar products for [Headers & Wire Housings](#) category:

Click to view products by [DLL](#) manufacturer:

Other Similar products are found below :

[0015917161](#) [0022155065](#) [57102-F02-18ULF](#) [58102-G61-06LF](#) [582553-1](#) [01.001.5753.1](#) [0050291907](#) [02.125.8002.8](#) [609-3404](#) [61062-3](#)
[CSU011177004](#) [622-0430](#) [622-3653LF](#) [63453-116](#) [636-1030](#) [636-1427](#) [636-3427](#) [636-4007](#) [641938-9](#) [65495-038](#) [65692-001LF](#) [65781-018](#)
[65781-047](#) [65817-010LF](#) [65817-015LF](#) [67095-007LF](#) [67601157](#) [68631-112](#) [68645-018](#) [699319-000](#) [70.362.1628.0](#) [70-4210](#) [70-4226B](#) [70-](#)
[4853B](#) [71.350.2428.0](#) [733-134](#) [733-162](#) [760-3052](#) [MHR-64-VUAL](#) [80.063.4001.1](#) [800-90-001-10-001000](#) [801-43-002-10-013000](#)
[801-43-006-10-002000](#) [803-43-024-10-001000](#) [803-93-012-10-001000](#) [8-1437020-4](#) [819-22-004-30-001101](#) [820-22-006-30-001101](#)
[820-22-008-30-001101](#) [821-22-002-10-001101](#)