

技术特性/Specifications:

额定电压 Rated voltage: 12V AC, DC
额定电流 Rated current: 3mA AC, DC
接触电阻 Contact resistance: 20m Ω max
绝缘电阻 Insulation resistance: 100M Ω min
耐压 Withstand voltage: 1000V AC/minute
环境温度 Ambient temperature: -40 $^{\circ}$ C~+105 $^{\circ}$ C
适用线规 Wire range: AWG#24~#20

| | | | |
|------|----------------------|------|------|
| REV. | REVISION DESCRIPTION | DATE | APPD |
| | | | |

NOTES

Available in 08 through 40 Circuits.

Match with DL22001-Y series housing.

Material : PBT UL94-V0.

Pin Material : Brass .

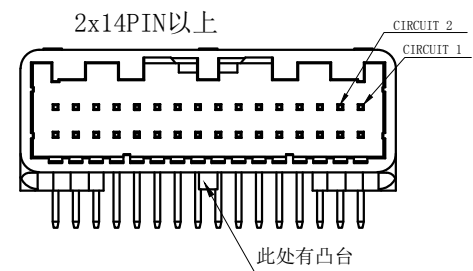
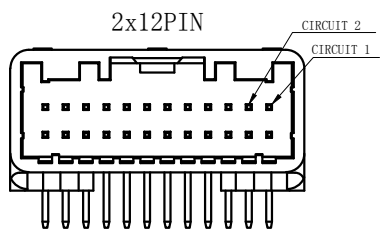
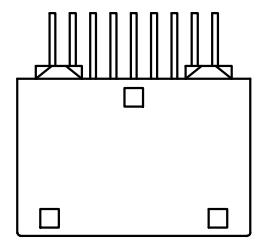
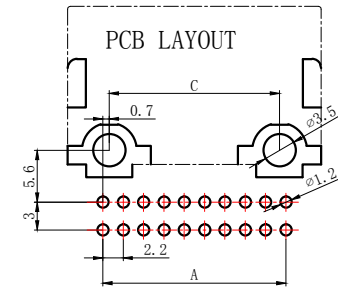
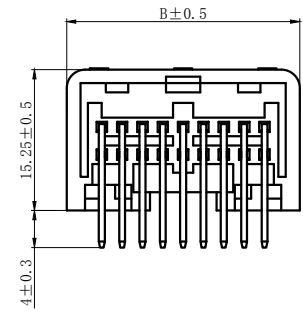
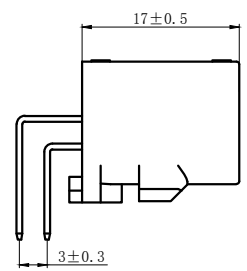
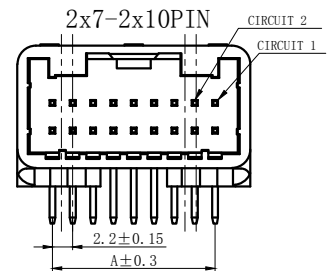
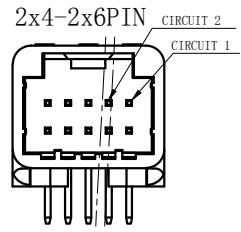
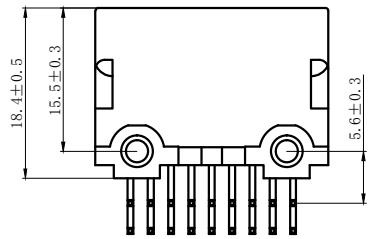

| Circuits | Product name | Dimensino (mm) | | | Circuits | Product name | Dimensino (mm) | | |
|----------|--------------|----------------|-------|-------|----------|--------------|----------------|-------|-------|
| | | A | B | C | | | A | B | C |
| 2X4 | QA-8AW | 6.60 | 14.20 | 8.20 | 2X10 | QA-20AW | 19.80 | 27.40 | 21.50 |
| 2X5 | QA-10AW | 8.80 | 16.40 | 9.50 | 2X12 | QA-24AW | 24.20 | 31.80 | 23.10 |
| 2X6 | QA-12AW | 11.00 | 18.60 | 9.60 | 2X14 | QA-28AW | 28.60 | 36.20 | 27.20 |
| 2X7 | QA-14AW | 13.20 | 20.80 | 11.80 | 2X16 | QA-32AW | 33.00 | 40.60 | 31.60 |
| 2X8 | QA-16AW | 15.40 | 23.00 | 14.00 | 2X20 | QA-40AW | 41.80 | 49.40 | 40.40 |
| 2X9 | QA-18AW | 17.60 | 25.20 | 16.20 | | | | | |

| | | | |
|---------------------------------------|--------------|------------------------------------|---------------------------------|
| GENERAL TOLERANCES (UNLESS SPECIFIED) | | ZHE JIANG DELI CONNECTORS CO., LTD | |
| .X: ± 0.25 | X°: ± 3.0° | PRODUCT NAME: DL22001 (QA)-AW | TITLE: 2.20 mm Pitch Housing |
| .XX: ± 0.15 | .X°: ± 2.0° | DR: Chen Quan Long | DATE: 22/08/01 |
| .XXX: ± 0.01 | .XX°: ± 1.0° | CHKD: Wu Hui | DATE: 22/08/01 |
| FINISH: | | APPD: Ren An De | DATE: 22/08/01 |
| DRAWING NO: | | | |
| | | SCALE: N/A | PAGE: 1/1 |
| | | UNITS: mm | REV.: A |

| | | | |
|------|----------------------|------|------|
| REV. | REVISION DESCRIPTION | DATE | APPD |
| | | | |

NOTES

Available in 08 through 40 Circuits.
 Match with DL22001 series housing.
 Material : PBT UL94-V0.
 Accepts DL22001-T Crimp Terminal.

| | | | | |
|----|----|----|-----|----|
| 2 | ② | 护圈 | PBT | 1 |
| 1 | ① | 底座 | PBT | 1 |
| 序号 | 图号 | 名称 | 材料 | 数量 |

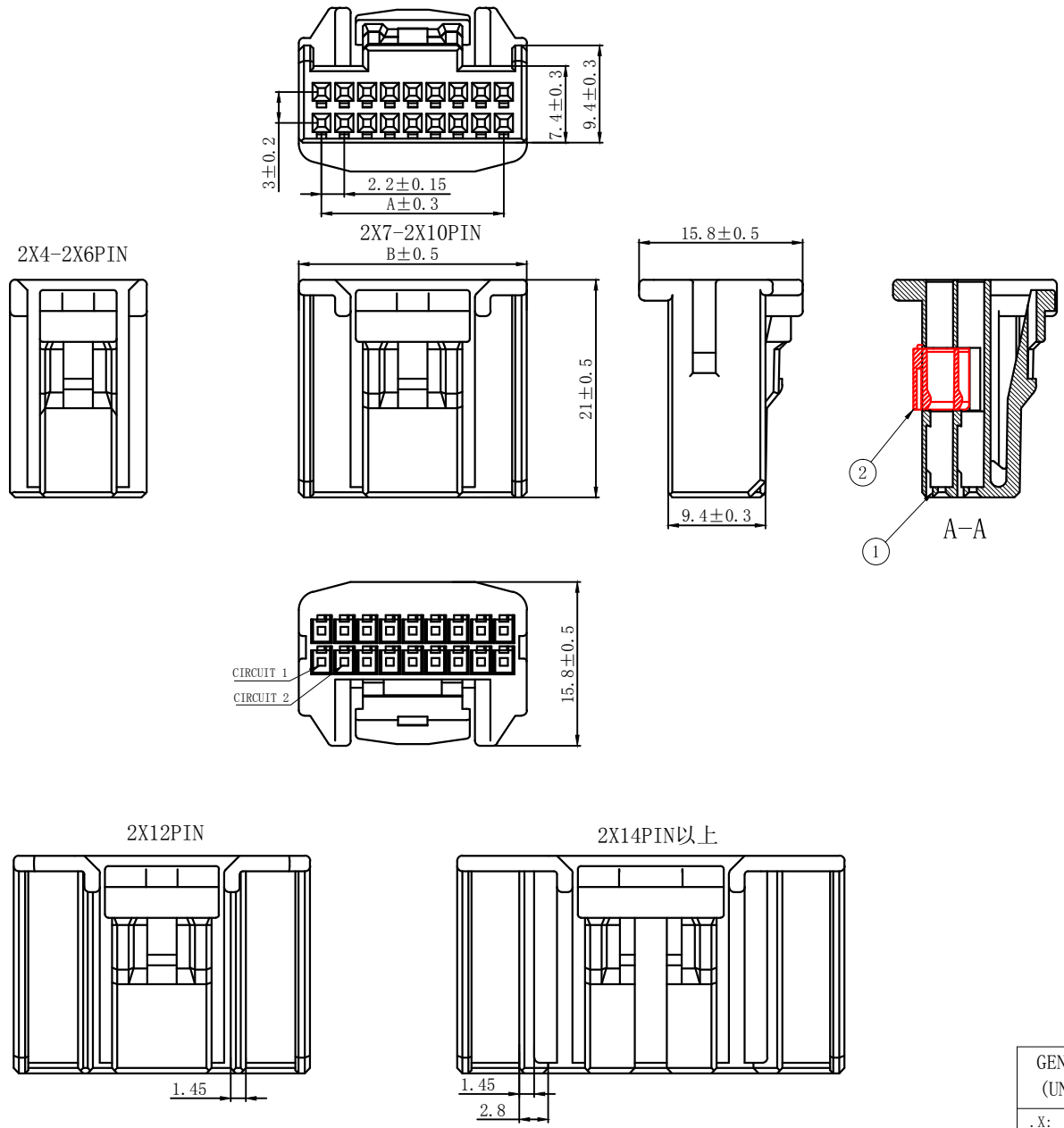

| Circuits | product name | Dimensino (mm) | | Circuits | product name | Dimensino (mm) | |
|----------|--------------|----------------|-------|----------|--------------|----------------|-------|
| | | A | B | | | A | B |
| 2X4 | QA-8Y | 6.60 | 11.00 | 2X10 | QA-20Y | 19.80 | 24.20 |
| 2X5 | QA-10Y | 8.80 | 13.20 | 2X12 | QA-24Y | 24.20 | 28.60 |
| 2X6 | QA-12Y | 11.00 | 15.40 | 2X14 | QA-28Y | 28.60 | 33.00 |
| 2X7 | QA-14Y | 13.20 | 17.60 | 2X16 | QA-32Y | 33.00 | 37.40 |
| 2X8 | QA-16Y | 15.40 | 19.80 | 2X20 | QA-40Y | 41.80 | 46.20 |
| 2X9 | QA-18Y | 17.60 | 22.00 | | | | |

| | | | |
|---------------------------------------|--------------|------------------------------------|---------------------------------|
| GENERAL TOLERANCES (UNLESS SPECIFIED) | | ZHE JIANG DELI CONNECTORS CO., LTD | |
| .X: ± 0.25 | X°: ± 3.0° | PRODUCT NAME: DL22001 (QA)-Y | TITLE: 2.00 mm Pitch Housing |
| .XX: ± 0.15 | .X°: ± 2.0° | DR: Chen Quan Long | DATE: 23/09/01 |
| .XXX: ± 0.01 | .XX°: ± 1.0° | CHKD: Wu Hui | DATE: 23/09/01 |
| FINISH: | | APPD: Ren An De | DATE: 23/09/01 |
| DRAWING NO: | | | |
| | | SCALE: N/A | PAGE: 1/1 |
| | | UNITS: mm | REV.: A |

| REV. | REVISION DESCRIPTION | DATE | APPD |
|------|----------------------|------|------|
| | | | |

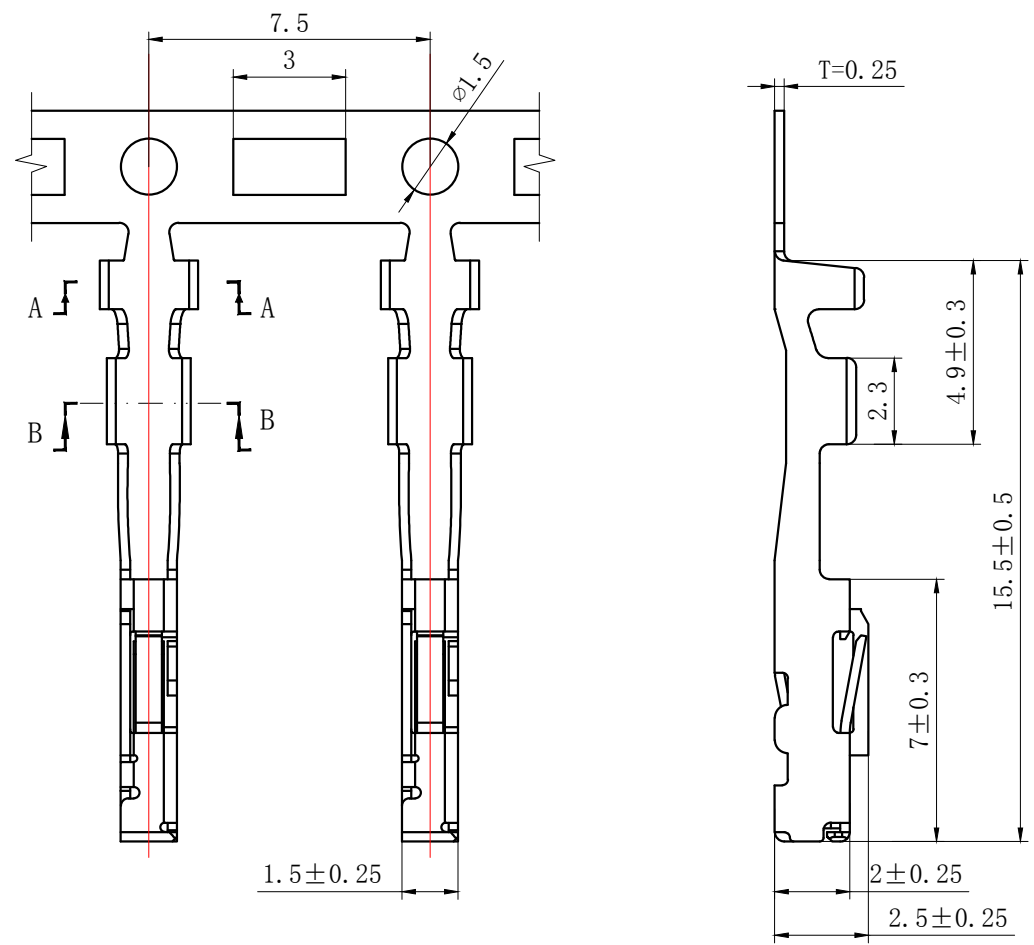

NOTES

Used in DL22001-Y Series Housing.
 Accepts AWG #20~24 Wire Range.
 Material : Phosphor Bronze .
 Finish: Tin plated.
 Thickness: 0.25 mm.

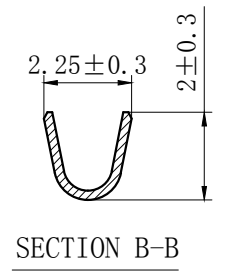
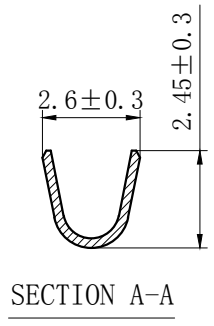

| GENERAL TOLERANCES (UNLESS SPECIFIED) | | ZHE JIANG DELI CONNECTORS CO., LTD | |
|--|-----------------------|--|---|
| .X: ± 0.25 | X°: $\pm 3.0^\circ$ | PRODUCT NAME: DL22001 (QA)-T | TITLE: 2.20 mm Pitch Crimp Terminal |
| .XX: ± 0.15 | .X°: $\pm 2.0^\circ$ | DR: Chen Quan Long | DATE: 22/08/01 |
| .XXX: ± 0.01 | .XX°: $\pm 1.0^\circ$ | CHKD: Wu Hui | DATE: 22/08/01 |
| DRAWING NO: | | APPD: Ren An De | DATE: 22/08/01 |
| | | SCALE: N/A | PAGE: 1/1 |
| | | UNITS: mm | REV.: A |

X-ON Electronics

Largest Supplier of Electrical and Electronic Components

Click to view similar products for [Headers & Wire Housings](#) category:

Click to view products by [DLL](#) manufacturer:

Other Similar products are found below :

[0015917161](#) [0022155065](#) [57102-F02-18ULF](#) [58102-G61-06LF](#) [582553-1](#) [01.001.5753.1](#) [0050291907](#) [02.125.8002.8](#) [609-3404](#) [61062-3](#)
[CSU011177004](#) [622-0430](#) [622-3653LF](#) [63453-116](#) [636-1030](#) [636-1427](#) [636-3427](#) [636-4007](#) [641938-9](#) [65495-038](#) [65692-001LF](#) [65781-018](#)
[65781-047](#) [65817-010LF](#) [65817-015LF](#) [67095-007LF](#) [67601157](#) [68631-112](#) [699319-000](#) [70.362.1628.0](#) [70-4210](#) [70-4226B](#) [70-4853B](#) [707-](#)
[5028](#) [71.350.2428.0](#) [733-134](#) [733-162](#) [760-3052](#) [MHR-64-VUAL](#) [80.063.4001.1](#) [800-90-001-10-001000](#) [801-43-002-10-013000](#)
[801-43-006-10-002000](#) [803-43-024-10-001000](#) [803-93-012-10-001000](#) [8-1437020-4](#) [819-22-004-30-001101](#) [820-22-006-30-001101](#)
[820-22-008-30-001101](#) [821-22-002-10-001101](#)