

技术特性/Specifications:

额定电压 Rated voltage: 250V AC, DC
额定电流 Rated current: 2A AC, DC
接触电阻 Contact resistance: 20m Ω max
绝缘电阻 Insulation resistance: 1000M Ω min
耐压 Withstand voltage: 800V AC/minute
环境温度 Ambient temperature: -40 $^{\circ}$ C~+105 $^{\circ}$ C
适用线规 Wire range: AWG#30~#22

| REV. | REVISION DESCRIPTION | DATE | APPD |
|------|----------------------|------|------|
| | | | |

NOTES

Available in 02 through 16 Circuits.
 Material : Nylon UL94V-0(2).
 Accepts DL20009-T Crimp Terminal.

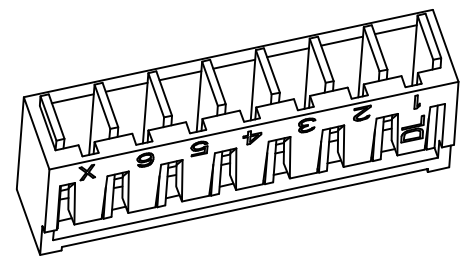
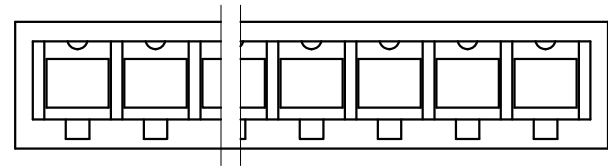
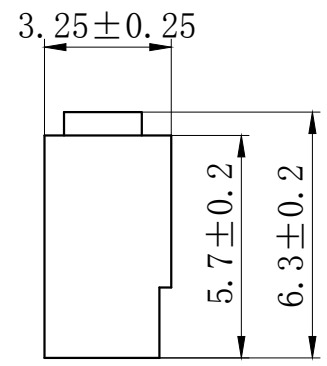
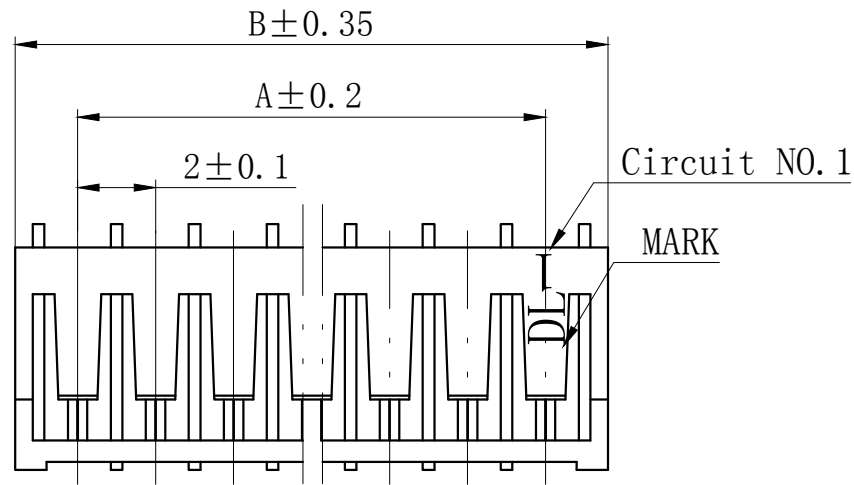

| Circuits | Product name | Dimension mm | | Circuits | Product name | Dimension mm | |
|----------|--------------|--------------|-------|----------|--------------|--------------|-------|
| | | A | B | | | A | B |
| 2 | SAN-2Y | 2.00 | 5.50 | 10 | SAN-10Y | 18.00 | 21.50 |
| 3 | SAN-3Y | 4.00 | 7.50 | 11 | SAN-11Y | 20.00 | 23.50 |
| 4 | SAN-4Y | 6.00 | 9.50 | 12 | SAN-12Y | 22.00 | 25.50 |
| 5 | SAN-5Y | 8.00 | 11.50 | 13 | SAN-13Y | 24.00 | 27.50 |
| 6 | SAN-6Y | 10.00 | 13.50 | 14 | SAN-14Y | 26.00 | 29.50 |
| 7 | SAN-7Y | 12.00 | 15.50 | 15 | SAN-15Y | 28.00 | 31.50 |
| 8 | SAN-8Y | 14.00 | 17.50 | 16 | SAN-16Y | 30.00 | 33.50 |
| 9 | SAN-9Y | 16.00 | 19.50 | - | - | - | - |

| | | | |
|--|--------------|---|--|
| GENERAL TOLERANCES (UNLESS SPECIFIED) | | ZHE JIANG DELI CONNECTORS CO., LTD | |
| .X: ± 0.25 | X°: ± 3.0° | PRODUCT NAME: DL20009 (SAN)-Y | TITLE: 2.00 mm Pitch Wire To Board Housing |
| .XX: ± 0.15 | .X°: ± 2.0° | DR:Chen Quan Long | DATE:19/08/01 |
| .XXX: ± 0.01 | .XX°: ± 1.0° | CHKD:Wu Hui | DATE:19/08/01 |
| FINISH: _____ | | APPD:Ren An De | DATE:19/08/01 |
| DRAWING NO: | | | |
| | | SCALE: N/A | PAGE: 1/1 |
| | | UNITS: mm | REV.: A |

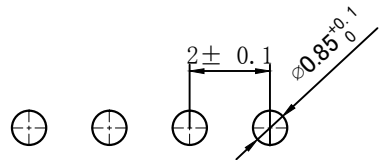
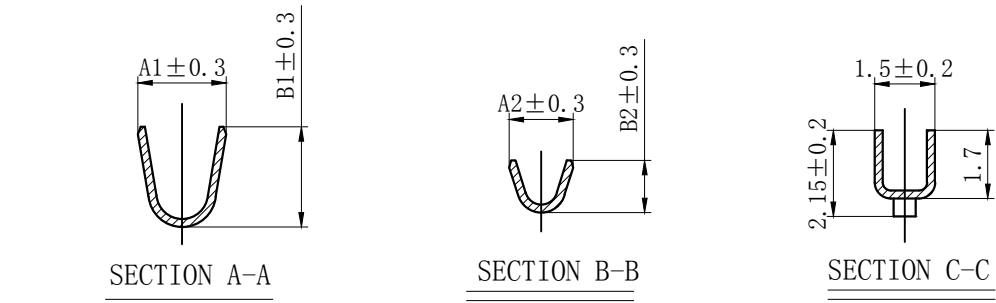
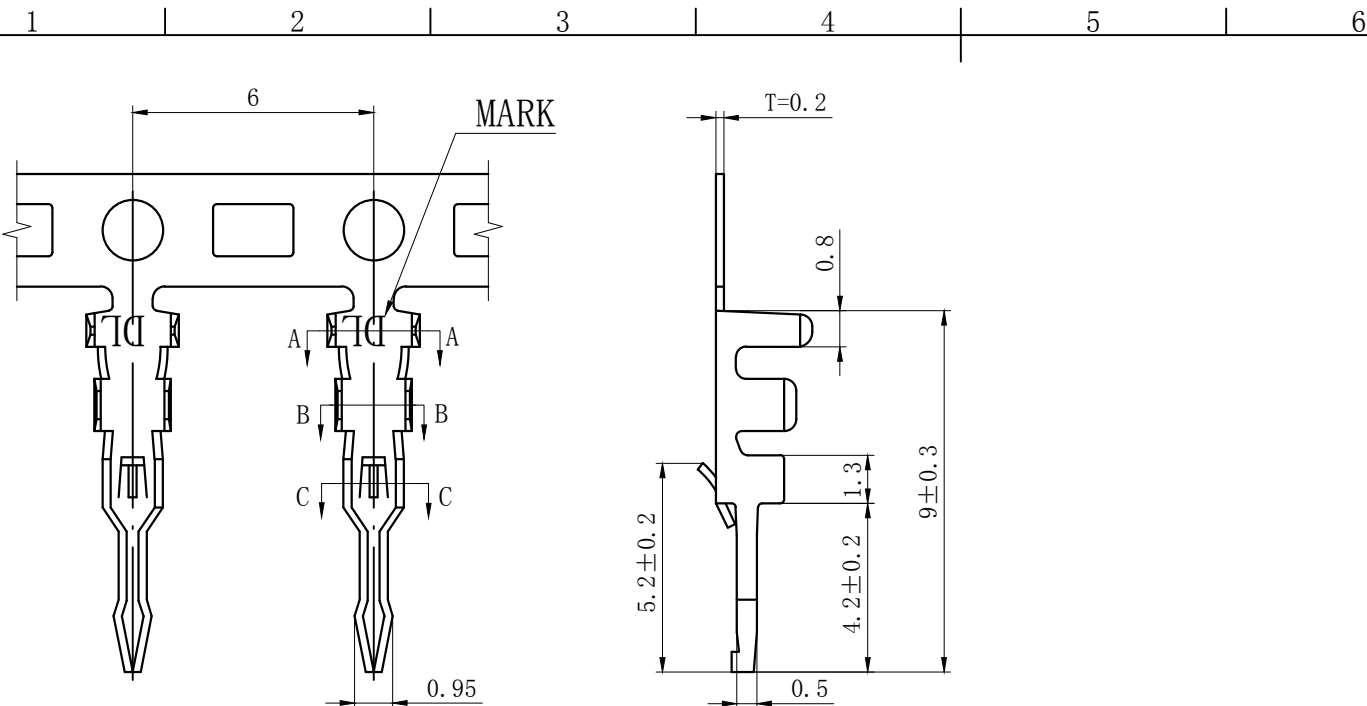

| REV. | REVISION DESCRIPTION | DATE | APPD |
|------|----------------------|------|------|
| | | | |
| | | | |

NOTES

Used in DL20009-Y Series Housing.
 Accepts AWG #30~22 Wire Range.
 Insulation O.D. =0.9~1.8mm.
 Material : Phosphor Bronze .
 Finish: Tin plated 2.0 μm MiN .
 Thickness: 0.2 mm.

| TYPE | Dimension mm | | | | Applicable wires |
|---------|--------------|-----|-----|-----|------------------|
| | A1 | B1 | A2 | B2 | AWG# |
| SAN-T | 2.2 | 2.5 | 1.6 | 1.3 | 30-24 |
| SAN-T-G | 2.3 | 2.4 | 1.9 | 2.0 | 26-22 |

| GENERAL TOLERANCES (UNLESS SPECIFIED) | | ZHE JIANG DELI CONNECTORS CO., LTD | | |
|---------------------------------------|---------------|------------------------------------|--------------------------------|-----------|
| .X: ± 0.25 | X° : ± 3.0° | PRODUCT NAME: | TITLE: | |
| .XX: ± 0.15 | .X° : ± 2.0° | DL20009 (SAN)-T | 2.0 mm pitch Crimping Terminal | |
| .XXX: ± 0.01 | .XX° : ± 1.0° | DR:Chen Quan Long | DATE:2019/08/01 | |
| FINISH: | | CHKD: Wu Hui | DATE:2019/08/01 | |
| DRAWING NO: | | APPD:Ren An De | DATE:2019/08/01 | |
| | | | PART NO: | |
| | | | SCALE: N/A | PAGE: 1/1 |
| | | | UNITS: mm | REV.: A |

X-ON Electronics

Largest Supplier of Electrical and Electronic Components

Click to view similar products for [Headers & Wire Housings](#) category:

Click to view products by [DLL](#) manufacturer:

Other Similar products are found below :

[0015917161](#) [0022155065](#) [57102-F02-18ULF](#) [58102-G61-06LF](#) [582553-1](#) [01.001.5753.1](#) [0050291907](#) [02.125.8002.8](#) [609-3404](#) [61062-3](#)
[CSU011177004](#) [622-0430](#) [622-3653LF](#) [63453-116](#) [636-1030](#) [636-1427](#) [636-3427](#) [636-4007](#) [641938-9](#) [65495-038](#) [65692-001LF](#) [65781-018](#)
[65781-047](#) [65817-010LF](#) [65817-015LF](#) [67095-007LF](#) [67601157](#) [68631-112](#) [68645-018](#) [699319-000](#) [70.362.1628.0](#) [70-4210](#) [70-4226B](#) [70-](#)
[4853B](#) [71.350.2428.0](#) [733-134](#) [733-162](#) [760-3052](#) [MHR-64-VUAL](#) [80.063.4001.1](#) [800-90-001-10-001000](#) [801-43-002-10-013000](#)
[801-43-006-10-002000](#) [803-43-024-10-001000](#) [803-93-012-10-001000](#) [8-1437020-4](#) [819-22-004-30-001101](#) [820-22-006-30-001101](#)
[820-22-008-30-001101](#) [821-22-002-10-001101](#)