

技术特性/Specifications:

额定电压 Rated voltage: 250V AC, DC
额定电流 Rated current: 3A AC, DC
接触电阻 Contact resistance: 20m Ω max
绝缘电阻 Insulation resistance: 1000M Ω min
耐压 Withstand voltage: 1000V AC/minute
环境温度 Ambient temperature: -40 $^{\circ}$ C~+105 $^{\circ}$ C
适用线规 Wire range: AWG#28~#20

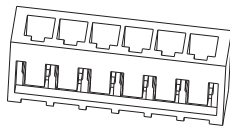

| | | | |
|------|----------------------|------|------|
| REV. | REVISION DESCRIPTION | DATE | APPD |
| | | | |

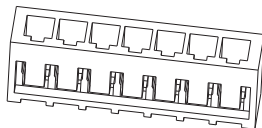
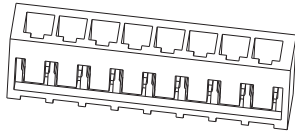
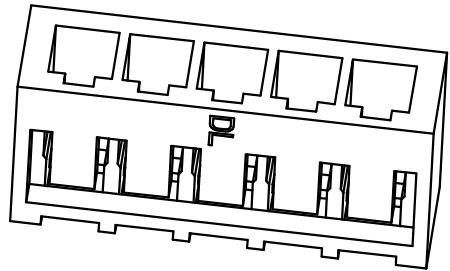
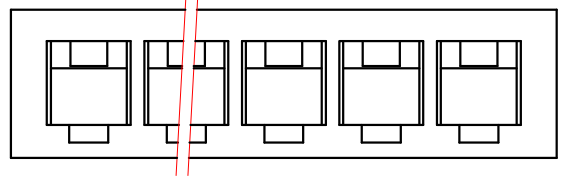
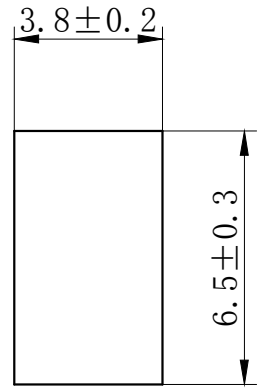
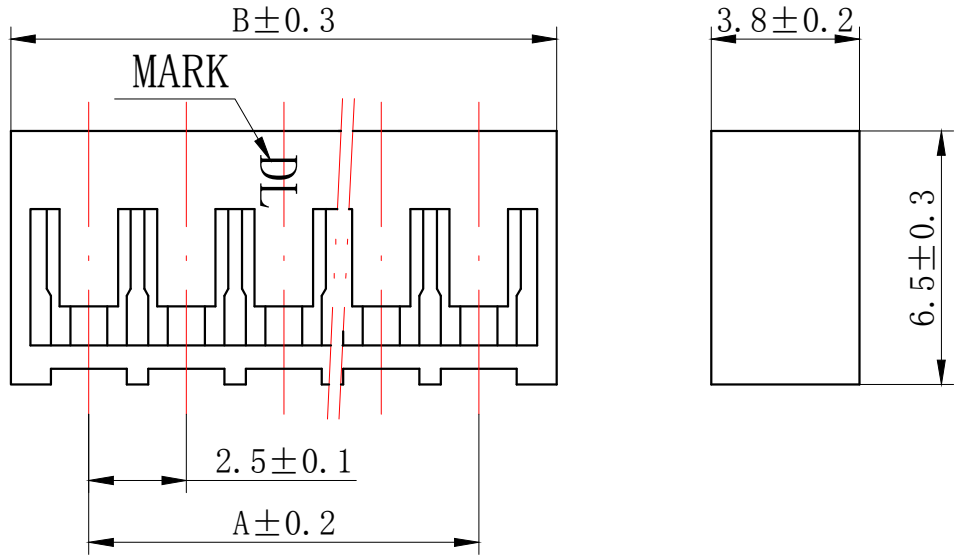

NOTES:

- 1、Rated voltage: 250V AC.DC
- 2、Rated current: 3A AC.DC
- 3、Contact resistance: $\leq 20 \text{ m}\Omega$
- 4、Insulation resistance: $\geq 1000 \text{ M}\Omega$
- 5、Withstand voltage : $\geq 1000 \text{ V AC/minute}$
- 6、Ambient temperature: $-40^\circ\text{C} \sim 105^\circ\text{C}$
- 7、Materials: Nylon UL94-V0(2)
- 8、Matched RoHS criteria

| Circuits | Product name | Dimension mm | | Circuits | Product name | Dimension mm | |
|----------|--------------|--------------|------|----------|--------------|--------------|-------|
| | | A | B | | | A | B |
| 2 | SCNB-2Y | 2.5 | 6.5 | 10 | SCNB-10Y | 22.5 | 26.5 |
| 3 | SCNB-3Y | 5.0 | 9.0 | 11 | SCNB-11Y | 25.0 | 29.0 |
| 4 | SCNB-4Y | 7.5 | 11.5 | 12 | SCNB-12Y | 27.5 | 31.5 |
| 5 | SCNB-5Y | 10.0 | 14.0 | 13 | SCNB-13Y | 30.0 | 34.0 |
| 6 | SCNB-6Y | 12.5 | 16.5 | 14 | SCNB-14Y | 32.5 | 36.5 |
| 7 | SCNB-7Y | 15.0 | 19.0 | 15 | SCNB-15Y | 35.0 | 39.0 |
| 8 | SCNB-8Y | 17.5 | 21.5 | ~ | ~ | ~ | ~ |
| 9 | SCNB-9Y | 20.0 | 24.0 | 20 | SCNB-20Y | 47.5 | 51.50 |

| | | | |
|---------------------------------------|-----------------------|------------------------------------|--|
| GENERAL TOLERANCES (UNLESS SPECIFIED) | | ZHE JIANG DELI CONNECTORS CO., LTD | |
| .X: ± 0.25 | X°: $\pm 3.0^\circ$ | PRODUCT NAME: DL25010 (SCNB) -Y | TITLE: 2.50 mm Pitch Wire To Board Housing |
| .XX: ± 0.15 | .X°: $\pm 2.0^\circ$ | DR: Chen Quan Long | DATE: 19/08/01 |
| .XXX: ± 0.01 | .XX°: $\pm 1.0^\circ$ | CHKD: Wu Hui | DATE: 19/08/01 |
| FINISH: | | APPD: Ren An De | DATE: 19/08/01 |
| DRAWING NO: | | | |
| | | | |

| REV. | REVISION DESCRIPTION | DATE | APPD |
|------|----------------------|------|------|
| | | | |

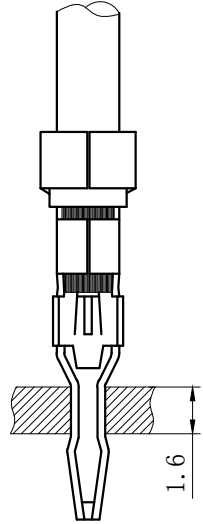
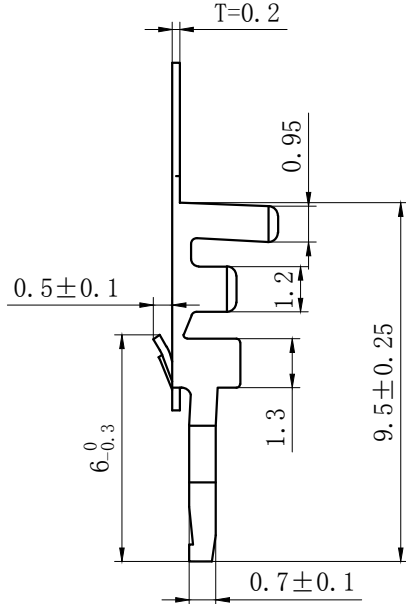
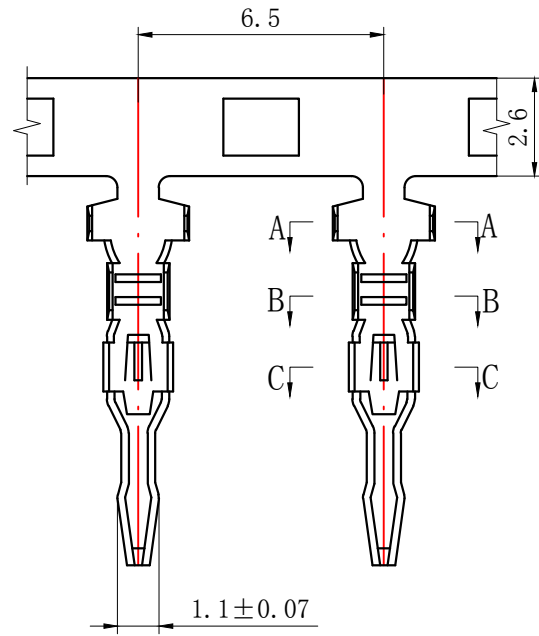

NOTES

Used in DL25009-Y Series Housing.
 Accepts AWG #28~20 Wire Range.
 Insulation O.D. = 0.9~1.9 mm.
 Material : Phosphor Bronze .
 Finish: Tin plated.
 Thickness: 0.2 mm.

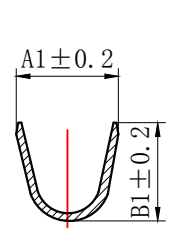

SECTION A-A

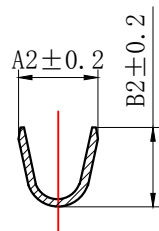

SECTION B-B

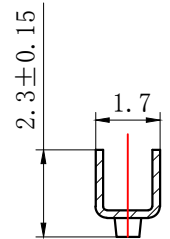

SECTION C-C

| Product name | Dimension mm | | | | 适用线规 AWG# |
|--------------|--------------|-----|-----|-----|--------------|
| | A1 | B1 | A2 | B2 | |
| SCN-T-G | 2.7 | 2.6 | 2.1 | 2.1 | 24-20 |
| SCN-T | 2.7 | 2.6 | 1.8 | 1.4 | 28-22 |

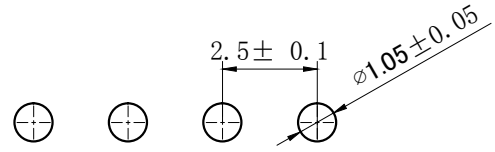

PCB LAYOUT

| GENERAL TOLERANCES (UNLESS SPECIFIED) | | ZHE JIANG DELI CONNECTORS CO., LTD | |
|--|--------------|---|---------------|
| .X: ± 0.25 | X°: ± 3.0° | PRODUCT NAME: DL25009 (SCN) -T | |
| .XX: ± 0.15 | .X°: ± 2.0° | TITLE: 2.00 mm Pitch Wire To Board Crimp Terminal | |
| .XXX: ± 0.01 | .XX°: ± 1.0° | DR: Chen Quan Long | DATE: 20.3.31 |
| FINISH: | | CHKD: Wu Hui | DATE: 20.3.31 |
| DRAWING NO: | | APPD: Ren An De | DATE: 20.3.31 |
| | | SCALE: N/A | PAGE: 1/1 |
| | | UNITS: mm | REV.: A |

X-ON Electronics

Largest Supplier of Electrical and Electronic Components

Click to view similar products for [Headers & Wire Housings](#) category:

Click to view products by [DLL](#) manufacturer:

Other Similar products are found below :

[0015917161](#) [0022155065](#) [57102-F02-18ULF](#) [58102-G61-06LF](#) [582553-1](#) [01.001.5753.1](#) [0050291907](#) [02.125.8002.8](#) [609-3404](#) [61062-3](#)
[CSU011177004](#) [622-0430](#) [622-3653LF](#) [63453-116](#) [636-1030](#) [636-1427](#) [636-3427](#) [636-4007](#) [641938-9](#) [65495-038](#) [65692-001LF](#) [65781-018](#)
[65781-047](#) [65817-010LF](#) [65817-015LF](#) [67095-007LF](#) [67601157](#) [68631-112](#) [68645-018](#) [699319-000](#) [70.362.1628.0](#) [70-4210](#) [70-4226B](#) [70-](#)
[4853B](#) [71.350.2428.0](#) [733-134](#) [733-162](#) [760-3052](#) [MHR-64-VUAL](#) [80.063.4001.1](#) [800-90-001-10-001000](#) [801-43-002-10-013000](#)
[801-43-006-10-002000](#) [803-43-024-10-001000](#) [803-93-012-10-001000](#) [8-1437020-4](#) [819-22-004-30-001101](#) [820-22-006-30-001101](#)
[820-22-008-30-001101](#) [821-22-002-10-001101](#)