

**技术特性/Specifications:**

额定电压 Rated voltage: 250V AC, DC  
额定电流 Rated current: 3A AC, DC  
接触电阻 Contact resistance: 20mΩ max  
绝缘电阻 Insulation resistance: 1000MΩ min  
耐压 Withstand voltage: 1000V AC/minute  
环境温度 Ambient temperature: -40°C~+105°C  
适用线规 Wire range: AWG#28~#20

| REV. | REVISION DESCRIPTION | DATE | APPD |
|------|----------------------|------|------|
|      |                      |      |      |

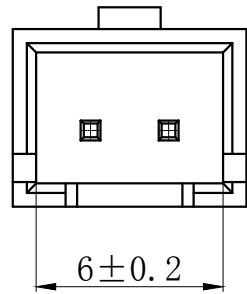
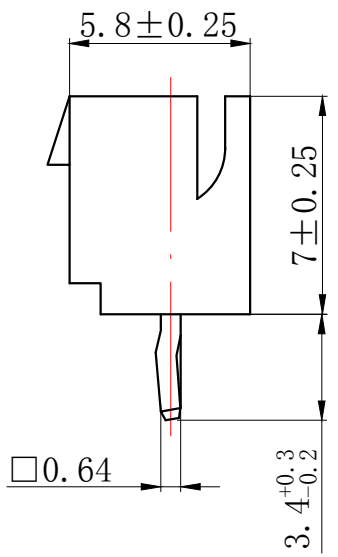
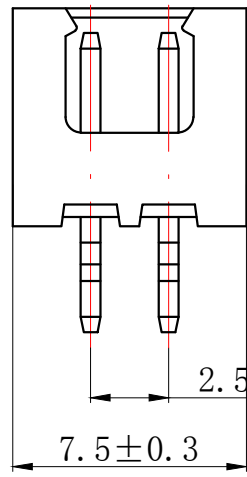
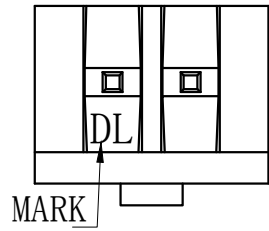

**NOTES**

Available in 02Circuits.  
 Mates with DL25023-Y Series Housing.  
 Material : Nylon UL94V-0(2) .  
 0.64mm Square Pin.  
 Pin Material : Brass / Tin-Plated.

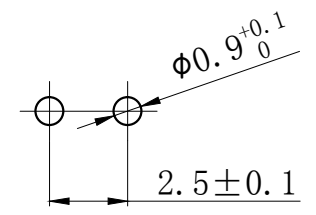

PCB LAYOUT

| GENERAL TOLERANCES (UNLESS SPECIFIED) |               | ZHE JIANG DELI CONNECTORS CO ., LTD |  |
|---------------------------------------|---------------|-------------------------------------|--|
| .X: ± 0.25                            | X° : ± 3.0°   | PRODUCT NAME:                       | TITLE: 2.50 mm Pitch Wire To Board Wafer |
| .XX: ± 0.15                           | .X° : ± 2.0°  | DL25023 (TJC3D)-2A                  |  |
| .XXX: ± 0.01                          | .XX° : ± 1.0° | DR:Chen Quan Long                   | DATE:19/08/01                            |
| FINISH:                               |               | CHKD: Wu Hui                        | DATE:19/08/01                            |
| DRAWING NO:                           |               | APPD:Ren An De                      | DATE:19/08/01                            |
|                                       |               |                                     | SCALE: N/A                               |
|                                       |               |                                     | PAGE: 1/1                                |
|                                       |               |                                     | UNITS: mm                                |
|                                       |               |                                     | REV. : A                                 |

|      |                      |      |      |
|------|----------------------|------|------|
| REV. | REVISION DESCRIPTION | DATE | APPD |
|      |                      |      |      |

### NOTES

Available in 03 through 15 Circuits.  
 Mates with DL25023-Y Series Housing.  
 Material : Nylon UL94V-0(2) .  
 0.64mm Square Pin.  
 Pin Material : Brass / Tin-Plated.

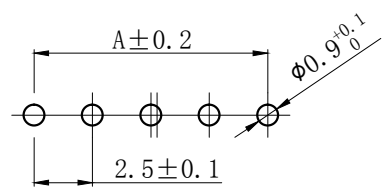
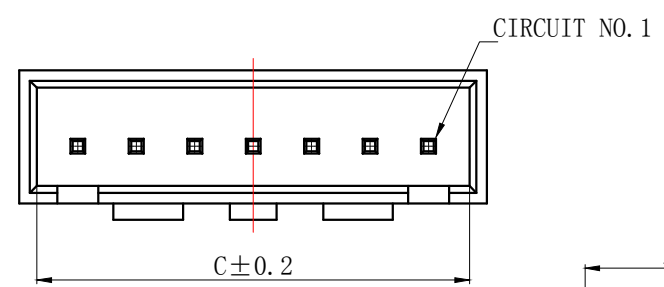
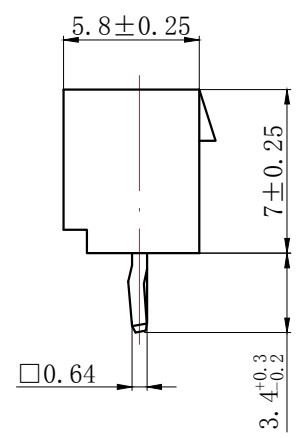
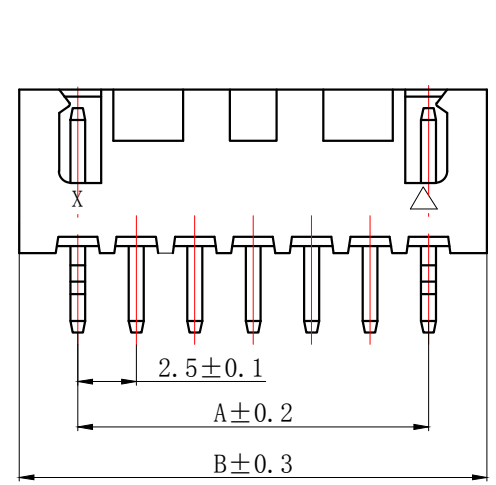
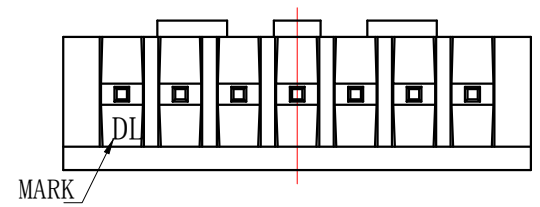

PCB LAYOUT

| Circuits | Product name | Dimension mm |       |       | Circuits | Product name | Dimension mm |       |       |
|----------|--------------|--------------|-------|-------|----------|--------------|--------------|-------|-------|
|          |              | A            | B     | C     |          |              | A            | B     | C     |
| 3        | TJC3D-3A     | 5.00         | 10.00 | 8.50  | 10       | TJC3D-10A    | 22.50        | 27.50 | 26.00 |
| 4        | TJC3D-4A     | 7.50         | 12.50 | 11.00 | 11       | TJC3D-11A    | 25.00        | 30.00 | 28.50 |
| 5        | TJC3D-5A     | 10.00        | 15.00 | 13.50 | 12       | TJC3D-12A    | 27.50        | 32.50 | 31.00 |
| 6        | TJC3D-6A     | 12.50        | 17.50 | 16.00 | 13       | TJC3D-13A    | 30.00        | 35.00 | 33.50 |
| 7        | TJC3D-7A     | 15.00        | 20.00 | 18.50 | 14       | TJC3D-14A    | 32.50        | 37.50 | 36.00 |
| 8        | TJC3D-8A     | 17.50        | 22.50 | 21.00 | 15       | TJC3D-15A    | 35.00        | 40.00 | 38.50 |
| 9        | TJC3D-9A     | 20.00        | 25.00 | 23.50 |          |              |              |       |       |

|  |               |                                    |  |
|--|---------------|------------------------------------|--|
| GENERAL TOLERANCES<br>(UNLESS SPECIFIED) |               | ZHE JIANG DELI CONNECTORS CO., LTD |  |
| .X: ± 0.25                               | X° : ± 3.0°   | PRODUCT NAME:<br>DL25023 (TJC3D)-A | TITLE:<br>2.50 mm Pitch<br>Wire To Board Wafer |
| .XX: ± 0.15                              | .X° : ± 2.0°  | DR: Chen Quan Long                 | DATE: 19/08/01                                 |
| .XXX: ± 0.01                             | .XX° : ± 1.0° | CHKD: Wu Hui                       | DATE: 19/08/01                                 |
| FINISH:                                  |               | APPD: Ren An De                    | DATE: 19/08/01                                 |
| DRAWING NO:                              |               | SCALE: N/A                         | PAGE: 1/1                                      |
|  |               | UNITS: mm                          | REV.: A  |

| REV. | REVISION DESCRIPTION | DATE | APPD |
|------|----------------------|------|------|
|      |                      |      |      |

### NOTES

Available in 02 Circuits.  
 Mates with DL25023-Y Series Housing.  
 Material : Nylon UL94V-0(2).  
 0.64mm Square Pin.  
 Pin Material : Brass / Tin-Plated.

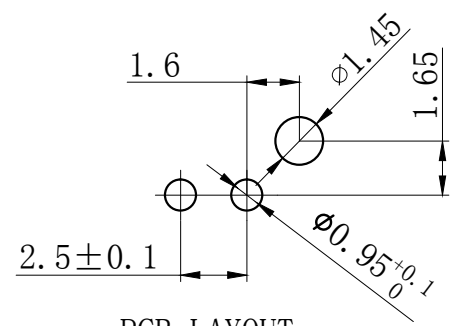
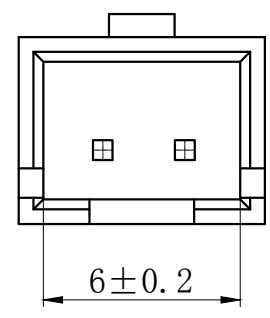
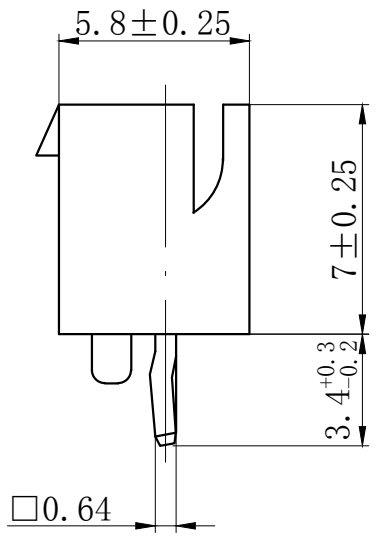
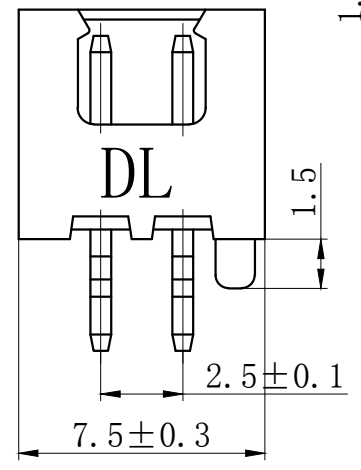
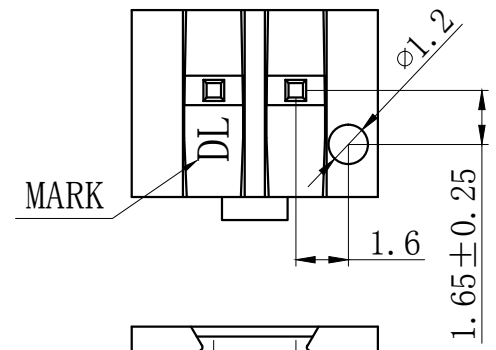

PCB LAYOUT

| GENERAL TOLERANCES (UNLESS SPECIFIED) |               | ZHE JIANG DELI CONNECTORS CO., LTD |  |
|---------------------------------------|---------------|------------------------------------|--|
| .X: ± 0.25                            | X° : ± 3.0°   | PRODUCT NAME:                      | TITLE: 2.50 mm Pitch Wire To Board Wafer |
| .XX: ± 0.15                           | .X° : ± 2.0°  | DL25023(TJC3D)-2AS                 |  |
| .XXX: ± 0.01                          | .XX° : ± 1.0° | DR: Chen Quan Long                 | DATE:19/08/01                            |
| FINISH:                               |               | CHKD: Wu Hui                       | DATE:19/08/01                            |
| DRAWING NO:                           |               | APPD:Ren An De                     | DATE:19/08/01                            |
|                                       |               | SCALE: N/A                         | PAGE: 1/1                                |
|                                       |               | UNITS: mm                          | REV.: A                                  |

| REV. | REVISION DESCRIPTION | DATE | APPD |
|------|----------------------|------|------|
|      |                      |      |      |

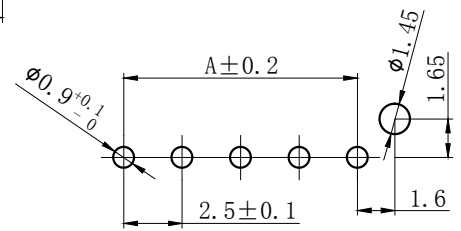
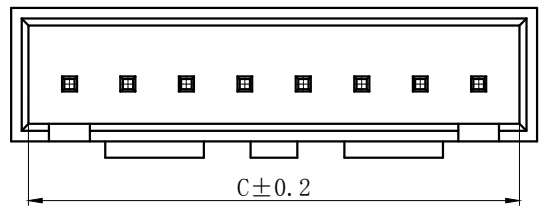
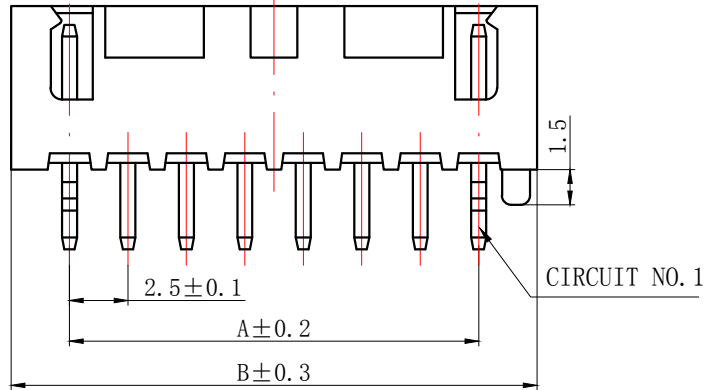
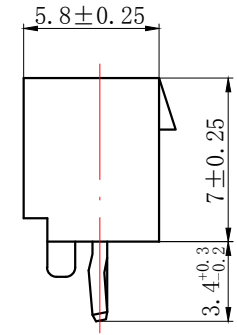
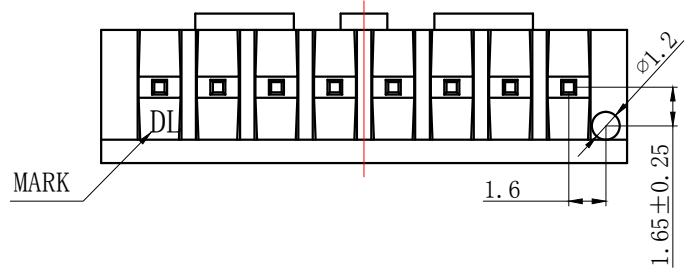

### NOTES

Available in 03 through 15 Circuits.  
Mates with DL25023-Y Series Housing.  
Material : Nylon UL94V-0(2).  
0.64mm Square Pin.  
Pin Material : Brass / Tin-Plated.

| Circuits | Product name | Dimension mm |       |       | Circuits | Product name | Dimension mm |       |       |
|----------|--------------|--------------|-------|-------|----------|--------------|--------------|-------|-------|
|          |              | A            | B     | C     |          |              | A            | B     | C     |
| 3        | TJC3D-3AS    | 5.00         | 10.00 | 8.50  | 10       | TJC3D-10AS   | 22.50        | 27.50 | 26.00 |
| 4        | TJC3D-4AS    | 7.50         | 12.50 | 11.00 | 11       | TJC3D-11AS   | 25.00        | 30.00 | 28.50 |
| 5        | TJC3D-5AS    | 10.00        | 15.00 | 13.50 | 12       | TJC3D-12AS   | 27.50        | 32.50 | 31.00 |
| 6        | TJC3D-6AS    | 12.50        | 17.50 | 16.00 | 13       | TJC3D-13AS   | 30.00        | 35.00 | 33.50 |
| 7        | TJC3D-7AS    | 15.00        | 20.00 | 18.50 | 14       | TJC3D-14AS   | 32.50        | 37.50 | 36.00 |
| 8        | TJC3D-8AS    | 17.50        | 22.50 | 21.00 | 15       | TJC3D-15AS   | 35.00        | 40.00 | 38.50 |
| 9        | TJC3D-9AS    | 20.00        | 25.00 | 23.50 | -        | -            | -            | -     | -     |

|                                       |             |                                    |  |
|---------------------------------------|-------------|------------------------------------|--|
| GENERAL TOLERANCES (UNLESS SPECIFIED) |             | ZHE JIANG DELI CONNECTORS CO., LTD |  |
| .X: ±0.25                             | X°: ±3.0°   | PRODUCT NAME:                      | TITLE: 2.50 mm Pitch Wire To Board Wafer |
| .XX: ±0.15                            | .X°: ±2.0°  | DL25023 (TJC3D)-AS                 |  |
| .XXX: ±0.01                           | .XX°: ±1.0° | DR: Chen Quan Long                 | DATE:19/08/01                            |
| FINISH:                               |             | CHKD: Wu Hui                       | DATE:19/08/01                            |
| DRAWING NO:                           |             | APPD:Ren An De                     | DATE:19/08/01                            |
|                                       |             | SCALE: N/A                         | PAGE: 1/1                                |
|                                       |             | UNITS: mm                          | REV.: A                                  |

| REV. | REVISION DESCRIPTION | DATE | APPD |
|------|----------------------|------|------|
|      |                      |      |      |

### NOTES

Available in 02 Circuits.

Mates with DL25023-Y Series Housing.

Material : Nylon UL94V-0(2).

0.64mm Square Pin.

Pin Material : Brass / Tin-Plated.

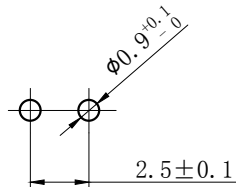
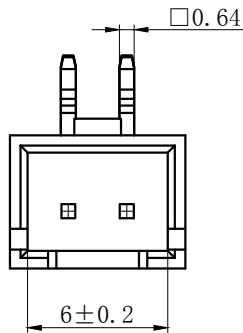
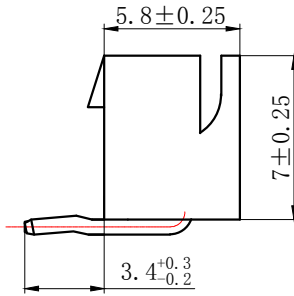
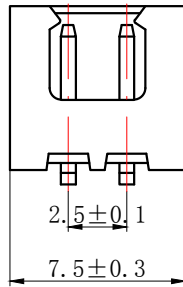
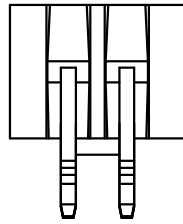

PCB LAYOUT

| GENERAL TOLERANCES<br>(UNLESS SPECIFIED) |             | ZHE JIANG DELI CONNECTORS CO., LTD   |                |  |           |
|--|-------------|--------------------------------------|----------------|--|-----------|
| .X: ±0.25                                | X°: ±3.0°   | PRODUCT NAME:<br>DL25023 (TJC3D)-2AW |                | TITLE:<br>2.50 mm Pitch<br>Wire To Board Wafer |           |
| .XX: ±0.15                               | .X°: ±2.0°  | DR: Yuan Jun Rong                    | DATE: 19/08/01 | PART NO:<br>DL25023-2W-XXX-XX-X-XX             |           |
| .XXX: ±0.01                              | .XX°: ±1.0° | CHKD: Wu Hui                         | DATE: 19/08/01 | SCALE: N/A                                     | PAGE: 1/1 |
| FINISH:                                  |             | APPD: Ren An De                      | DATE: 19/08/01 | UNITS: mm                                      | REV.: A   |
| DRAWING NO:<br>GC-DL25023-2W-XXX-XX-X-XX |             |                                      |                |  |           |

| REV. | REVISION DESCRIPTION | DATE | APPD |
|------|----------------------|------|------|
|      |                      |      |      |

A  
B  
C  
D  
E  
F

A  
B  
C  
D  
E  
F

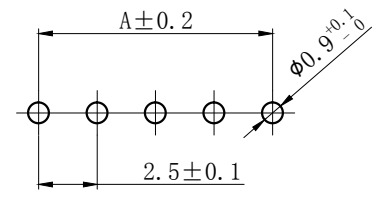
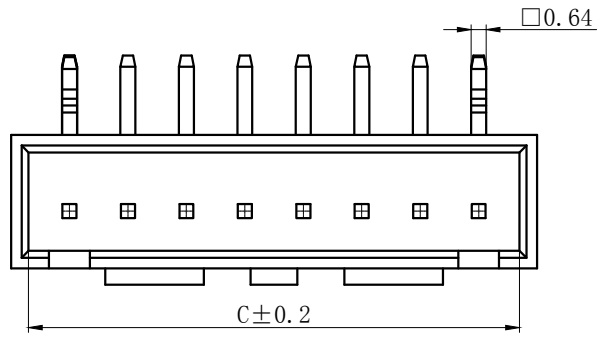
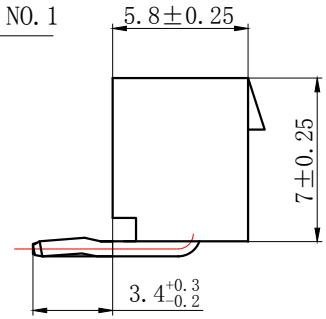
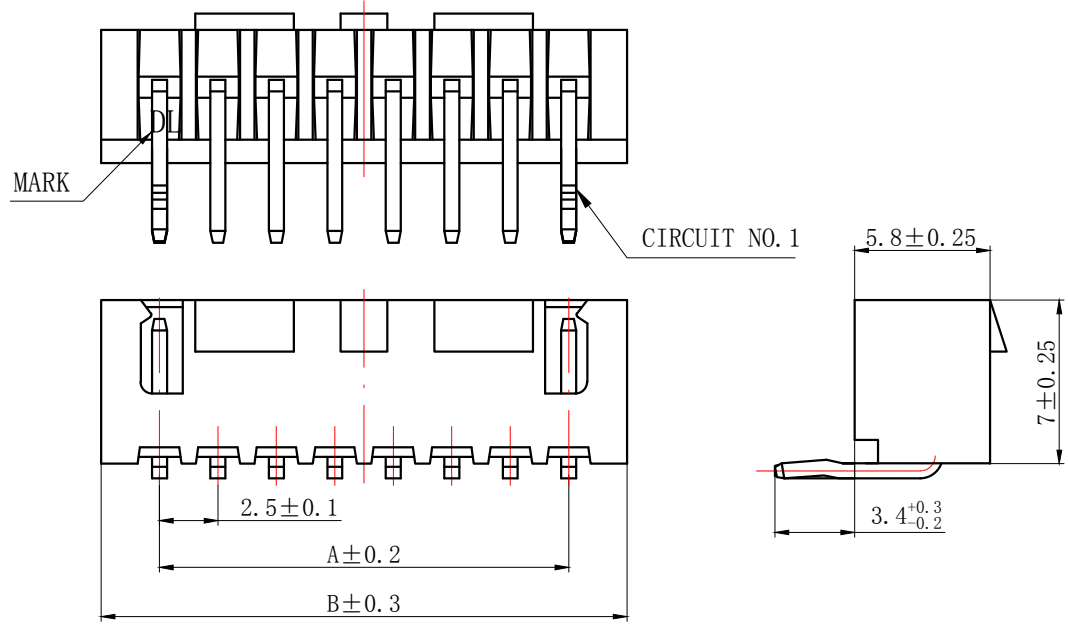

PCB LAYOUT

### NOTES

Available in 03 through 15 Circuits.  
 Mates with DL25023-Y Series Housing.  
 Material : Nylon UL94V-0(2).  
 0.64mm Square Pin.  
 Pin Material : Brass / Tin-Plated.

| Circuits | Product name | Dimension mm |       |       | Circuits | Product name | Dimension mm |       |       |
|----------|--------------|--------------|-------|-------|----------|--------------|--------------|-------|-------|
|          |              | A            | B     | C     |          |              | A            | B     | C     |
| 3        | TJC3D-3AW-K  | 5.00         | 10.00 | 8.50  | 10       | TJC3D-10AW-K | 22.50        | 27.50 | 26.00 |
| 4        | TJC3D-4AW-K  | 7.50         | 12.50 | 11.00 | 11       | TJC3D-11AW-K | 25.00        | 30.00 | 28.50 |
| 5        | TJC3D-5AW-K  | 10.00        | 15.00 | 13.50 | 12       | TJC3D-12AW-K | 27.50        | 32.50 | 31.00 |
| 6        | TJC3D-6AW-K  | 12.50        | 17.50 | 16.00 | 13       | TJC3D-13AW-K | 30.00        | 35.00 | 33.50 |
| 7        | TJC3D-7AW-K  | 15.00        | 20.00 | 18.50 | 14       | TJC3D-14AW-K | 32.50        | 37.50 | 36.00 |
| 8        | TJC3D-8AW-K  | 17.50        | 22.50 | 21.00 | 15       | TJC3D-15AW-K | 35.00        | 40.00 | 38.50 |
| 9        | TJC3D-9AW-K  | 20.00        | 25.00 | 23.50 |          |              |              |       |       |

|                                       |             |                                    |  |
|---------------------------------------|-------------|------------------------------------|--|
| GENERAL TOLERANCES (UNLESS SPECIFIED) |             | ZHE JIANG DELI CONNECTORS CO., LTD |  |
| .X: ±0.25                             | X°: ±3.0°   | PRODUCT NAME:                      | TITLE: 2.50 mm Pitch Wire To Board Wafer |
| .XX: ±0.15                            | .X°: ±2.0°  | DL25023 (TJC3D)-AW-K               |  |
| .XXX: ±0.01                           | .XX°: ±1.0° | DR: Yuan Jun Rong                  | DATE:19/08/01                            |
| FINISH:                               |             | CHKD: Wu Hui                       | DATE:19/08/01                            |
| DRAWING NO:                           |             | APPD:Ren An De                     | DATE:19/08/01                            |
|                                       |             | SCALE: N/A                         | PAGE: 1/1                                |
|                                       |             | UNITS: mm                          | REV.: A                                  |

F

1 2 3 4 5 6 7 8

| REV. | REVISION DESCRIPTION | DATE | APPD |
|------|----------------------|------|------|
|      |                      |      |      |

### NOTES

Available in 022 Circuits.

Mates with DL25023-Y Series Housing.

Material : Nylon UL94V-0(2).

0.64mm Square Pin.

Pin Material : Brass / Tin-Plated.

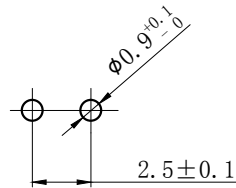
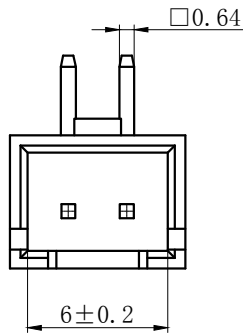
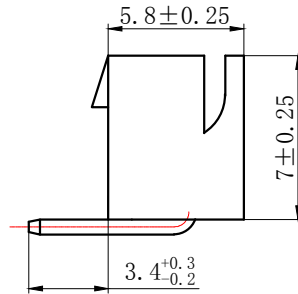
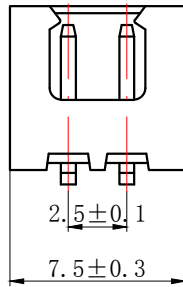
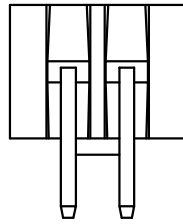

PCB LAYOUT

| GENERAL TOLERANCES<br>(UNLESS SPECIFIED) |             | ZHE JIANG DELI CONNECTORS CO., LTD |  |
|--|-------------|------------------------------------|--|
| .X: ±0.25                                | X°: ±3.0°   | PRODUCT NAME:                      | TITLE: 2.50 mm Pitch Wire To Board Wafer |
| .XX: ±0.15                               | .X°: ±2.0°  | DL25023(TJC3D)-2AW-Z               |  |
| .XXX: ±0.01                              | .XX°: ±1.0° | DR: Chen Quan Long                 | DATE:19/08/01                            |
| FINISH:                                  |             | CHKD: Wu Hui                       | DATE:19/08/01                            |
| DRAWING NO:                              |             | APPD:Ren An De                     | DATE:19/08/01                            |
|  |             | SCALE: N/A                         | PAGE: 1/1                                |
|  |             | UNITS: mm                          | REV.: A                                  |



| REV. | REVISION DESCRIPTION | DATE | APPD |
|------|----------------------|------|------|
|      |                      |      |      |

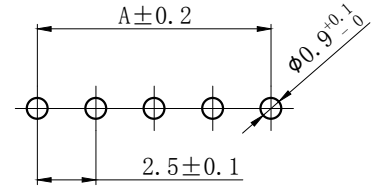
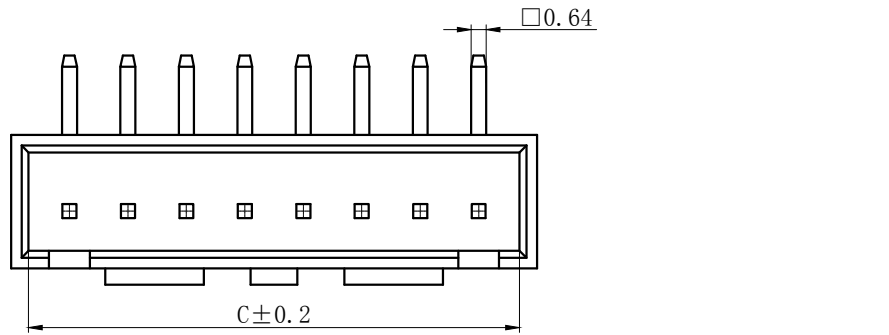
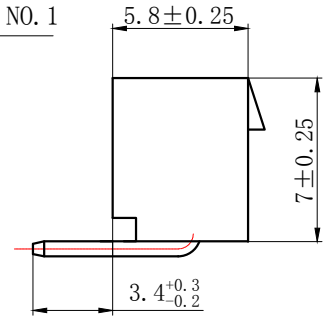
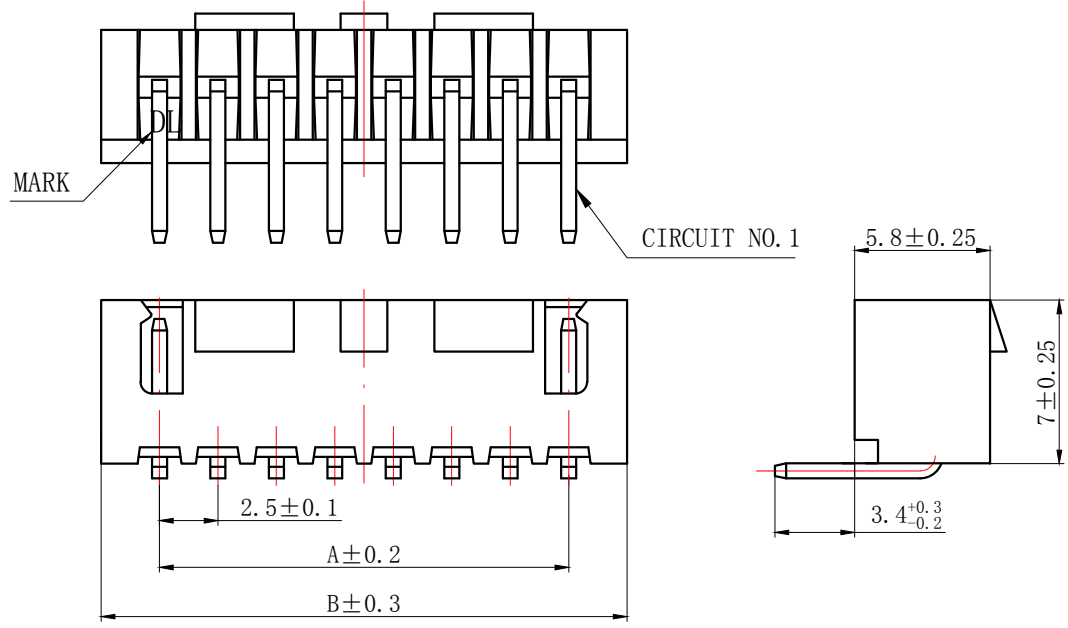

PCB LAYOUT

### NOTES

Available in 03 through 15 Circuits.  
 Mates with DL25023-Y Series Housing.  
 Material : Nylon UL94V-0(2).  
 0.64mm Square Pin.  
 Pin Material : Brass / Tin-Plated.

| Circuits | Product name | Dimension mm |       |       | Circuits | Product name | Dimension mm |       |       |
|----------|--------------|--------------|-------|-------|----------|--------------|--------------|-------|-------|
|          |              | A            | B     | C     |          |              | A            | B     | C     |
| 3        | TJC3D-3AW-Z  | 5.00         | 10.00 | 8.50  | 10       | TJC3D-10AW-Z | 22.50        | 27.50 | 26.00 |
| 4        | TJC3D-4AW-Z  | 7.50         | 12.50 | 11.00 | 11       | TJC3D-11AW-Z | 25.00        | 30.00 | 28.50 |
| 5        | TJC3D-5AW-Z  | 10.00        | 15.00 | 13.50 | 12       | TJC3D-12AW-Z | 27.50        | 32.50 | 31.00 |
| 6        | TJC3D-6AW-Z  | 12.50        | 17.50 | 16.00 | 13       | TJC3D-13AW-Z | 30.00        | 35.00 | 33.50 |
| 7        | TJC3D-7AW-Z  | 15.00        | 20.00 | 18.50 | 14       | TJC3D-14AW-Z | 32.50        | 37.50 | 36.00 |
| 8        | TJC3D-8AW-Z  | 17.50        | 22.50 | 21.00 | 15       | TJC3D-15AW-Z | 35.00        | 40.00 | 38.50 |
| 9        | TJC3D-9AW-Z  | 20.00        | 25.00 | 23.50 |          |              |              |       |       |

| GENERAL TOLERANCES (UNLESS SPECIFIED) |               | ZHE JIANG DELI CONNECTORS CO., LTD |  |
|---------------------------------------|---------------|------------------------------------|--|
| .X: ±0.25                             | X° : ± 3.0°   | PRODUCT NAME:                      | TITLE: 2.50 mm Pitch Wire To Board Wafer |
| .XX: ± 0.15                           | .X° : ± 2.0°  | DL25023 (TJC3D)-AW-Z               |  |
| .XXX: ± 0.01                          | .XX° : ± 1.0° | DR: Chen Quan Long                 | DATE:19/08/01                            |
| FINISH:                               |               | CHKD: Wu Hui                       | DATE:19/08/01                            |
| DRAWING NO:                           |               | APPD:Ren An De                     | DATE:19/08/01                            |
|                                       |               | SCALE: N/A                         | PAGE: 1/1                                |
|                                       |               | UNITS: mm                          | REV.: A                                  |

| REV. | REVISION DESCRIPTION | DATE | APPD |
|------|----------------------|------|------|
|      |                      |      |      |

### NOTES

Available in 02 Circuits.

Mates with DL25023-Y Series Housing.

Material : Nylon UL94V-0(2).

0.64mm Square Pin.

Pin Material : Brass / Tin-Plated.

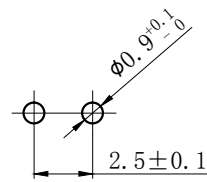
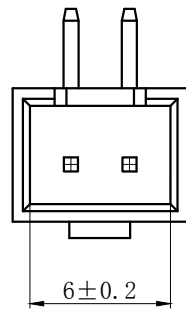
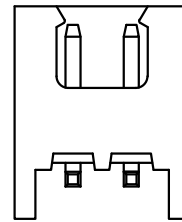
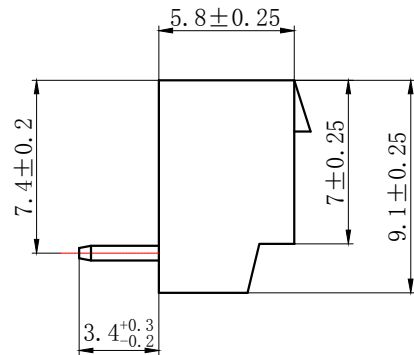
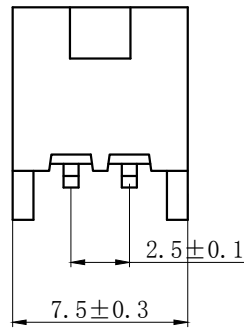
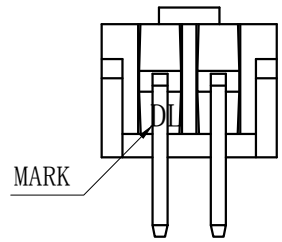

PCB LAYOUT

| GENERAL TOLERANCES<br>(UNLESS SPECIFIED) |             | ZHE JIANG DELI CONNECTORS CO., LTD |   |
|--|-------------|------------------------------------|---|
| .X: ±0.25                                | X°: ±3.0°   | PRODUCT NAME:                      | TITLE: 2.50 mm Pitch<br>Wire To Board Wafer |
| .XX: ±0.15                               | .X°: ±2.0°  | DL25023 (TJC3D)-2AWD-Z             |   |
| .XXX: ±0.01                              | .XX°: ±1.0° | DR: Chen Quan Long                 | DATE:19/08/01                               |
| FINISH:                                  |             | CHKD: Wu Hui                       | DATE:19/08/01                               |
| DRAWING NO:                              |             | APPD:Ren An De                     | DATE:19/08/01                               |
|  |             |                                    | PART NO:                                    |
|  |             |                                    | SCALE: N/A                                  |
|  |             |                                    | PAGE: 1/1                                   |
|  |             |                                    | UNITS: mm                                   |
|  |             |                                    | REV.: A                                     |

| REV. | REVISION DESCRIPTION | DATE | APPD |
|------|----------------------|------|------|
|      |                      |      |      |

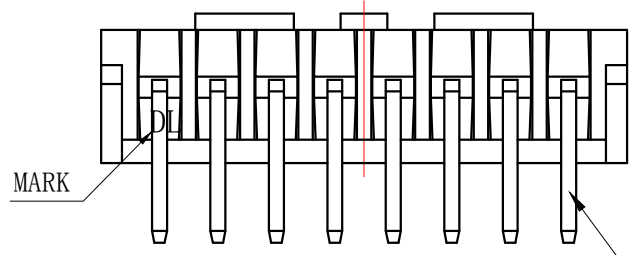

CIRCUIT NO. 1

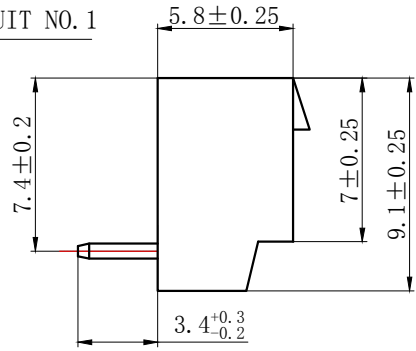
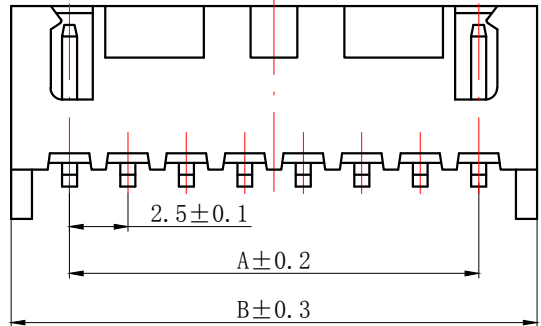

### NOTES

Available in 03 through 15 Circuits.  
 Mates with DL25023-Y Series Housing.  
 Material : Nylon UL94V-0(2).  
 0.64mm Square Pin.  
 Pin Material : Brass / Tin-Plated.

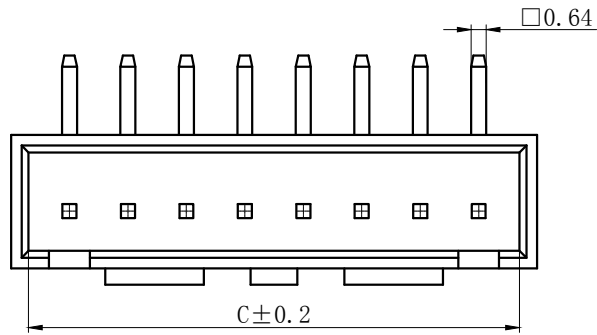

| Circuits | Product name | Dimension mm |       |       | Circuits | Product name  | Dimension mm |       |       |
|----------|--------------|--------------|-------|-------|----------|---------------|--------------|-------|-------|
|          |              | A            | B     | C     |          |               | A            | B     | C     |
| 3        | TJC3D-3AWD-Z | 5.00         | 10.00 | 8.50  | 10       | TJC3D-10AWD-Z | 22.50        | 27.50 | 26.00 |
| 4        | TJC3D-4AWD-Z | 7.50         | 12.50 | 11.00 | 11       | TJC3D-11AWD-Z | 25.00        | 30.00 | 28.50 |
| 5        | TJC3D-5AWD-Z | 10.00        | 15.00 | 13.50 | 12       | TJC3D-12AWD-Z | 27.50        | 32.50 | 31.00 |
| 6        | TJC3D-6AWD-Z | 12.50        | 17.50 | 16.00 | 13       | TJC3D-13AWD-Z | 30.00        | 35.00 | 33.50 |
| 7        | TJC3D-7AWD-Z | 15.00        | 20.00 | 18.50 | 14       | TJC3D-14AWD-Z | 32.50        | 37.50 | 36.00 |
| 8        | TJC3D-8AWD-Z | 17.50        | 22.50 | 21.00 | 15       | TJC3D-15AWD-Z | 35.00        | 40.00 | 38.50 |
| 9        | TJC3D-9AWD-Z | 20.00        | 25.00 | 23.50 |          |               |              |       |       |

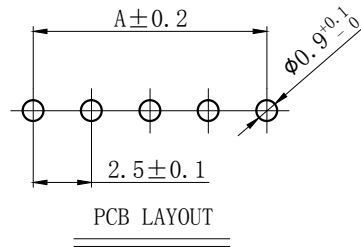

|                                       |             |                                    |  |
|---------------------------------------|-------------|------------------------------------|--|
| GENERAL TOLERANCES (UNLESS SPECIFIED) |             | ZHE JIANG DELI CONNECTORS CO., LTD |  |
| .X: ±0.25                             | X°: ±3.0°   | PRODUCT NAME:                      | TITLE: 2.50 mm Pitch Wire To Board Wafer |
| .XX: ±0.15                            | .X°: ±2.0°  | DL25023 (TJC3D)-AWD-Z              |  |
| .XXX: ±0.01                           | .XX°: ±1.0° | DR: Chen Quan Long                 | DATE:19/08/01                            |
| FINISH:                               |             | CHKD: Wu Hui                       | DATE:19/08/01                            |
| DRAWING NO:                           |             | APPD:Ren An De                     | DATE:19/08/01                            |
|                                       |             |                                    | PART NO:                                 |
|                                       |             |                                    | SCALE: N/A                               |
|                                       |             |                                    | PAGE: 1/1                                |
|                                       |             |                                    | UNITS: mm                                |
|                                       |             |                                    | REV.: A                                  |

| REV. | REVISION DESCRIPTION | DATE | APPD |
|------|----------------------|------|------|
|      |                      |      |      |

### NOTES

Available in 02 Circuits.

Mates with DL25023-Y Series Housing.

Material : Nylon UL94V-0(2).

0.64mm Square Pin.

Pin Material : Brass / Tin-Plated.

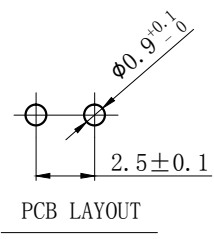
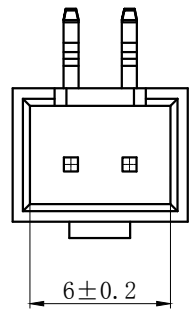
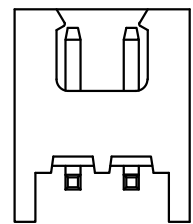
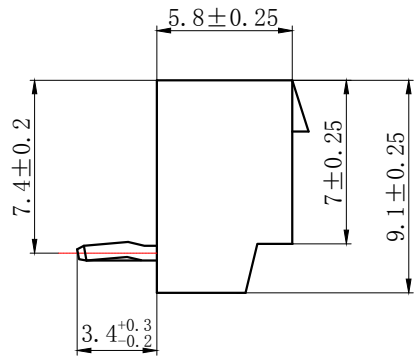
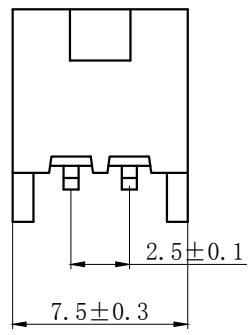
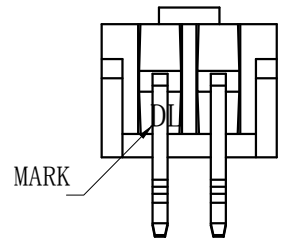

| GENERAL TOLERANCES<br>(UNLESS SPECIFIED) |             | ZHE JIANG DELI CONNECTORS CO., LTD |   |
|--|-------------|------------------------------------|---|
| .X: ±0.25                                | X°: ±3.0°   | PRODUCT NAME:                      | TITLE: 2.50 mm Pitch<br>Wire To Board Wafer |
| .XX: ±0.15                               | .X°: ±2.0°  | DL25023 (TJC3D)-2AWD-K             |   |
| .XXX: ±0.01                              | .XX°: ±1.0° | DR: Chen Quan Long                 | DATE:19/08/01                               |
| FINISH:                                  |             | CHKD: Wu Hui                       | DATE:19/08/01                               |
| DRAWING NO:                              |             | APPD:Ren An De                     | DATE:19/08/01                               |
|  |             | SCALE: N/A                         | PAGE: 1/1                                   |
|  |             | UNITS: mm                          | REV.: A                                     |

| REV. | REVISION DESCRIPTION | DATE | APPD |
|------|----------------------|------|------|
|      |                      |      |      |

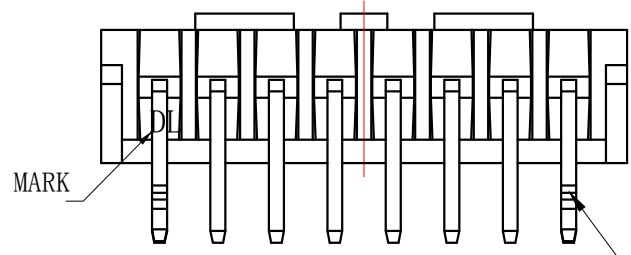

CIRCUIT NO. 1

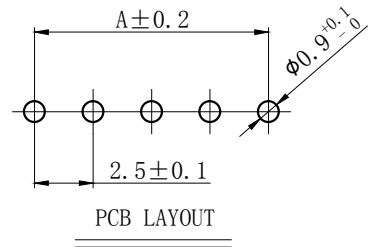
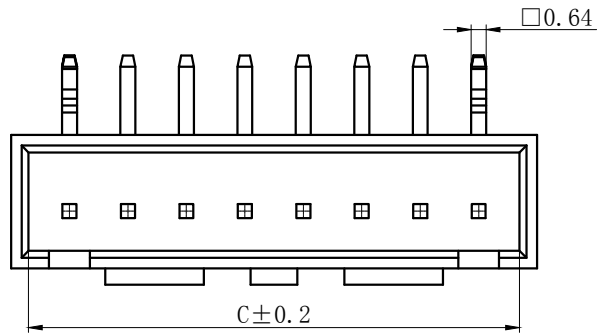
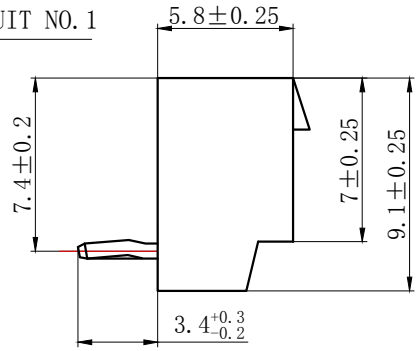
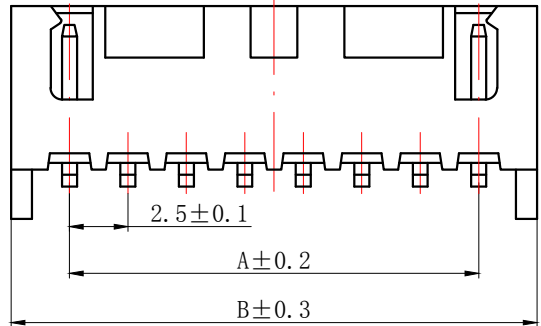

### NOTES

Available in 03 through 15 Circuits.  
 Mates with DL25023-Y Series Housing.  
 Material : Nylon UL94V-0(2).  
 0.64mm Square Pin.  
 Pin Material : Brass / Tin-Plated.

| Circuits | Product name | Dimension mm |       |       | Circuits | Product name  | Dimension mm |       |       |
|----------|--------------|--------------|-------|-------|----------|---------------|--------------|-------|-------|
|          |              | A            | B     | C     |          |               | A            | B     | C     |
| 3        | TJC3D-3AWD-K | 5.00         | 10.00 | 8.50  | 10       | TJC3D-10AWD-K | 22.50        | 27.50 | 26.00 |
| 4        | TJC3D-4AWD-K | 7.50         | 12.50 | 11.00 | 11       | TJC3D-11AWD-K | 25.00        | 30.00 | 28.50 |
| 5        | TJC3D-5AWD-K | 10.00        | 15.00 | 13.50 | 12       | TJC3D-12AWD-K | 27.50        | 32.50 | 31.00 |
| 6        | TJC3D-6AWD-K | 12.50        | 17.50 | 16.00 | 13       | TJC3D-13AWD-K | 30.00        | 35.00 | 33.50 |
| 7        | TJC3D-7AWD-K | 15.00        | 20.00 | 18.50 | 14       | TJC3D-14AWD-K | 32.50        | 37.50 | 36.00 |
| 8        | TJC3D-8AWD-K | 17.50        | 22.50 | 21.00 | 15       | TJC3D-15AWD-K | 35.00        | 40.00 | 38.50 |
| 9        | TJC3D-9AWD-K | 20.00        | 25.00 | 23.50 |          |               |              |       |       |

| GENERAL TOLERANCES (UNLESS SPECIFIED) |             | ZHE JIANG DELI CONNECTORS CO., LTD |  |
|---------------------------------------|-------------|------------------------------------|--|
| .X: ±0.25                             | .X°: ±3.0°  | PRODUCT NAME:                      | TITLE: 2.50 mm Pitch Wire To Board Wafer |
| .XX: ±0.15                            | .X°: ±2.0°  | DL25023 (TJC3D)-AWD-K              |  |
| .XXX: ±0.01                           | .XX°: ±1.0° | DR: Chen Quan Long                 | DATE:19/08/01                            |
| FINISH:                               |             | CHKD: Wu Hui                       | DATE:19/08/01                            |
| DRAWING NO:                           |             | APPD:Ren An De                     | DATE:19/08/01                            |
|                                       |             |                                    | PART NO:                                 |
|                                       |             |                                    | SCALE: N/A                               |
|                                       |             |                                    | PAGE: 1/1                                |
|                                       |             |                                    | UNITS: mm                                |
|                                       |             |                                    | REV.: A                                  |

| REV. | REVISION DESCRIPTION | DATE | APPD |
|------|----------------------|------|------|
|      |                      |      |      |

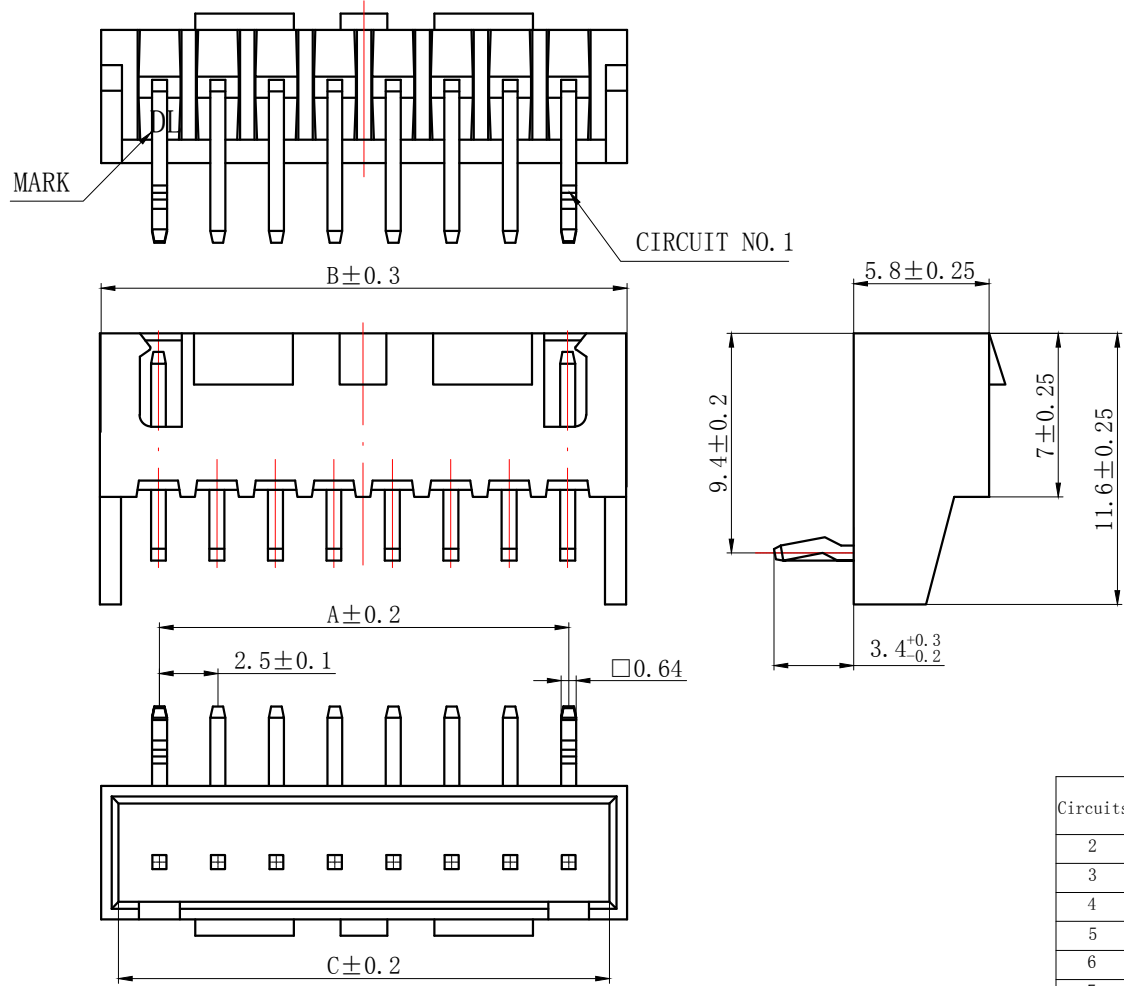

### NOTES

Available in 02 through 15 Circuits.  
 Mates with DL25023-Y Series Housing.  
 Material : Nylon UL94V-0(2).  
 0.64mm Square Pin.  
 Pin Material : Brass / Tin-Plated.

| Circuits | Product name | Dimension mm |       |       | Circuits | Product name | Dimension mm |       |       |
|----------|--------------|--------------|-------|-------|----------|--------------|--------------|-------|-------|
|          |              | A            | B     | C     |          |              | A            | B     | C     |
| 2        | TJC3D-2AWF   | 2.50         | 7.50  | 6.50  | 9        | TJC3D-9AWF   | 20.00        | 25.00 | 23.50 |
| 3        | TJC3D-3AWF   | 5.00         | 10.00 | 8.50  | 10       | TJC3D-10AWF  | 22.50        | 27.50 | 26.00 |
| 4        | TJC3D-4AWF   | 7.50         | 12.50 | 11.00 | 11       | TJC3D-11AWF  | 25.00        | 30.00 | 28.50 |
| 5        | TJC3D-5AWF   | 10.00        | 15.00 | 13.50 | 12       | TJC3D-12AWF  | 27.50        | 32.50 | 31.00 |
| 6        | TJC3D-6AWF   | 12.50        | 17.50 | 16.00 | 13       | TJC3D-13AWF  | 30.00        | 35.00 | 33.50 |
| 7        | TJC3D-7AWF   | 15.00        | 20.00 | 18.50 | 14       | TJC3D-14AWF  | 32.50        | 37.50 | 36.00 |
| 8        | TJC3D-8AWF   | 17.50        | 22.50 | 21.00 | 15       | TJC3D-15AWF  | 35.00        | 40.00 | 38.50 |

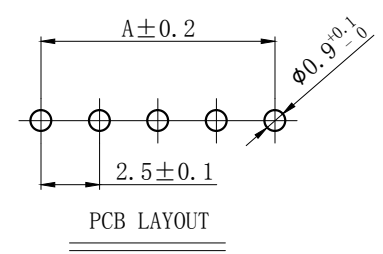

|                                       |                       |                                      |  |
|---------------------------------------|-----------------------|--------------------------------------|--|
| GENERAL TOLERANCES (UNLESS SPECIFIED) |                       | ZHE JIANG DELI CONNECTORS CO., LTD   |  |
| .X: $\pm 0.25$                        | X°: $\pm 3.0^\circ$   | PRODUCT NAME:<br>DL25023 (TJC3D)-AWF | TITLE:<br>2.50 mm Pitch<br>Wire To Board Wafer |
| .XX: $\pm 0.15$                       | .X°: $\pm 2.0^\circ$  | DR: Chen Quan Long                   | DATE: 19/08/01                                 |
| .XXX: $\pm 0.01$                      | .XX°: $\pm 1.0^\circ$ | CHKD: Wu Hui                         | DATE: 19/08/01                                 |
| FINISH:                               |                       | APPD: Ren An De                      | DATE: 19/08/01                                 |
| DRAWING NO:                           |                       |                                      | PART NO:                                       |
|                                       |                       |                                      | SCALE: N/A                                     |
|                                       |                       |                                      | PAGE: 1/1                                      |
|                                       |                       |                                      | UNITS: mm                                      |
|                                       |                       |                                      | REV.: A  |

| REV. | REVISION DESCRIPTION | DATE | APPD |
|------|----------------------|------|------|
|      |                      |      |      |

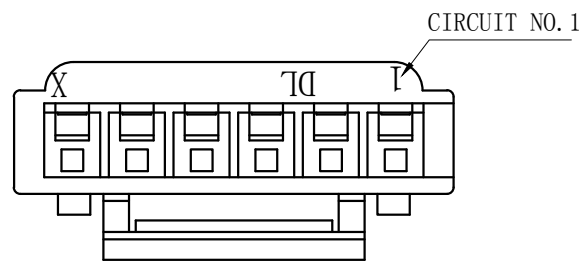
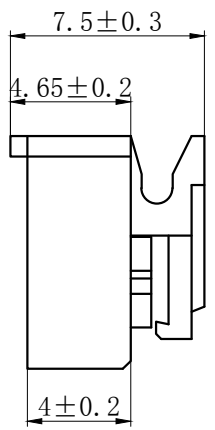
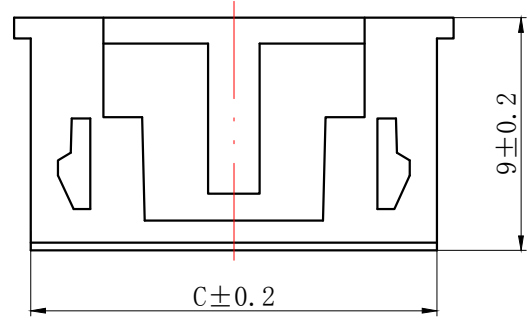
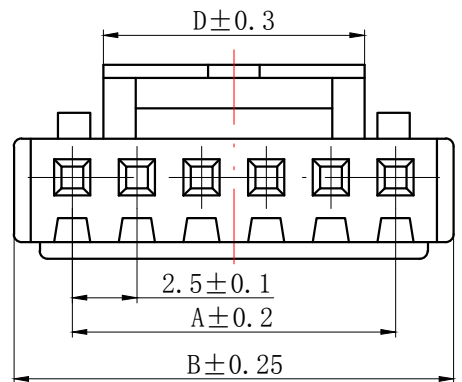

### NOTES

Available in 02 through 15 Circuits.  
 Match with DL25023 series housing  
 Material : Nylon UL94V-0(2).  
 Accepts DL25023-T Crimp Terminal.

| Circuits | Product name | Dimension mm |       |       |       | Circuits | Product name | Dimension mm |       |       |      |
|----------|--------------|--------------|-------|-------|-------|----------|--------------|--------------|-------|-------|------|
|          |              | A            | B     | C     | D     |          |              | A            | B     | C     | D    |
| 2        | TJC3D-2Y     | 2.50         | 7.00  | 5.70  | 5.30  | 10       | TJC3D-10Y    | 22.50        | 27.00 | 25.70 | 15.1 |
| 3        | TJC3D-3Y     | 5.00         | 9.50  | 8.20  | 5.10  | 11       | TJC3D-11Y    | 25.00        | 29.50 | 28.20 | 15.1 |
| 4        | TJC3D-4Y     | 7.50         | 12.00 | 10.70 | 5.10  | 12       | TJC3D-12Y    | 27.50        | 32.00 | 30.70 | 15.1 |
| 5        | TJC3D-5Y     | 10.00        | 14.50 | 13.20 | 7.60  | 13       | TJC3D-13Y    | 30.00        | 34.50 | 33.20 | 15.1 |
| 6        | TJC3D-6Y     | 12.50        | 17.00 | 15.70 | 10.10 | 14       | TJC3D-14Y    | 32.50        | 37.00 | 35.70 | 15.1 |
| 7        | TJC3D-7Y     | 15.00        | 19.50 | 18.20 | 12.60 | 15       | TJC3D-15Y    | 35.00        | 39.50 | 38.20 | 15.1 |
| 8        | TJC3D-8Y     | 17.50        | 22.00 | 20.70 | 15.10 | -        | -            | -            | -     | -     | -    |
| 9        | TJC3D-9Y     | 20.00        | 24.50 | 23.20 | 17.60 | -        | -            | -            | -     | -     | -    |

|  |              |                                    |                                 |
|--|--------------|------------------------------------|---------------------------------|
| GENERAL TOLERANCES<br>(UNLESS SPECIFIED) |              | ZHE JIANG DELI CONNECTORS CO., LTD |                                 |
| .X: ± 0.25                               | .X°: ± 3.0°  | PRODUCT NAME:<br>DL25023 (TJC3D)-Y | TITLE:<br>2.50 mm Pitch Housing |
| .XX: ± 0.15                              | .X°: ± 2.0°  | DR: Chen Quan Long                 | DATE: 19/08/01                  |
| .XXX: ± 0.01                             | .XX°: ± 1.0° | CHKD: Wu Hui                       | DATE: 19/08/01                  |
| FINISH:                                  |              | APPD: Ren An De                    | DATE: 19/08/01                  |
| DRAWING NO:                              |              | SCALE: N/A                         | PAGE: 1/1                       |
|  |              | UNITS: mm                          | REV.: A                         |

| REV. | REVISION DESCRIPTION | DATE | APPD |
|------|----------------------|------|------|
|      |                      |      |      |

### NOTES

Available in 02 through 20 Circuits.  
 Match with DL25023-Y series housing  
 Material : Nylon UL94V-0(2).  
 Accepts DL25023-RT Crimp Terminal.

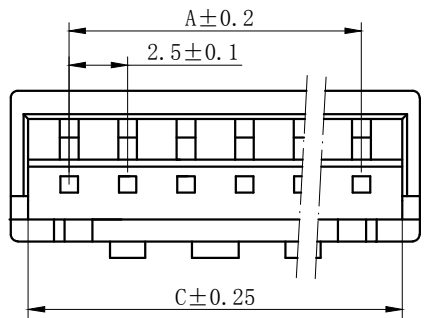
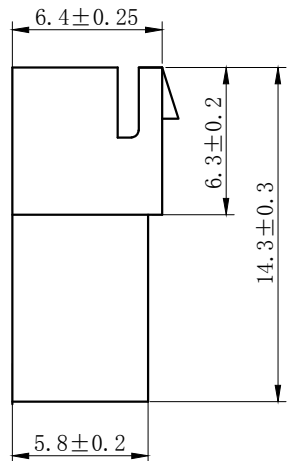
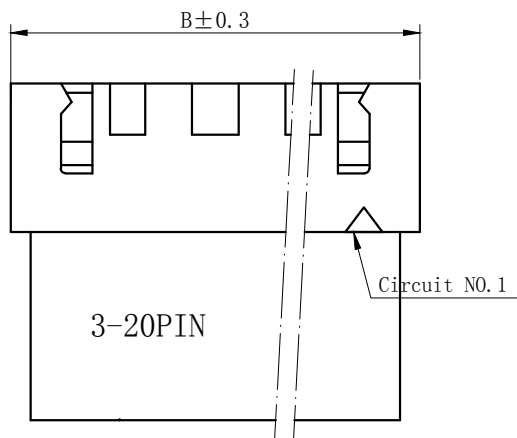
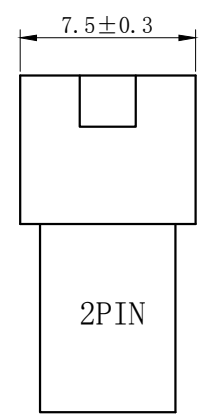

| Circuits | Product name | Dimension mm |       |       | Circuits | Product name | Dimension mm |       |       |
|----------|--------------|--------------|-------|-------|----------|--------------|--------------|-------|-------|
|          |              | A            | B     | C     |          |              | A            | B     | C     |
| 2        | TJC3D-2R     | 2.50         | 7.50  | 6.00  | 10       | TJC3D-10R    | 22.50        | 27.50 | 26.00 |
| 3        | TJC3D-3R     | 5.00         | 10.00 | 8.50  | 11       | TJC3D-11R    | 25.00        | 30.00 | 28.50 |
| 4        | TJC3D-4R     | 7.50         | 12.50 | 11.00 | 12       | TJC3D-12R    | 27.50        | 32.50 | 31.00 |
| 5        | TJC3D-5R     | 10.00        | 15.00 | 13.50 | 13       | TJC3D-13R    | 30.00        | 35.00 | 33.50 |
| 6        | TJC3D-6R     | 12.50        | 17.50 | 16.00 | 14       | TJC3D-14R    | 32.50        | 37.50 | 36.00 |
| 7        | TJC3D-7R     | 15.00        | 20.00 | 18.50 | 15       | TJC3D-15R    | 35.00        | 40.00 | 38.50 |
| 8        | TJC3D-8R     | 17.50        | 22.50 | 21.00 | -        | -            | -            | -     | -     |
| 9        | TJC3D-9R     | 20.00        | 25.00 | 23.50 | 20       | TJC3D-20R    | 47.50        | 52.50 | 51.00 |

|  |              |                                    |  |
|--|--------------|------------------------------------|--|
| GENERAL TOLERANCES<br>(UNLESS SPECIFIED) |              | ZHE JIANG DELI CONNECTORS CO., LTD |  |
| .X: ± 0.25                               | X°: ± 3.0°   | PRODUCT NAME:                      | TITLE: 2.50 mm Pitch<br>Wire To Wire Housing |
| .XX: ± 0.15                              | .X°: ± 2.0°  | DL25023 (TJC3D)-R                  | PART NO:                                     |
| .XXX: ± 0.01                             | .XX°: ± 1.0° | DR:Chen Quan Long                  |  |
| FINISH:                                  |              | CHKD: Wu Hui                       | DATE:20/12/30                                |
| DRAWING NO:                              |              | APPD:Ren An De                     | DATE:20/12/30                                |
|  |              | SCALE: N/A                         | PAGE: 1/1                                    |
|  |              | UNITS: mm                          | REV.: A                                      |



|      |                      |      |      |
|------|----------------------|------|------|
| REV. | REVISION DESCRIPTION | DATE | APPD |
|      |                      |      |      |

## NOTES

Available in 02 through 20 Circuits.  
 Match with DL25001-Y series housing  
 Material : Nylon UL94V-0(2).

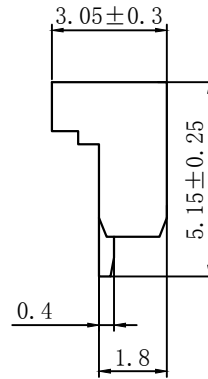
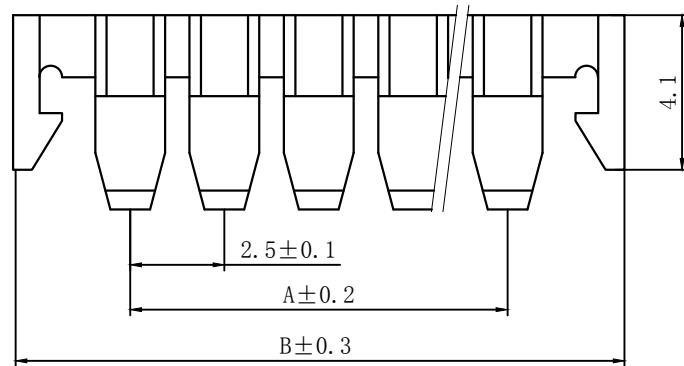
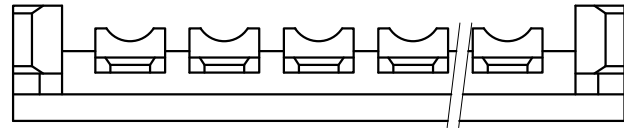

| Circuits | Product name | Dimension mm |      | Circuits | Product name | Dimension mm |      |
|----------|--------------|--------------|------|----------|--------------|--------------|------|
|          |              | A            | B    |          |              | A            | B    |
| 2        | TJC3-2S      | 2.50         | 8.7  | 9        | TJC3-9S      | 20.00        | 26.2 |
| 3        | TJC3-3S      | 5.00         | 11.2 | 10       | TJC3-10S     | 22.50        | 28.7 |
| 4        | TJC3-4S      | 7.50         | 13.7 | 11       | TJC3-11S     | 25.00        | 31.2 |
| 5        | TJC3-5S      | 10.00        | 16.2 | 12       | TJC3-12S     | 27.50        | 33.7 |
| 6        | TJC3-6S      | 12.50        | 18.7 | 13       | TJC3-13S     | 30.00        | 36.2 |
| 7        | TJC3-7S      | 15.00        | 21.2 | ~        | ~            | ~            | ~    |
| 8        | TJC3-8S      | 17.50        | 23.7 | 20       | TJC3-20S     | 47.80        | 53.7 |

|  |              |                                    |               |                                 |           |
|--|--------------|------------------------------------|---------------|---------------------------------|-----------|
| GENERAL TOLERANCES<br>(UNLESS SPECIFIED) |              | ZHE JIANG DELI CONNECTORS CO., LTD |               |                                 |           |
| .X: ± 0.25                               | X°: ± 3.0°   | PRODUCT NAME:<br>DL25001(TJC3)-S   |               | TITLE:<br>2.50 mm Pitch Housing |           |
| .XX: ± 0.15                              | .X°: ± 2.0°  | DR: Yuan Jun Rong                  | DATE:21/03/18 | PART NO:                        |           |
| .XXX: ± 0.01                             | .XX°: ± 1.0° | CHKD: Wu Hui                       | DATE:21/03/18 | SCALE: N/A                      | PAGE: 1/1 |
| FINISH:                                  |              | APPD: Ren An De                    | DATE:21/03/18 | UNITS: mm                       | REV.: A   |
| DRAWING NO:                              |              |                                    |               |                                 |           |

| REV. | REVISION DESCRIPTION | DATE | APPD |
|------|----------------------|------|------|
|      |                      |      |      |



### NOTES

Used in DL25001-Y Series Housing.  
 Accepts AWG #24~20 Wire Range.  
 Material : Phosphor Bronze .  
 Finish: Tin plated.  
 Thickness: 0.2 mm.



| GENERAL TOLERANCES (UNLESS SPECIFIED) |              |   |  | ZHE JIANG DELI CONNECTORS CO., LTD     |  |            |           |
|---------------------------------------|--------------|---|--|--|--|------------|-----------|
| .X: ± 0.25                            | X°: ± 3.0°   | PRODUCT NAME:<br><b>DL25001(TJC3)-T-G</b> |  | TITLE:<br>2.50 mm Pitch Crimp Terminal |  |            |           |
| .XX: ± 0.15                           | .X°: ± 2.0°  | DR: Chen Quan Long                        |  | DATE: 19/08/01                         |  | PART NO:   |           |
| .XXX: ± 0.01                          | .XX°: ± 1.0° | CHKD: Wu Hui                              |  | DATE: 19/08/01                         |  | SCALE: N/A | PAGE: 1/1 |
| DRAWING NO:                           |              | APPD: Ren An De                           |  | DATE: 19/08/01                         |  | UNITS: mm  | REV.: A   |

| REV. | REVISION DESCRIPTION | DATE | APPD |
|------|----------------------|------|------|
|      |                      |      |      |

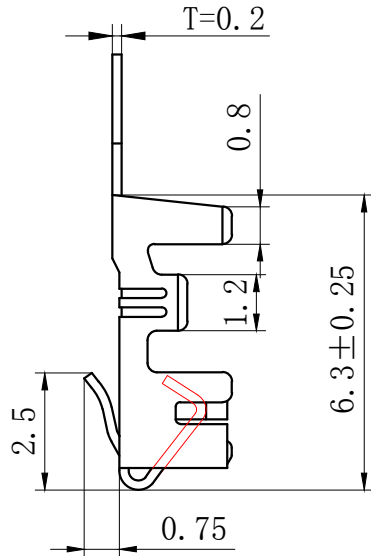
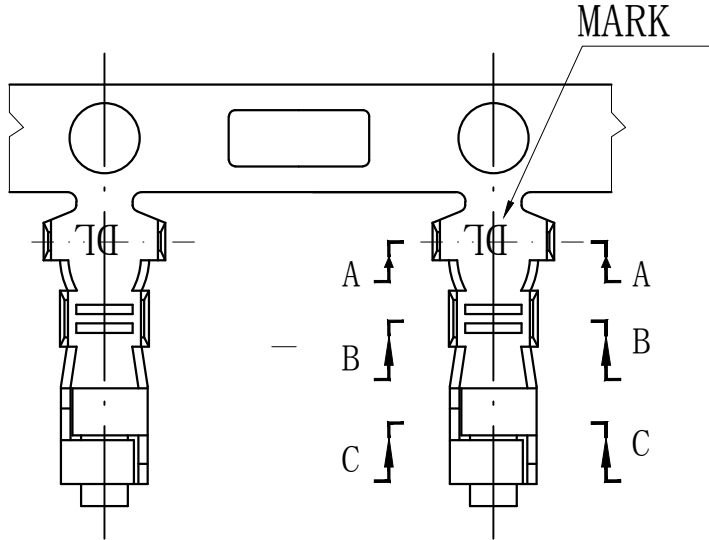

### NOTES

Used in DL25001-Y Series Housing.  
 Accepts AWG #28~22 Wire Range.  
 0.08~ 0.33 mm<sup>2</sup> .  
 Insulation O.D.=1.2~1.9 mm.  
 Material : Phosphor Bronze .  
 Finish: Tin plated.  
 Thickness: 0.2 mm.

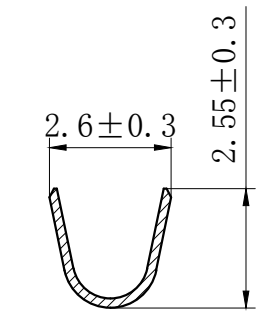

SECTION A-A

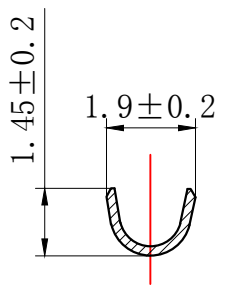

SECTION B-B

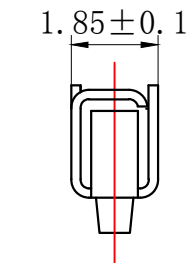

SECTION C-C

| GENERAL TOLERANCES<br>(UNLESS SPECIFIED) |               | ZHE JIANG DELI CONNECTORS CO.,LTD        |   |
|--|---------------|--|---|
| .X: ± 0.25                               | X° : ± 3.0°   | PRODUCT NAME:<br><b>DL25001 (TJC3)-T</b> | TITLE:<br>2.50 mm Pitch<br>Crimp Terminal |
| .XX: ± 0.15                              | .X° : ± 2.0°  | DR:Chen Quan Long                        | DATE:19/08/01                             |
| .XXX: ± 0.01                             | .XX° : ± 1.0° | CHKD: Wu Hui                             | DATE:19/08/01                             |
| FINISH:                                  |               | APPD:Ren An De                           | DATE:19/08/01                             |
| DRAWING NO:                              |               |  |   |

A  
B  
C  
D  
E  
F

A  
B  
C  
D  
E  
F

1 2 3 4 5 6 7 8

1 2 3 4 5 6 7 8

| REV. | REVISION DESCRIPTION | DATE | APPD |
|------|----------------------|------|------|
|      |                      |      |      |

### NOTES

Used in DL25002-R Series Housing.  
Accepts AWG #28~22 Wire Range.

0.08~ 0.33 mm<sup>2</sup> .

Insulation O.D. =1.2~1.9 mm.

Material : Phosphor Bronze .

Finish: Tin plated.

Thickness: 0.2 mm.

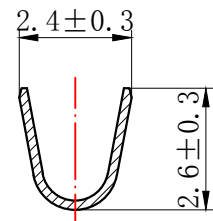
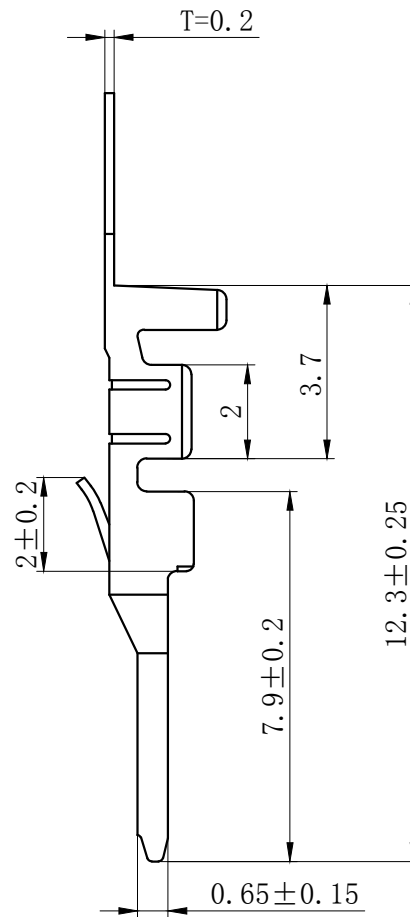
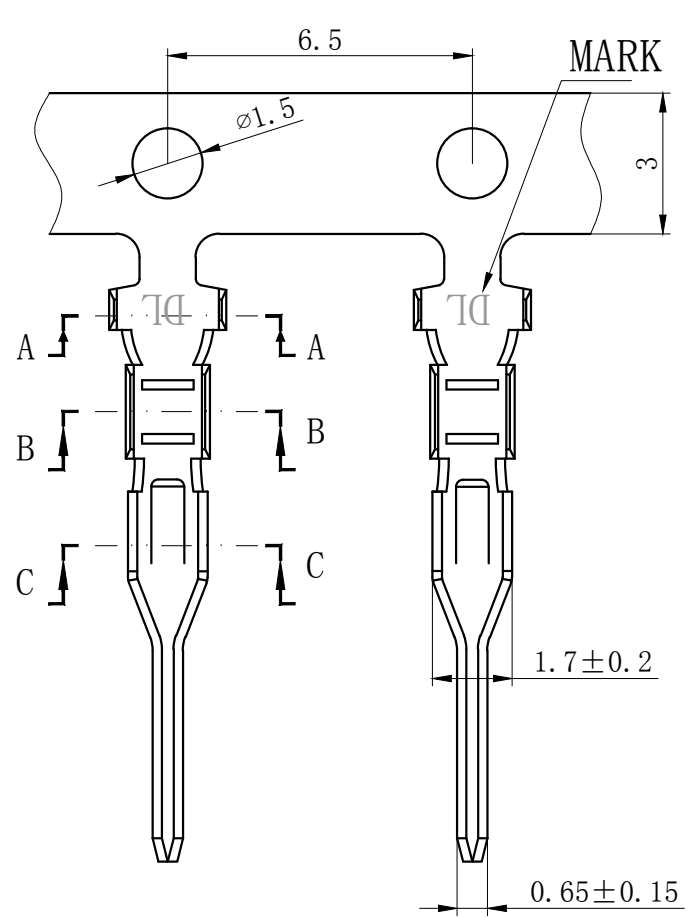

SECTION A-A

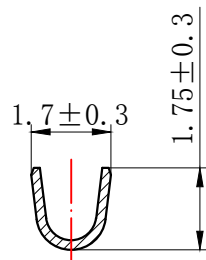

SECTION B-B

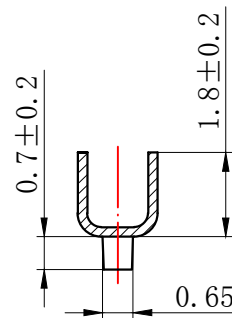

SECTION C-C

| GENERAL TOLERANCES<br>(UNLESS SPECIFIED) |              |                                     |                | ZHE JIANG DELI CONNECTORS CO., LTD               |  |          |  |
|--|--------------|-------------------------------------|----------------|--|--|----------|--|
| .X: ± 0.25                               | X°: ± 3.0°   | PRODUCT NAME:<br>DL25002 (TJC3B)-RT |                | TITLE:<br>2.50 mm Pitch<br>Wire To Wire Terminal |  | PART NO: |  |
| .XX: ± 0.15                              | .X°: ± 2.0°  | DR: Chen Quan Long                  | DATE: 20/12/30 | SCALE: N/A                                       |  |          |  |
| .XXX: ± 0.01                             | .XX°: ± 1.0° | CHKD: Wu Hui                        | DATE: 20/12/30 | PAGE: 1/1  |  |          |  |
| DRAWING NO:                              |              | APPD: Ren An De                     | DATE: 20/12/30 | UNITS: mm  |  | REV.: A  |  |

## X-ON Electronics

Largest Supplier of Electrical and Electronic Components

*Click to view similar products for [Headers & Wire Housings](#) category:*

*Click to view products by [DLL](#) manufacturer:*

Other Similar products are found below :

[0015917161](#) [0022155065](#) [57102-F02-18ULF](#) [58102-G61-06LF](#) [582553-1](#) [01.001.5753.1](#) [0050291907](#) [02.125.8002.8](#) [609-3404](#) [61062-3](#)  
[CSU011177004](#) [622-0430](#) [622-3653LF](#) [63453-116](#) [636-1030](#) [636-1427](#) [636-3427](#) [636-4007](#) [641938-9](#) [65495-038](#) [65692-001LF](#) [65781-018](#)  
[65781-047](#) [65817-010LF](#) [65817-015LF](#) [67095-007LF](#) [67601157](#) [68631-112](#) [68645-018](#) [699319-000](#) [70.362.1628.0](#) [70-4210](#) [70-4226B](#) [70-](#)  
[4853B](#) [71.350.2428.0](#) [733-134](#) [733-162](#) [MHR-64-VUAL](#) [80.063.4001.1](#) [800-90-001-10-001000](#) [801-43-002-10-013000](#) [801-43-006-10-](#)  
[002000](#) [803-43-024-10-001000](#) [803-93-012-10-001000](#) [8-1437020-4](#) [819-22-004-30-001101](#) [820-22-006-30-001101](#) [820-22-008-30-001101](#)  
[821-22-002-10-001101](#) [821-22-003-10-002101](#)