

**技术特性/Specifications:**

额定电压 Rated voltage: 250V AC, DC  
额定电流 Rated current: 3A AC, DC  
接触电阻 Contact resistance: 20m $\Omega$  max  
绝缘电阻 Insulation resistance: 1000M $\Omega$  min  
耐压 Withstand voltage: 1000V AC/minute  
环境温度 Ambient temperature: -40 $^{\circ}$ C~+105 $^{\circ}$ C  
适用线规 Wire range: AWG#28~#20

| REV. | REVISION DESCRIPTION | DATE | APPD |
|------|----------------------|------|------|
|      |                      |      |      |

### NOTES

Available in 02 Circuits.  
Mates with DL25026-Y Series Housing.  
Material : Nylon UL94V-0(2).  
0.64mm Square Pin.  
Pin Material : Brass / Tin-Plated.

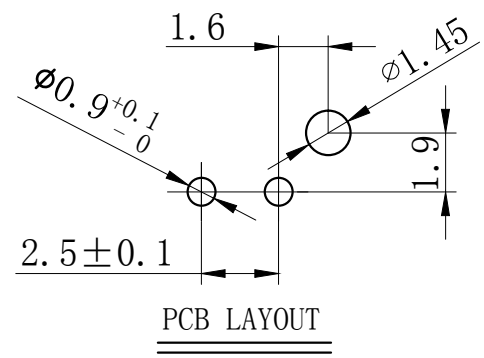
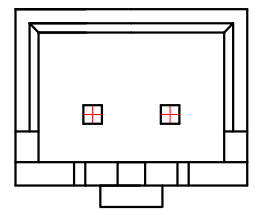
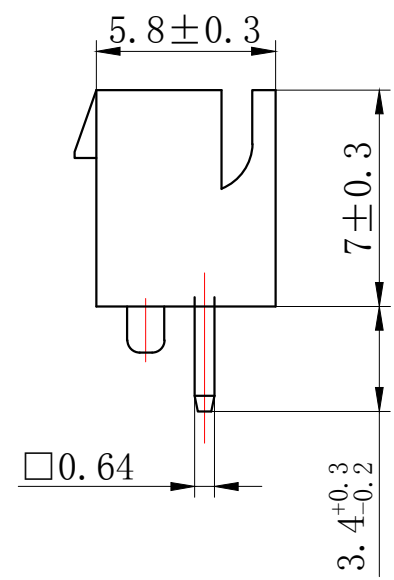
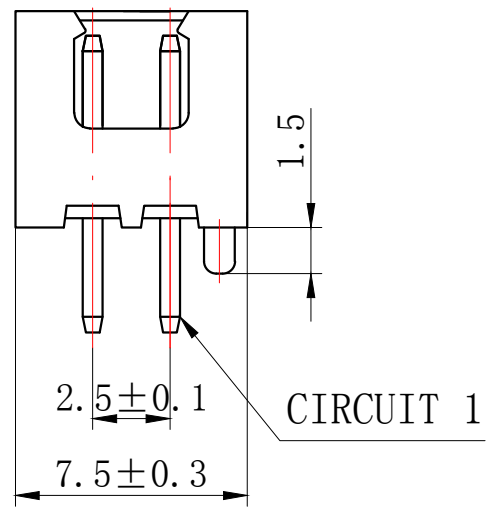
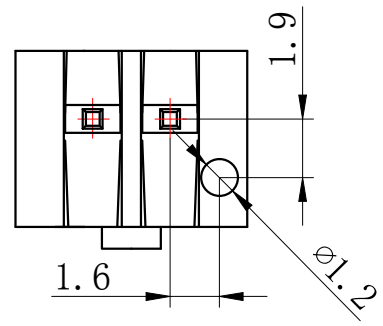

| GENERAL TOLERANCES (UNLESS SPECIFIED) |             | ZHE JIANG DELI CONNECTORS CO., LTD |  |
|---------------------------------------|-------------|------------------------------------|--|
| .X: ±0.25                             | X°: ±3.0°   | PRODUCT NAME:                      | TITLE: 2.50 mm Pitch Wire To Board Wafer |
| .XX: ±0.15                            | .X°: ±2.0°  | DL25026 (XHDH)-2AS                 |  |
| .XXX: ±0.01                           | .XX°: ±1.0° | DR: Chen Quan Long                 | DATE:19/08/01                            |
| FINISH:                               |             | CHKD: Wu Hui                       | DATE:19/08/01                            |
| DRAWING NO:                           |             | APPD: Ren An De                    | DATE:19/08/01                            |
|                                       |             |                                    | SCALE: N/A                               |
|                                       |             |                                    | PAGE: 1/1                                |
|                                       |             |                                    | UNITS: mm                                |
|                                       |             |                                    | REV.: A                                  |

| REV. | REVISION DESCRIPTION | DATE | APPD |
|------|----------------------|------|------|
|      |                      |      |      |

### NOTES

Available in 03 through 20 Circuits.  
 Mates with DL25026-Y Series Housing.  
 Material : Nylon UL94V-0(2).  
 0.64mm Square Pin.  
 Pin Material : Brass / Tin-Plated.

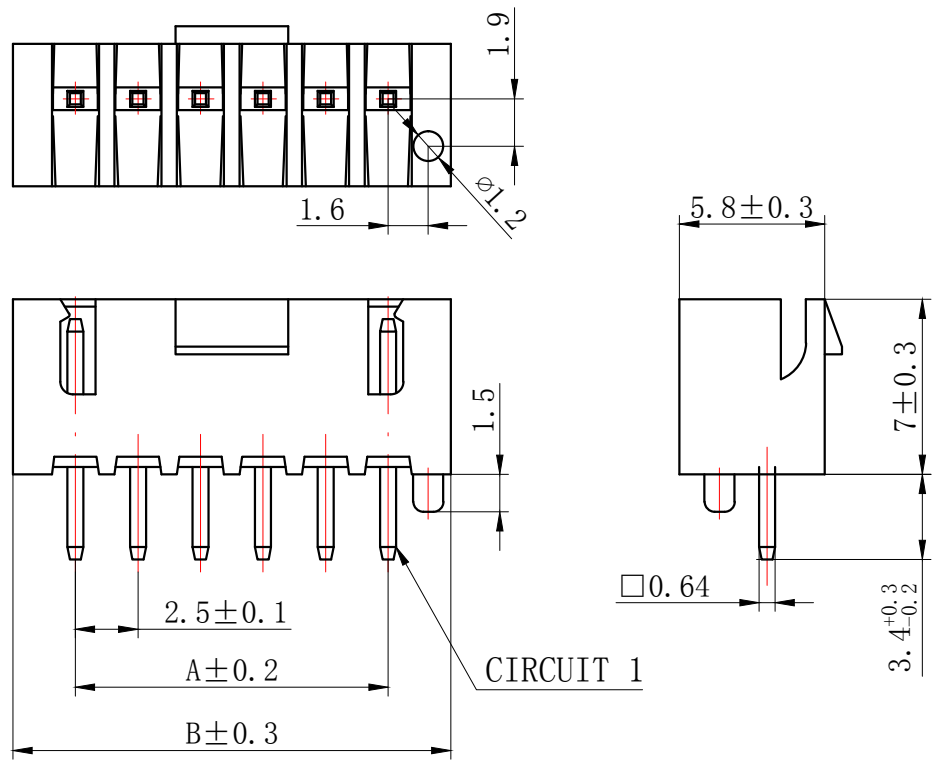
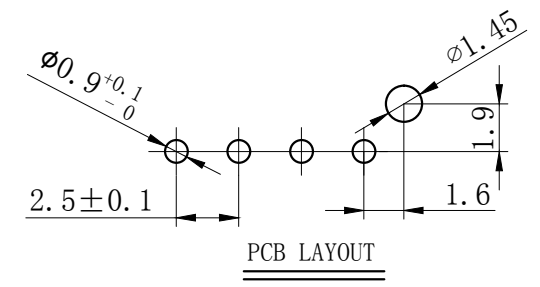

| Circuits | Product name | Dimension mm |       | Circuits | Product name | Dimension mm |       |
|----------|--------------|--------------|-------|----------|--------------|--------------|-------|
|          |              | A            | B     |          |              | A            | B     |
| 3        | XHDH-3AS     | 5.00         | 10.00 | 10       | XHDH-10AS    | 22.50        | 27.50 |
| 4        | XHDH-4AS     | 7.50         | 12.50 | 11       | XHDH-11AS    | 25.00        | 30.00 |
| 5        | XHDH-5AS     | 10.00        | 15.00 | 12       | XHDH-12AS    | 27.50        | 32.50 |
| 6        | XHDH-6AS     | 12.50        | 17.50 | 13       | XHDH-13AS    | 30.00        | 35.00 |
| 7        | XHDH-7AS     | 15.00        | 20.00 | 14       | XHDH-14AS    | 32.50        | 37.50 |
| 8        | XHDH-8AS     | 17.50        | 22.50 | -        | -            | -            | -     |
| 9        | XHDH-9AS     | 20.00        | 25.00 | 20       | XHDH-20AS    | 47.5         | 52.5  |

|  |             |                                    |  |
|--|-------------|------------------------------------|--|
| GENERAL TOLERANCES<br>(UNLESS SPECIFIED) |             | ZHE JIANG DELI CONNECTORS CO., LTD |  |
| .X: ±0.25                                | X°: ±3.0°   | PRODUCT NAME:<br>DL25026 (XHDH)-AS | TITLE:<br>2.50 mm Pitch<br>Wire To Board Wafer |
| .XX: ±0.15                               | .X°: ±2.0°  | DR: Chen Quan Long                 | DATE: 19/08/01                                 |
| .XXX: ±0.01                              | .XX°: ±1.0° | CHKD: Wu Hui                       | DATE: 19/08/01                                 |
| FINISH:                                  |             | APPD: Ren An De                    | DATE: 19/08/01                                 |
| DRAWING NO:                              |             |                                    |  |
|  |             | PART NO:                           | SCALE: N/A                                     |
|  |             | UNITS: mm                          | PAGE: 1/1                                      |
|  |             | REV.:                              | A  |

| REV. | REVISION DESCRIPTION | DATE | APPD |
|------|----------------------|------|------|
|      |                      |      |      |

### NOTES

Available in 03 through 20 Circuits.  
Mates with DL25026-Y Series Housing.  
Material : Nylon UL94V-0(2).  
0.64mm Square Pin.  
Pin Material : Brass / Tin-Plated.

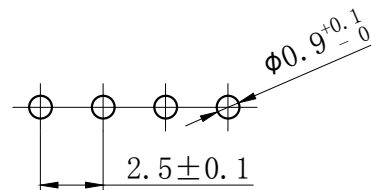
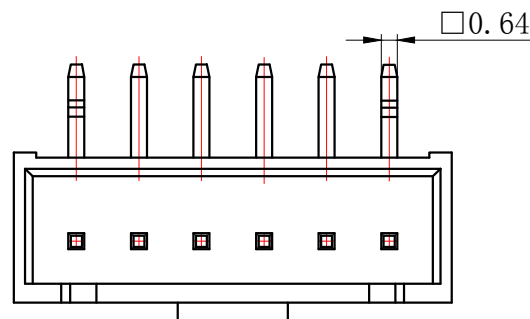
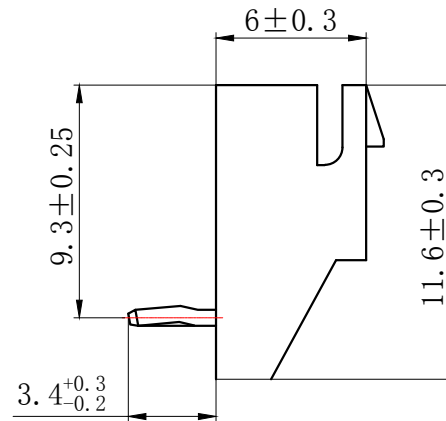
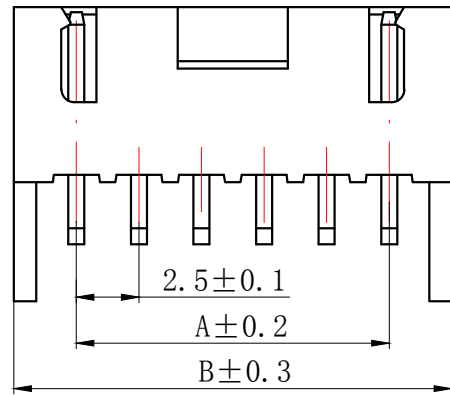
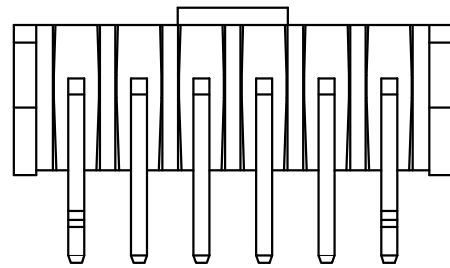

PCB LAYOUT

| Circuits | Product name | Dimension mm |       | Circuits | Product name | Dimension mm |       |
|----------|--------------|--------------|-------|----------|--------------|--------------|-------|
|          |              | A            | B     |          |              | A            | B     |
| 3        | XHDH-3AWF    | 5.00         | 10.00 | 10       | XHDH-10AWF   | 22.50        | 27.50 |
| 4        | XHDH-4AWF    | 7.50         | 12.50 | 11       | XHDH-11AWF   | 25.00        | 30.00 |
| 5        | XHDH-5AWF    | 10.00        | 15.00 | 12       | XHDH-12AWF   | 27.50        | 32.50 |
| 6        | XHDH-6AWF    | 12.50        | 17.50 | 13       | XHDH-13AWF   | 30.00        | 35.00 |
| 7        | XHDH-7AWF    | 15.00        | 20.00 | 14       | XHDH-14AWF   | 32.50        | 37.50 |
| 8        | XHDH-8AWF    | 17.50        | 22.50 | -        | -            | -            | -     |
| 9        | XHDH-9AWF    | 20.00        | 25.00 | 20       | XHDH-20AWF   | 47.5         | 52.5  |

| GENERAL TOLERANCES (UNLESS SPECIFIED) |             |                                   |  | ZHE JIANG DELI CONNECTORS CO., LTD       |  |           |  |
|---------------------------------------|-------------|-----------------------------------|--|--|--|-----------|--|
| .X: ±0.25                             | X°: ±3.0°   | PRODUCT NAME: DL25026 (XHDH)-AWF  |  | TITLE: 2.50 mm Pitch Wire To Board Wafer |  |           |  |
| .XX: ±0.15                            | .X°: ±2.0°  | DR: Chen Quan Long DATE: 19/08/01 |  | PART NO:                                 |  |           |  |
| .XXX: ±0.01                           | .XX°: ±1.0° | CHKD: Wu Hui DATE: 19/08/01       |  | SCALE: N/A                               |  | PAGE: 1/1 |  |
| FINISH:                               |             | APPD: Ren An De DATE: 19/08/01    |  | UNITS: mm                                |  | REV.: A   |  |
| DRAWING NO:                           |             |                                   |  |  |  |           |  |

| REV. | REVISION DESCRIPTION | DATE | APPD |
|------|----------------------|------|------|
|      |                      |      |      |

### NOTES

Available in 02 Circuits.  
 Match with DL25026 series housing  
 Material : Nylon UL94V-0(2).  
 Accepts DL25026-T Crimp Terminal.

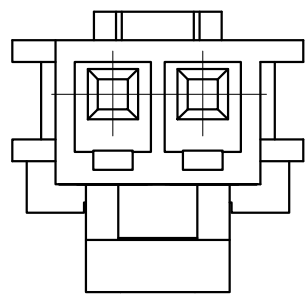
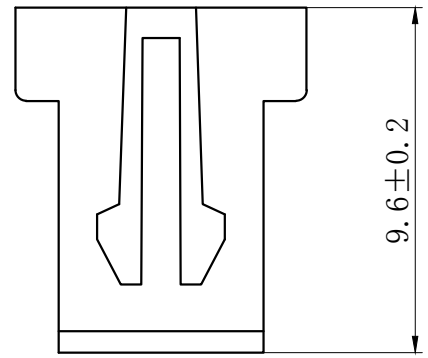
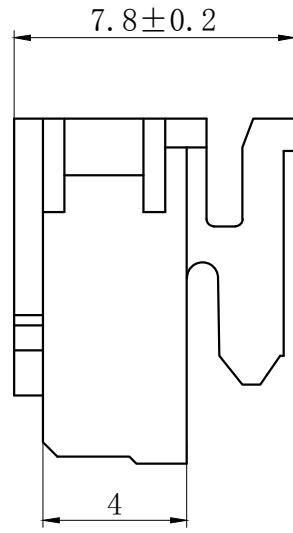
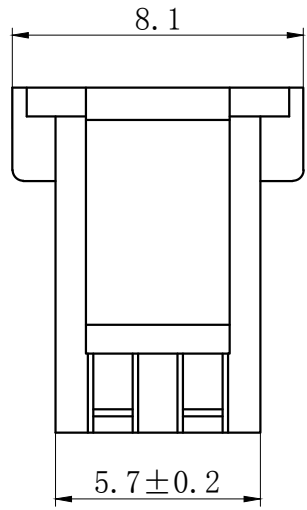
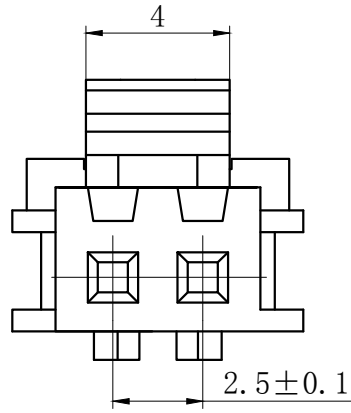

| GENERAL TOLERANCES<br>(UNLESS SPECIFIED) |              | ZHE JIANG DELI CONNECTORS CO., LTD |                                 |
|--|--------------|------------------------------------|---------------------------------|
| .X: ± 0.25                               | X°: ± 3.0°   | PRODUCT NAME:<br>DL25026 (XHDH)-2Y | TITLE:<br>2.50 mm Pitch Housing |
| .XX: ± 0.15                              | .X°: ± 2.0°  | DR: Chen Quan Long                 | DATE: 19/08/01                  |
| .XXX: ± 0.01                             | .XX°: ± 1.0° | CHKD: Wu Hui                       | DATE: 19/08/01                  |
| FINISH:                                  |              | APPD: Ren An De                    | DATE: 19/08/01                  |
| DRAWING NO:                              |              |                                    |                                 |

A  
B  
C  
D  
E  
F

A  
B  
C  
D  
E  
F

1 2 3 4 5 6 7 8

1 2 3 4 5 6 7 8

| REV. | REVISION DESCRIPTION | DATE | APPD |
|------|----------------------|------|------|
|      |                      |      |      |

## NOTES

Available in 03 through 20 Circuits.

Match with DL25026 series housing

Material : Nylon UL94V-0(2).

Accepts DL25026-T Crimp Terminal.

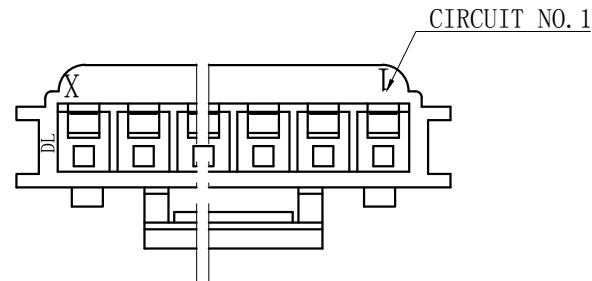
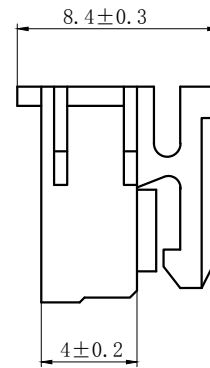
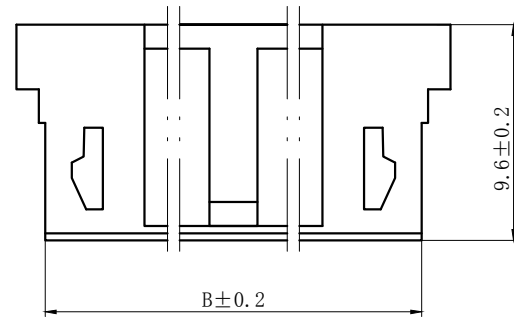
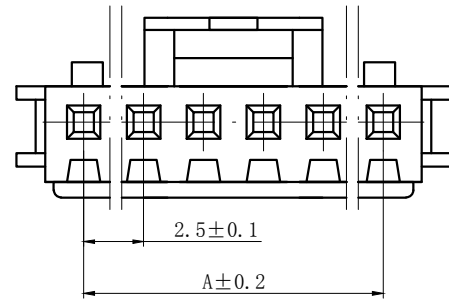

| Circuits | Product name | Dimension mm |       | Circuits | Product name | Dimension mm |       |
|----------|--------------|--------------|-------|----------|--------------|--------------|-------|
|          |              | A            | B     |          |              | A            | B     |
| 3        | XHDH-3Y      | 5.00         | 8.20  | 10       | XHDH-10Y     | 22.50        | 25.70 |
| 4        | XHDH-4Y      | 7.50         | 10.70 | 11       | XHDH-11Y     | 25.00        | 28.20 |
| 5        | XHDH-5Y      | 10.00        | 13.20 | 12       | XHDH-12Y     | 27.50        | 30.70 |
| 6        | XHDH-6Y      | 12.50        | 15.70 | 13       | XHDH-13Y     | 30.00        | 33.20 |
| 7        | XHDH-7Y      | 15.00        | 18.20 | 14       | XHDH-14Y     | 32.50        | 35.70 |
| 8        | XHDH-8Y      | 17.50        | 20.70 | -        | -            | -            | -     |
| 9        | XHDH-9Y      | 20.00        | 23.20 | 20       | XHDH-20Y     | 47.50        | 50.70 |

GENERAL TOLERANCES  
(UNLESS SPECIFIED)

|              |               |
|--------------|---------------|
| .X: ± 0.25   | X° : ± 3.0°   |
| .XX: ± 0.15  | .X° : ± 2.0°  |
| .XXX: ± 0.01 | .XX° : ± 1.0° |

FINISH: \_\_\_\_\_

DRAWING NO:

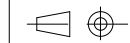

ZHE JIANG DELI CONNECTORS CO., LTD

PRODUCT NAME:  
DL25026 (XHDH)-Y

DR: Chen Quan Long

CHKD: Wu Hui

APPD: Ren An De

TITLE:  
2.50 mm Pitch Housing

DATE: 19/08/01

DATE: 19/08/01

DATE: 19/08/01

PART NO:

SCALE: N/A

UNITS: mm

PAGE: 1/1

REV.: A

|      |                      |      |      |
|------|----------------------|------|------|
| REV. | REVISION DESCRIPTION | DATE | APPD |
|      |                      |      |      |

## NOTES

Available in 02 through 20 Circuits.

Mates with DL25026-Y Series Housing.

Material : Nylon UL94V-0(2).

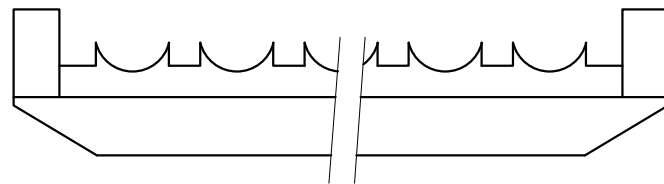
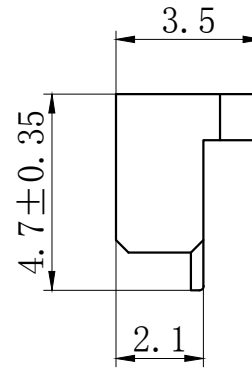
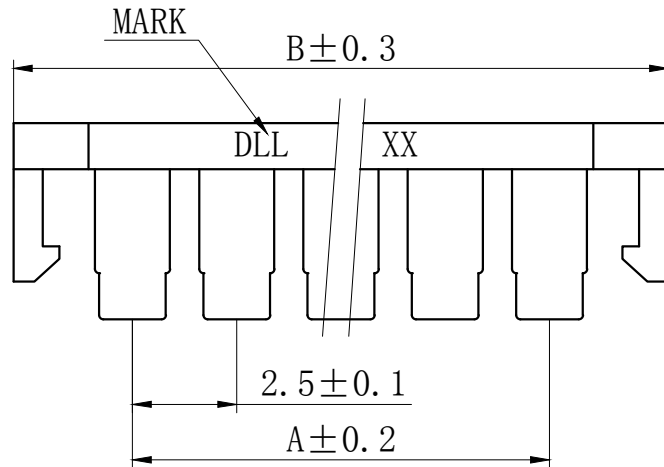

| Circuits | Product name | Dimension mm |      | Circuits | Product name | Dimension mm |      |
|----------|--------------|--------------|------|----------|--------------|--------------|------|
|          |              | A            | B    |          |              | A            | B    |
| 2        | XHDH-2S      | 2.5          | 8.2  | 9        | XHDH-9S      | 20.0         | 25.7 |
| 3        | XHDH-3S      | 5.0          | 10.7 | 10       | XHDH-10S     | 22.5         | 28.2 |
| 4        | XHDH-4S      | 7.5          | 13.2 | 11       | XHDH-11S     | 25.0         | 30.7 |
| 5        | XHDH-5S      | 10.0         | 15.7 | 12       | XHDH-12S     | 27.5         | 33.2 |
| 6        | XHDH-6S      | 12.5         | 18.2 | 13       | XHDH-13S     | 30.0         | 35.7 |
| 7        | XHDH-7S      | 15.0         | 20.7 | -        | -            | -            | -    |
| 8        | XHDH-8S      | 17.5         | 23.2 | 20       | XHDH-20S     | 47.5         | 53.2 |

|  |             |                                   |  |                                    |  |           |  |
|--|-------------|-----------------------------------|--|------------------------------------|--|-----------|--|
| GENERAL TOLERANCES<br>(UNLESS SPECIFIED) |             |                                   |  | ZHE JIANG DELI CONNECTORS CO., LTD |  |           |  |
| .X: ±0.25                                | X°: ±3.0°   | PRODUCT NAME:<br>DL25026 (XHDH)-S |  | TITLE:<br>2.50 mm Pitch Retainer   |  |           |  |
| .XX: ±0.15                               | .X°: ±2.0°  | DR: Chen Quan Long                |  | DATE: 19/08/01                     |  |           |  |
| .XXX: ±0.01                              | .XX°: ±1.0° | CHKD: Wu Hui                      |  | DATE: 19/08/01                     |  |           |  |
| FINISH: _____                            |             | APPD: Ren An De                   |  | DATE: 19/08/01                     |  | PART NO:  |  |
| DRAWING NO:                              |             |                                   |  | SCALE: N/A                         |  | PAGE: 1/1 |  |
|  |             |                                   |  | UNITS: mm                          |  | REV.: B   |  |

| REV. | REVISION DESCRIPTION | DATE | APPD |
|------|----------------------|------|------|
|      |                      |      |      |

### NOTES

Available in 02 through 20 Circuits.  
 Match with DL25026-Y series housing  
 Material : Nylon UL94V-0(2).  
 Accepts DL25026-RT Crimp Terminal.

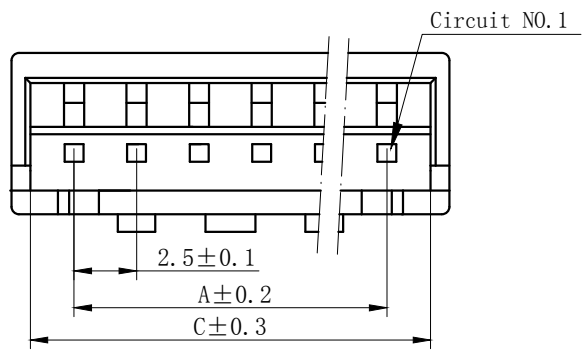
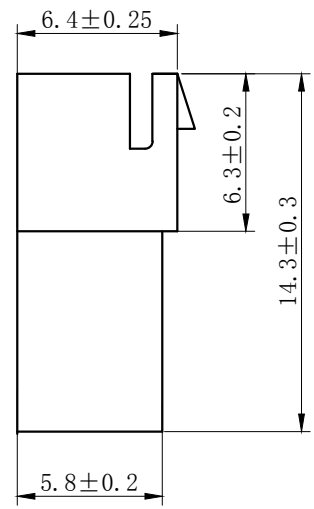
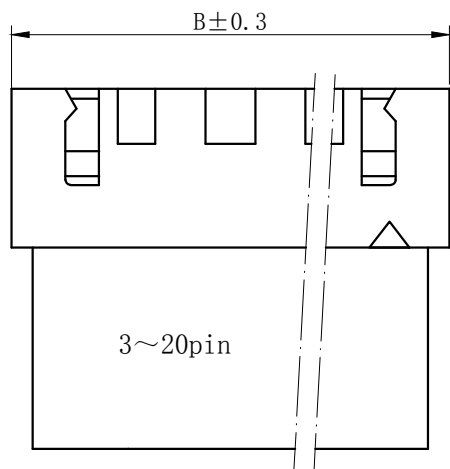
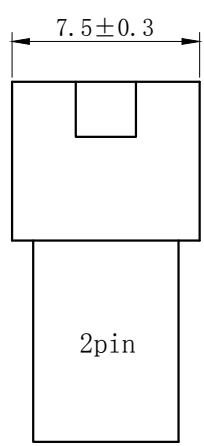
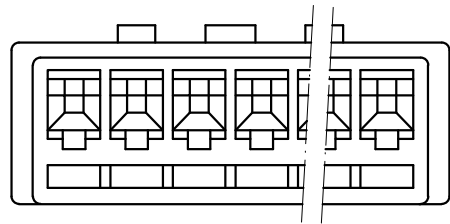

| Circuits | Product name | Dimension mm |       |       | Circuits | Product name | Dimension mm |       |       |
|----------|--------------|--------------|-------|-------|----------|--------------|--------------|-------|-------|
|          |              | A            | B     | C     |          |              | A            | B     | C     |
| 2        | XHDH-2R      | 2.50         | 7.50  | 6.00  | 10       | XHDH-10R     | 22.50        | 27.50 | 26.00 |
| 3        | XHDH-3R      | 5.00         | 10.00 | 8.50  | 11       | XHDH-11R     | 25.00        | 30.00 | 28.50 |
| 4        | XHDH-4R      | 7.50         | 12.50 | 11.00 | 12       | XHDH-12R     | 27.50        | 32.50 | 31.00 |
| 5        | XHDH-5R      | 10.00        | 15.00 | 13.50 | 13       | XHDH-13R     | 30.00        | 35.00 | 33.50 |
| 6        | XHDH-6R      | 12.50        | 17.50 | 16.00 | 14       | XHDH-14R     | 32.50        | 37.50 | 36.00 |
| 7        | XHDH-7R      | 15.00        | 20.00 | 18.50 | 15       | XHDH-15R     | 35.00        | 40.00 | 38.50 |
| 8        | XHDH-8R      | 17.50        | 22.50 | 21.00 | -        | -            | -            | -     | -     |
| 9        | XHDH-9R      | 20.00        | 25.00 | 23.50 | 20       | XHDH-20R     | 47.50        | 52.50 | 51.00 |

|  |              |                                    |  |   |  |
|--|--------------|------------------------------------|--|---|--|
| GENERAL TOLERANCES<br>(UNLESS SPECIFIED) |              | ZHE JIANG DELI CONNECTORS CO., LTD |  |   |  |
| .X: ± 0.25                               | X°: ± 3.0°   | PRODUCT NAME:<br>DL25026 (XHDH)-R  |  | TITLE:<br>2.50 mm Pitch<br>Wire To Wire Housing |  |
| .XX: ± 0.15                              | .X°: ± 2.0°  | DR: Chen Quan Long                 |  | DATE: 20/12/30                                  |  |
| .XXX: ± 0.01                             | .XX°: ± 1.0° | CHKD: Wu Hui                       |  | DATE: 20/12/30                                  |  |
| DRAWING NO:                              |              | APPD: Ren An De                    |  | DATE: 20/12/30                                  |  |
| FINISH:                                  |              | SCALE: N/A                         |  | PAGE: 1/1                                       |  |
|  |              | UNITS: mm                          |  | REV.: A   |  |



| REV. | REVISION DESCRIPTION | DATE | APPD |
|------|----------------------|------|------|
|      |                      |      |      |



### NOTES

Used in DL25001-Y Series Housing.  
 Accepts AWG #28~22 Wire Range.  
 0.08~ 0.33 mm<sup>2</sup> .  
 Insulation O.D.=1.2~1.9 mm.  
 Material : Phosphor Bronze .  
 Finish: Tin plated.  
 Thickness: 0.2 mm.



SECTION A-A



SECTION B-B



SECTION C-C

| GENERAL TOLERANCES<br>(UNLESS SPECIFIED) |               | ZHE JIANG DELI CONNECTORS CO.,LTD        |   |
|--|---------------|--|---|
| .X: ± 0.25                               | X° : ± 3.0°   | PRODUCT NAME:<br><b>DL25001 (TJC3)-T</b> | TITLE:<br>2.50 mm Pitch<br>Crimp Terminal |
| .XX: ± 0.15                              | .X° : ± 2.0°  | DR:Chen Quan Long                        | DATE:19/08/01                             |
| .XXX: ± 0.01                             | .XX° : ± 1.0° | CHKD: Wu Hui                             | DATE:19/08/01                             |
| FINISH:<br>_____                         |               | APPD:Ren An De                           | DATE:19/08/01                             |
| DRAWING NO:                              |               |  |   |

A  
B  
C  
D  
E  
F

A  
B  
C  
D  
E  
F

1 2 3 4 5 6 7 8

1 2 3 4 5 6 7 8

| REV. | REVISION DESCRIPTION | DATE | APPD |
|------|----------------------|------|------|
|      |                      |      |      |



### NOTES

Used in DL25001-Y Series Housing.  
 Accepts AWG #24~20 Wire Range.  
 Material : Phosphor Bronze .  
 Finish: Tin plated.  
 Thickness: 0.2 mm.



| GENERAL TOLERANCES<br>(UNLESS SPECIFIED) |              |   |                | ZHE JIANG DELI CONNECTORS CO., LTD        |  |           |  |
|--|--------------|---|----------------|---|--|-----------|--|
| .X: ± 0.25                               | X°: ± 3.0°   | PRODUCT NAME:<br><b>DL25001(TJC3)-T-G</b> |                | TITLE:<br>2.50 mm Pitch<br>Crimp Terminal |  | PART NO:  |  |
| .XX: ± 0.15                              | .X°: ± 2.0°  | DR: Chen Quan Long                        | DATE: 19/08/01 | SCALE: N/A                                |  | PAGE: 1/1 |  |
| .XXX: ± 0.01                             | .XX°: ± 1.0° | CHKD: Wu Hui                              | DATE: 19/08/01 | UNITS: mm                                 |  | REV.: A   |  |
| DRAWING NO:                              |              | APPD: Ren An De                           | DATE: 19/08/01 |   |  |           |  |

| REV. | REVISION DESCRIPTION | DATE | APPD |
|------|----------------------|------|------|
|      |                      |      |      |

### NOTES

Used in DL25002-R Series Housing.  
Accepts AWG #28~22 Wire Range.

0.08~ 0.33 mm<sup>2</sup> .

Insulation O.D. =1.2~1.9 mm.

Material : Phosphor Bronze .

Finish: Tin plated.

Thickness: 0.2 mm.

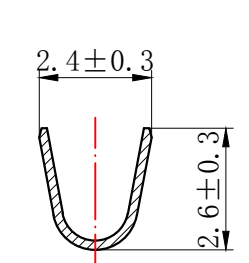

SECTION A-A



SECTION B-B



SECTION C-C

| GENERAL TOLERANCES<br>(UNLESS SPECIFIED) |              |                                     |                | ZHE JIANG DELI CONNECTORS CO., LTD               |           |  |  |
|--|--------------|-------------------------------------|----------------|--|-----------|--|--|
| .X: ± 0.25                               | X°: ± 3.0°   | PRODUCT NAME:<br>DL25002 (TJC3B)-RT |                | TITLE:<br>2.50 mm Pitch<br>Wire To Wire Terminal |           |  |  |
| .XX: ± 0.15                              | .X°: ± 2.0°  | DR: Chen Quan Long                  | DATE: 20/12/30 | PART NO:   |           |  |  |
| .XXX: ± 0.01                             | .XX°: ± 1.0° | CHKD: Wu Hui                        | DATE: 20/12/30 | SCALE: N/A                                       | PAGE: 1/1 |  |  |
| DRAWING NO:                              |              | APPD: Ren An De                     | DATE: 20/12/30 | UNITS: mm  | REV.: A   |  |  |

## X-ON Electronics

Largest Supplier of Electrical and Electronic Components

*Click to view similar products for [Headers & Wire Housings](#) category:*

*Click to view products by [DLL](#) manufacturer:*

Other Similar products are found below :

[0015917161](#) [0022155065](#) [57102-F02-18ULF](#) [58102-G61-06LF](#) [582553-1](#) [01.001.5753.1](#) [0050291907](#) [02.125.8002.8](#) [609-3404](#) [61062-3](#)  
[CSU011177004](#) [622-0430](#) [622-3653LF](#) [63453-116](#) [636-1030](#) [636-1427](#) [636-3427](#) [636-4007](#) [641938-9](#) [65495-038](#) [65692-001LF](#) [65781-018](#)  
[65781-047](#) [65817-010LF](#) [65817-015LF](#) [67095-007LF](#) [67601157](#) [68631-112](#) [68645-018](#) [699319-000](#) [70.362.1628.0](#) [70-4210](#) [70-4226B](#) [70-](#)  
[4853B](#) [71.350.2428.0](#) [733-134](#) [733-162](#) [MHR-64-VUAL](#) [80.063.4001.1](#) [800-90-001-10-001000](#) [801-43-002-10-013000](#) [801-43-006-10-](#)  
[002000](#) [803-43-024-10-001000](#) [803-93-012-10-001000](#) [8-1437020-4](#) [819-22-004-30-001101](#) [820-22-006-30-001101](#) [820-22-008-30-001101](#)  
[821-22-002-10-001101](#) [821-22-003-10-002101](#)