

REVISIONS				
REV. SYM.	E.C.O. NUMBER	DESCRIPTION	BY DATE	APP'D DATE
1		ORIGINAL RELEASE	DUNG CAO 8-18-95	DE 8-95

**UNCONTROLLED DOCUMENT  
WILL NOT BE UPDATED**

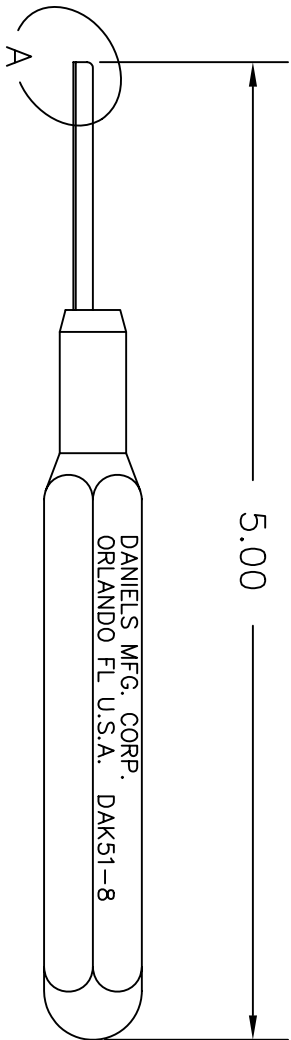
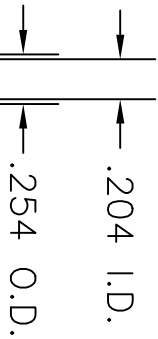

VIEW A

<b>RESTRICTED &amp; CONFIDENTIAL</b>		<b>CONFIDENTIAL PROPERTY OF DANIELS MANUFACTURING CORP. NOT TO BE DISCLOSED TO OTHERS, REPRODUCED OR USED FOR ANY OTHER PURPOSE, EXCEPT AS AUTHORIZED IN WRITING BY DANIELS MANUFACTURING. MUST BE RETURNED TO DANIELS MANUFACTURING CORP. ON COMPLETION OF ORDER OR OTHER PURPOSE FOR WHICH LENT.</b>	
<b>MATERIAL</b>		<b>HEAT TREAT</b>	
<b>FINISH</b>		<b>FINISH</b>	

<b>ITEM</b>	<b>PART NO.</b>	<b>DATE</b>
DRN. DUNG CAO	8-18-95	
GJK'D DE	8-95	
APP'D.	DATE	
APP'D.	DATE	

<b>NOTE:</b> THIS DRAWING IS AN OUTLINE DRAWING OF THE RESPECTIVE DMC PART NUMBER INDICATED. ACTUAL DMC PART NUMBER IS DRAWING NUMBER WITHOUT THE "-ENV" SUFFIX.			
<b>WHERE USED:</b>		<b>TITLE</b>	
SIZE A	SCALE NTS	INSTALLING TOOL #8 ENVELOPE DRAWING	
CAD P/N DAK51-8-ENV	DWG. NO. DAK51-8-ENV	SHEET 1	OF 1

<b>DO NOT SCALE DRAWING</b>			
<b>DESCRIPTION/REMARKS</b>		<b>QTY.</b>	
DANIELS MANUFACTURING CORP. ORLANDO, FLORIDA CAGE 11851			
DANIELS MFG. CORP. ORLANDO FL U.S.A. DAK51-8			

## X-ON Electronics

Largest Supplier of Electrical and Electronic Components

*Click to view similar products for [Extraction, Removal & Insertion Tools](#) category:*

*Click to view products by [DMC manufacturer](#):*

Other Similar products are found below :

[M8196914-08](#) [768211-2](#) [809-131](#) [844751-2](#) [8-59558-2](#) [91018-1](#) [12014013](#) [12093647](#) [1-21048-0](#) [R282867020](#) [12093078](#) [1-21048-6](#)  
[12121897](#) [DCF.91.405.5LT](#) [1322](#) [15314260](#) [15313892](#) [15350698](#) [15350707](#) [15430130](#) [1579018-4](#) [1643916-1](#) [1-679532-0](#) [1976593-3](#)  
[OUTEXT-0321](#) [2-1579008-3](#) [2-1579008-4](#) [229694-7](#) [231106-1](#) [241469](#) [91040-3](#) [91040-7](#) [965004-000](#) [965069-000](#) [1738219-1](#) [ET-JL05-16](#)  
[FG 0300 146 3000](#) [FIT-6](#) [210S048](#) [2-1579007-9](#) [231879-1](#) [312138-3](#) [RJ11FODE](#) [356-162](#) [M8196914-10](#) [4-1579018-0](#) [430395-001](#) [483249-](#)  
[1](#) [5-1579007-2](#) [5-1579007-9](#)