

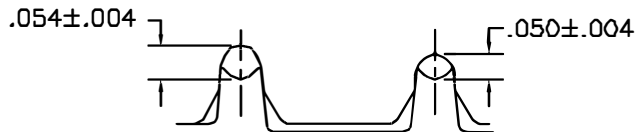

CONDUCTOR CRIMP
JAWS GMT225 -2 & -4



INSULATION CRIMP
JAWS GMT225 -1 & -3

- FEMALE CONDUCTOR JAW
P/N GMT225-2
- FEMALE INSULATION JAW
P/N GMT225-1
- MALE INSULATION JAW
P/N GMT225-3
- MALE CONDUCTOR JAW
P/N GMT 225-4

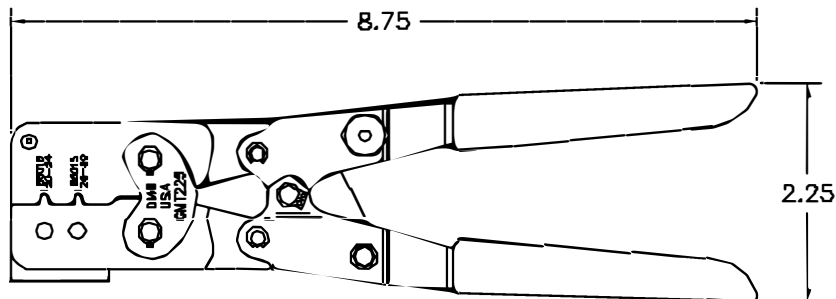

1. GAGING INSTRUCTIONS:
SAMPLE CRIMP ON ϕ .062 50/50 SOLID SOLDER
(MEASURE WITH A BLADE MICROMETER OR VERNIER).

NOTES:

RESTRICTED & CONFIDENTIAL

CONFIDENTIAL PROPERTY OF DANIELS MANUFACTURING CORP. NOT TO BE DISCLOSED TO OTHERS, REPRODUCED OR USED FOR ANY OTHER PURPOSE, EXCEPT AS AUTHORIZED IN WRITING BY DANIELS MANUFACTURING CORP. ON COMPLETION OF ORDER OR OTHER PURPOSE FOR WHICH LENT.

DO NOT SCALE DRAWING

REVISIONS				
REV. SYM.	ECO NUMBER	DESCRIPTION	BY DATE	APP'D DATE
3		REVISED NOTE 1	DTM 4/1/88	JW 4/1/88

**UNCONTROLLED DOCUMENT
WILL NOT BE UPDATED**

WIRE SIZE (AWG)	CONTACT NUMBER	
	LP	STRIP
26-30	86015	85967
	87045	86491
	1-87313-3 1-87313-4	87313-2, -3, -8 AND -9
	87110-4, -7, AND 1-87110-0	87110-2, -3, -5, -6, -7, -8 AND -9
	87522-3, -6, AND -7	87522-2, -4 -5, -8, -9, AND 1-87522-0
20-24	87861-1, -2, -3, -4, AND -5	87827-1, -2 -3, -4 AND -5
	86016	85969
	87046	86492
	1-87309-3 1-87309-4	87309-2, -3, -8 AND -9
	87523-3, -6, AND -7	87523-2, -4, AND -5
	87195-4, -5 AND 1-87195-0	87195-2, -3, -5 -6, -8 AND -9

ITEM	PART NO.	QTY.	DESCRIPTION/REMARKS
DRN	AM	DATE 1-8-88	DANIELS MANUFACTURING CORP. ORLANDO, FLORIDA CAGE 11857
CRCD	JS	DATE	
APP'D.	MS	DATE	
APP'D.	AAM	DATE	
			TITLE CRIMP TOOL (AMP EQUIVALENT 90202-2) ENVELOPE DRAWING
WHOME USED:			
SIZE	SCALE	CAD P/N	SHEET OF
B	NTS	GMT225-ENV	1 1
POSTING		P/N	REV.
		GMT225-ENV	3

X-ON Electronics

Largest Supplier of Electrical and Electronic Components

Click to view similar products for [Crimpers / Crimping Tools](#) category:

Click to view products by [DMC](#) manufacturer:

Other Similar products are found below :

[010-0096](#) [M225201-06](#) [M225202-37](#) [6-1579015-5](#) [CT150-6-RH07](#) [622-6441LF](#) [M322](#) [6-304052-1](#) [63456-0054](#) [63484-3701](#) [63800-8355](#)
[63819-1875](#) [63819-2875](#) [63819-4475](#) [63827-5375](#) [64001-0975](#) [64001-4175](#) [64005-0175](#) [662903-2](#) [690602-6](#) [7-1579001-9](#) [7-23471-1](#)
[762637-1](#) [808714-1](#) [811242-5](#) [999-50-020083](#) [1-21002-3](#) [1-21002-7](#) [12085270](#) [1-21002-6](#) [1-21113-6](#) [1-22548-4](#) [125442-1](#)
[DCE.91.073.BVC](#) [DCE.91.090.3MVM](#) [DCE.91.130.5MVU](#) [DCE.91.202.BVCM](#) [1338300-1](#) [1-354003-0](#) [1338301-1](#) [DF62/RE-MD](#) [142321](#)
[1456088-1](#) [1490794-1](#) [1-45804-6](#) [1490357-2](#) [1490357-3](#) [AX100749](#) [1-59619-7](#) [1596970-1](#)