

MPT-250C Wire Crimp Pull Tester



The **MPT-250C** is a Motorized Tensile Wire Crimp Pull Tester used to test a crimp contact's or terminal's tensile strength. The unit has a range of 2.5 lbf to 250 lbf and a full color LCD touchscreen interface. Includes data capture capability for exporting test data to a PC via USB or RS-232. *The MPT-250C meets UL, ISO, SAE, MIL, and ASTM tensile test requirements.*

Features and Specifications

- 2 Test Types: "Pull to Fail" and "Force Hold"
- Data Capture (measures continuous and peak force values)
- Compact / High Stability Profile
- Intuitive Full Color Touchscreen LCD User Interface
- Easy Setup, Operation, and Grip Change
- Force Measurement Range: 2.5 – 250.0 lbf (113kgf or 1112.0N)
- Force Measurement Resolution: 0.1 (lbf, kgf, N)
- Force Measurement Accuracy: +/- 0.5% Full Scale
- Force Readout in (lbf, kgf, N)
- Safe Force Overload: 150% of Full Scale
- Pull Rate Speeds: 1 to 10 inches per minute (inch / min)
- Pull Rate / Speed Accuracy: 1-5 +/- 0.125 inch/min, 6-10 +/- 0.250 inch/min
- Accommodates Most 10 AWG - 26 AWG Wire
- Communication Ports: Serial RS-232 (DB9 female connector), USB 2.0
- Power Requirements: IEC Connector, 100 – 240VAC, 50/60Hz, 25 Watts maximum
- External Fuse Type and Rating: Type 3AG (6.3 X 32mm) 1A time delay, 250VAC

Standard Accessories

- Self-Tightening Cam-Type (Contact) Grip (P/N 15-3202C)
- Heavy-Duty Swivel Lockdown Upper Grip (P/N 15-3046)
- Custom Fit, Foam Lined, HardShell Shipping / Travel Case

Optional Accessories

- Ring Terminal Grip (P/N 15-0066C)
- Miniature Contacts Grip (P/N 15-3314)
- Slotted Terminal Grip (P/N 15-3087C)
- Safe-T-Cable Grip Set (P/N 15-3318)
- Customized Grips are available for specific applications

Physical

- Weight 20 lbs (less options)
- Shipping Weight ≈ 25 lbs (with typical / standard grips)
- Base Dimensions: 13.3" Wide x 6" High x 11" Deep

Calibration

- New units are supplied with a "Certificate of Calibration"
- Factory Calibration available

MINIMUM TENSILE STRENGTH REQUIREMENT

CONDUCTOR SIZE AWG (REFERENCE)	UL 486A CAPACITY (COMMERCIAL STANDARD)		TYPICAL MIL-SPEC (AS22520, AS7928, ETC)	
	AWG	Pounds	Newtons	Pounds
26	3	13.4	7	31.2
24	5	22.3	10	44.5
22	8	35.6	15	66.8
20	13	57.9	19	84.6
18	20	89.0	38	169.1
16	30	133.5	50	222.5
14	50	222.5	70	311.5
12	70	311.5	110	489.5
10	80	356.0	150	667.5

MPT-250C STANDARD AND OPTIONAL GRIPS

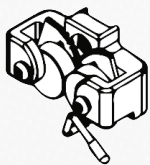

15-3202C
Standard Contact Grip
Terminal Lugs, Machined Contacts

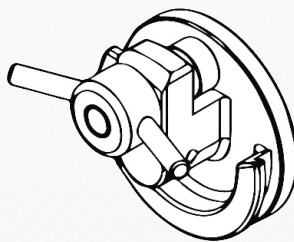

15-3046
Standard Wire Grip
Heavy-Duty Swivel
Lockdown Upper Grip

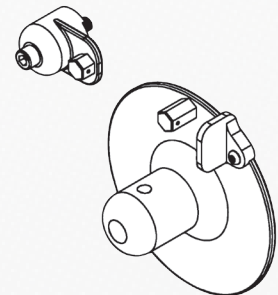

15-3318
Optional
Safety Cable Grip Set



15-0066C
Optional Contact Grip
Ring Terminals



15-3087C
Optional Contact Grip
Terminal Lugs,
Machined Contacts

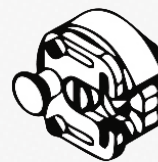

15-3314
Optional Contact Grip
Miniature Contacts



MPT-VF
Optional Accessory
Verification Fixture

X-ON Electronics

Largest Supplier of Electrical and Electronic Components

Click to view similar products for [LAN/Telecom/Cable Testing category](#):

Click to view products by [DMC manufacturer](#):

Other Similar products are found below :

[1673606-1](#) [SEFRAM95](#) [KE8000](#) [POECHECK](#) [TCT-1620](#) [TCT-2210](#) [TCT-680](#) [TCT-2690PRO](#) [TESTER-MS6811](#) [TESTER-MS6812](#) [262](#)
[N044-000-R](#) [MCT-468](#) [TM-901N](#) [TM-902](#) [TM-903](#) [LAN-1](#) [24-517](#) [CT20](#) [40180](#) [TG20](#) [CLM-1000E](#) [CLM-1000](#) [HDMI-100](#) [TEP-100](#)
[KE3100](#) [KE3150](#) [KE501](#) [KE850](#) [VDV501-851](#) [LC-90](#) [P 3434](#) [SEFRAM96](#) [UT681C](#) [UT682D](#) [UT681HDMI](#) [UT681L](#) [UT682](#) [UTP05](#)
[VTLAN6](#) [VTTEST11](#) [VTTEST11N](#) [PA901066](#) [VDV526-052](#) [VDV501-826](#) [VDV501-815](#) [VDV501-829](#) [VDV500-060](#) [MS-POE](#) [MS-POE-](#)
[KIT](#)