

ESD3Z5V0C

ESD3Z5V0C Transient Voltage Suppressors for ESD protection

General description

Transient Voltage Suppressors for ESD protection in a SOD-323 Package.

FEATURES

- Protects one I/O line
- Low clamping voltage
- Working voltages : 5V
- Low leakage current
- Peak power dissipation: 128W (8/20 μ s)

APPLICATIONS:

- High Speed Line :USB1.0/2.0, VGA, DVI, SDI,
- Serial and Parallel Ports
- Notebooks, Desktops, Servers
- Projection TV
- Cellular handsets and accessories
- Portable instrumentation
- Peripherals

MACHANICAL DATA

- SOD-323 package
- Terminals: Tin plated, solderable per MIL-STD-750, method 2026

Package Outline

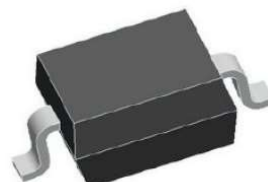

SOD-323 Package

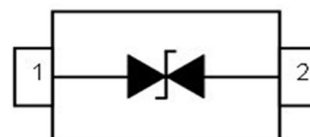

Device Marking:

| Device Type | Marking |
|-------------|----------|
| ESD3Z5V0C | 3M or AC |

ABSOLUTE MAXIMUM RATING

| Symbol | Parameter | Value | Units |
|------------------|---------------------------------|---------|-------|
| V _{ESD} | ESD per IEC 61000-4-2 (Air) | ±30 | kV |
| | ESD per IEC 61000-4-2 (Contact) | ±30 | |
| P _{PP} | Peak Pulse Power (8/20 μ s) | 128 | W |
| T _{OPT} | Operating Temperature | -40~150 | °C |
| T _{STG} | Storage Temperature | -40~150 | °C |

ELECTRICAL CHARACTERISTICS (T_{amb}=25°C)

| Symbol | Parameter | Test Condition | Min | Typ | Max | Units |
|------------------|---------------------------|--|-----|-----|------|---------|
| V _{RWM} | Reverse Working Voltage | | | | 5.0 | V |
| V _{BR} | Reverse Breakdown Voltage | I _T = 1mA | 5.6 | | 7.8 | V |
| I _R | Reverse Leakage Current | V _{RWM} = 5V | | | 1.0 | μ A |
| V _C | Clamping Voltage | I _{PP} = 5A, t _p = 8/20 μ s | | | 11.6 | V |
| V _C | Clamping Voltage | I _{PPmax} = 8A, t _p = 8/20 μ s | | | 16.0 | V |
| C _J | Junction Capacitance | V _R = 0V, f = 1MHz | | | 15 | pF |

Typical Characteristic:

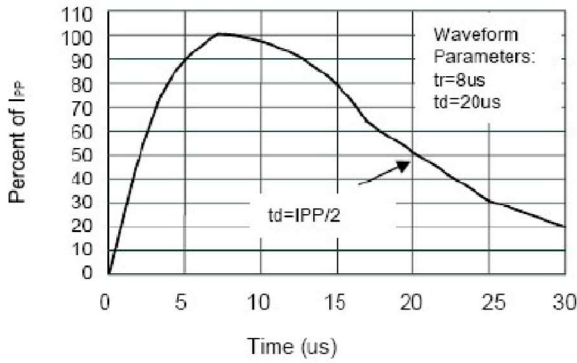

Pulse Waveform

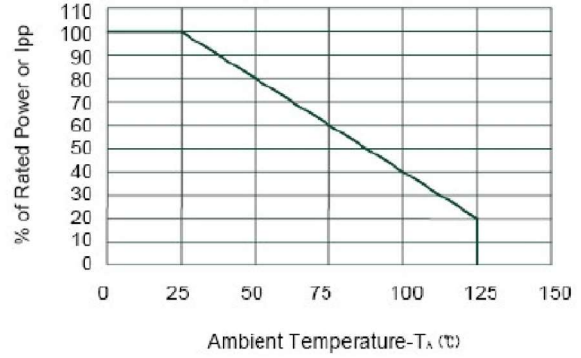

Power Derating Curve

SOD-323 PACKAGE OUTLINE DIMENSIONS

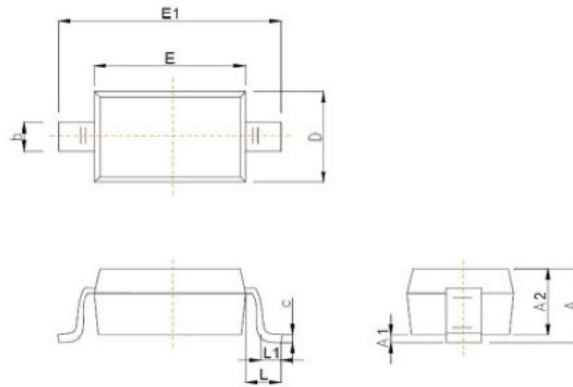

| Symbol | Dimensions in Millimeters | |
|----------|---------------------------|-------|
| | Min | Max |
| A | | 1.00 |
| A1 | 0.000 | 0.100 |
| A2 | 0.800 | 0.900 |
| b | 0.250 | 0.350 |
| c | 0.080 | 0.150 |
| D | 1.200 | 1.400 |
| E | 1.600 | 1.800 |
| E1 | 2.500 | 2.700 |
| e | 1.800 | 2.040 |
| L | 0.475 REF | |
| L1 | 0.250 | 0.400 |
| θ | 0° | 8° |

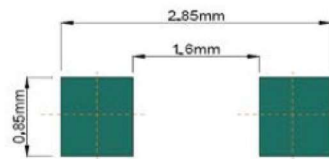

Recommended Pad outline

Important Notice and Disclaimer

DOESHARE has used reasonable care in preparing the information included in this document, but DOESHARE does not warrant that such information is error free. DOESHARE assumes no liability whatsoever for any damages incurred by you resulting from errors in or omissions from the information included herein.

DOESHARE no warranty, representation or guarantee regarding the documents, circuits and products specification, DOESHARE reservation rights to make changes for any documents, products, circuits and specifications at any time without notice.

Purchasers are solely responsible for the choice, selection and use of the DOESHARE products and services described herein, and DOESHARE assumes no liability whatsoever relating to the choice, selection or use of the products and services described herein.

No license, express or implied, by implication or otherwise under any intellectual property rights of DOESHARE.

Resale of DOESHARE products with provisions different from the statements and/or technical features set forth in this document shall immediately void any warranty granted by DOESHARE for the DOESHARE product or service described herein and shall not create or extend in any manner whatsoever, any liability of DOESHARE.

X-ON Electronics

Largest Supplier of Electrical and Electronic Components

Click to view similar products for [ESD Suppressors / TVS Diodes](#) category:

Click to view products by [Doeshare](#) manufacturer:

Other Similar products are found below :

[60KS200C](#) [D18V0L1B2LP-7B](#) [D5V0F4U5P5-7](#) [DESD5V0U1BB-7](#) [NTE4902](#) [P4KE27CA](#) [P6KE11CA](#) [P6KE39CA-TP](#) [P6KE8.2A](#)
[SA110CA](#) [SA60CA](#) [SA64CA](#) [SMBJ12CATR](#) [SMBJ33CATR](#) [SMBJ8.0A](#) [ESD101-B1-02ELS E6327](#) [ESD105-B1-02EL E6327](#) [ESD112-B1-02EL E6327](#) [ESD119B1W01005E6327XTSA1](#) [ESD5V0L1B02VH6327XTSA1](#) [ESD7451N2T5G](#) [19180-510](#) [CPDT-5V0USP-HF](#)
[3.0SMCJ33CA-F](#) [3.0SMCJ36A-F](#) [HSPC16701B02TP](#) [D3V3Q1B2DLP3-7](#) [D55V0M1B2WS-7](#) [DESD5V0U1BL-7B](#) [DRTR5V0U4SL-7](#)
[SCM1293A-04SO](#) [ESD200-B1-CSP0201 E6327](#) [SM12-7](#) [SMLJ45CA-TP](#) [CEN955 W/DATA](#) [82350120560](#) [VESD12A1A-HD1-GS08](#)
[CPDUR5V0R-HF](#) [CPDQC5V0U-HF](#) [CPDQC5V0USP-HF](#) [CPDQC5V0-HF](#) [D1213A-01LP4-7B](#) [D1213A-02WL-7](#) [MMAD1108/TR13](#)
[5KP100A](#) [5KP15A](#) [5KP18A](#) [5KP48A](#) [5KP90A](#) [5KP90CA](#)