

RB520SM9-30

RB520SM9-30 Schottky Barrier Diode

General description

Schottky Barrier Diode in a SOD-923 Plastic Package.

FEATURES

- Low current Rectification
- Low reverse current
- SOD923 Thin SMD package
- RoHS compliant / Green EMC
- Matte Tin (Sn) Lead finish
- Cathode Band / Device marking

Absolute Maximum Ratings T_A = 25°C unless otherwise noted

Symbol	Parameter	Value	Units
VRRM	Repetitive Peak Reverse Voltage	30	V
VR	DC Blocking Voltage	30	V
IO	Continuous Forward Current	200	mA
IFSM	Non-Repetitive Peak Forward Current *1	1	A
PD	Power Dissipation	200	mW
TJ	Junction Temperature	125	°C
TSTG	Storage Temperature	-55 to +125	°C

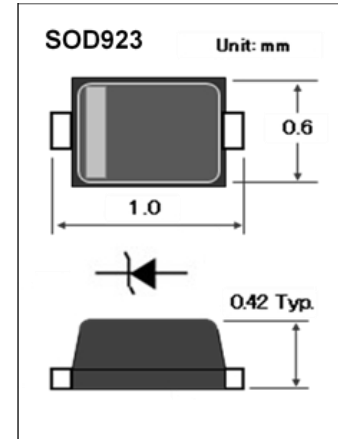

Device Marking Code:

Device Type	Device Marking
RB520SM9-30	B or F

Electrical Characteristics T_A = 25°C unless otherwise noted

Symbol	Parameter	Conditions	Min	Max	Units
VF	Forward Voltage	IF = 10mA		0.40	V
		IF = 200mA		0.60	V
BVR	Breakdown Voltage	IR = 100µA	30		V
IR	Reverse Current	VR = 10V		1	µA

Typical Characteristics

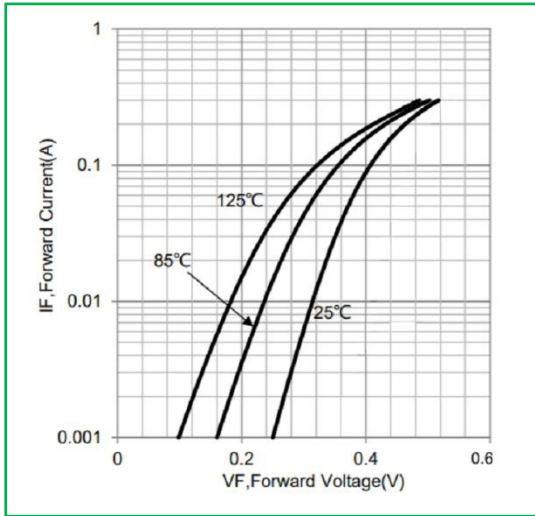

Forward Characteristics

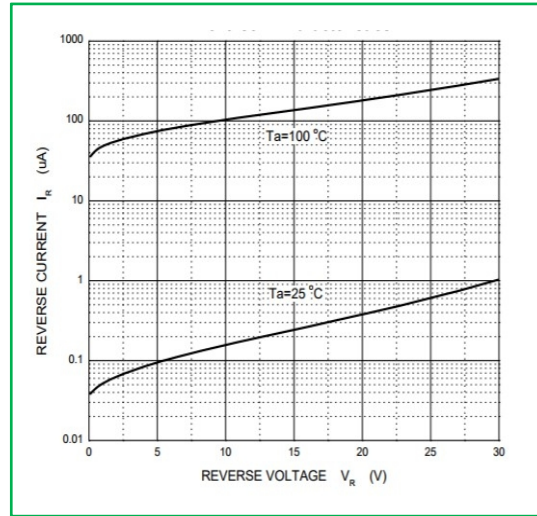

Reverse Characteristics

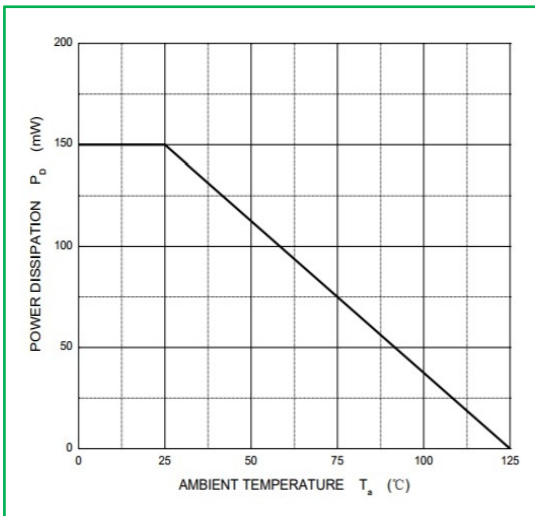

Power Derating Curve

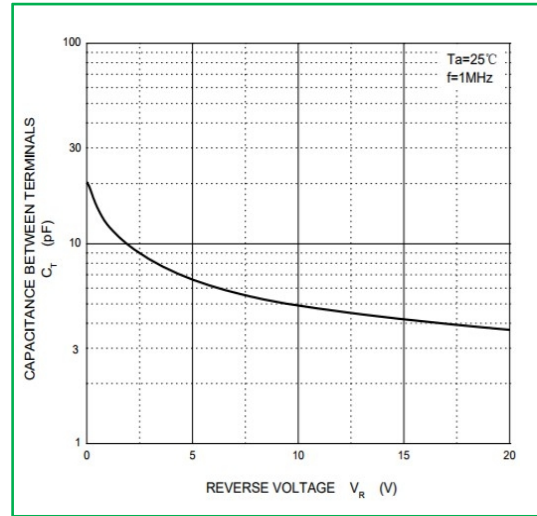

CT vs VR

Package Dimensions

Package outline : SOD923

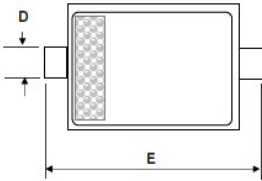
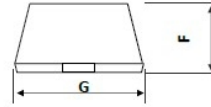
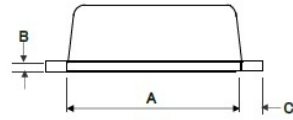

SOD923 * Package Outline

Dimensions

Unit	A	B	C	D	E	F	G
Max.	0.90	0.20	0.15	0.30	1.10	0.45	0.65
Min.	0.70	0.05	0.05	0.15	0.90	0.39	0.55

Note:

1. Halogen free, EMC
2. Pb free solder
3. Lead thickness includes solder plating
4. Lead frame: Cu
5. Other Tolerance: ± 0.05
6. Dimensions are exclusive of Burrs, Mold Flash and Tie Bar extrusions
7. Unit: mm

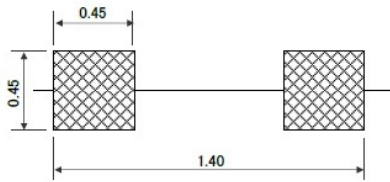

Land Pattern Recommendation

Important Notice and Disclaimer

DOESHARE has used reasonable care in preparing the information included in this document, but DOESHARE does not warrant that such information is error free. DOESHARE assumes no liability whatsoever for any damages incurred by you resulting from errors in or omissions from the information included herein.

DOESHARE no warranty, representation or guarantee regarding the documents, circuits and products specification, DOESHARE reservation rights to make changes for any documents, products, circuits and specifications at any time without notice.

Purchasers are solely responsible for the choice, selection and use of the DOESHARE products and services described herein, and DOESHARE assumes no liability whatsoever relating to the choice, selection or use of the products and services described herein.

No license, express or implied, by implication or otherwise under any intellectual property rights of DOESHARE.

Resale of DOESHARE products with provisions different from the statements and/or technical features set forth in this document shall immediately void any warranty granted by DOESHARE for the DOESHARE product or service described herein and shall not create or extend in any manner whatsoever, any liability of DOESHARE.

X-ON Electronics

Largest Supplier of Electrical and Electronic Components

Click to view similar products for [Schottky Diodes & Rectifiers](#) category:

Click to view products by [Doeshare](#) manufacturer:

Other Similar products are found below :

[MA4E2039](#) [MMBD301M3T5G](#) [RB160M-50TR](#) [D83C](#) [BAS16E6433HTMA1](#) [BAS 3010S-02LRH E6327](#) [BAT 54-02LRH E6327](#)
[NRVBAF360T3G](#) [NSR05F40QNXT5G](#) [NTE555](#) [JANS1N6640](#) [SS3003CH-TL-E](#) [GA01SHT18](#) [CRS10I30A\(TE85L,QM](#) [MBRA140TRPBF](#)
[MBRB30H30CT-1G](#) [BAT 15-04R E6152](#) [JANTX1N5712-1](#) [DMJ3940-000](#) [SB007-03C-TB-E](#) [NRVBB20100CTT4G](#) [NRVBM120LT1G](#)
[NTSB30U100CT-1G](#) [CRG04\(T5L,TEMQ\)](#) [ACDBA1100LR-HF](#) [ACDBA1200-HF](#) [ACDBA240-HF](#) [ACDBA3100-HF](#) [CDBQC0530L-HF](#)
[ACDBA260LR-HF](#) [ACDBA1100-HF](#) [10BQ015-M3/5BT](#) [NRVBM120ET1G](#) [VSSB410S-M3/5BT](#) [1N5819T-G](#) [PDS1040Q-13](#) [B160BQ-13-F](#)
[SDM05U20CSP-7](#) [BAS 70-07 E6433](#) [B140S1F-7](#) [HSM560Je3/TR13](#) [DDB2265-000](#) [ZHCS506QTA](#) [HSM190Je3/TR13](#) [B330AF-13](#)
[ACDBUC0230-HF](#) [SDM1U100S1F-7](#) [MBR10200CTF-G1](#) [CDLL5712](#) [DMF2822-000](#)