

| linear dimension(Tolerances Standard GB/T 14486-2008) |       |              |               |               |                |                 |             | —     | $\nabla$       | $\perp$     |
|---|-------|--------------|---------------|---------------|----------------|-----------------|-------------|-------|----------------|-------------|
| variable range  | to 6  | over 6 to 10 | over 10 to 30 | over 30 to 60 | over 60 to 100 | over 100 to 160 | over 160 to | to 10 | over 10 to 100 | over 100 to |
| tolerance   | ±0.20 | ±0.30        | ±0.50         | ±0.70         | ±1.00          | ±1.30           | ±1.60       | 0.10  | 0.30           | 0.60        |

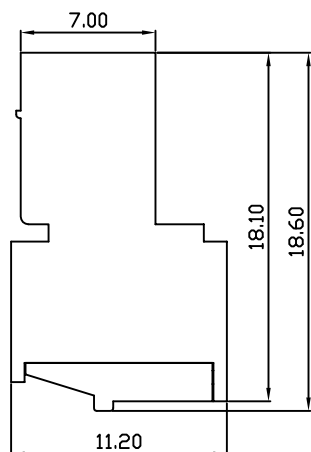
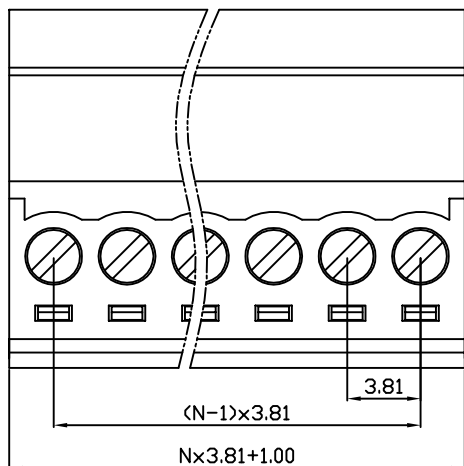
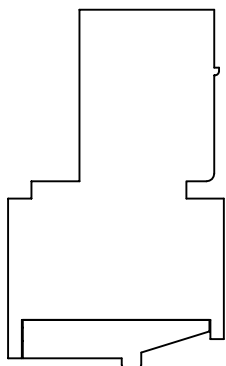
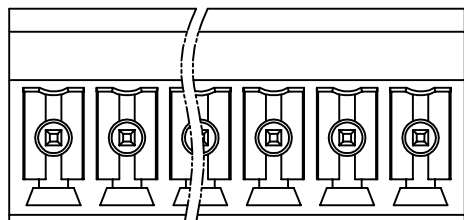

| UL/CUL 技术参数<br>UL/CUL Technical Data |                                   |                  |     |     |
|--------------------------------------|-----------------------------------|------------------|-----|-----|
| 等级                                   | Use Group                         | B                | C   | D   |
| 额定电压                                 | Rated Voltage [V]                 | 300              | -   | 300 |
| 额定电流                                 | Rated Current [A]                 | 8                | -   | 8   |
| 接线范围                                 | Wire Range                        | 28-16            |     |     |
| 单/多芯线                                | Solid/Stranded [AWG]              |                  |     |     |
| 耐电压                                  | Withstanding Voltage              | 1600V/1Min       |     |     |
| IEC 技术参数<br>IEC Technical Data       |                                   |                  |     |     |
| 过电压类别                                | Overvoltage Category              | III              | III | II  |
| 污染等级                                 | Contamination Class               | 3                | 2   | 2   |
| 额定电压                                 | Rated Voltage [V]                 | 160              | 160 | 320 |
| 额定电流                                 | Rated Current [A]                 | 8                | 8   | 8   |
| 额定冲击电压                               | Impulse withstand voltagea [KV]   | 2.5              | 2.5 | 2.5 |
| 导线截面积                                | Conductor cross section           | 1.5              |     |     |
| 硬质/柔性导线                              | Solid/flexible [mm <sup>2</sup> ] |                  |     |     |
| 材料 Material                          |                                   |                  |     |     |
| 绝缘材料                                 | Insulation Material               | PA66             |     |     |
| 阻燃等级                                 | Imflamability                     | UL94V-0          |     |     |
| 导体材料                                 | Contacto Material                 | 铜合金 Copper alloy |     |     |
| 导体表面镀层                               | Contactive Coating                | 镀锡 Sn Plated     |     |     |
| 一般参数 Other Data                      |                                   |                  |     |     |
| 间距                                   | Pitch [mm]                        | 3.81             |     |     |
| 极数                                   | Poles [P]                         | 02-24            |     |     |
| 剥线长度                                 | Stripping Length [mm]             | 6-7              |     |     |
| 螺丝                                   | Screw/扭矩 Torque(Max) [N.m]        | M2/0.2           |     |     |
| 工作温度                                 | Operating temperatur [°C]         | -40~+105         |     |     |
| 引针尺寸                                 | Pin Dimensions [mm]               | -                |     |     |
| PCB板孔径                               | PCB Hole Diameter [mm]            | -                |     |     |

DB2EKR — 3.81 — XXP — C — S/P

(Series No.) (Pitch) (Poles) Slotted/Phillips

(Color) : 1.(Green) 2.(Black) 3.(Blue) 4.(Clear) 5.(Gray)  
6.(Orange) 7.(Red) 8.(White) 9.(Yellow)

APPD: JTING Chen 2022.4.6  
CHKD: Duck Mao 2022.4.6  
DRFT: Steven Lu 2022.4.6

**DORABO** 宁波地博电气有限公司  
Ningbo Dorabo Electric CO., Ltd

NAME: DB2EKR-3.81-XXP-C-S

TYPE: CUSTOMER\_DRAWING

SIZE: A4

SCALE: 1:1

REV: T0-1

SHEET: 1/1

## X-ON Electronics

Largest Supplier of Electrical and Electronic Components

*Click to view similar products for [Pluggable Terminal Blocks](#) category:*

*Click to view products by [DORABO](#) manufacturer:*

Other Similar products are found below :

[57.510.0053](#) [721-104/026-047](#) [721-204/026-045](#) [MC 1.5/ 6-ST-3.5 GY AU](#) [ET02015000J0G](#) [860505](#) [860516](#) [860810](#) [GBPACX-12](#)  
[93.731.4953.0](#) [PVP03-3,50](#) [PVS02-5,00](#) [1-1986160-3](#) [1377680000](#) [1531000000](#) [1546228-5](#) [ELFP03110](#) [ELFP10210](#) [ELFT07250](#)  
[ELVD12100](#) [ELVF09400](#) [ELXH071G0E](#) [1725220000](#) [1760336](#) [1855000000](#) [19346](#) [1946309](#) [1973592](#) [19892](#) [25.320.4053.1](#) [25.320.4553.9](#)  
[25.320.4753.1](#) [25.320.5453.1](#) [25.340.0353.1](#) [25.340.1053.1](#) [25.345.3553.0M001](#) [25.640.3553.1](#) [SH02-5,08](#) [SH06-3,81](#) [SH08-5,08](#) [SH08-](#)  
[5,08-K](#) [SH12-5,08](#) [SHS04-5,00](#) [30.303](#) [30.305](#) [30.306](#) [PHP09-5,08](#) [25.193.0453.0](#) [25.320.4653.1](#) [25.332.2453.1](#)