

REVISION RECORD

REV	ECN	DESCRIPTION	DRFT	DATE

(W/O COVER)

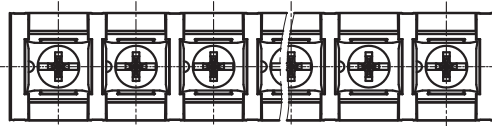

NOTES1:

UL Standard

1. Rated voltage/current : 600V / 40A
2. Torque value : M4 , 10.53Lb.in
3. Wire range : 18~10AWG

NOTES2:

1. Dimension shall be interpreted per ASME Y14.5-2009
2. Pitch : 13.00mm, Poles : N=02~20P
3. Stripping length : 8~9mm
4. Withstanding voltage : AC2200V/1Min
5. Operating temperature : -40°C~+105°C
6. Undimensioned tolerances:

Pitch range in mm	Nominal dimension range in mm		Tolerance
	Over TO	Over TO	
6 TO 10	6 TO 10	6 TO 10	0.1/10
10 TO 24	10 TO 24	10 TO 24	<
30 TO 60	30 TO 60	30 TO 60	±0.15
60 TO 100	60 TO 100	60 TO 100	±0.20
100 TO 150	100 TO 150	100 TO 150	±0.30
150 TO 200	150 TO 200	150 TO 200	±0.50
200 TO 250	200 TO 250	200 TO 250	±0.70
250 TO 300	250 TO 300	250 TO 300	±1.00
300 TO 350	300 TO 350	300 TO 350	±1.30
350 TO 400	350 TO 400	350 TO 400	±2*

7. RoHS Compliance

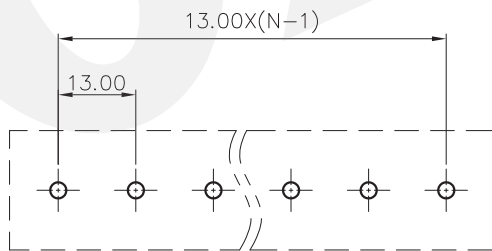
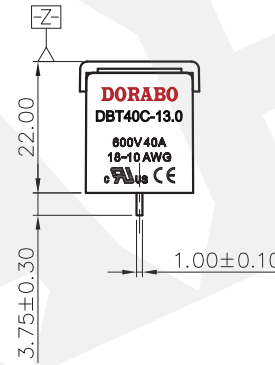
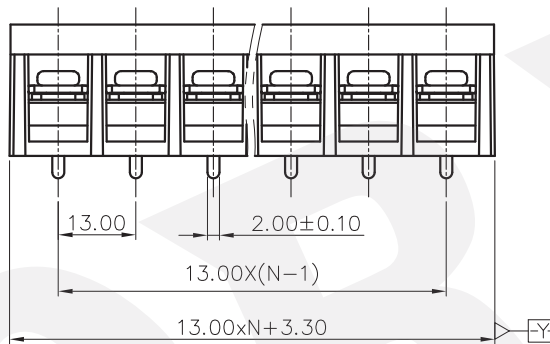
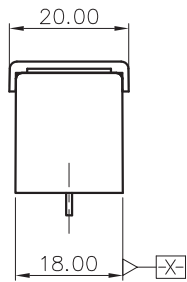

PCB LAYOUT

DBT40C-13.0 - XXP - 1Y - 00A (H)

(Series No.) (Poles) (Single Pitch) (Color): 1.(Grey)  
 2.(Blue)  
 3.(Black)  
 4.(Green)  
 5.(Orange)  
 6.(Red)  
 7.(Transparent)  
 8.(Yellow)  
 9.(White)

(RoHS)  
 00A-(Standard)

DETACHED LISTS	PART NO.: /	<b>DORABO</b> 慈溪市地博电子有限公司 CIXI DORABO ELECTRONICS CO.,LTD			
	APPD: /	NAME: DBT40C-13.0-XXP-1Y-00A(H)			
	CHKD: /	TITLE: CUSTOMER DRAWING			
	DRFT: /	DRAWING NO.: /		REV	DO
THIRD ANGLE PROJECTION		MM (INCH)	DO NOT SCALE DRAWING	SHEET	1/1
			SCALE	1:1	

## X-ON Electronics

Largest Supplier of Electrical and Electronic Components

*Click to view similar products for [Barrier Terminal Blocks](#) category:*

*Click to view products by [DORABO](#) manufacturer:*

Other Similar products are found below :

[CR151D20104](#) [670A-RZ-15-KT20](#) [6C1N03](#) [6PCR-02](#) [6PCR-02-008](#) [6PCR-05-008](#) [6PCR-08-008](#) [6PCR-09-008](#) [6PCR-13-006](#) [6PCR-15-006](#) [6PCV-06-008](#) [6PCV-06-716](#) [6PCV-09-001](#) [6PCV-15-008](#) [6PCV-17-1206](#) [6PCV-20-323](#) [6STR-06-006](#) [6STR-08-006](#) [6STR-12-008](#) [6STR-13-006](#) [6STR-14-008](#) [6STR-16-008](#) [6STR-17-008](#) [6STR-21-008](#) [6STR-25-008](#) [6STR-27-008](#) [6STV-03-008](#) [6STV-09-006](#) [6STV-10-006](#) [6WWV-11-008](#) [6WWV-12-008](#) [6WWV-16-008](#) [71502-50](#) [71507-47-50](#) [72504-C-50](#) [72506-C](#) [72507-C-50](#) [72508-56](#) [73203](#) [75505-C-50](#) [812-GP-3/4ST-09](#) [812-GPZ-03PSB](#) [8-1437402-5](#) [8-1437402-7](#) [8PCR-06-006](#) [8PCR-11-006](#) [8PCV-04-001](#) [8PCV-05-008](#) [8PCV-09-006](#) [8PCV-15-006](#)