

Features

- Uni-directional ESD protection of four lines
- 60W Peak pulse Power (8/20us)
- Working voltage: 5V
- Junction Capacitance: 0.3pF(Typ) I/O to I/O
- Low clamping voltage
- Low leakage current
- IEC 61000-4-2 ±12kV contact ±17kV air
- IEC 61000-4-5 (Lightning) 4.5A (8/20μs)

Applications

- USB 2.0
- Monitors and flat panel displays
- 10/100/1000 ethernet
- Notebook computers
- SIM ports
- ATM interface

Mechanical Data

- Package:SOT-23-6L
- Molding compound flammability rating: UL 94V-0
- RoHS/WEEE Compliant

Schematic & PIN Configuration

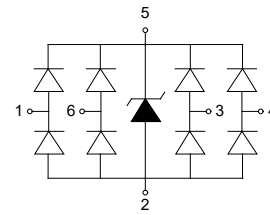

Ordering Information

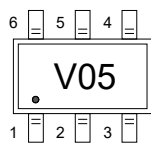
Part Number	Package	Marking	Packing	Reel Size
IP4220CZ6	SOT-23-6L		3000 Tape & Reel	7 inches



Symbol	Parameters
VRWM	Peak Reverse Working Voltage
IR	Reverse Leakage Current @ VRWM
VBR	Breakdown Voltage @ IT
IT	Test Current
IPP	Maximum Reverse Peak Pulse Current
VC	Clamping Voltage @ IPP
IF	Forward Current
VF	Forward Voltage @ IF

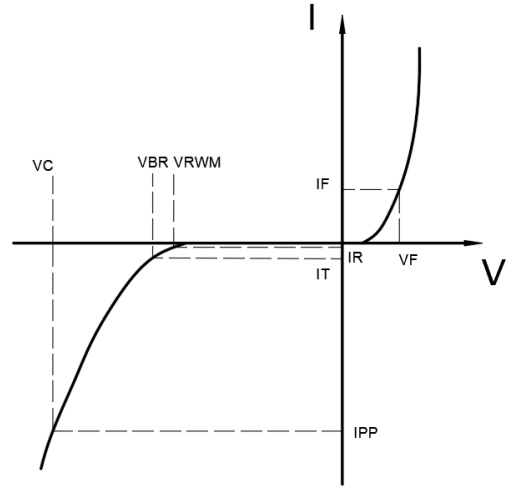

Typical Characteristics ($T_A=25^\circ\text{C}$ unless otherwise Specified)

Figure1: Clamping Voltage vs. Peak Pulse Current

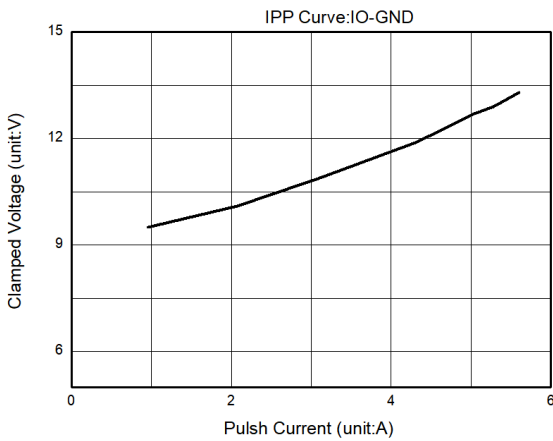

Figure2: 8 X 20us Pulse Waveform

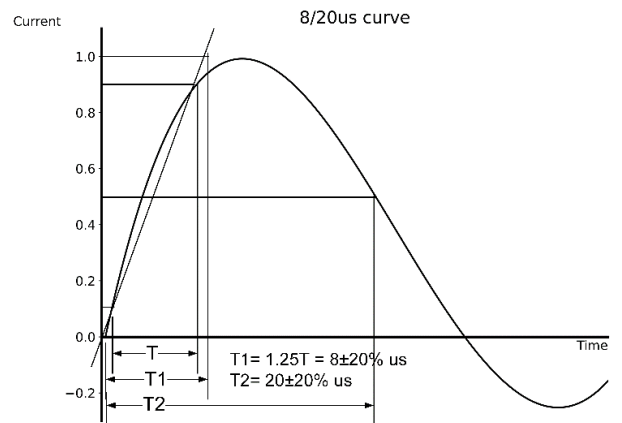

Figure3: Junction Capacitance vs. Reverse Voltage

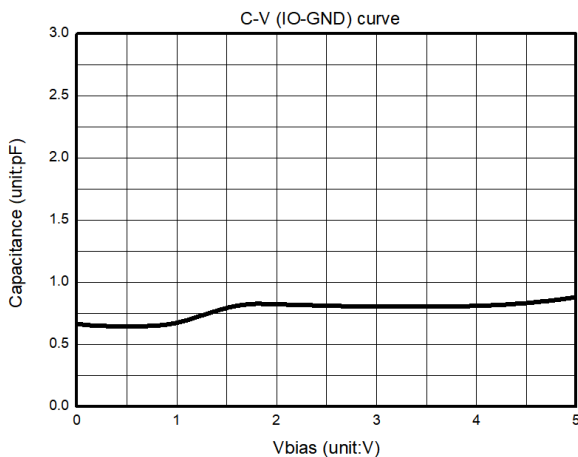

Figure4: Junction Capacitance vs. Reverse Voltage

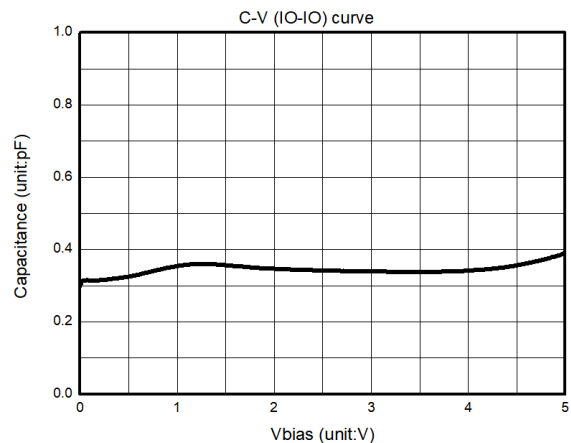



Figure5: Power derating vs. Ambient temperature

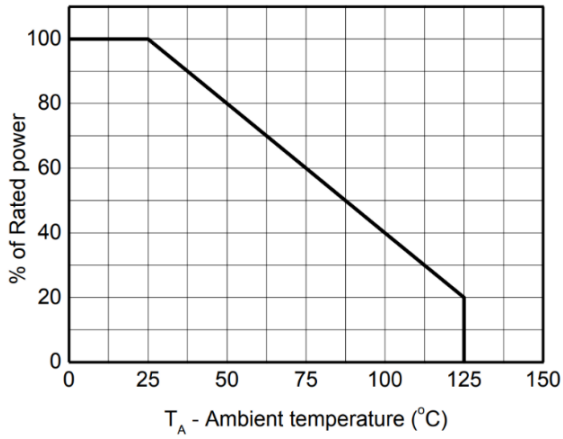
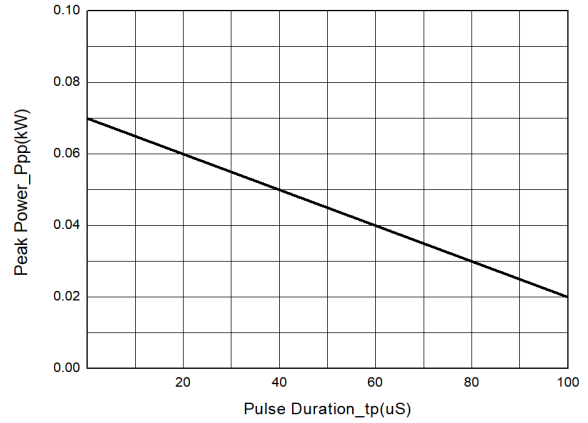
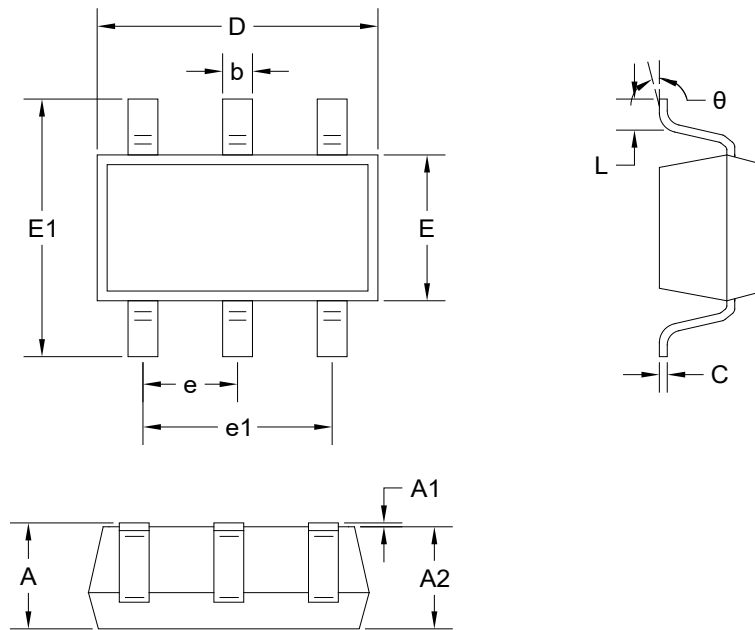

Figure6: Peak Pulse Power vs. Pulse Time



Outline Drawing – SOT-23-6L



Unit: mm

Symbol		A	A1	A2	b	c	D
Spec	Min	1.050	0.000	1.050	0.300	0.100	2.820
	Max	1.250	0.100	1.150	0.500	0.200	3.020
Symbol		E	E1	e	e1	L	θ
Spec	Min	1.500	2.650	0.950BSC	1.800	0.300	0°
	Max	1.700	2.950		2.000	0.600	8°

X-ON Electronics

Largest Supplier of Electrical and Electronic Components

Click to view similar products for [ESD Suppressors / TVS Diodes](#) category:

Click to view products by [DOWO](#) manufacturer:

Other Similar products are found below :

[60KS200C](#) [D18V0L1B2LP-7B](#) [D5V0F4U5P5-7](#) [NTE4902](#) [P4KE27CA](#) [P6KE11CA](#) [P6KE8.2A](#) [JANTX1N6053A](#) [SA60CA](#) [SA64CA](#)
[SMBJ12CATR](#) [SMBJ33CATR](#) [SMBJ6.5A](#) [SMBJ8.0A](#) [ESD101-B1-02ELS E6327](#) [ESD112-B1-02EL E6327](#) [ESD7451N2T5G](#) [19180-510](#)
[CPDT-5V0USP-HF](#) [3.0SMCJ33CA-F](#) [3.0SMCJ36A-F](#) [HSPC16701B02TP](#) [JANTX1N6126A](#) [D3V3Q1B2DLP3-7](#) [D55V0M1B2WS-7](#)
[SCM1293A-04SO](#) [ESD200-B1-CSP0201 E6327](#) [SM12-7](#) [CEN955 W/DATA](#) [VESD12A1A-HD1-GS08](#) [CPDQC5V0-HF](#) [D1213A-01LP4-7B](#)
[ESD101-B1-02EL E6327](#) [AOZ8808DI-03](#) [5KP15A](#) [5KP48A](#) [5KP90A](#) [ESD3V3D7-TP](#) [15KPA36A-LF](#) [P4KE56CA](#) [P4KE68A](#)
[P4KE91CATR](#) [P6KE120A](#) [P6KE13CA](#) [P6KE43CA](#) [P6KE6.8CA](#) [P6KE8.2](#) [P6SMBJ20CA](#) [JANTX1N6072A](#) [SR2835ESKG](#)