

■ Features

- Uni-directional ESD protection of four lines
- 60Watts peak pulse power (tp = 8/20μs)
- Working voltage: 5V
- Low clamping voltage
- Low leakage current
- Ultra-low capacitance: 0.6pF Typ
- Protecting 4 unidirectional lines
- IEC 61000-4-2 ±12kV contact ±17kV air
- IEC 61000-4-5 (Lightning) 4.5A (8/20μs)

■ Mechanical Data

- Package:SOT-23-6L
- Molding compound flammability rating: UL 94V-0
- RoHS/WEEE Compliant

■ Ordering Information

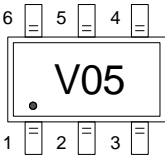
Part Number	Package	Marking	Packing	Reel Size
USBLC6-4SC6	SOT-23-6L		3000 Tape & Reel	7 inches

■ Applications

- USB 2.0
- Monitors and flat panel displays
- 10/100/1000 ethernet
- Notebook computers
- SIM ports
- ATM interface

■ Schematic & PIN Configuration

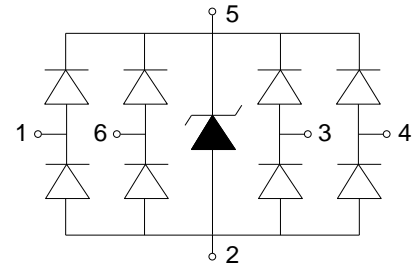

■ Absolute Maximum Rating($T_A=25^{\circ}\text{C}$ unless otherwise Specified)

Parameters	Symbol	Min.	Max.	Unit
Peak pulse power (tp=8/20us)@25°C	Ppk	-	60	W
Peak pulse current (tp=8/20us)@25°C	IPP		4.5	A
ESD (IEC61000-4-2 air discharge) @25°C	VESD	-	±17	kV
ESD (IEC61000-4-2 contact discharge) @25°C	VESD	-	±12	kV
Junction temperature	TJ	-	150	°C
Operating temperature	TOP	-40	125	°C
Storage temperature	TSTG	-55	150	°C
Lead temperature	TL	-	260	°C

■ Electrical Characteristics($T_A=25^{\circ}\text{C}$ unless otherwise Specified)

Parameter	Symbol	Conditions	Min.	Typ.	Max.	Units
Reverse Stand-off Voltage	VRWM				5	V
Reverse Breakdown Voltage	VBR	IT=1mA	6			V
Reverse Leakage Current	IR	VRWM=5V			1	uA
Clamping Voltage	VC	IPP=1A; tp=8/20us		9		V
Clamping Voltage	VC	IPP=4.5A; tp=8/20us		12		V
Junction Capacitance	CJ	I/O to GND; VR=0V; f=1MHz		0.6	0.8	pF
		Between I/O; VR=0V; f=1MHz		0.3	0.4	pF



■ Electrical Parameters($T_A=25^{\circ}\text{C}$ unless otherwise Specified)

Symbol	Parameters
V_{RWM}	Peak Reverse Working Voltage
I_R	Reverse Leakage Current @ V_{RWM}
V_{BR}	Breakdown Voltage @ I_T
I_T	Test Current
I_{PP}	Maximum Reverse Peak Pulse Current
V_C	Clamping Voltage @ I_{PP}
I_F	Forward Current
V_F	Forward Voltage @ I_F

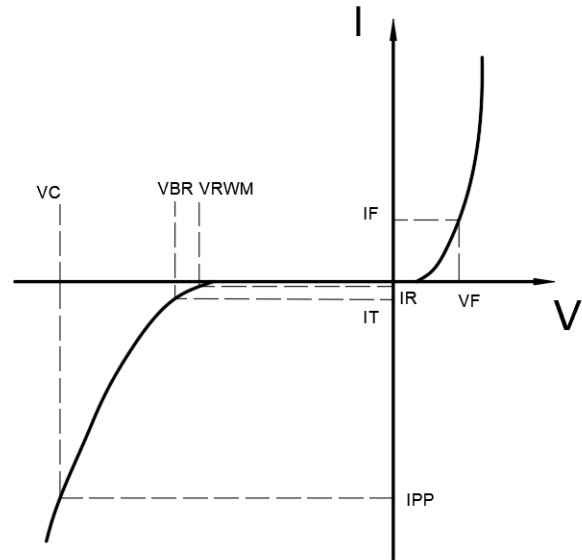

■ Typical Characteristics($T_A=25^{\circ}\text{C}$ unless otherwise Specified)

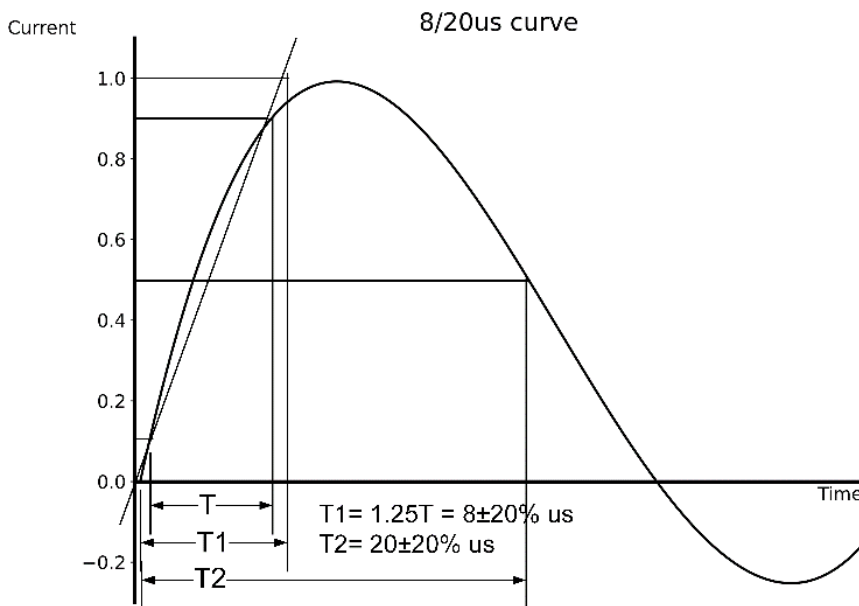



■ Outline Drawing – SOT-23-6L

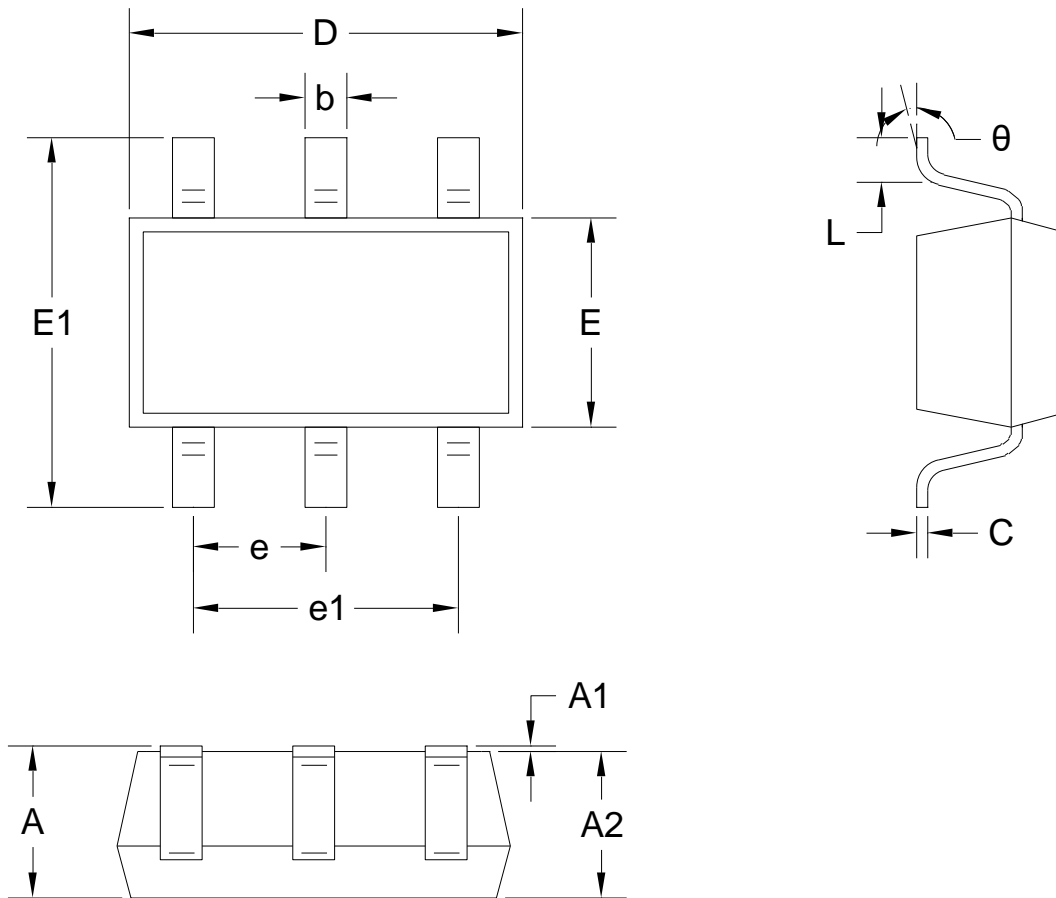

Unit: mm

Symbol		A	A1	A2	b	c	D
Spec	Min	1.050	0.000	1.050	0.300	0.100	2.820
	Max	1.250	0.100	1.150	0.500	0.200	3.020
Symbol		E	E1	e	e1	L	θ
Spec	Min	1.500	2.650	0.950BSC	1.800	0.300	0°
	Max	1.700	2.950		2.000	0.600	8°

X-ON Electronics

Largest Supplier of Electrical and Electronic Components

Click to view similar products for [ESD Suppressors / TVS Diodes](#) category:

Click to view products by [DOWO](#) manufacturer:

Other Similar products are found below :

[60KS200C](#) [D18V0L1B2LP-7B](#) [D5V0F4U5P5-7](#) [NTE4902](#) [P4KE27CA](#) [P6KE11CA](#) [P6KE8.2A](#) [SA60CA](#) [SA64CA](#) [SMBJ12CATR](#)
[SMBJ33CATR](#) [SMBJ6.5A](#) [SMBJ8.0A](#) [ESD101-B1-02ELS E6327](#) [ESD112-B1-02EL E6327](#) [ESD7451N2T5G](#) [19180-510](#) [CPDT-5V0USP-](#)
[HF](#) [3.0SMCJ33CA-F](#) [3.0SMCJ36A-F](#) [HSPC16701B02TP](#) [JANTX1N6126A](#) [D3V3Q1B2DLP3-7](#) [D55V0M1B2WS-7](#) [SCM1293A-04SO](#)
[ESD200-B1-CSP0201 E6327](#) [SM12-7](#) [CEN955 W/DATA](#) [VESD12A1A-HD1-GS08](#) [CPDQC5V0-HF](#) [D1213A-01LP4-7B](#) [ESD101-B1-02EL](#)
[E6327](#) [AOZ8808DI-03](#) [5KP15A](#) [5KP48A](#) [5KP90A](#) [ESD3V3D7-TP](#) [15KPA36A-LF](#) [P4KE56CA](#) [P4KE68A](#) [P4KE91CATR](#) [P6KE120A](#)
[P6KE13CA](#) [P6KE43CA](#) [P6KE6.8CA](#) [P6KE8.2](#) [P6SMBJ20CA](#) [JANTX1N6072A](#) [SR2835ESKG](#) [SA90CA](#)