

- Material acc. to DIN 176: 11 SMn Pb30
- Minimum tensile strength: 500 N/mm²
- Surface finish acc. to DIN 267: galvanised (A3 F)
- Material number: 1.0718
- Tolerance for length dimensions +/- 0.1 mm (DIN 2768-m applies to SW13)
- All articles are also available without undercut.

- Available from stock. Delivery times for intermediate lengths and special versions upon request.



Standard range – spacer bolts [Zinc, plated]

EXECUTION DIA [Internal / external thread]

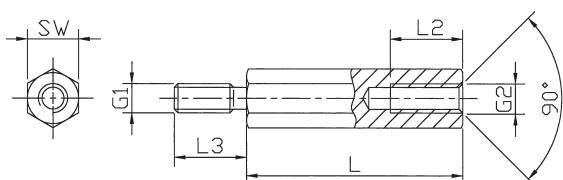

Internal thread lengths [mm]

L	L2 at M2.5-M5	L2 at M2	L2 at M6	L2 at M8
5	3	3		
8	5	5		
10	6	6	6	
12	7	6	7	
15	10	6	10	10
18	10	6	10	
from 20	10	6	12	14

External thread lengths [mm]

G1=G2	L3
M2	5
M2,5	6
M3	6
M4	8
M5	8
M6	10
M8	14

Order No.	Execution	Material	SW* (hexagon)	Thread	Standard lengths in mm
221 x (length)	DIA	Steel	SW4	M2	5, 8, 10, 12, 15, 18, 20, 25, 30, 35, 40
2212 x	DIA	Steel	SW4	M2.5	5, 8, 10, 12, 15, 18, 20, 25, 30, 35, 40
223 x	DIA	Steel	SW5	M3	5, 8, 10, 12, 15, 18, 20, 25, 30, 35, 40, 45, 50
224 x	DIA	Steel	SW5.5	M3	5, 8, 10, 12, 15, 18, 20, 25, 30, 35, 40, 45, 50, 55, 60, 65, 70
225 x	DIA	Steel	SW6	M3	5, 8, 10, 12, 15, 18, 20, 25, 30, 35, 40, 45, 50, 55, 60, 65, 70, 75, 80, 85, 90, 95, 100
226 x	DIA	Steel	SW7	M4	5, 8, 10, 12, 15, 18, 20, 25, 30, 35, 40, 45, 50, 55, 60, 65, 70, 75, 80, 85, 90, 95, 100
227 x	DIA	Steel	SW8	M4	5, 8, 10, 12, 15, 18, 20, 25, 30, 35, 40, 45, 50, 55, 60, 65, 70, 75, 80, 85, 90, 95, 100
228 x	DIA	Steel	SW8	M5	8, 10, 12, 15, 18, 20, 25, 30, 35, 40, 45, 50, 55, 60, 65, 70, 75, 80, 85, 90, 95, 100
229 x	DIA	Steel	SW10	M6	10, 12, 15, 18, 20, 25, 30, 35, 40, 45, 50, 55, 60, 65, 70, 75, 80, 85, 90, 95, 100
2213 x	DIA	Steel	SW13	M8	15, 20, 25, 30, 35, 40, 45, 50, 55, 60, 65, 70, 75, 80, 85, 90, 95, 100

*SW: width across flats

Ordering example: 229 x 50 = DIA / St / SW10 / M6 x 50

X-ON Electronics

Largest Supplier of Electrical and Electronic Components

Click to view similar products for [Standoffs & Spacers](#) category:

Click to view products by [Dremec](#) manufacturer:

Other Similar products are found below :

[588-6208-02](#) [M0513-25-N](#) [M0609-5-SS](#) [M0655-5-AL](#) [M0655-5-N](#) [M0659-4-AL](#) [M0660-4-N](#) [M0671-5-N](#) [M0671-5-SS](#) [M0725-6-N](#)
[M0731-4-N](#) [M1273-3005-AL](#) [60273](#) [60335-SP](#) [60348-SP](#) [60489-SP](#) [60762-SP](#) [60763-SP](#) [M1313-3005-N](#) [M1314-3005-AL](#) [M1314-3005-SS](#)
[M1314-3506-N](#) [M1315-4007-N](#) [M1316-3005-N](#) [M1317-3506-SS](#) [M1318-3005-SS](#) [M1320-3005-AL](#) [M1321-3005-SS](#) [M1322-4007-N](#)
[M1326-3005-AL](#) [M1577-B-4007-B](#) [M2122-2545-SS](#) [M2140-3005-N](#) [M2143-4007-N](#) [M2145-4007-N](#) [M2148-3005-N](#) [M2157-4007-N](#)
[M2162-3506-SS](#) [M2162-4007-N](#) [M2162-4007-SS](#) [632A-9206-17](#) [634A-5005-19](#) [634A-7204-17](#) [636A-7108-17](#) [642A-9416-17](#) [647A-5013-17](#) [660A-2606-17](#) [660A-2606-19](#) [699A-9823-17](#) [699A-9858-17](#)