

REV.	DESCRIPTION	DRAWN	CHECKED	APPROVED
A	NEW RELEASE	HP 25/06/05		

NOTES:

1. SPECIFICATIONS

- Current Rating: 1A
  - Insulation Resistance: 500M $\Omega$  Min
  - Dielectric Withstanding: 300V AC
  - Contact Resistance: 30m $\Omega$  Max
  - Operating Temperature: -40 $^{\circ}$ C to +105 $^{\circ}$ C
2. MATERIALS
- Contact Material: Copper alloy
  - Insulator: Thermoplastic(Ul94 V-0).

3. PART NUMBER: DS1065-01

4. PRODUCT NUMBER CODE:

DS1065-01 - X X X X X

- MOUNTING TYPE
- V/V/T TYPE
- HOUSING COLOR
- B:BLACK
- CONTACT PLATING
- 8: FULL GOLD FLASH
- CONNECTOR TYPE
- S:SOCKET
- NO.OF CONTACTS

1\*1-1\*40

PROJECTION		TITLE	FEMALE HEADER PITCH 1.27mm TYPE
UNITS	mm	SINGLE ROW V/T TYPE	
SHEET SIZE	A4	SERIES	DS1065-01

GENERAL TOLERANCE	X. ±0.60	X. ±0.38	.XX ±0.25
ANGLE TOLERANCE	X. ±5.	X. ±3.	.XX ±2.

DRAWING TYPE	CUSTOMER		
SCALE	1:1	SHEET	1 OF 1
DRAWING NO.	C-DS1065-01-XXXXXX		

**CONFLY CONNELY ELECTRONIC CO., LTD**

**晨翔电子有限公司**

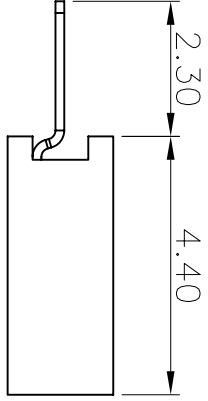
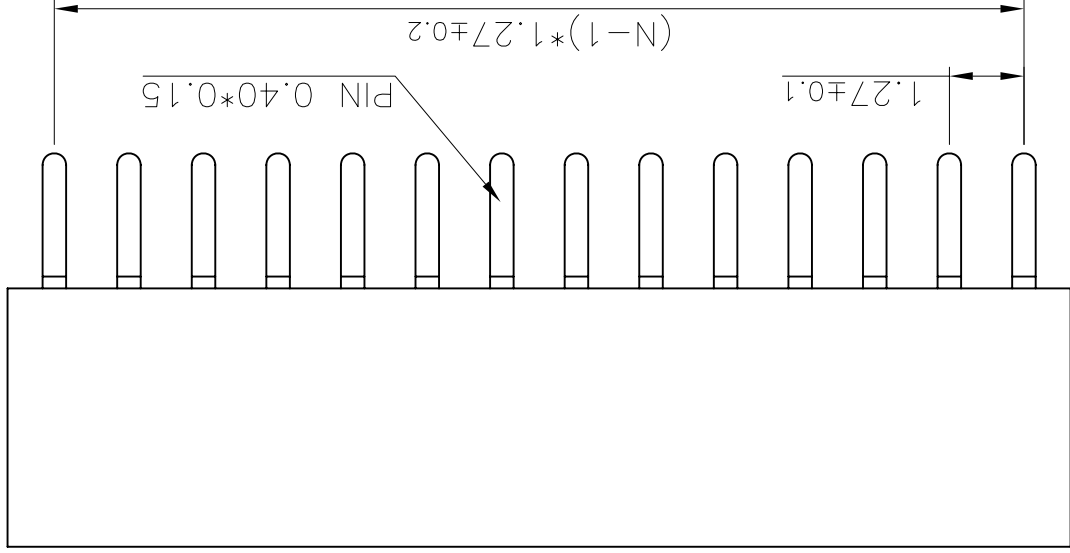
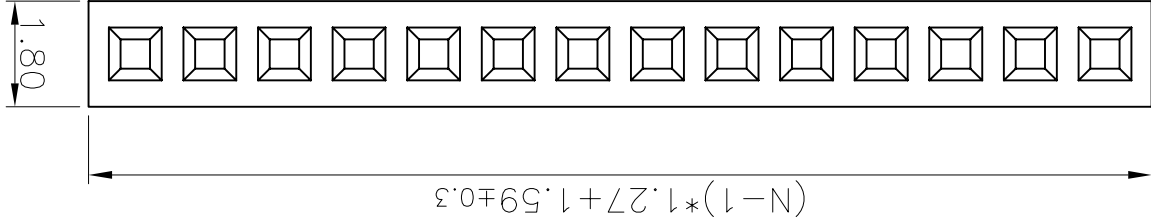

## X-ON Electronics

Largest Supplier of Electrical and Electronic Components

*Click to view similar products for [Headers & Wire Housings](#) category:*

*Click to view products by [Connfly](#) manufacturer:*

Other Similar products are found below :

[95000-104TRLF](#) [10135584-644402LF](#) [DF62W-EP2022PCA](#) [95000-106TRLF](#) [DF62W-2022SCA](#) [DF62W-EP2022PC](#) [2203348](#) [DF62W-2022SC](#) [1084018](#) [1029039](#) [1084017](#) [802-10-012-10-002000](#) [1112640](#) [1112639](#) [891-007-9SS-BST1T](#) [000-34000](#) [0008550134](#) [0009482033](#) [0009507031](#) [57102-F02-18ULF](#) [57102-S06-03LF](#) [57202-S52-04LF](#) [PCN6-15S-2.5E](#) [0039019024](#) [58102-G61-06LF](#) [582553-1](#) [0009485154](#) [0009508121](#) [0022285053](#) [0050291907](#) [018731A](#) [LY20-4P-DT1-P1E-BR](#) [02.125.8002.8](#) [60101931](#) [60598-1 \(Cut Strip\)](#) [M1625-3R/100](#) [61062-3](#) [61082-181009](#) [CSU011177004](#) [636-1427](#) [638009-1](#) [641938-9](#) [641991-4](#) [644168-1](#) [644827-2](#) [647662-1](#) [65039-019ELF](#) [65692-001LF](#) [65781-018](#) [65781-047](#)