

# EAO – Your Expert Partner for Human Machine Interfaces

## 18-158.035 - Pushbutton actuator

### 18-158.035 - Pushbutton actuator

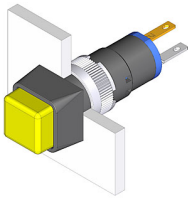

*Attention: The preview is based on a sample product. This can differ from your current configuration.*

#### Mounting

Mounting cut-out	Ø 8 mm
Design	raised

#### Front

Front dimension	9 mm x 9 mm
Front shape	square
Front bezel colour	black
Front bezel material	Plastic

#### Other Attributes

Weight	0,002 kg
--------	----------

#### Operating-/Indication part

Lens illumination	illuminative
-------------------	--------------

#### IP-Rating

Front protection	IP40
------------------	------

#### Connection Method

Terminal	Solder
----------	--------

#### Actuator

Switching action	Momentary
Housing colour	black
Housing material	Plastic

#### Switching element

Switching system	Snap-action switching element
Contacts	1 NC
Switching voltage	42 V AC/DC
Switching current	0.1 A
Contact material	

#### Function

Pushbutton	
------------	--

# EAO – Your Expert Partner for Human Machine Interfaces

18-158.035 - Pushbutton actuator

## Dimensions

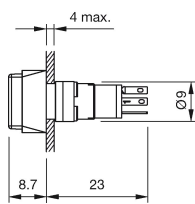

## Mounting cut-outs

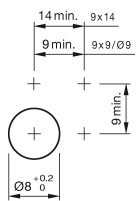

## Wiring diagram

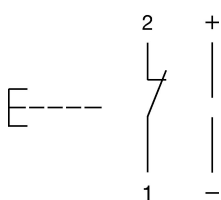

## Component layout

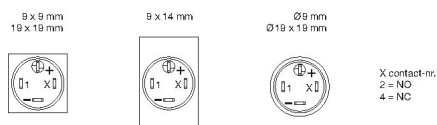

## Additional information

+/- terminals are not connected

## Legend

Contacts: NC = Normally closed  
Switching action: B = Momentary

## X-ON Electronics

Largest Supplier of Electrical and Electronic Components

*Click to view similar products for [Pushbutton Switches](#) category:*

*Click to view products by [EAO](#) manufacturer:*

Other Similar products are found below :

[8940K2012](#) [LW1L-M1C10V-A](#) [LW1L-M1C70-A](#) [LW2L-A1C20M-GD](#) [LW2L-M1C20M-A](#) [60324L](#) [M22-D-R-GB0/K11](#) [M7E-HRN2](#)  
[67021K512](#) [67081K512X](#) [701PB580](#) [7199K101](#) [810K12910](#) [810KSV30B](#) [MML21EA2ADK](#) [MML21KA3ABK](#) [MML23KA3AC05K-001](#)  
[MML23KW3AA01W](#) [8418K2](#) [8442K3](#) [8450K1](#) [860K11911T01A](#) [861901](#) [861K11911T01A07](#) [861K13810T00A14](#) [861K13911](#)  
[8646AB6X718UL](#) [8646ABUL](#) [9001KXRK](#) [907AYY100](#) [PMHD155A1](#) [9533CD4+U574+U4922](#) [95-414.000](#) [99-450.837](#) [99-453.837](#)  
[PV3H2B0NN-341](#) [1203MRA](#) [A22NZBGANGA](#) [A22NZBNANGA](#) [A22NZMPATRA](#) [A2PMA1X03EC56](#) [A3A-5123-02](#) [A3A-7140](#) [A3A-7310](#) [A3A-7340](#) [A3U-TMW-A2C-5M](#) [A595](#) [12037A2ULCSA](#) [ABD122N-B](#) [1211390004](#)