

### 704.074.2 - Stop switch actuator

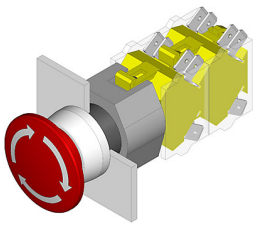

*Attention: The preview is based on a sample product. This can differ from your current configuration.*

#### Mounting

Mounting cut-out Ø 22.5 mm  
Design raised

#### Front

Front ring material Plastic  
Front ring colour grey  
Front shape round  
Front dimension Ø 40 mm

#### Other Attributes

Marking Arrows  
Weight 0.047 kg

#### Operating-/Indication part

Lens material Plastic  
Lens optics opaque  
Lens profile Mushroom  
Lens colour red

#### IP-Rating

Front protection IP 65

#### Actuator

Switching action Maintained

#### Function

Stop switch

# EAO – Your Expert Partner for Human Machine Interfaces

704.074.2 - Stop switch actuator

## Dimensions

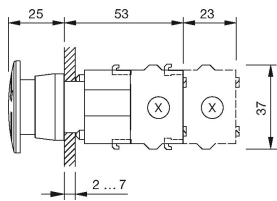

X = Screw terminal

## Mounting cut-outs

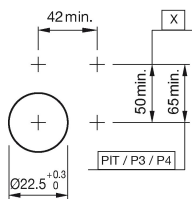

PIT = Push-in terminal

## Wiring diagram



## Additional information

Twist to unlock clockwise

Max. 3 switching elements can be clipped on

## Legend

Switching action: C = Maintained

## X-ON Electronics

Largest Supplier of Electrical and Electronic Components

*Click to view similar products for [Switch Actuators](#) category:*

*Click to view products by [EAO](#) manufacturer:*

Other Similar products are found below :

[LW1B-A0L](#) [LW1B-M0](#) [680-4000-00](#) [704.012.618](#) [704.096.0](#) [704.411.018I](#) [704.412.0](#) [704.633.1](#) [704.730.1](#) [704.733.0](#) [84-1221.7](#) [862.8102](#)  
[G6083](#) [9PA24](#) [A0107X](#) [A019307](#) [ADC-418G](#) [12MA7](#) [ASDHHY-B](#) [HW1F-3G](#) [HW1M-L2222](#) [HW4S-31L](#) [200-.704-00](#) [JS-10008](#) [JS-](#)  
[10083](#) [JS-10118](#) [JS-10133](#) [JS-10277](#) [JS-10389](#) [JS-150](#) [JS-552](#) [JS-555](#) [JS-68](#) [JS-6-B](#) [JS-91](#) [JS-94](#) [22-211.011](#) [9001KXSDC](#) [92-458.500](#)  
[SAPT654133](#) [2PA3](#) [SW53AA2](#) [302561](#) [LW2L-A0](#) [3E-10.4](#) [468-10243-001](#) [51-030.005](#) [JM-13](#) [JS-10120](#) [JS-138-B](#)