

EAO – Your Expert Partner for Human Machine Interfaces

704.075.2 - Stop switch Ø 40 mm - Actuator

704.075.2 - Stop switch Ø 40 mm - Actuator



Attention: The preview is based on a sample product. This can differ from your current configuration.

Attribute

Design	raised
Front dimension	Ø 40 mm
Front form	round
IP front protection	IP65
Mounting cut-out	Ø 22.3 mm
Front bezel colour	Nature
Front bezel material	Aluminium
Front bezel surface	anodised
Housing colour	Grey
Housing material	Plastic
Lens colour	Red
Lens illumination	non illuminative
Lens material	Plastic
Lens optics	opaque
Lens shape	mushroom-head
Marking	Arrows
Switching action	Maintained
Weight	0.044 kg

Function

Stop switch

EAO – Your Expert Partner for Human Machine Interfaces

704.075.2 - Stop switch Ø 40 mm - Actuator

Dimensions

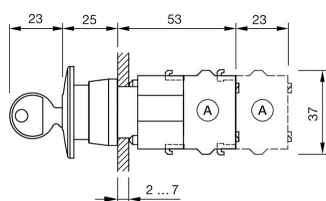

Mounting cut-outs

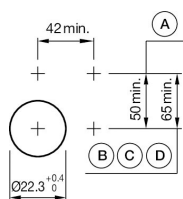

Wiring diagrams

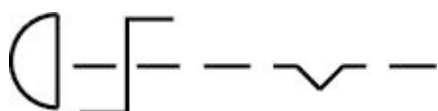

Additional information

The standard lock Ronis 251

The colour of anodised aluminium parts can vary due to technical production reasons

Twist to unlock clockwise

X-ON Electronics

Largest Supplier of Electrical and Electronic Components

Click to view similar products for [Switch Actuators](#) category:

Click to view products by [EAO](#) manufacturer:

Other Similar products are found below :

[LW1B-A0L](#) [LW1B-M0](#) [680-4000-00](#) [704.012.618](#) [704.096.0](#) [704.411.018I](#) [704.412.0](#) [704.633.1](#) [704.730.1](#) [704.733.0](#) [84-1221.7](#) [862.8102](#)
[G6083](#) [9PA24](#) [A0107X](#) [A019307](#) [ADC-418G](#) [12MA7](#) [ASDHHY-B](#) [HW1F-3G](#) [HW1M-L2222](#) [HW4S-31L](#) [200-.704-00](#) [JS-10008](#) [JS-](#)
[10083](#) [JS-10118](#) [JS-10133](#) [JS-10277](#) [JS-10389](#) [JS-150](#) [JS-552](#) [JS-555](#) [JS-68](#) [JS-6-B](#) [JS-91](#) [JS-94](#) [22-211.011](#) [9001KXSDC](#) [92-458.500](#)
[SAPT654133](#) [2PA3](#) [SW53AA2](#) [302561](#) [LW2L-A0](#) [3E-10.4](#) [468-10243-001](#) [51-030.005](#) [JM-13](#) [JS-10120](#) [JS-138-B](#)