

# EAO – Your Expert Partner for Human Machine Interfaces

82-5151.2234 - Illuminated pushbutton 19 mm stainless-steel, maintain

## 82-5151.2234 - Illuminated pushbutton 19 mm stainless-steel, maintain



Attention: The preview is based on a sample product. This can differ from your current configuration.

### Mounting

Mounting cut-out Ø 19 mm  
Design flush

### Front

Front dimension Ø 22 mm  
Front shape round  
Front ring shape flush  
Front bezel material Stainless steel

### Other Attributes

Operating voltage 24 V AC/DC  
Weight 0,021 kg  
Operation current 7 mA

### Operating-/Indication part

Lens optics opaque  
Lens material Stainless steel  
Lens profile flat  
Lens illumination illuminative  
Lens colour Stainless steel

### IP-Rating

Front protection IP65, IP67

### Connection Method

Terminal Solder 2.8 x 0.5 mm

### Actuator

Switching action Maintained

### Switching element

Switching current 3 A  
Contact material Silver  
Contacts 1 C  
Switching system Snap-action switching element  
Switching voltage 240 V AC/DC

### Illumination

Illumination Dot with green LED

### Function

Illuminated pushbutton

# EAO – Your Expert Partner for Human Machine Interfaces

82-5151.2234 - Illuminated pushbutton 19 mm stainless-steel, maintain

## Dimensions

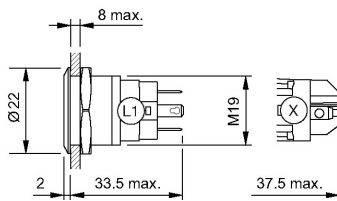

## Mounting cut-outs

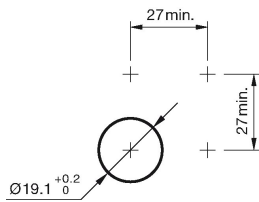

## Wiring diagram

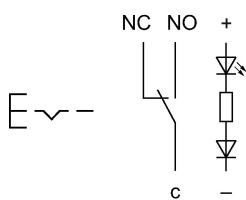

## Component layout

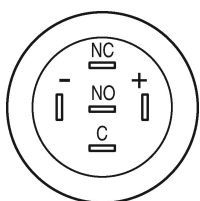

## Legend

Switching action: C = Maintained

Contacts: C = Changeover

## X-ON Electronics

Largest Supplier of Electrical and Electronic Components

*Click to view similar products for [Pushbutton Switches](#) category:*

*Click to view products by [EAO](#) manufacturer:*

Other Similar products are found below :

[8940K2012](#) [LW1L-M1C10V-A](#) [LW1L-M1C70-A](#) [LW2L-A1C20M-GD](#) [LW2L-M1C20M-A](#) [60324L](#) [M22-D-R-GB0/K11](#) [M7E-HRN2](#)  
[67021K512](#) [67081K512X](#) [701PB580](#) [7199K101](#) [810K12910](#) [810KSV30B](#) [MML21EA2ADK](#) [MML21KA3ABK](#) [MML23KA3AC05K-001](#)  
[MML23KW3AA01W](#) [8418K2](#) [8442K3](#) [8450K1](#) [860K11911T01A](#) [861901](#) [861K11911T01A07](#) [861K13810T00A14](#) [861K13911](#)  
[8646AB6X718UL](#) [8646ABUL](#) [9001KXRK](#) [907AYY100](#) [PMHD155A1](#) [9533CD4+U574+U4922](#) [95-414.000](#) [99-450.837](#) [99-453.837](#)  
[PV3H2B0NN-341](#) [1203MRA](#) [A22NZBGANGA](#) [A22NZBNANGA](#) [A22NZMPATRA](#) [A2PMA1X03EC56](#) [A3A-5123-02](#) [A3A-7140](#) [A3A-7310](#) [A3A-7340](#) [A3U-TMW-A2C-5M](#) [A595](#) [12037A2ULCSA](#) [ABD122N-B](#) [1211390004](#)