

Illuminated pushbutton Ø 19 mm silver contact

82-5152.1124



<https://eao.com/p/82-5152.1124>

Your product:



82-5152.1124

Illuminated pushbutton Ø
19 mm silver contact

FRONT

Front bezel material: Stainless steel

MOUNTING

Mounting cut-out: Ø 19 mm

OPERATING-/INDICATION PART

Lens illumination: illuminative

Lens shape: flush

Lens optics: opaque

Illumination colour: Blue

Shape of illumination: Ring

Lens colour: Silver

Lens material: Stainless steel

ELECTRICAL CHARACTERISTICS

Rated insulation voltage U_i : 250 V

Operating voltage: 24 V DC

Switching voltage and switching current:

according to IEC 60947-5-1 (Silver contacts)

Service categorie AC-15

Voltage

24 VAC

35 VAC

110 VAC

220 VAC

Current

1 A

1 A (M12 version)

1 A

0.5 A

Switch rating DC service categorie DC-13 (Silver contacts)

Voltage

24 VDC

35 VDC

110 VDC

220 VDC

Current

0.7 A

0.5 A (M12 version)

0.2 A

0.1 A

according to UL 508 (Silver contacts)

cos ϕ 0,75 ... 0,8

Voltage

120 VAC

240 VAC

24 VAC

Current

5 A

3 A

1 A

Rated Operational Voltage Ue:	250 VAC
Electric strength:	1500 VAC, 50 Hz 1 minute between life terminals and ground
Electrical lifetime:	50 000 cycles of operation
Contacts:	1 C
Pollution degree:	2, according to EN IEC 60947-1
Thermal current Ith:	5 A

MECHANICAL CHARACTERISTIC

Tightening torque:	0.5 ... 0.6 Nm
Switching system:	Snap-action switching element
Weight:	0.018 kg
Switching action:	Momentary
Contact material:	Silver
Mechanical lifetime:	1 Mio. cycles of operation
Terminal:	Screw terminal
Operating force:	4 N ... 7 N
Operating Travel:	ca. 3 mm

AMBIENT CONDITION

Operating temperature:	- 30 °C ... + 70 °C
Shock resistance:	Max. 500 m / s ² as per IEC 60068-2-27
Storage temperature:	

- 40 °C ... + 80 °C

Climate resistance:

Damp heat, 21 days according to IEC 60512-11

Vibration resistance:

10 ... 500 Hz, amplitude 1.5 mm p-p according to IEC 60068-2-6

CERTIFICATE

Conformities:

CE, 2011 / 65 / EC (RoHS), 2014 / 35 / EU (LVD)

Approbations:

CB, CCC, C UL, UL

OTHER

Short Description:

Illuminated pushbutton Ø 19 mm silver contact, Momentary, 24 V DC, 1 C, Screw terminal, Stainless steel, Blue, Silver

Kind of illumination:

Single-LED

Component layouts:

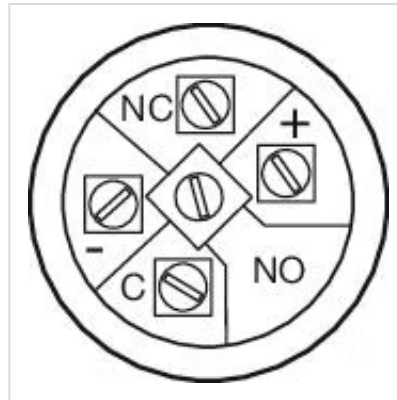

Dimension drawings:

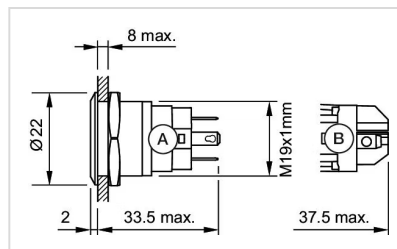

Wiring diagrams:

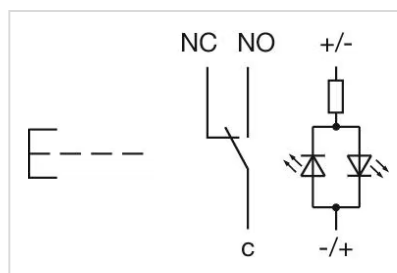

Mounting cut-outs:

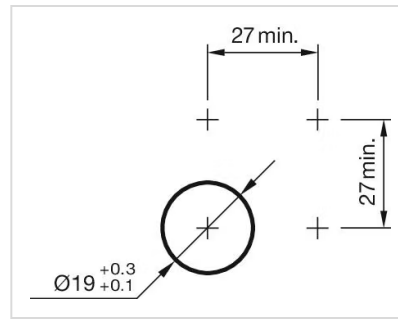

X-ON Electronics

Largest Supplier of Electrical and Electronic Components

Click to view similar products for [Pushbutton Switches](#) category:

Click to view products by [EAO](#) manufacturer:

Other Similar products are found below :

[8971K1133](#) [LW2L-M1C20M-A](#) [01-153.025](#) [M22-D-R-GB0/K11](#) [67021K512](#) [701PB580](#) [7199K101](#) [810K12910](#) [810KSV30B](#) [FLT 2U EE](#)
[01A](#) [MML21EA2ADK](#) [MML21KA3ABK](#) [MML23KW3AA01W](#) [8418K2](#) [8442K3](#) [8450K1](#) [860K11911T01A](#) [861901](#) [861K11911T01A07](#)
[861K13810T00A14](#) [861K13911](#) [8646AB6X718UL](#) [9533CD4+U574+U4922](#) [99-450.837](#) [99-453.837](#) [A2PMA1X03EC56](#) [A3A-7310](#) [A3A-](#)
[7340](#) [12037A2ULCSA](#) [1203A2UL](#) [ABGW410-R](#) [1211390004](#) [ABN400-R](#) [121382](#) [1213C3](#) [HE3B-M2](#) [1211500044](#) [121194](#) [1212MRA](#)
[1232A6NF](#) [121489](#) [1223A2ULCSA](#) [D5P-MT4](#) [13435AG](#) [13445AD29GX768](#) [AG23-L2](#) [AH165-2SGLG1TE3](#) [AH165-TGFY22](#) [AH165-](#)
[TGL5Y11E3](#) [AH165-TGLR11AA3](#)