

Data sheet Illuminated pushbutton Ø 22 mm stainless steel 316L.

Part No.: 82-6651.2114

Technical data



Front form	round
Mounting cut-out	Ø 22.3 mm
Terminal	Plug-in terminal
Shape of illumination	Ring (Tritan)
Operating voltage	24 V DC (LED)
Lens illumination	illuminative
Lens colour	Silver
Lens shape	flush
Lens material	Stainless steel 316L
Lens optics	opaque
Front bezel shape	flush
Front bezel material	Stainless steel 316L
Weight	0.018 kg
IP front protection	IP65, IP67
Contacts change over	1 C
Contact material	Silver
Illumination colour	Red
Kind of illumination	Single-LED
Switching action	Maintained
Switching voltage	36 V
Switching voltage kind of	AC/DC
Switching current	0.6 A
Switching system	Snap-action switching element

Hints

- Switching voltage: max. 36 V AC/1A, max. 36 V DC/0.6

Dimensions

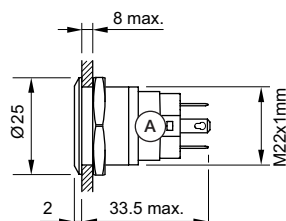

Mounting cut-outs

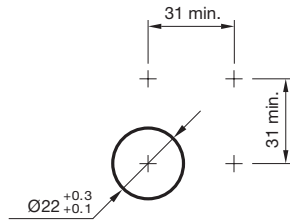

Wiring diagrams

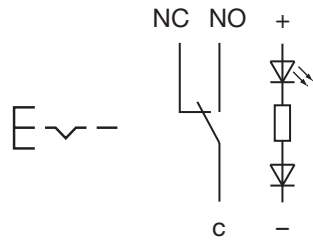

Component layouts

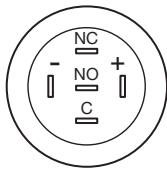

X-ON Electronics

Largest Supplier of Electrical and Electronic Components

Click to view similar products for [Pushbutton Switches](#) category:

Click to view products by [EAO](#) manufacturer:

Other Similar products are found below :

[8971K1133](#) [LW2L-M1C20M-A](#) [M22-D-R-GB0/K11](#) [701PB580](#) [7199K101](#) [810K12910](#) [810KSV30B](#) [FLT 2U EE 01A](#) [MML21EA2ADK](#)
[MML21KA3ABK](#) [MML23KA3AC05K-001](#) [MML23KW3AA01W](#) [8418K2](#) [8442K3](#) [8450K1](#) [860K11911T01A](#) [861901](#) [861K11911T01A07](#)
[861K13810T00A14](#) [861K13911](#) [8646AB6X718UL](#) [9533CD4+U574+U4922](#) [99-450.837](#) [99-453.837](#) [A2PMA1X03EC56](#) [A3A-7310](#) [A3A-](#)
[7340](#) [12037A2ULCSA](#) [1203A2UL](#) [ABGW410-R](#) [ABN400-R](#) [121382](#) [1213C3](#) [HE3B-M2](#) [121194](#) [1212MRA](#) [1241.1183.7047](#) [121489](#)
[1223A2ULCSA](#) [1241.1183.8000](#) [1241.1183.8029](#) [D5P-MT4](#) [13435AG](#) [13445AD29GX768](#) [AG23-L2](#) [AH165-2SGLG1TE3](#) [AH165-](#)
[TGFY22](#) [AH165-TGL5Y11E3](#) [AH165-TGLR11AA3](#) [AH165-TL5Y22E](#)