

Stud-Mounted Fuses

ACK



Catalog Symbol: ACK

Ampere Rating: 10 to 400 Amperes

Voltage Rating: 130 Volts DC or less
 (10-100): 130 Vdc, (120-200): 72 Vdc,
 (225-300): 48 Vdc

Agency Approvals:

U.L. Recognized (15-300A), Guide JFHR2, File E56412

Electrical Ratings (Catalog Symbol, Amperes and Voltage)

ACK-10	130V	ACK-40	130V	ACK-100	130V	ACK-200	72V
ACK-15	130V	ACK-50	130V	ACK-120	72V	ACK-225	80V
ACK-20	130V	ACK-60	130V	ACK-140	72V	ACK-250	80V
ACK-25	130V	ACK-70	130V	ACK-150	72V	ACK-300	80V
ACK-30	130V	ACK-75	130V	ACK-160	72V	ACK-400	80V
ACK-35	130V	ACK-80	130V	ACK-175	72V	—	—

Test Specifications

Fuse	Load	Opening Time
ACK	200%	100 Seconds*
	300%	35 Seconds*
	500%	13 Seconds*

*Approximately.

General Information:

- These fuses avoid needless openings from starting currents or surges.
- A fuse link which operates only on very high overloads or short-circuits.
- Thermal cutout functions on low overloads – the thermal cutout cannot operate quickly at any load, hence long time-lag is obtained on high overloads of short duration.
- This long time-lag also makes it unnecessary to use extra large size or over-size fuses.

Fuseblocks

Catalog Number	Block Number	Catalog Number	Block Number
ACK 10-30	4228	ACK 120-200	3569
ACK 35-60	3411	ACK 225-400	3578
ACK 70-100	2322		

CE logo denotes compliance with European Union Low Voltage Directive (50-1000 Vac, 75-1500 Vdc). Refer to BIF document #8002 or contact Bussmann Application Engineering at 314-527-1270 for more information.

The only controlled copy of this BIF document is the electronic read-only version located on the Bussmann Network Drive. All other copies of this document are by definition uncontrolled. This bulletin is intended to clearly present comprehensive product data and provide technical information that will help the end user with design applications. Bussmann reserves the right, without notice, to change design or construction of any products and to discontinue or limit distribution of any products. Bussmann also reserves the right to change or update, without notice, any technical information contained in this bulletin. Once a product has been selected, it should be tested by the user in all possible applications.

Dimensional Data

All other tolerances (± 0.005) mm
 (± 0.13) inches

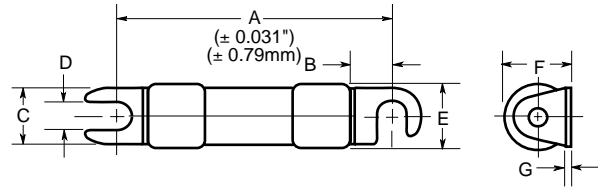

Catalog Symbol	Dimensions in Inches and (mm)						
	A	B	C	D	E	F	G
ACK 10-30	2.5" (63.5)	.375" (9.53)	.500" (12.70)	.250" (6.35)	.557" (14.15)	.588" (14.94)	.031" (0.79)
ACK 35-60	3.0" (76.20)	.470" (11.94)	.685" (17.40)	.344" (8.74)	.812" (20.63)	.860" (21.84)	.051" (1.30)
ACK 70-100	3.5" (88.90)	.547" (13.89)	.750" (19.05)	.312" (7.92)	1.062" (26.98)	1.125" (28.58)	.050" (1.27)
ACK 120-200	3.750" (95.25)	.750" (19.05)	.750" (19.05)	.375" (9.52)	1.062" (26.98)	1.15" (29.21)	.050" (1.27)
ACK 225-400	3.750" (95.25)	.610" (15.49)	.750" (19.05)	.312" (7.92)	1.062" (26.98)	1.125" (28.58)	.050" (1.27)

Note: 10-60 amp fuses use brass terminals and ferrules.
 70-400 amp fuses use copper terminals and ferrules.

Time-Current Characteristics-Total Clear

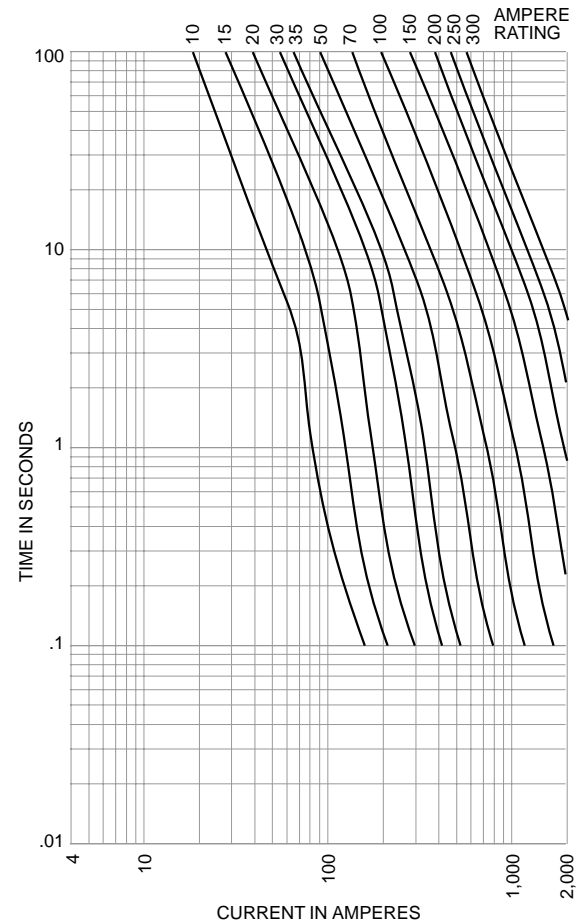

X-ON Electronics

Largest Supplier of Electrical and Electronic Components

Click to view similar products for [Fuse Holder](#) category:

Click to view products by [Eaton](#) manufacturer:

Other Similar products are found below :

[570-290-741P40](#) [570-290-751P40](#) [0031.1351.01](#) [020417G](#) [020418E](#) [80910030](#) [8601.2020](#) [9-3557-GP REV A](#) [15600-08-10](#) [BK1-HTC-45M](#)
[BK/FHN19G](#) [BK/HJM-HH](#) [BK/HKP-CCHH](#) [BK/HKP-E-CC](#) [BK/HKP-E-HH](#) [BK/HKP-EH-HH](#) [BK/HKP-U-HH](#) [BK/HTJ-LES-FUSE](#)
[HMG-241](#) [2086-1](#) [2193](#) [RTMF-SC](#) [2602](#) [2650](#) [FHN31G1](#) [G4PB8](#) [2660](#) [2799](#) [CQ-209V](#) [345621A](#) [3794](#) [4202](#) [4408](#) [4413](#) [4423](#) [4482](#)
[4532](#) [4537](#) [TSD1404-12](#) [BK/FHN31G1](#) [BK/HKP-H-CC](#) [BK/HKP-JQ-BB](#) [BK/HKP-JQW-BB](#) [BK/HKP-N-HH](#) [BK/HKP-S-CC](#) [BK/HKP-W-](#)
[BBHH](#) [BP/HHS](#) [BPHHU](#) [55900008011](#) [C1933](#)