

# Fusible Links

## Protecting Wiring Harnesses

# FLF, FLM

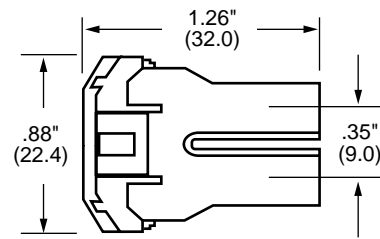

| Cat. Symbol | Type Connection | Amperes            | Carton Data |          | Dimensions                                | Volume      |
|-------------|-----------------|--------------------|-------------|----------|---|-------------|
|             |                 |                    | Qty.        | Weight   |   |             |
| FLF         | Female          | 20, 30, 40, 50, 60 | 10          | .30 Lbs. | 3" x 2" x 7 <sup>3</sup> / <sub>4</sub> " | 46.5 cu. in |

| Part No. | Rated Current | Applicable Wire   | Color      |
|----------|---------------|-------------------|------------|
| FLF-60   | 60A           | AVS 5 (AWG 10)    | Yellow     |
| FLF-50   | 50A           | AVS 3 (AGW 12)    | Red        |
| FLF-40   | 40A           | AVS 3 (AGW 12)    | Green      |
| FLF-30   | 30A           | AVS 2 (AWG 14)    | Pink       |
| FLF-20   | 20A           | AVS 1.25 (AWG 16) | Light Blue |

| Part No. | Rated Current | Applicable Wire | Color  |
|----------|---------------|-----------------|--------|
| FLM-120  | 120A          | AV 15 (AWG 6)   | Gray   |
| FLM-100  | 100A          | AV 10 (AWG 8)   | Blue   |
| FLM-80   | 80A           | AV 8 (AWG 8)    | Black  |
| FLM-60   | 60A           | AVS 5 (AWG 10)  | Yellow |
| FLM-30   | 30A           | AVS 2 (AWG 14)  | Pink   |

### Dimensions

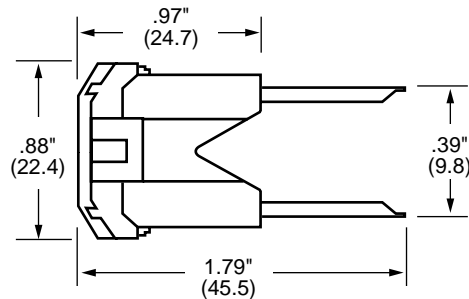

| Cat. Symbol | Type Connection | Amperes              | Carton Data |          | Dimensions                                | Volume      |
|-------------|-----------------|----------------------|-------------|----------|---|-------------|
|             |                 |                      | Qty.        | Weight   |   |             |
| FLM         | Male            | 30, 60, 80, 100, 120 | 10          | .35 Lbs. | 3" x 2" x 7 <sup>3</sup> / <sub>4</sub> " | 46.5 cu. in |

The only controlled copy of this Data Sheet is the electronic read-only version located on the Bussmann Network Drive. All other copies of this Data Sheet are by definition uncontrolled. This bulletin is intended to clearly present comprehensive product data and provide technical information that will help the end user with design applications. Bussmann reserves the right, without notice, to change design or construction of any products and to discontinue or limit distribution of any products. Bussmann also reserves the right to change or update, without notice, any technical information contained in this bulletin. Once a product has been selected, it should be tested by the user in all possible applications.

## X-ON Electronics

Largest Supplier of Electrical and Electronic Components

*Click to view similar products for [Automotive Fuses](#) category:*

*Click to view products by [Eaton](#) manufacturer:*

Other Similar products are found below :

[ATM-4LP](#) [299080](#) [HBO-70](#) [0287015](#) [FMM-15](#) [0297003.WXT](#) [0695060.PXPS](#) [MRBF-075](#) [MRBF-300](#) [MRBF-200](#) [ANX80-UL-20A](#)  
[ANX80-UL-25A](#) [ANX80-UL-30A](#) [ANX80-UL-35A](#) [ANX80-UL-40A](#) [ANT-I-3A](#) [APM-I-25A](#) [APR-10A](#) [APR-25A](#) [ANX58-UL-20A](#)  
[ANX58-UL-25A](#) [ANX58-UL-35A](#) [ANX58-UL-40A](#) [ANX58-UL-50A](#) [ANM-4A](#) [ANM-25A](#) [ANE-175A](#) [APM-25A](#) [APM-4A](#) [ACB2-PL-](#)  
[15A](#) [ACB2-PL-25A](#) [ANM58-15A](#) [ANM58-5A](#) [FMX-LP-20A](#) [MIDA-50A](#) [0695040.PXP](#) [0327030.YX2T](#) [0298500.UX1M8](#) [0299070.ZXT](#)  
[20A32V](#) [ATM-1](#) [MRBF-040](#) [MRBF-100](#) [MRBF-250](#) [MRBF-050](#) [MRBF-060](#) [CFCOVER-2R](#) [MRBF-030](#) [3298600.ZXM10](#) [AMG-80](#)