

# BCI motor.

BCI-52.XX



- Direct current motor with permanent magnets made of ceramic bound ferrite
- Mechanical commutation through 12-piece collector
- Closed steel motor housing with die-cast zinc bearing flanges
- Operation in both directions of rotation
- Service life 3 000 h for continuous operation (S1)
- Insulation class B
- Protection class IP 40, optionally higher

Nominal data					
Type		BCI-52.30-A00	BCI-52.30-B00	BCI-52.60-A00	BCI-52.60-B00
Nominal voltage ( $U_{BN}$ )	V DC	12	24	12	24
Nominal speed ( $n_N$ )*	rpm	3 600	3 600	3 100	3 100
Nominal torque ( $M_N$ )*	mNm	100	100	170	170
Nominal current ( $I_{BN}$ )*	A	4.80	2.20	6.40	3.00
Nominal output power ( $P_N$ )*	W	38	38	55	55
Rated efficiency, approx. ( $\eta_N$ )	%	66	71	72	77
Free-running speed ( $n_f$ )	rpm	4 200	4 200	3 500	3 500
Free-running current ( $I_{fL}$ )	A	0.48	0.30	0.60	0.40
Starting torque ( $M_A$ )	mNm	550	650	800	980
Starting current ( $I_A$ )	A	20.8	12.0	27.6	16.0
Induced voltage ( $U_{imax}$ )	V/1 000 rpm	2.78	5.60	3.04	6.40
Connection resistance ( $R_v$ )	Ohm	0.58	2.00	0.44	1.50
Connection inductance ( $L_v$ )	mH	0.90	3.60	1.10	4.70
Rotor moment of inertia ( $J_R$ )	kgm <sup>2</sup> x 10 <sup>-6</sup>	23	23	46	46
Heat resistance ( $R_{th}$ )	K/W	3.20	3.20	3.30	3.30
Protection class**		IP 40			
Permissible ambient temperature range ( $T_U$ )	°C	0 ... +40			
Weight	kg	0.90	0.90	1.10	1.10
Order no.		on request	931 5230 001	on request	931 6325 070
Subject to alterations		* at $T_U$ max. 40°C ** Classification of protection class refers to installed state with sealing on the flange side			

## Characteristic curve

BCI-52.30, 24 V (at 25°C)

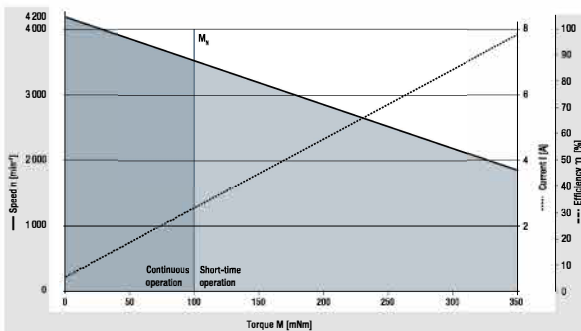

<sup>1)</sup> Nominal data, see table

BCI-52.60, 24 V (at 25°C)

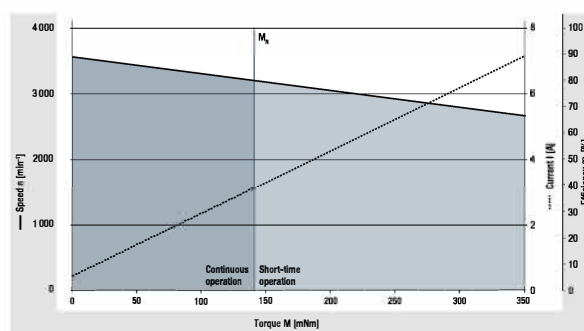

<sup>1)</sup> Nominal data, see table

**Technical drawing**

Image standard type / All dimensions in mm

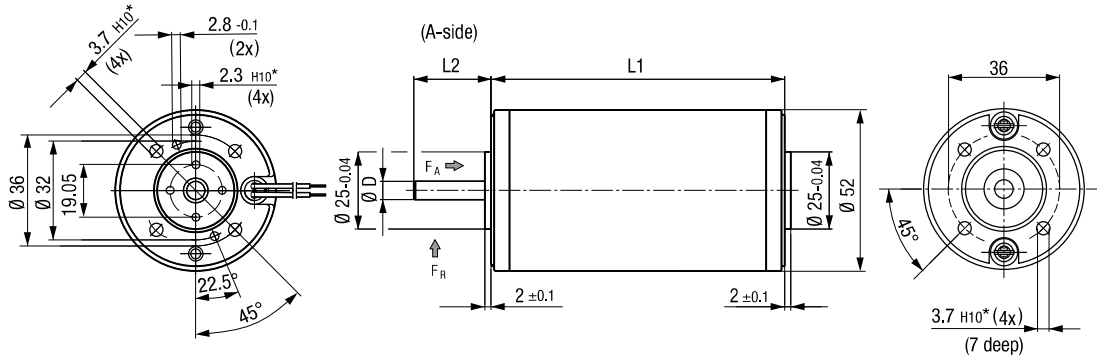

Shaft dimensions	ØD (A-side)	L2 (A-side)	ØD (B-side)	L (B-side)
Standard type	6 <sub>gs</sub>	25,0 mm	--	--
Preferred type	6 <sub>gs</sub>	18,2 mm	6 <sub>gs</sub>	15 mm

Type	L1
BCI-52,30	95 ± 0,5
BCI-52,60	125 ± 0,5

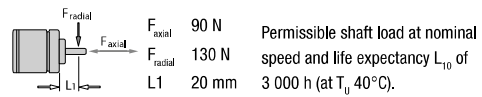

\* Blind holes for thread-forming screws according to DIN 7500

**Electrical connection**

**Connection cable**

Color	Function	
red	Power supply (+)	Cable length 300 ± 30 from motor Cable end 7 ± 2 stripped and tin-coated
black	GND (-)	

Change of the rotating direction is possible by polarity reversal of the wires

**Modular construction kit**

<p><b>Brake system</b></p> <p>Spring-applied braking BFK 457-02 (page 48)</p>		<p><b>Basic motor</b></p>
<p><b>Encoder system</b></p> <p>Magnetic encoder system PMG 2-X (page 50) Optical incremental encoder HEDS 5500 / PWB AE30 (page 52)</p>		<p><b>Planetary gearhead</b></p> <p>Performax® 52 (page 24)</p>

For motor-gearbox combinations, depending on the choice of the single components, the maximum allowable torque (gearbox) can be exceeded or respectively not reached.

## X-ON Electronics

Largest Supplier of Electrical and Electronic Components

*Click to view similar products for [AC, DC & Servo Motors](#) category:*

*Click to view products by [ebm papst](#) manufacturer:*

Other Similar products are found below :

[M2E068-DF13-79](#) [79207644](#) [805470B40040MY](#) [80807028](#) [808070Y01125Z](#) [808550Y00049Z](#) [823055C10001MWY](#) [82520405](#) [82664024](#)  
[82802504](#) [R88MK10030H](#) [M4E068-EC03-01](#) [M4E068-CF01-01](#) [79265119](#) [80510503](#) [805470A40040MY](#) [805470B40020MY](#) [80627003](#)  
[808070Y00250Y](#) [808070Y83.33Y](#) [823055A20001MW](#) [825140A40010MP](#) [825290C43.75MX](#) [82714023](#) [82800003](#) [82830009](#) [82810017](#)  
[R88M-K90010F-S2](#) [R88M-K1K030H-S2](#) [89830012](#) [82840003](#) [82840004](#) [82869011](#) [82524021](#) [82862202](#) [82869006](#) [82861013](#) [80803009](#)  
[80547015](#) [82862205](#) [R88M-K40030T-B](#) [80527006](#) [82330514](#) [81021118](#) [82524004](#) [89800008](#) [82867009](#) [82662564](#) [82662515](#) [82600041](#)