

PIN

AISI 303 stainless steel

PAWLS

AISI 304 stainless steel

SPRING

AISI 301 stainless steel.

KNOB

Glass-fibre reinforced polyamide based (PA) technopolymer, black colour, provided with holes for security ring.

PUSH BUTTON

Polyamide based (PA) technopolymer, red colour, glossy finish.

WORKING TEMPERATURE

From -20°C to +80°C.

FEATURES AND APPLICATIONS

GN 114.3 stainless steel lock pins are generally used for quick fixation or connection of parts to be machined, in particular for elements which need to be removed and reset continuously.

ACCESSORIES

To optimise the use of these lock pins, have been designed:

- ball chains GN 111 (see page 934);
- retaining cables GN 111.2 (see page 935);
- spiral retaining cables GN 111.4 (see page 936).

SPECIAL EXECUTIONS ON REQUEST

Other dimensions.

INSTRUCTIONS OF USE

By pressing the push button the two pawls are freed and the pin can be pulled-out or inserted.



Application example

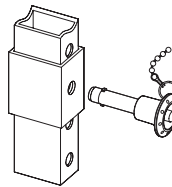

Conversion Table 1 mm = 0.039 inch			
d1			
mm	inch	mm	inch
6	0.24	12	0.47
8	0.31	16	0.63
10	0.39	16	0.79

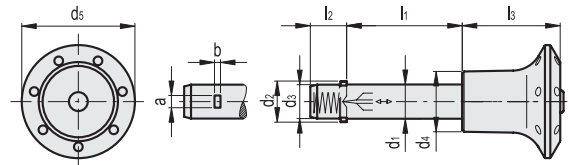

Code	Description	d1-0.1	d2	d3	d4	d5	l1+0.4	l2	l3	a	b	Double sided shearing force [KN]	⚖️
GN.38795	GN 114.3-6-10	6	7.5+0.5	5.9	15	30	10	7	21	2.3	0.5	17	10
GN.38796	GN 114.3-6-16	6	7.5+0.5	5.9	15	30	16	7	21	2.3	0.5	17	12
GN.38797	GN 114.3-6-20	6	7.5+0.5	5.9	15	30	20	7	21	2.3	0.5	17	13
GN.38798	GN 114.3-6-25	6	7.5+0.5	5.9	15	30	25	7	21	2.3	0.5	17	15
GN.38799	GN 114.3-6-30	6	7.5+0.5	5.9	15	30	30	7	21	2.3	0.5	17	15
GN.38800	GN 114.3-6-40	6	7.5+0.5	5.9	15	30	40	7	21	2.3	0.5	17	16
GN.38751	GN 114.3-8-20	8	10+0.5	7.9	15	30	20	8.4	21	2.8	1	35	18
GN.38753	GN 114.3-8-25	8	10+0.5	7.9	15	30	25	8.4	21	2.8	1	35	19
GN.38755	GN 114.3-8-30	8	10+0.5	7.9	15	30	30	8.4	21	2.8	1	35	22
GN.38757	GN 114.3-8-40	8	10+0.5	7.9	15	30	40	8.4	21	2.8	1	35	24
GN.38759	GN 114.3-8-50	8	10+0.5	7.9	15	30	50	8.4	21	2.8	1	35	28
GN.38761	GN 114.3-10-20	10	12+1	9.9	18	34	20	9.8	26	3.3	1	47	27
GN.38763	GN 114.3-10-25	10	12+1	9.9	18	34	25	9.8	26	3.3	1	47	40
GN.38765	GN 114.3-10-30	10	12+1	9.9	18	34	30	9.8	26	3.3	1	47	31
GN.38767	GN 114.3-10-40	10	12+1	9.9	18	34	40	9.8	26	3.3	1	47	37
GN.38769	GN 114.3-10-50	10	12+1	9.9	18	34	50	9.8	26	3.3	1	47	42
GN.38771	GN 114.3-12-25	12	14+1	11.9	18	34	25	11.3	26	3.8	1	75	38
GN.38773	GN 114.3-12-30	12	14+1	11.9	18	34	30	11.3	26	3.8	1	75	39
GN.38775	GN 114.3-12-40	12	14+1	11.9	18	34	40	11.3	26	3.8	1	75	46
GN.38777	GN 114.3-12-50	12	14+1	11.9	18	34	50	11.3	26	3.8	1	75	53
GN.38779	GN 114.3-12-60	12	14+1	11.9	18	34	60	11.3	26	3.8	1	75	62
GN.38781	GN 114.3-16-30	16	19+1	15.9	22	40	30	14.2	32	4.3	1.2	138	80
GN.38782	GN 114.3-16-35	16	19+1	15.9	22	40	35	14.2	32	4.3	1.2	138	85
GN.38783	GN 114.3-16-40	16	19+1	15.9	22	40	40	14.2	32	4.3	1.2	138	95
GN.38785	GN 114.3-16-50	16	19+1	15.9	22	40	50	14.2	32	4.3	1.2	138	110
GN.38787	GN 114.3-16-60	16	19+1	15.9	22	40	60	14.2	32	4.3	1.2	138	120
GN.38789	GN 114.3-16-70	16	19+1	15.9	22	40	70	14.2	32	4.3	1.2	138	133
GN.38849	GN 114.3-20-30	20	23+1	19.8	25	40	30	14.8	33	4.3	1.2	228	120
GN.38850	GN 114.3-20-35	20	23+1	19.8	25	40	35	14.8	33	4.3	1.2	228	130
GN.38851	GN 114.3-20-40	20	23+1	19.8	25	40	40	14.8	33	4.3	1.2	228	140
GN.38853	GN 114.3-20-50	20	23+1	19.8	25	40	50	14.8	33	4.3	1.2	228	160
GN.38855	GN 114.3-20-60	20	23+1	19.8	25	40	60	14.8	33	4.3	1.2	228	185
GN.38856	GN 114.3-20-70	20	23+1	19.8	25	40	70	14.8	33	4.3	1.2	228	210
GN.38857	GN 114.3-20-80	20	23+1	19.8	25	40	80	14.8	33	4.3	1.2	228	230

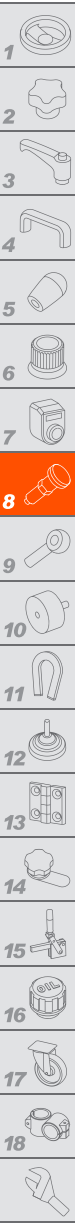

Indexing and positioning elements

X-ON Electronics

Largest Supplier of Electrical and Electronic Components

Click to view similar products for [Crimpers / Crimping Tools](#) category:

Click to view products by [Elesa & Ganter](#) manufacturer:

Other Similar products are found below :

[010-0096](#) [M225201-06](#) [M225202-37](#) [6-1579015-5](#) [CT150-2-D02](#) [CT150-6-RH07](#) [622-6441LF](#) [M322](#) [6-304052-1](#) [63456-0054](#) [63484-3701](#)
[63800-8355](#) [63819-1875](#) [63819-2875](#) [63819-4475](#) [63823-3475](#) [63827-5375](#) [64001-0975](#) [64001-4175](#) [64005-0175](#) [662903-2](#) [690602-6](#) [7-](#)
[1579001-9](#) [7-23471-1](#) [762637-1](#) [808714-1](#) [811242-5](#) [91362-1](#) [999-50-020083](#) [1-21002-3](#) [1-21002-7](#) [12085270](#) [1-21002-6](#) [1-21113-6](#) [1-](#)
[22548-4](#) [125442-1](#) [DCE.91.073.BVC](#) [DCE.91.090.3MVM](#) [DCE.91.130.5MVU](#) [DCE.91.202.BVCM](#) [1338300-1](#) [1-354003-0](#) [1338301-1](#)
[142321](#) [AP105-DF11-2428S\(64\)](#) [1456088-1](#) [1490794-1](#) [1-45804-6](#) [1490357-2](#) [1490357-3](#)