

Stainless Steel-Bezel discs

SPECIFICATION

Stainless Steel AISI 303 NI
 - matt shot-blasted
 Plastic disc (Polyamide PA)
 white

INFORMATION

Stainless Steel-Bezel discs GN 185 are used for shrouding screw joints when a visually nice finish is required.
 The purpose of the plastic discs supplied as a standard item on delivery is merely to avoid damage to improved surfaces.

TECHNICAL INFORMATION

- Stainless Steel characteristics (see page A26)
- Plastic characteristics (see page A2)

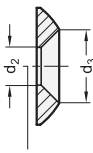

Bore for countersunk head screw
 DIN 7991 / DIN ISO 2009

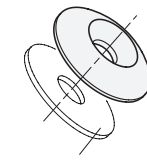
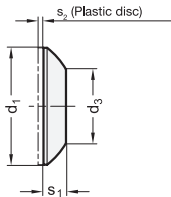

Plastic disc

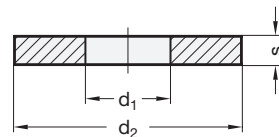

GN 185

STAINLESS STEEL

Description	d1	d2	d3	s1	s2	For countersunk screws DIN 7991 DIN ISO 2009	⚖️
GN 185-18-NI	18	4.3	8.5	3	0.8	M 4	3
GN 185-20-NI	20	5.3	10.5	3.5	1	M 5	5
GN 185-22-NI	22	6.4	12.6	4	1	M 6	7
GN 185-26-NI	26	8.4	16.8	5	1	M 8	11

DIN 6340

Description	d1	d2	s	For threaded bolts	⚖️
DIN 6340-6,4	6.4	17	3	M 6	5
DIN 6340-8,4	8.4	23	4	M 8	10
DIN 6340-10,5	10.5	28	4	M 10	15
DIN 6340-13	13	35	5	M 12	30
DIN 6340-15	15	40	5	M 14	42
DIN 6340-17	17	45	6	M 16	50
DIN 6340-21	21	50	6	M 20	60
DIN 6340-25	25	60	8	M 24	135
DIN 6340-31	31	68	10	M 30	230

X-ON Electronics

Largest Supplier of Electrical and Electronic Components

Click to view similar products for [Screws & Fasteners](#) category:

Click to view products by [Elesa & Ganter](#) manufacturer:

Other Similar products are found below :

[5721-1440-1/4-SS](#) [593503FX](#) [0098.0094](#) [0098.9206](#) [0098.9219](#) [0098.9221](#) [0098.9262](#) [596-2114-013](#) [59781-4](#) [59781-6](#) [0098.0026](#)
[0098.9210](#) [0098.9212](#) [60227-01](#) [60227-04](#) [60227-08](#) [60228-09](#) [618-00001](#) [62153-03](#) [62153-11](#) [M316-KSSTMCZ100](#) [M3440-SS](#) [M3442-SS](#) [M3448-SS](#) [6291A](#) [6292-1](#) [6-306105-9](#) [6-306131-4](#) [690432-1](#) [699161-000](#) [700989](#) [7-18023-1](#) [7-21002-8](#) [7230-3](#) [7235-3](#) [7248-1](#) [7248-2](#)
[73542-02](#) [CAPTIVE SHORT THUMBSCREW](#) [745564-1](#) [748174-2](#) [F03-02](#) [SUS316](#) [F1209](#) [751-00001](#) [80011](#) [809704-1](#) [8700](#) [8860220](#)
[9047](#) [95000002B](#) [9885-2](#)