

# GN 798.1 | Revolving handles

Stainless steel



## MATERIAL

Fine turned AISI 303 stainless steel.

## STANDARD EXECUTION

AISI 303 stainless steel pin, hexagonal socket at threaded end.

## SPECIAL EXECUTIONS ON REQUEST

Shank with different threadings.

# GN 798.4 | Revolving handles

Mounting on the operator's side, stainless steel



## MATERIAL

Fine turned AISI 303 stainless steel.

## STANDARD EXECUTION

AISI 303 stainless steel pin.

## FEATURES

Using a wrench to the flat faces (s) at the base of the pin, the front locking allows to exert a greater torque than the one applied with a wrench to the hexagonal socket into the threaded pin (back mounting).



Conversion Table	
1 mm = 0.039 inch	
d1	
mm	inch
18	0.71
22	0.87
24	0.94

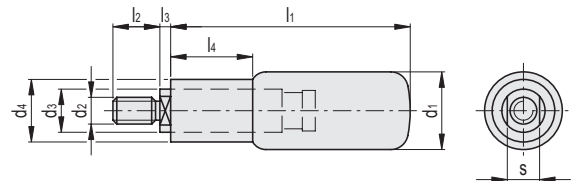
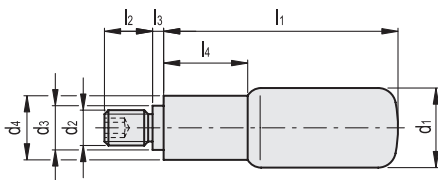

Code	Description	d1	d2	d3	d4	l1	l2	l3	l4	⚖️
GN.11221	GN 798.1-NI-18-M6	18	M6	10	14.5	56	13	2.5	19	95
GN.11222	GN 798.1-NI-18-M8	18	M8	10	14.5	56	13	2.5	19	97
GN.11225	GN 798.1-NI-22-M8	22	M8	14	18.5	59	14	2.5	21	163
GN.11226	GN 798.1-NI-22-M10	22	M10	14	18.5	59	14	2.5	21	165
GN.11227	GN 798.1-NI-24-M8	24	M8	14	18.5	74	16	2.5	27	210
GN.11228	GN 798.1-NI-24-M10	24	M10	14	18.5	74	16	2.5	27	212



Code	Description	d1	d2	d3	d4	l1	l2	l3	l4	s	⚖️
GN.11212	GN 798.4-NI-18-M6	18	M6	10	14.5	56	13	4	19	8	89
GN.11215	GN 798.4-NI-22-M8	22	M8	14	18.5	59	14	5.2	21	11	157
GN.11217	GN 798.4-NI-24-M10	24	M10	14	18.5	74	16	5.2	27	11	209

## X-ON Electronics

Largest Supplier of Electrical and Electronic Components

*Click to view similar products for [Knobs & Dials](#) category:*

*Click to view products by [Elesa & Ganter](#) manufacturer:*

Other Similar products are found below :

[790-1030](#) [790-1202](#) [790-2226](#) [8519](#) [8529](#) [8547](#) [85-559](#) [8573](#) [11K5015-EMNB](#) [11K5020-KLAB](#) [11K5048-KMNB](#) [11K5014-EMNB](#)  
[11K5015-EMNG](#) [MS91528-2N2B](#) [1770](#) [P400S-08-D6-N](#) [K6510](#) [KNP700A1/4](#) [3045B](#) [AR22PY-122B](#) [PKJ50B18](#) [277A](#) [348003](#) [42000B38](#)  
[420114B14](#) [5006](#) [56008-001](#) [KS700B14](#) [411](#) [420037B14](#) [WA-101C-P](#) [WA-102B](#) [WA-103](#) [WA-109B](#) [WA-1450-P](#) [WA-1550](#) [WA-1600-P](#)  
[WA-2300](#) [WA-4100](#) [WA-4108-P](#) [0195316-052](#) [0703006-003](#) [0744386-211](#) [52-928.20](#) [52-928.60](#) [8517](#) [8545](#) [8546](#) [8572](#) [WA-4104](#)