

## Breather valves

Brass

### SPECIFICATION

#### Types

- Type **A**: low design
- Type **B**: high design with Stainless Steel cap

Valve body

Brass **MS**

Ball

Stainless Steel AISI 5210

Spring

Stainless Steel AISI 301

Sealing DIN 7603 A

Soft iron 1.0338

(for  $d_1 = M10 \times 1:PA6$ )

Breather cap (Type B)

Stainless Steel AISI 304

temperature resistant from  $-30\text{ °C}$  to  $+100\text{ °C}$

### INFORMATION

Once the opening pressure given in the table is exceeded, breather valves GN 883 will vent into a container and so protect against excessive inside container pressure. They also feature highly compact dimensions.

A coding (Type A) or a colour ring (Type B) in yellow (20 - 80 mbar) or green (160 - 240 mbar) indicates the different opening pressure ratings.

The simple function principle (pressure spring / ball) ensures long and trouble-free use of the valve. The installation position is vertical to the top.

### TECHNICAL INFORMATION

- Stainless Steel characteristics (see page A26)



Type A

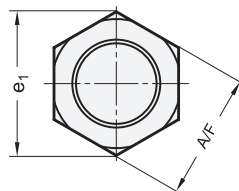
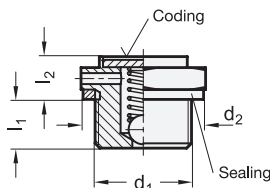

Type B

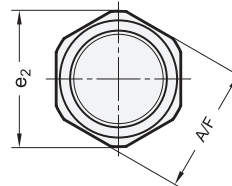
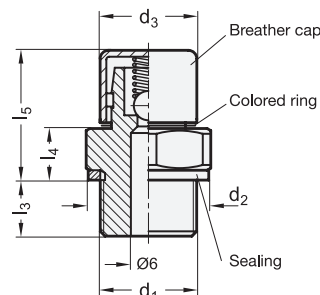



GN 883

Description	d1	Opening pressure in mbar min.	Opening pressure in mbar max.	d2	d3	e1	e2	l1	l2	l3	l4	l5	A/F	Ca. air passage l/min.	
GN 883-M10x1-20-A-MS	M 10 x 1	20	80	14.5	-	16	-	6	6	-	-	-	14	1.2	8
GN 883-M10x1-160-A-MS	M 10 x 1	160	240	14.5	-	16	-	6	6	-	-	-	14	1.2	8
GN 883-M12x1,5-20-A-MS	M 12 x 1.5	20	80	18	-	19.5	-	6.5	6	-	-	-	17	1.2	14
GN 883-M12x1,5-160-A-MS	M 12 x 1.5	160	240	18	-	19.5	-	6.5	6	-	-	-	17	1.2	14
GN 883-M14x1,5-20-A-MS	M 14 x 1.5	20	80	20	-	19.5	-	6.5	6	-	-	-	17	1.2	16
GN 883-M14x1,5-160-A-MS	M 14 x 1.5	160	240	20	-	19.5	-	6.5	6	-	-	-	17	1.2	17
GN 883-M16x1,5-20-A-MS	M 16 x 1.5	20	80	22	-	25	-	9	11	-	-	-	22	1.2	35
GN 883-M16x1,5-160-A-MS	M 16 x 1.5	160	240	22	-	25	-	9	11	-	-	-	22	1.2	36
GN 883-M10x1-20-B-MS	M 10 x 1	20	80	-	12.5	-	18.5	-	-	8	7	16	17	1.8	19
GN 883-M10x1-160-B-MS	M 10 x 1	160	240	-	12.5	-	18.5	-	-	8	7	16	17	1.8	19
GN 883-M12x1,5-20-B-MS	M 12 x 1.5	20	80	-	12.5	-	18.5	-	-	7.5	7	16.5	17	1.8	22
GN 883-M12x1,5-160-B-MS	M 12 x 1.5	160	240	-	12.5	-	18.5	-	-	7.5	7	16.5	17	1.8	22
GN 883-M14x1,5-20-B-MS	M 14 x 1.5	20	80	-	12.5	-	18.5	-	-	7.5	7.5	16.5	17	1.8	25
GN 883-M14x1,5-160-B-MS	M 14 x 1.5	160	240	-	12.5	-	18.5	-	-	7.5	7.5	16.5	17	1.8	25
GN 883-M16x1,5-20-B-MS	M 16 x 1.5	20	80	-	12.5	-	24	-	-	7.5	7.5	16.5	22	1.8	36
GN 883-M16x1,5-160-B-MS	M 16 x 1.5	160	240	-	12.5	-	24	-	-	7.5	7.5	16.5	22	1.8	36
GN 883-G1/4-20-A-MS	G 1/4	20	80	20	-	19.5	-	6.5	6	-	-	-	17	1.2	15
GN 883-G1/4-160-A-MS	G 1/4	160	240	20	-	19.5	-	6.5	6	-	-	-	17	1.2	15
GN 883-G3/8-20-A-MS	G 3/8	20	80	23	-	25	-	9	11	-	-	-	22	1.2	37
GN 883-G3/8-160-A-MS	G 3/8	160	240	23	-	25	-	9	11	-	-	-	22	1.2	35
GN 883-G1/2-20-A-MS	G 1/2	20	80	26	-	31	-	8.5	11	-	-	-	27	1.2	46
GN 883-G1/2-160-A-MS	G 1/2	160	240	26	-	31	-	8.5	11	-	-	-	27	1.2	54
GN 883-G3/4-20-A-MS	G 3/4	20	80	32	-	37	-	8.5	11	-	-	-	32	1.2	49
GN 883-G3/4-160-A-MS	G 3/4	160	240	32	-	37	-	8.5	11	-	-	-	32	1.2	83
GN 883-G1/4-20-B-MS	G 1/4	20	80	-	12.5	-	18.5	-	-	7.5	7.5	16.5	17	1.8	24
GN 883-G1/4-160-B-MS	G 1/4	160	240	-	12.5	-	18.5	-	-	7.5	7.5	16.5	17	1.8	24
GN 883-G3/8-20-B-MS	G 3/8	20	80	-	12.5	-	24	-	-	7.5	7.5	16.5	22	1.8	38
GN 883-G3/8-160-B-MS	G 3/8	160	240	-	12.5	-	24	-	-	7.5	7.5	16.5	22	1.8	38
GN 883-G1/2-20-B-MS	G 1/2	20	80	-	12.5	-	29	-	-	8	8	17	27	1.8	56
GN 883-G1/2-160-B-MS	G 1/2	160	240	-	12.5	-	29	-	-	8	8	17	27	1.8	56
GN 883-G3/4-20-B-MS	G 3/4	20	80	-	12.5	-	35	-	-	8	8	17	32	1.8	84
GN 883-G3/4-160-B-MS	G 3/4	160	240	-	12.5	-	35	-	-	8	8	17	32	1.8	84

Accessories for hydraulic systems 15

## X-ON Electronics

Largest Supplier of Electrical and Electronic Components

*Click to view similar products for [Mounting Fixings](#) category:*

*Click to view products by [Elesa & Ganter](#) manufacturer:*

Other Similar products are found below :

[5912235-1 REV](#) - [71-215091-8S](#) [71-344699-4S](#) [75-69211-3P](#) [75-69214-6P](#) [75-69224-28P](#) [75-69232-17S](#) [7717-8DAP](#) [85043GULPR](#)  
[85048GBESR](#) [PMS27488-001-01](#) [1-18023-0](#) [H-118-2](#) [1301790551](#) [1302263564](#) [BR16A](#) [NT20SATT01](#) [22594-8](#) [89078GBESR](#)  
[9150700000](#) [SF4011-60101](#) [1671](#) [1855-54](#) [1996901-1](#) [2079844-1](#) [2193](#) [2518](#) [H-118-1](#) [BACC47CN2S](#) [LF9Z-1SB22](#) [WMLX-109](#)  
[ELXA051G1](#) [2547](#) [1453315-11](#) [71-452350-8S](#) [71-572965-8S](#) [75-69214-7J](#) [75-69224-28G](#) [75-69811-3S](#) [H373247-15](#) [81517301](#) [P954-1](#)  
[860099-1](#) [1189-90](#) [1106352-2](#) [M39014/01-1570](#) [30809-700](#) [6024](#) [197-007](#) [BRKT-ND](#)